

# **COMBUSTOR SITE** **SW1/4NE1/4 SECTION 12, T33N, R12W, N.M.P.M.**

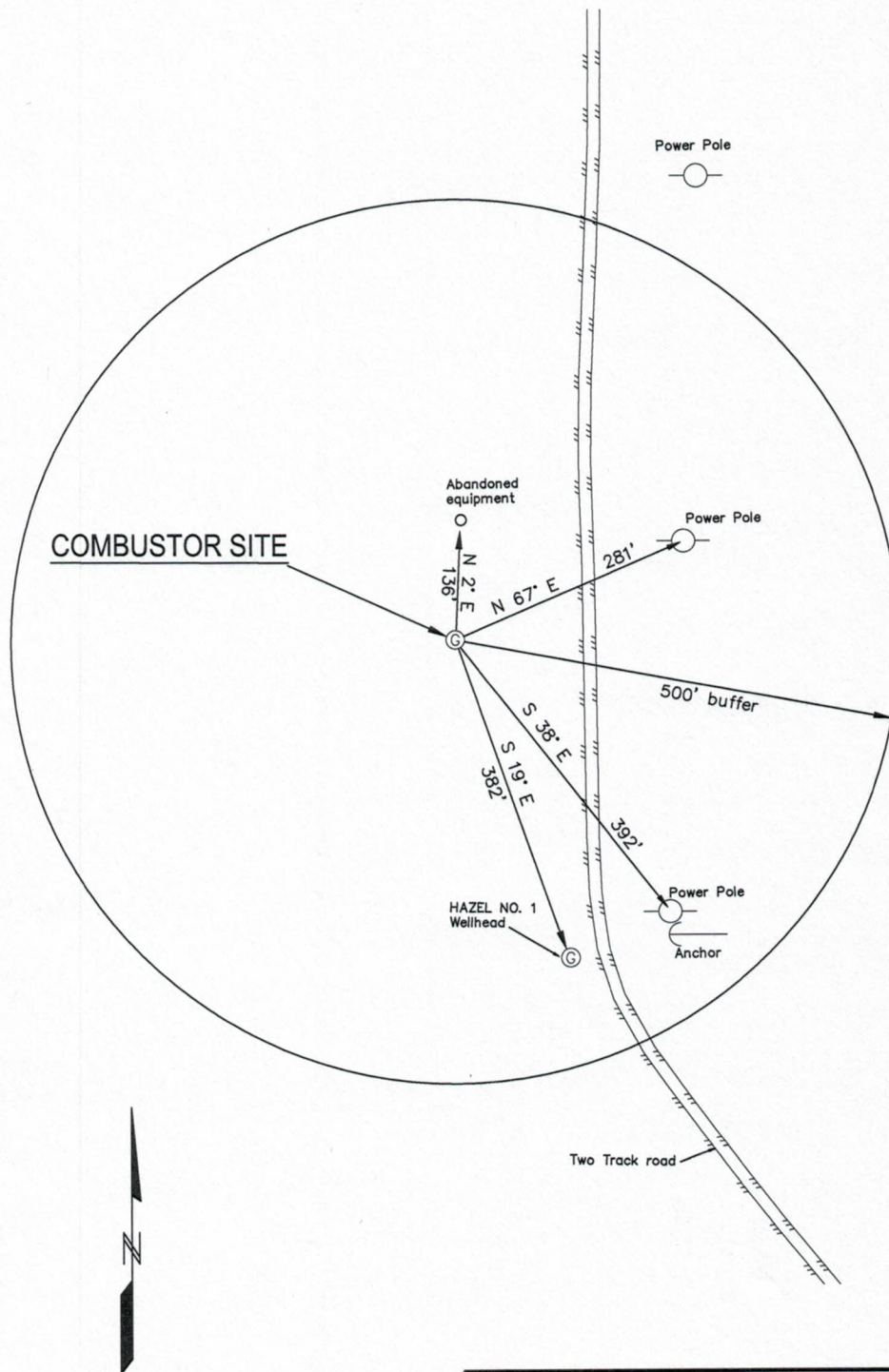

0 100' 200' 400'  
 SCALE 1"=200'  
 U.S. SURVEY FEET

<b>GOFF</b> ENGINEERING + SURVEYING INC 126 ROCK POINT DRIVE PO BOX 97 DURANGO, COLORADO 81302 970.247.1705		WILLIFORD RESOURCES		SHEET
		COMBUSTOR SITE LOCATION CERTIFICATE 1652 ft. FNL & 2030 ft FEL SW1/4NE1/4 SECTION 12, T 33 N, R 12 W, N.M.P.M. LA PLATA COUNTY, COLORADO		2 OF 2
PREPARED BY:	BMB	CHECKED BY:	R. TRUDEAUX	
PROJECT NO.	17-018	SCALE:	AS SHOWN	DATE: 04/25/17

Goff Engineering & Surveying, Inc. expressly reserves the common law copyright and other property rights in these plans. These plans are not to be changed or copied in any form or manner whatsoever nor are they to be assigned to any third party without first obtaining written permission and consent of Goff Engineering & Surveying, Inc. ©