

ENRIGHT 18-N PAD NOTIFICATION ZONE DRAWING

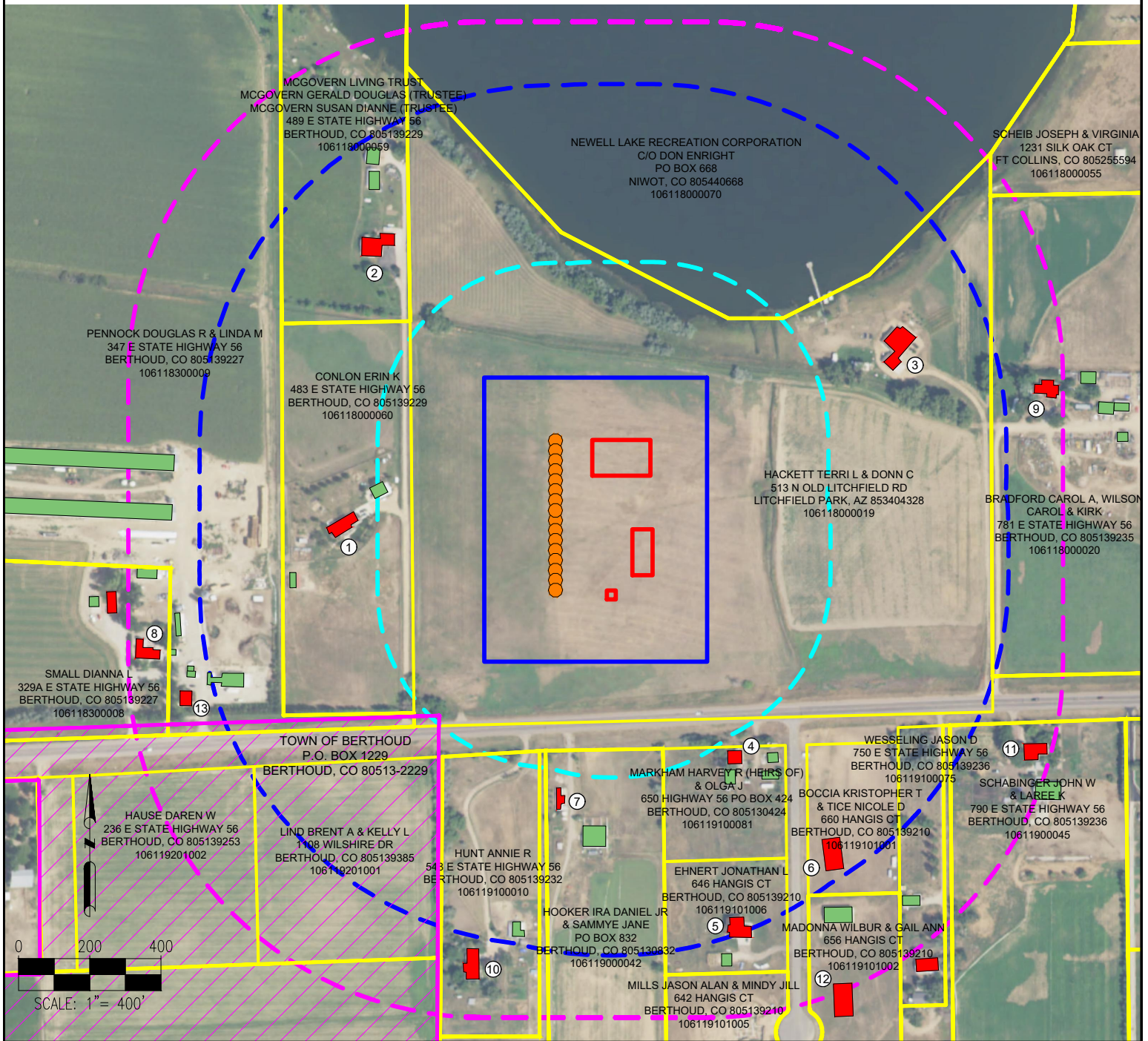

COGCC EXCEPTION ZONE

There are no building units within the Exception Zone

COGCC BUFFER ZONE

1. Conlin Erin K is ±554' W of Proposed Well Enright 9N
2. McGovern Living Trust is ±711' NW of Proposed Well Enright 1N
3. Hackett Terri L & Donn C are ±692' NE of Proposed Facility
4. Markham Harvey R (Heirs of) & Olga J are ±529' SE of Proposed Facility
5. Ehnert Jonathan L is ±949' SE of Proposed Facility
6. Boccia Kristopher T & Tice Nicole D are ±889' SE of Proposed Facility
7. Hooker Ira Daniel Jr & Sammye Jane are ±545' SW of Proposed Facility

WOGLA BUFFER ZONE

8. Small Diane L is ±911' W of Disturbance Area
9. Bradford Carol A, Wilson Carol & Kirk are ±1086' NE of Disturbance Area
10. Hunt Annie R is ±807' S of Disturbance Area
11. Schabinger John W & Laree K are ±919' SE of Disturbance Area
12. Madonna Wilbur & Gail Ann are ±972' SE of Disturbance Area
13. Pennock Douglas R & Linda M are ±826' SW of Disturbance Area

DATA SOURCE:
AERIAL IMAGERY: NAIP 2015
PARCELS: WELD COUNTY ASSESSOR

PUBLICLY AVAILABLE DATA SOURCES HAVE NOT BEEN INDEPENDENTLY VERIFIED BY PFS.

DISCLAIMER:
THIS PLOT DOES NOT REPRESENT A MONUMENTED LAND SURVEY AND SHOULD NOT BE RELIED UPON TO DETERMINE BOUNDARY LINES, PROPERTY OWNERSHIP OR OTHER PROPERTY INTERESTS. PARCEL LINES, IF DEPICTED HAVE NOT BEEN FIELD VERIFIED AND MAY BE BASED UPON PUBLICLY AVAILABLE DATA THAT ALSO HAS NOT BEEN INDEPENDENTLY VERIFIED.

LEGEND:

- = PROPOSED WELL
- = BUILDING UNIT
- ▨ = MUNICIPAL BOUNDARY
- = BUILDING
- ▭ = PROPOSED FACILITY
- ▭ = 500' EXCEPTION ZONE - COGCC REGS.
- ▭ = PROPERTY LINE
- ▭ = 1000' BUFFER ZONE - COGCC REGS.
- ▭ = DISTURBANCE AREA
- ▭ = 1000' BUFFER ZONE - WOGLA REGS.

REFERENCE LOCATION

All measurements are made from the wall or corner of the nearest Building Unit and the center of the proposed wellhead or Production Facility edge or Disturbance Area edge closest to said Building Unit.

7535 Hilltop Circle
Denver, CO 80221
(303) 929-7128
www.ascentgeomatics.com

FIELD DATE: 08-04-14	DRAWING DATE: 03-31-17	BY: CSG	CHECKED BY: IJM
--------------------------------	----------------------------------	-------------------	---------------------------

SITE NAME: ENRIGHT 18-N PAD	SURFACE LOCATION: SW 1/4 SE 1/4 SEC. 18, T4N, R68W, 6TH P.M.
WELD COUNTY, COLORADO	

PREPARED FOR:

EXTRACTION
Oil & Gas