

T6N

**LEGEND:**

- EXISTING DRAINAGE
- EDGE OF DISTURBANCE
- 1000' OFFSET BOUNDARY
- WATER WELLS
- FLOODPLAINS

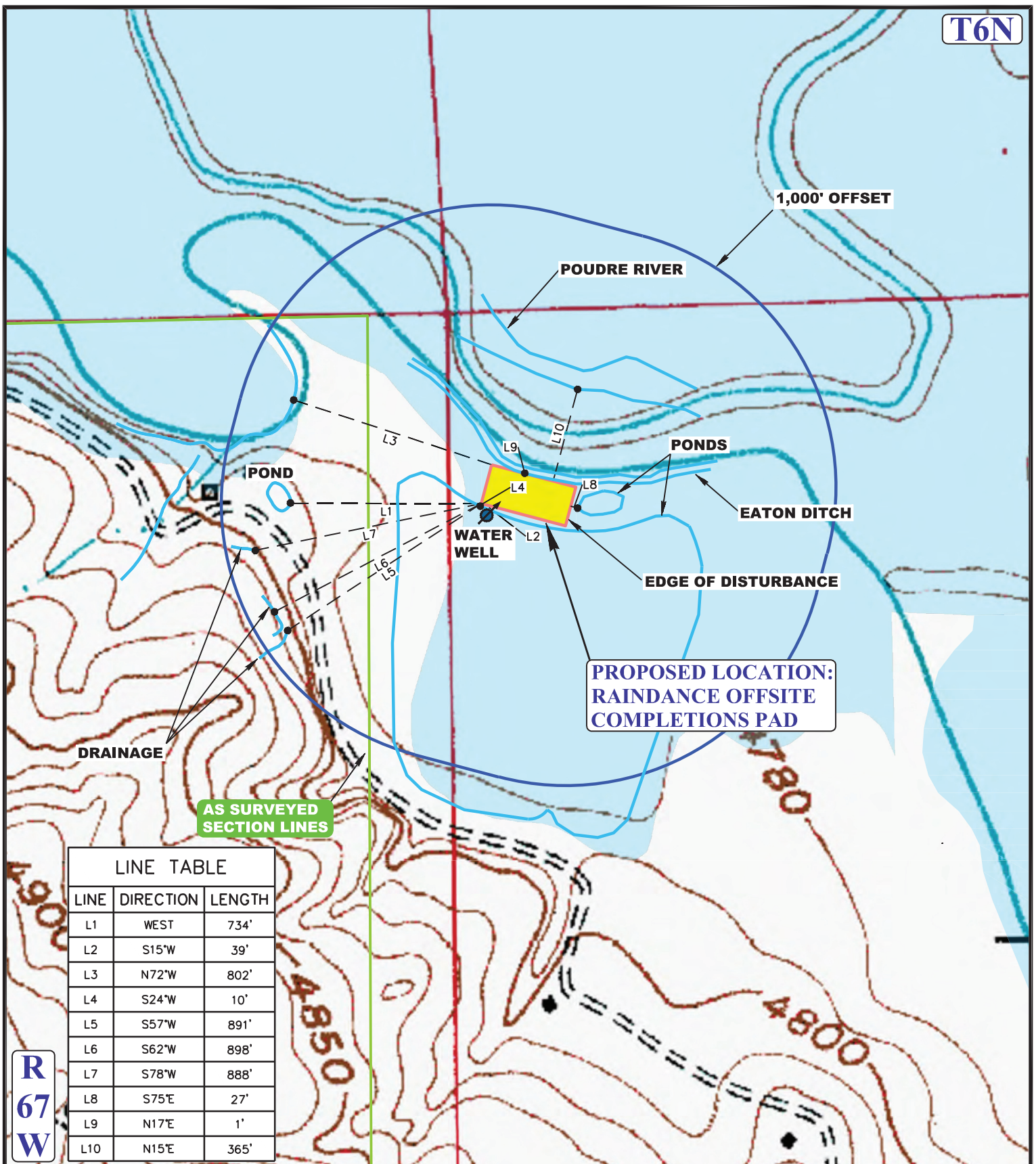

**UELS, LLC**  
 Corporate Office \* 85 South 200 East  
 Vernal, UT 84078 \* (435) 789-1017

**GREAT WESTERN OPERATING COMPANY**

**RAINDANCE OFFSITE COMPLETIONS PAD**  
 NW 1/4 NW 1/4, SECTION 29, T6N, R67W, 6th P.M.  
 WELD COUNTY, COLORADO

SURVEYED BY	D.N., C.M.	03-01-17	SCALE
DRAWN BY	J.L.G.	03-07-17	1 : 6000
<b>HYDROLOGY MAP</b>			<b>TOPO W</b>