

W1/2 SW1/4 SECTION 3, TOWNSHIP 1 NORTH, RANGE 68 WEST, 6TH P.M.

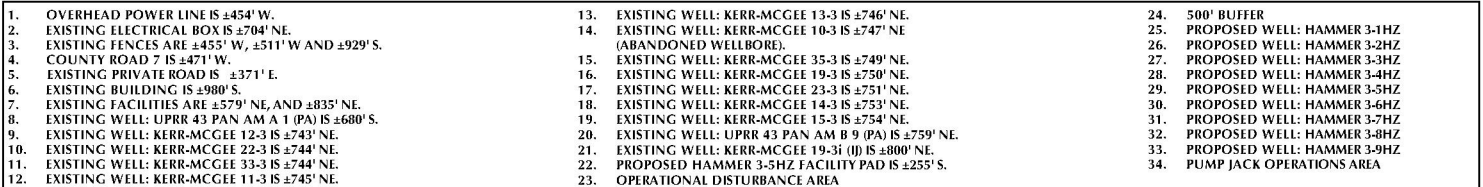

	EXISTING WELL		500' BUFFER
	PROPOSED WELL		DISTURBANCE AREA
	WATER WELL		PUMP JACK AREA
	EXISTING FENCE		PROPOSED FACILITY
	PUBLIC ROAD		DITCH/CANAL/DRAINAGE
	PRIVATE ROAD		

ALL MEASUREMENTS ARE MADE FROM
REFERENCE WELL: HAMMER 3-5HZ
LAT: 40.076616° LONG: -104.997205° (NAD83)
EXISTING GROUND ELEVATION = 5044.7'
WELL FOOTAGES: 1306' FSL & 486' FWL

PREPARED FOR:
Kerr-McGee Oil & Gas Onshore L.P.



SHERIDAN OFFICE
1095 Saberton Avenue
Sheridan, Wyoming 82801
Phone 307-674-0609

DATE SURVEYED: 12/15/16
DATE: 2/20/17
DRAFTER: CDR
REVISED:

DATA SOURCES:
- AERIAL COURTESY OF ESRI, INC.
- WATER WELLS COURTESY OF
COLORADO DIVISION OF WATER
RESOURCES