

OIL AND GAS CONSERVATION COMMISSION  
OF THE STATE OF COLORADO

REAL RESOURCES.

00643488

RECEIVED

MAR 19 1975

## APPLICATION

## FOR PERMIT TO DRILL, DEEPEN, OR REENTER AND OPERATE

## 1a. TYPE OF WORK

DRILL ☒DEEPEN ☐REENTER ☐

## b. TYPE OF WELL

OIL  
WELL ☐GAS  
WELL ☒OTHER ☐SINGLE  
ZONE ☐MULTIPLE  
ZONE ☐

## 2. NAME OF OPERATOR

Amoco Production Company

PHONE NO.

## 3. ADDRESS OF OPERATOR

P. O. Box 1400 Riverton, Wyoming 82501

## 4. LOCATION OF WELL (Report location clearly and in accordance with any State requirements.)

At surface

990 FWL, 1470 FSL, NW/4 SW/4 Sec. 22

At proposed prod. zone

## 14. DISTANCE IN MILES AND DIRECTION FROM NEAREST TOWN OR POST OFFICE

NW SW

15. DISTANCE FROM PROPOSED LOCATION TO NEAREST PROPERTY OR LEASE LINE, FT.  
(Also to nearest drlg. line, if any)16. NO. OF ACRES IN LEASE\*  
32017. NO. OF ACRES AND/OR DRILLING UNIT ASSIGNED TO THIS WELL  
320

## 18. DISTANCE FROM PROPOSED LOCATION TO NEAREST WELL, DRILLING, COMPLETED, OR APPLIED FOR, ON THIS LEASE, FT.

19. PROPOSED DEPTH  
785220. ROTARY OR CABLE TOOLS  
Rotary

## 21. ELEVATIONS (Show whether DF, RT, GR, etc.)

4988 GL

## 22. APPROX. DATE WORK WILL START

4-9-75

23.

## PROPOSED CASING AND CEMENTING PROGRAM

SIZE OF HOLE	SIZE OF CASING	WEIGHT PER FOOT	SETTING DEPTH	QUANTITY OF CEMENT
12 1/4	8 5/8	24	235	200 Sacks
7 7/8	4 1/2	10.5	7852	200 Sacks

(To cover Fox Hills Formation-  
Base of Fox Hills Formation  
Estimated at 182')

## \* DESCRIBE LEASE Drilling Unit S/2 Sec. 22

Propose to drill well to test Muddy J

Will run SP-IES Log from bottom of surface casing to total depth  
Will run FDC-GR-Caliper Log from Sussex & Niobrara to total depth

Coring Program: None

DST's: None

Completion Program will be contingent upon samples and logs.

IN ABOVE SPACE DESCRIBE PROPOSED PROGRAM: If proposal is to deepen or reenter and operate, give data on present productive zone and proposed new productive zone. If proposal is to drill or deepen directionally, give pertinent data on subsurface locations and measured and true vertical depths. Give blowout preventer program, if any.

In accepting this permit the applicant agrees to fully abide by the requirements and rules of this Commission governing this permitted operation including his responsibility to prevent pollution of state waters during drilling, treating, testing, and producing operations and by the casing, cementing and plugging requirements particularly designed for the protection of state waters and the prevention of intermingling of the contents of all the various zones encountered in this permitted operation.

24.

SIGNED

Area Admin. Supervisor

DATE 3/18/75

(This space for Federal or State Office use)

75 215

PERMIT NO.

APPROVAL DATE

APPROVED BY

TITLE

DATE

CONDITIONS OF APPROVAL, IF ANY:

A.P.I. NUMBER

C.5 123 83.54

See Instructions On Reverse Side



FORM F-106

RECEIVED

MAR 25 1975 N

GOLD. CO. &amp; S.W. COR. CO. M.

R. 68W

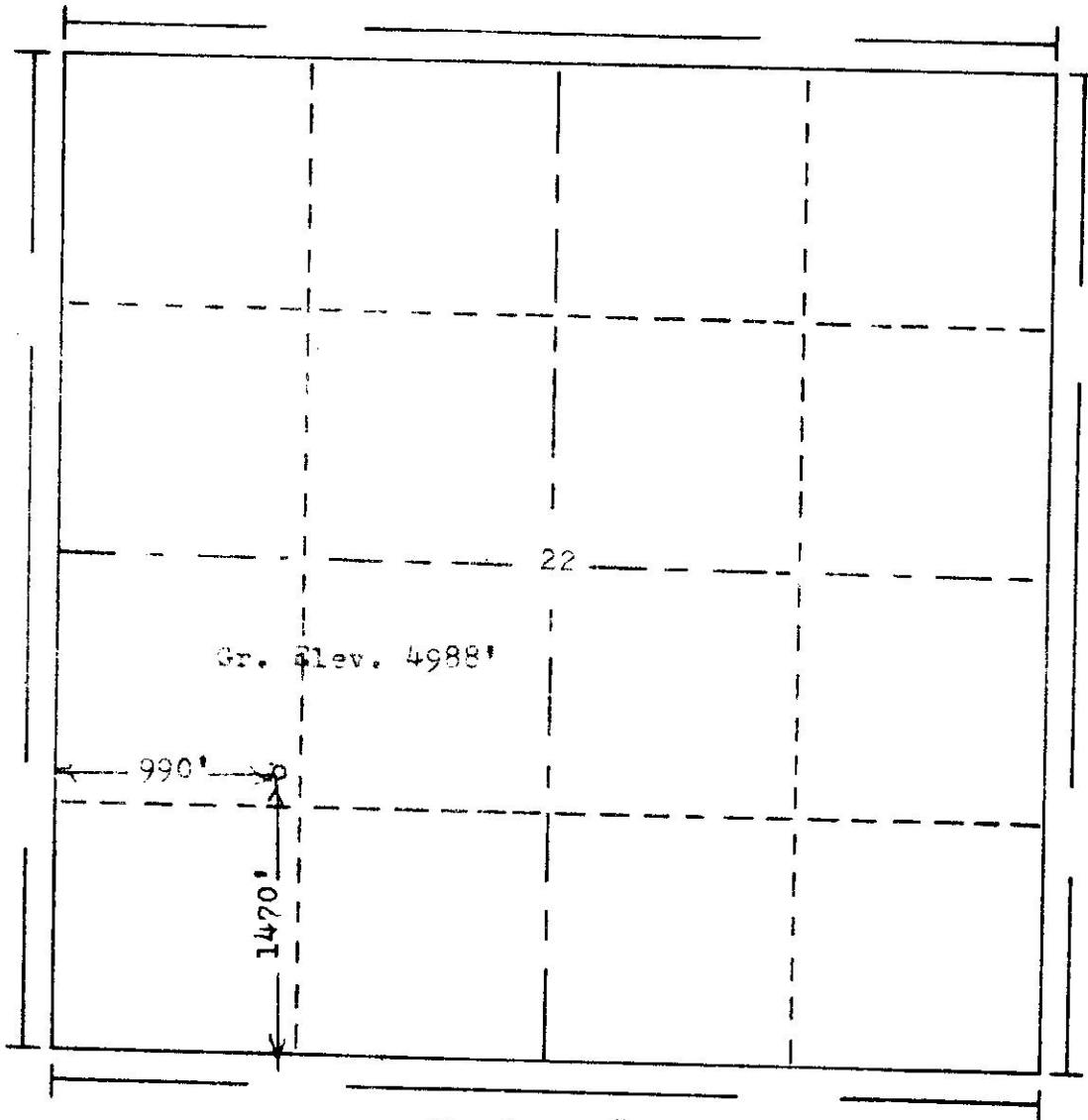

Scale... 1" = 1000'

Powers Elevation Company, Inc. of Denver, Colorado  
has in accordance with a request from Mr. McMillian  
for Amoco Production Co.  
determined the location of No. 1 F.E. Weingardt Gas Unit  
to be 1470'FS & 990'FW  
Range 68W of the 6th Principal Meridian  
Weld County, Colorado

I hereby certify that this plat is an  
accurate representation of a correct  
survey showing the location of

Date: 3-15-75

*Bill J. Hanna*  
Licensed Land Surveyor No. 2853  
State of Colorado