

Soil Map—Weld County, Colorado, Northern Part  
(Harvey Pad 7-63-24-SWSW Soils Map)

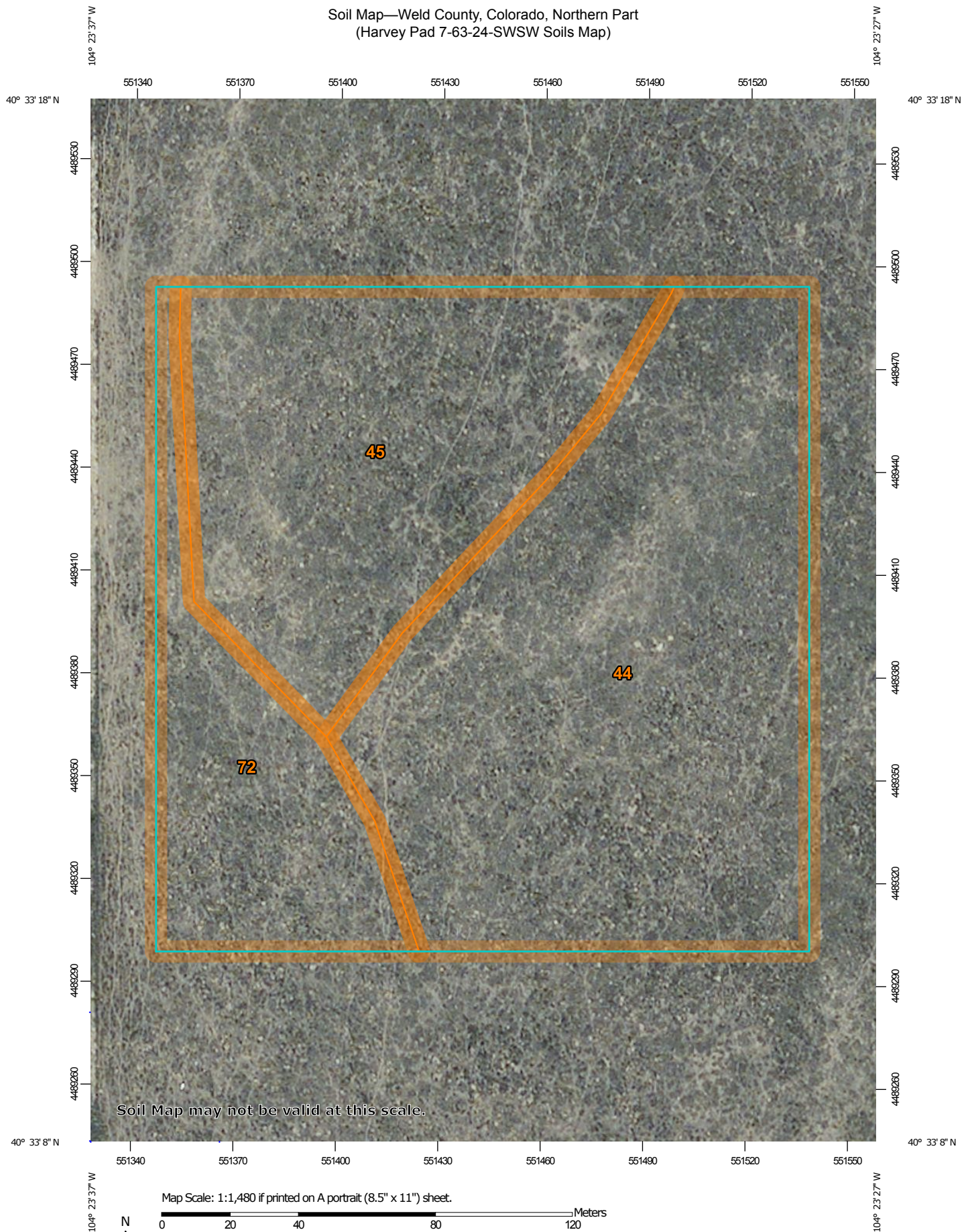

Soil Map may not be valid at this scale.

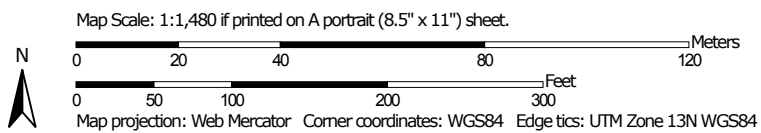

Soil Map—Weld County, Colorado, Northern Part  
(Harvey Pad 7-63-24-SWSW Soils Map)

## MAP LEGEND

### Area of Interest (AOI)

 Area of Interest (AOI)

### Soils

 Soil Map Unit Polygons

 Soil Map Unit Lines

 Soil Map Unit Points

### Special Point Features



Blowout



Borrow Pit



Clay Spot



Closed Depression



Gravel Pit



Gravelly Spot



Landfill



Lava Flow



Marsh or swamp



Mine or Quarry



Miscellaneous Water



Perennial Water



Rock Outcrop



Saline Spot



Sandy Spot



Severely Eroded Spot



Sinkhole



Slide or Slip



Sodic Spot



Spoil Area



Stony Spot



Very Stony Spot



Wet Spot



Other



Special Line Features

### Water Features



Streams and Canals

### Transportation



Rails



Interstate Highways



US Routes



Major Roads



Local Roads

### Background



Aerial Photography

## MAP INFORMATION

The soil surveys that comprise your AOI were mapped at 1:24,000.

Warning: Soil Map may not be valid at this scale.

Enlargement of maps beyond the scale of mapping can cause misunderstanding of the detail of mapping and accuracy of soil line placement. The maps do not show the small areas of contrasting soils that could have been shown at a more detailed scale.

Please rely on the bar scale on each map sheet for map measurements.

Source of Map: Natural Resources Conservation Service

Web Soil Survey URL:

Coordinate System: Web Mercator (EPSG:3857)

Maps from the Web Soil Survey are based on the Web Mercator projection, which preserves direction and shape but distorts distance and area. A projection that preserves area, such as the Albers equal-area conic projection, should be used if more accurate calculations of distance or area are required.

This product is generated from the USDA-NRCS certified data as of the version date(s) listed below.

Soil Survey Area: Weld County, Colorado, Northern Part

Survey Area Data: Version 11, Sep 22, 2016

Soil map units are labeled (as space allows) for map scales 1:50,000 or larger.

Date(s) aerial images were photographed: Apr 22, 2011—Oct 19, 2011

The orthophoto or other base map on which the soil lines were compiled and digitized probably differs from the background imagery displayed on these maps. As a result, some minor shifting of map unit boundaries may be evident.

## Map Unit Legend

Weld County, Colorado, Northern Part (CO617)			
Map Unit Symbol	Map Unit Name	Acres in AOI	Percent of AOI
44	Olney fine sandy loam, 0 to 6 percent slopes	4.8	52.3%
45	Olney fine sandy loam, 6 to 9 percent slopes	2.9	31.3%
72	Vona loamy sand, 3 to 9 percent slopes	1.5	16.4%
Totals for Area of Interest		9.2	100.0%

## Weld County, Colorado, Northern Part

### 44—Olney fine sandy loam, 0 to 6 percent slopes

#### Map Unit Setting

*National map unit symbol:* 35zy

*Elevation:* 3,500 to 5,800 feet

*Mean annual precipitation:* 11 to 15 inches

*Mean annual air temperature:* 46 to 54 degrees F

*Frost-free period:* 125 to 175 days

*Farmland classification:* Farmland of statewide importance

#### Map Unit Composition

*Olney and similar soils:* 85 percent

*Minor components:* 15 percent

*Estimates are based on observations, descriptions, and transects of the mapunit.*

#### Description of Olney

##### Setting

*Landform:* Plains

*Down-slope shape:* Linear

*Across-slope shape:* Linear

*Parent material:* Calcareous loamy alluvium

##### Typical profile

*H1 - 0 to 6 inches:* fine sandy loam

*H2 - 6 to 18 inches:* sandy clay loam

*H3 - 18 to 60 inches:* sandy loam

*H4 - 60 to 64 inches:* sandy loam

##### Properties and qualities

*Slope:* 0 to 6 percent

*Depth to restrictive feature:* More than 80 inches

*Natural drainage class:* Well drained

*Runoff class:* Low

*Capacity of the most limiting layer to transmit water (Ksat):*

Moderately high to high (0.57 to 2.00 in/hr)

*Depth to water table:* More than 80 inches

*Frequency of flooding:* None

*Frequency of ponding:* None

*Calcium carbonate, maximum in profile:* 15 percent

*Salinity, maximum in profile:* Nonsaline to very slightly saline (0.0 to 2.0 mmhos/cm)

*Available water storage in profile:* Moderate (about 8.1 inches)

##### Interpretive groups

*Land capability classification (irrigated):* None specified

*Land capability classification (nonirrigated):* 4c

*Hydrologic Soil Group:* B

*Ecological site:* Loamy Plains (R067BY002CO)



*Hydric soil rating:* No

**Minor Components**

**Stoneham**

*Percent of map unit:* 9 percent

*Hydric soil rating:* No

**Ascalon**

*Percent of map unit:* 6 percent

*Hydric soil rating:* No

**Data Source Information**

Soil Survey Area: Weld County, Colorado, Northern Part

Survey Area Data: Version 11, Sep 22, 2016

## Weld County, Colorado, Northern Part

### 45—Olney fine sandy loam, 6 to 9 percent slopes

#### Map Unit Setting

*National map unit symbol:* 35zz

*Elevation:* 3,500 to 5,800 feet

*Mean annual precipitation:* 11 to 15 inches

*Mean annual air temperature:* 46 to 54 degrees F

*Frost-free period:* 125 to 175 days

*Farmland classification:* Not prime farmland

#### Map Unit Composition

*Olney and similar soils:* 85 percent

*Minor components:* 15 percent

*Estimates are based on observations, descriptions, and transects of the mapunit.*

#### Description of Olney

##### Setting

*Landform:* Plains

*Down-slope shape:* Linear

*Across-slope shape:* Linear

*Parent material:* Calcareous loamy alluvium

##### Typical profile

*H1 - 0 to 6 inches:* fine sandy loam

*H2 - 6 to 18 inches:* sandy clay loam

*H3 - 18 to 60 inches:* sandy loam

*H4 - 60 to 64 inches:* sandy loam

##### Properties and qualities

*Slope:* 6 to 9 percent

*Depth to restrictive feature:* More than 80 inches

*Natural drainage class:* Well drained

*Runoff class:* Medium

*Capacity of the most limiting layer to transmit water (Ksat):*

Moderately high to high (0.57 to 2.00 in/hr)

*Depth to water table:* More than 80 inches

*Frequency of flooding:* None

*Frequency of ponding:* None

*Calcium carbonate, maximum in profile:* 15 percent

*Salinity, maximum in profile:* Nonsaline to very slightly saline (0.0 to 2.0 mmhos/cm)

*Available water storage in profile:* Moderate (about 8.1 inches)

##### Interpretive groups

*Land capability classification (irrigated):* None specified

*Land capability classification (nonirrigated):* 6e

*Hydrologic Soil Group:* B

*Ecological site:* Loamy Plains (R067BY002CO)

*Hydric soil rating:* No

**Minor Components**

**Vona**

*Percent of map unit:* 5 percent

*Hydric soil rating:* No

**Ascalon**

*Percent of map unit:* 5 percent

*Hydric soil rating:* No

**Stoneham**

*Percent of map unit:* 5 percent

*Hydric soil rating:* No

**Data Source Information**

Soil Survey Area: Weld County, Colorado, Northern Part  
Survey Area Data: Version 11, Sep 22, 2016

## Weld County, Colorado, Northern Part

### 72—Vona loamy sand, 3 to 9 percent slopes

#### Map Unit Setting

*National map unit symbol:* 360y

*Elevation:* 4,000 to 5,500 feet

*Mean annual precipitation:* 13 to 15 inches

*Mean annual air temperature:* 48 to 55 degrees F

*Frost-free period:* 130 to 160 days

*Farmland classification:* Not prime farmland

#### Map Unit Composition

*Vona and similar soils:* 85 percent

*Minor components:* 15 percent

*Estimates are based on observations, descriptions, and transects of the mapunit.*

#### Description of Vona

##### Setting

*Landform:* Plains

*Down-slope shape:* Linear

*Across-slope shape:* Linear

*Parent material:* Calcareous sandy alluvium and/or eolian deposits

##### Typical profile

*H1 - 0 to 2 inches:* loamy sand

*H2 - 2 to 20 inches:* fine sandy loam, sandy loam

*H2 - 2 to 20 inches:* loamy sand

*H3 - 20 to 60 inches:*

##### Properties and qualities

*Slope:* 3 to 9 percent

*Depth to restrictive feature:* More than 80 inches

*Natural drainage class:* Well drained

*Runoff class:* Low

*Capacity of the most limiting layer to transmit water (Ksat):* High  
(1.98 to 6.00 in/hr)

*Depth to water table:* More than 80 inches

*Frequency of flooding:* None

*Frequency of ponding:* None

*Calcium carbonate, maximum in profile:* 15 percent

*Salinity, maximum in profile:* Nonsaline to slightly saline (0.0 to 4.0  
mmhos/cm)

*Available water storage in profile:* Moderate (about 8.8 inches)

##### Interpretive groups

*Land capability classification (irrigated):* None specified

*Land capability classification (nonirrigated):* 6e

*Hydrologic Soil Group:* A

*Ecological site:* Deep Sand (R067BY015CO)



*Hydric soil rating:* No

**Minor Components**

**Remmit**

*Percent of map unit:* 8 percent

*Hydric soil rating:* No

**Valent**

*Percent of map unit:* 5 percent

*Hydric soil rating:* No

**Olney**

*Percent of map unit:* 2 percent

*Hydric soil rating:* No

**Data Source Information**

Soil Survey Area: Weld County, Colorado, Northern Part  
Survey Area Data: Version 11, Sep 22, 2016