

DATA SOURCES:
- AERIAL COURTESY OF ESRI, INC.

NOTES:
1. EQUIPMENT PLACEMENT IS APPROXIMATE AND SUBJECT TO MINOR MODIFICATION DUE TO SPECIFIC CIRCUMSTANCES.



LOVELAND OFFICE
1635 Foxtrail Drive, Suite 204
Loveland, Colorado 80538
Phone 970-776-4331
SHERIDAN OFFICE
1095 Saberton Avenue
Sheridan, Wyoming 82801
Phone 307-674-0609

CONSULTING, LLC



SRC ENERGY
1675 Broadway, Suite 2600
Denver, Colorado 80202

SCALE: 1" = 200'
DATE SURVEYED: 4/3/17
DATE: 4/14/17
DRAFTER: CDJ
REVISED:

FACILITY LOCATION DRAWING (A)
FALKEN 9-11 PAD
LOCATED IN SECTION 11
T6N, R66W, 6TH P.M.
WELD COUNTY, COLORADO

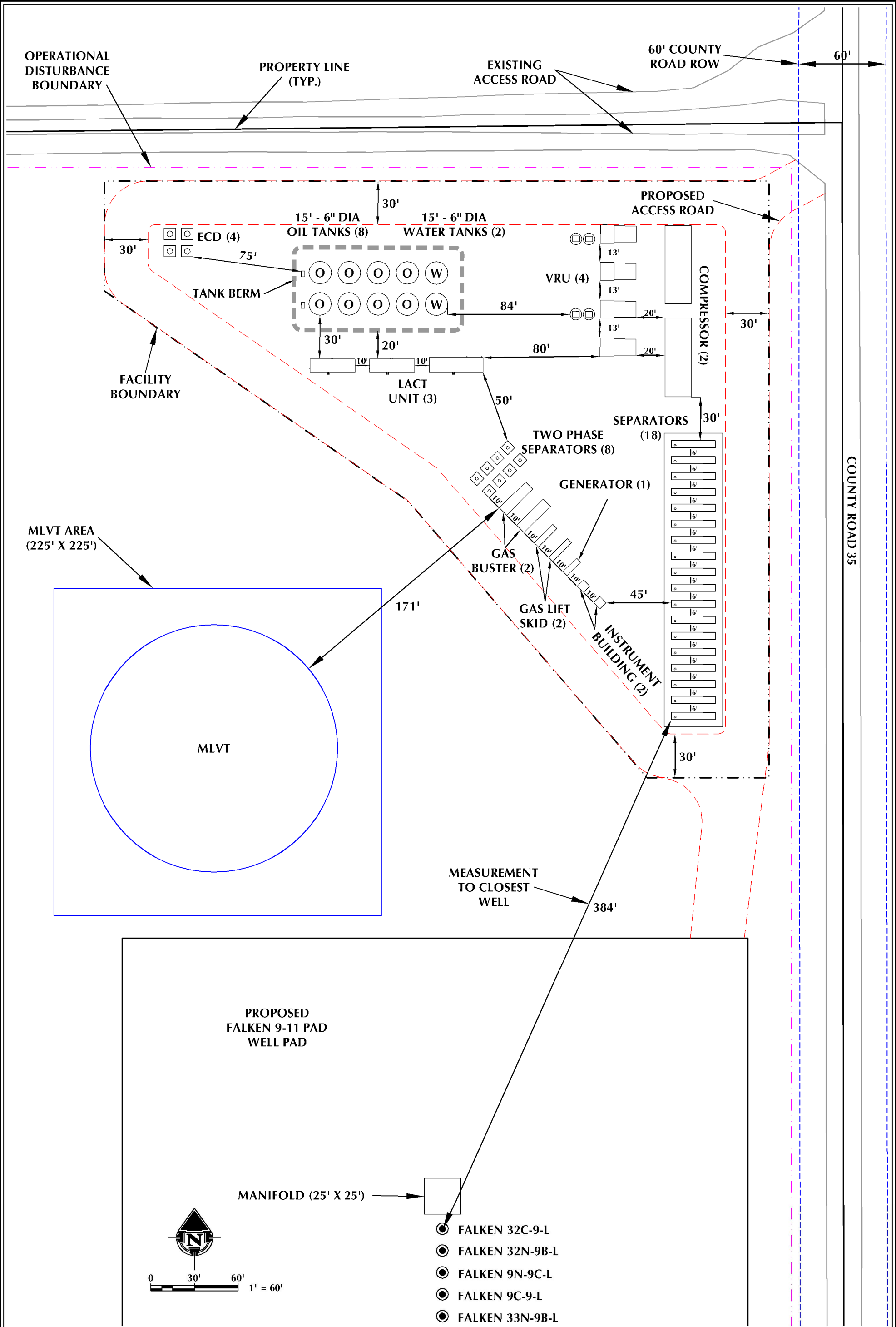

NOTES:

1. EQUIPMENT PLACEMENT IS APPROXIMATE AND SUBJECT TO MINOR MODIFICATION DUE TO SPECIFIC CIRCUMSTANCES.



609
CONSULTING, LLC

LOVELAND OFFICE
1635 Foxtrail Drive, Suite 204
Loveland, Colorado 80538
Phone 970-776-4331

SHERIDAN OFFICE
1095 Saberton Avenue
Sheridan, Wyoming 82801
Phone 307-674-0609



SRC ENERGY
1675 Broadway, Suite 2600
Denver, Colorado 80202

SCALE: 1" = 60'

DATE SURVEYED: 4/3/17

DATE: 4/3/17

DRAFTER: CDJ

REVISED: 4/7/17

FACILITY LOCATION DRAWING (B)

FALKEN 9-11 PAD

LOCATED IN SECTION 11

T6N, R66W, 6TH P.M.

WELD COUNTY, COLORADO

FACILITY LOCATION DRAWING (C)
FALKEN 9-11 PAD
PRODUCTION FACILITY & MISC. EQUIPMENT

# MLVTs	1
# VRUs	4
# Compressors	2
# LACT Units	3
# Combustors	4
# Gas Busters	2
# Oil Tanks	8
# Water Tanks	2
# Generators	1
# Single Separators	18
# Two Phase Separators	8
# Instrument Buildings	2
# Gas Lift Skids	2
* No existing facility equipment within disturbance area *	

WELLS

Proposed:
FALKEN 32C-9-L, FALKEN 32N-9B-L, FALKEN 9N-9C-L,
FALKEN 9C-9-L, FALKEN 33N-9B-L, FALKEN 33N-9A-L,
FALKEN 33C-9-L, FALKEN 33N-9C-L, FALKEN 16C-9-L,
FALKEN 16N-9B-L, FALKEN 34C-9-L, FALKEN 34N-9C-L,
FALKEN 30N-14B-S, FALKEN 30C-14-S, FALKEN 4N-14A-S,
FALKEN 4N-14C-S, FALKEN 31N-14B-S & FALKEN 31C-14-S

* No existing wells within disturbance area *