

NOTE: Earthwork calculations require a fill @ some of the location stakes for balance. All fill is to be compacted to a minimum of 95% of the maximum dry density obtained by AASHTO method t-99.

FINISHED GRADE ELEVATION = 5702.7'

- NOTES:**
- Round corners at 35' radius or as needed.
 - Construct diversion ditches as needed.
 - Contours shown at 2' intervals.
 - Cut/Fill slopes 3:1 (Typ.).

BISON EXPLORATION

HOULIHAN 4-64 22A PAD
SE 1/4 NE 1/4, SECTION 22, T4S, R64W, 6th P.M.
ARAPAHOE COUNTY, COLORADO

SURVEYED BY	GREG WEIMER	02-28-17	SCALE
DRAWN BY	J.J.	03-16-17	1" = 100'
CONSTRUCTION LAYOUT		FIGURE #1	



UELS, LLC
Corporate Office * 85 South 200 East
Vernal, UT 84078 * (435) 789-1017

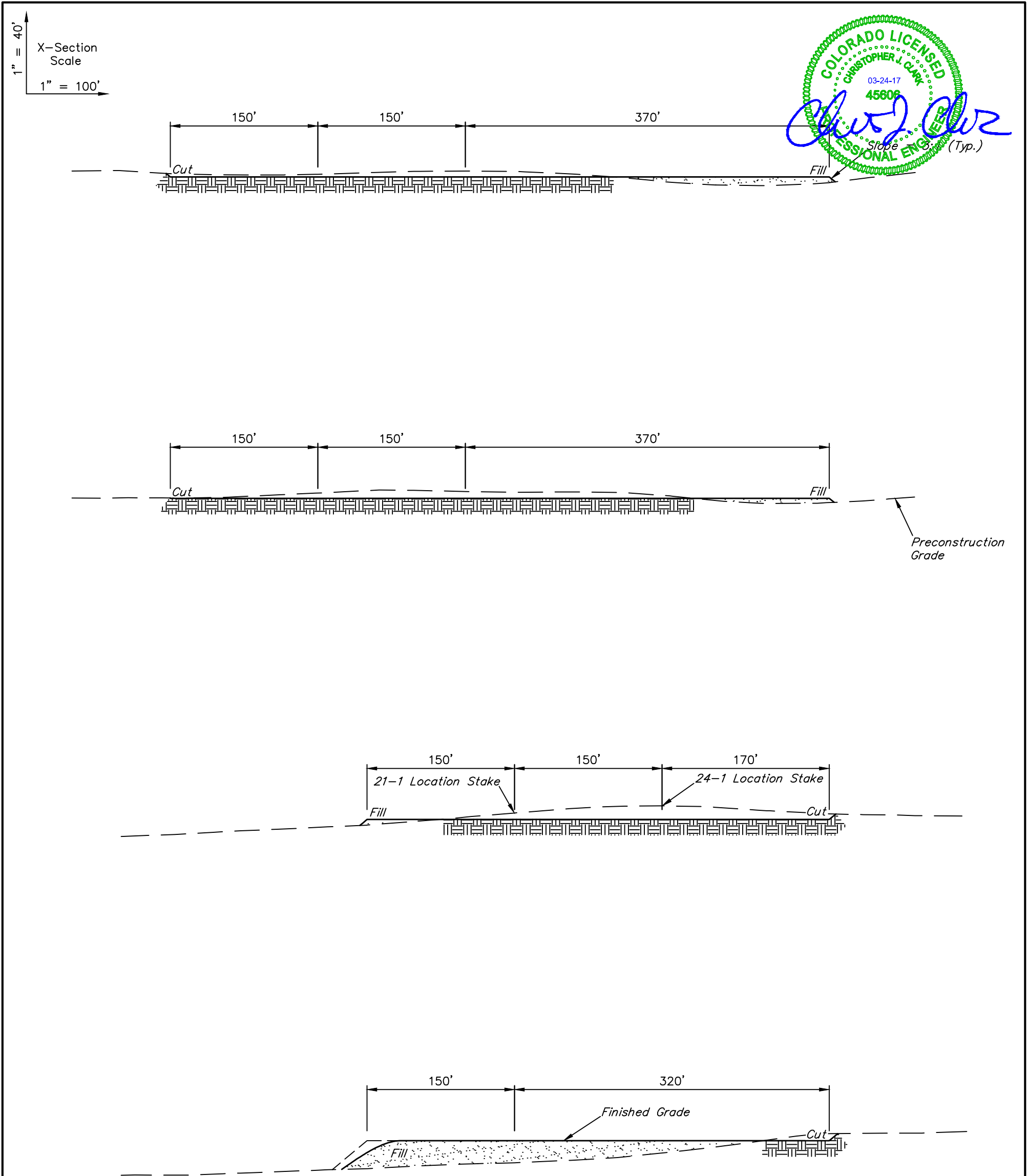

APPROXIMATE EARTHWORK QUANTITIES	
(6") TOPSOIL STRIPPING	8,380 Cu. Yds.
REMAINING LOCATION	23,910 Cu. Yds.
TOTAL CUT	32,290 Cu. Yds.
FILL	23,910 Cu. Yds.
EXCESS MATERIAL	8,380 Cu. Yds.
TOPSOIL	8,380 Cu. Yds.
EXCESS UNBALANCE (After Interim Rehabilitation)	0 Cu. Yds.

APPROXIMATE SURFACE DISTURBANCE AREAS		
	DISTANCE	ACRES
WELL SITE DISTURBANCE	NA	±13.761
30' WIDE ACCESS ROAD R-O-W DISTURBANCE	±651'	±0.448
TOTAL SURFACE USE AREA		±14.209

- NOTES:
- Fill quantity includes 10% for compaction.
 - Calculations based on 6" of topsoil stripping.
 - Cut/Fill slopes 3:1 (Typ.).

BISON EXPLORATION

HOULIHAN 4-64 22A PAD
SE 1/4 NE 1/4, SECTION 22, T4S, R64W, 6th P.M.
ARAPAHOE COUNTY, COLORADO

SURVEYED BY	GREG WEIMER	02-28-17	SCALE
DRAWN BY	J.J.	03-16-17	AS SHOWN
CONSTRUCTION LAYOUT CROSS SECTIONS			FIGURE #2



UELS, LLC
Corporate Office * 85 South 200 East
Vernal, UT 84078 * (435) 789-1017

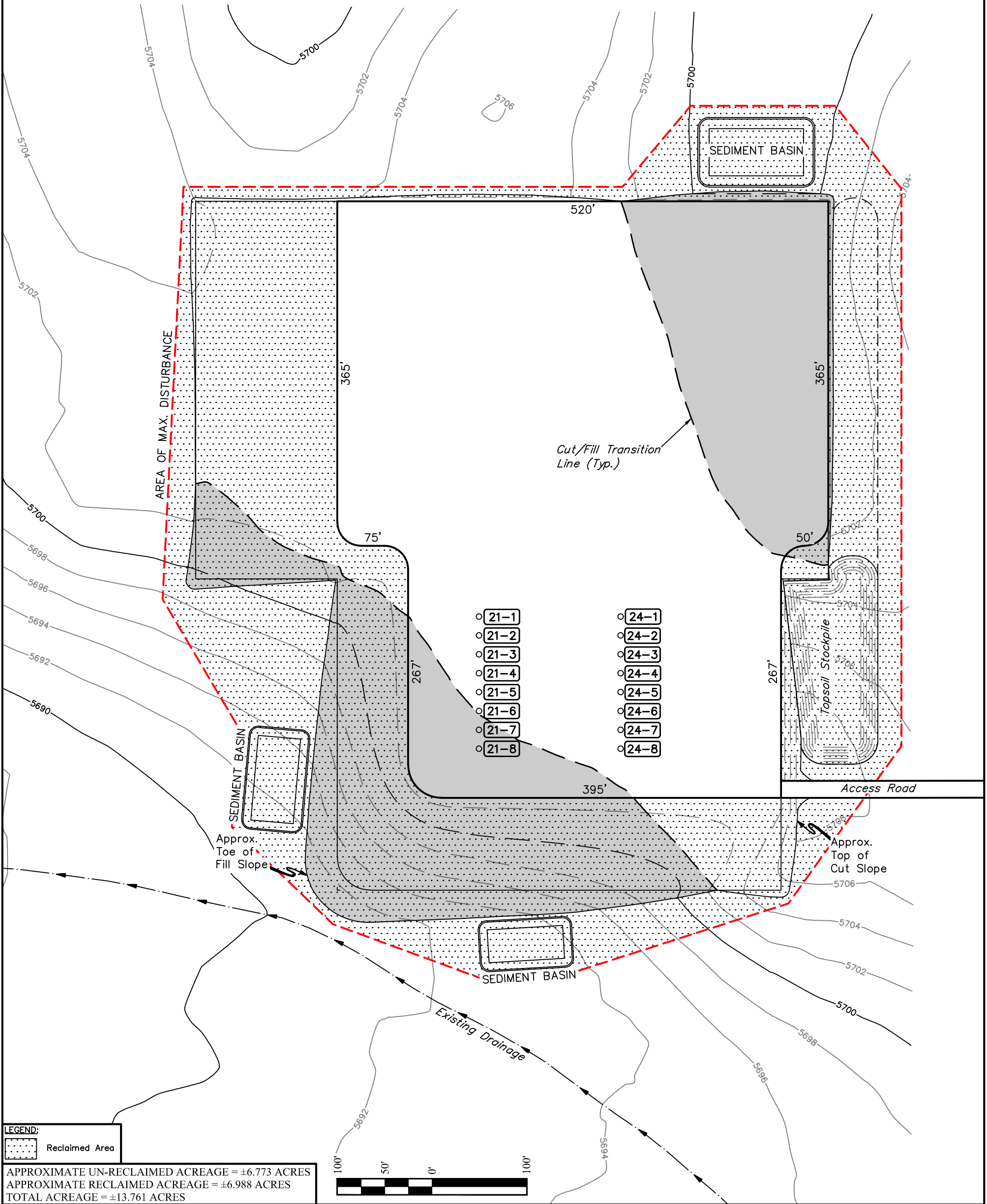
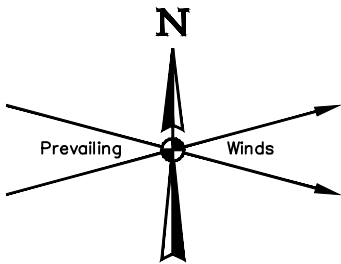

LEGEND:
Reclaimed Area

APPROXIMATE UN-RECLAIMED ACREAGE = ±6.773 ACRES
APPROXIMATE RECLAIMED ACREAGE = ±6.988 ACRES
TOTAL ACREAGE = ±13.761 ACRES

NOTES:
• Contours shown at 2' intervals.

BISON EXPLORATION

HOULIHAN 4-64 22A PAD
SE 1/4 NE 1/4, SECTION 22, T4S, R64W, 6th P.M.
ARAPAHOE COUNTY, COLORADO

SURVEYED BY	GREG WEIMER	02-28-17	SCALE
DRAWN BY	J.J.	03-16-17	1" = 100'
INTERIM RECLAMATION PLAN			FIGURE #3



UELS, LLC
Corporate Office * 85 South 200 East
Vernal, UT 84078 * (435) 789-1017