

# PROPOSED PAD CONTOURS WAKANDA #3-42

SECTION: 3  
TOWNSHIP: 4S  
RANGE: 50W

CONTOUR INTERVAL=1'

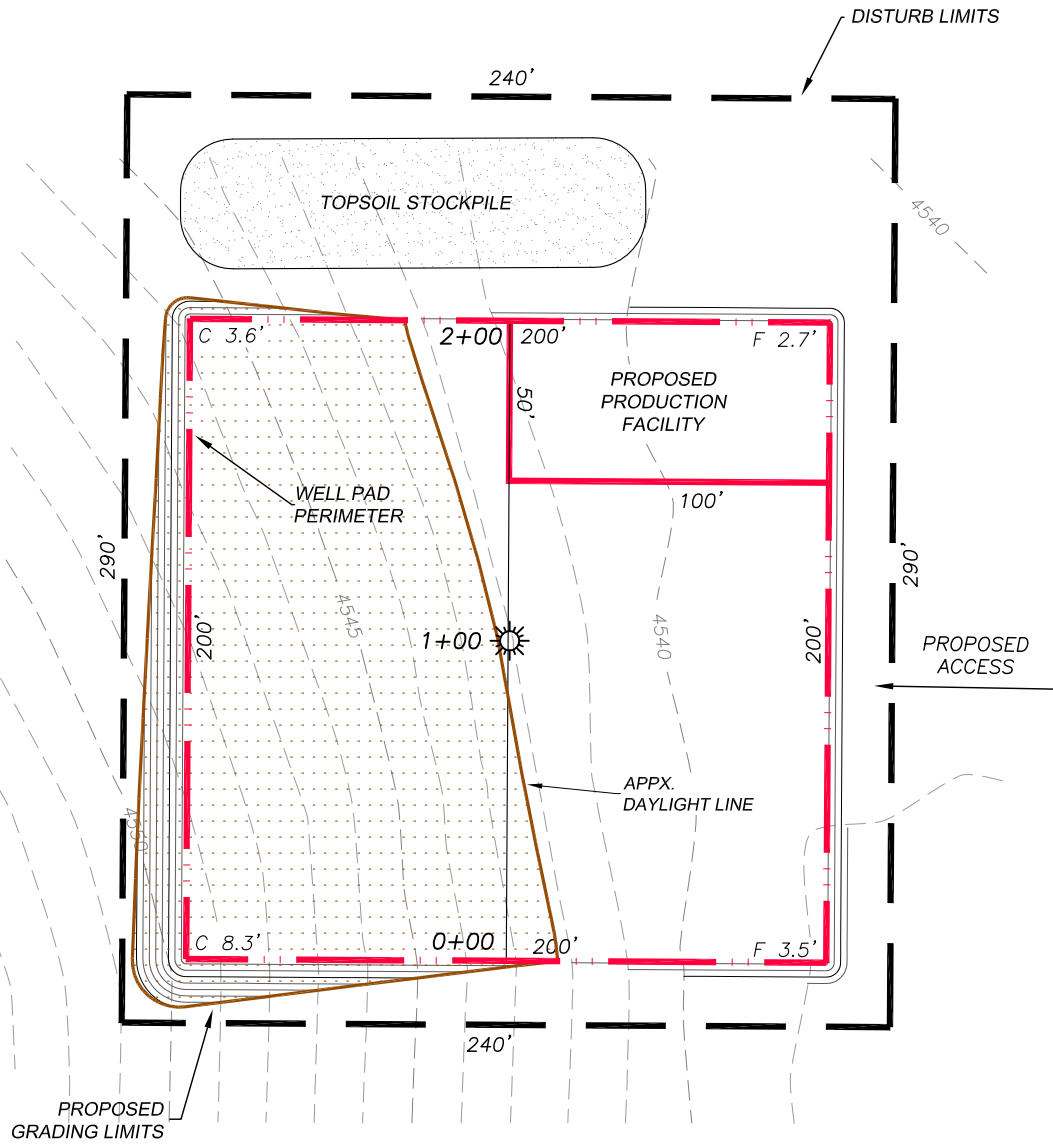

## PROPOSED PAD

Top of pad elevation: 4542.2'  
Cut slope ratio: 2.0  
Fill slope ratio: 2.0  
Cut Swell Factor: 1.00  
Fill Shrink Factor: 1.00

## PAD EARTHWORK VOLUMES

Total cut: 2468± C.Y.  
Total fill: 1618± C.Y.  
Balance Export: 850± C.Y.  
(6" Topsoil)  
Area: 1.0 Acres



AREA OF  
PROPOSED CUT

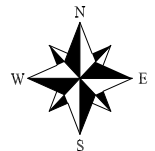

0 60  
SCALE: 1" = 60'

# PROPOSED PAD CROSS SECTIONS

## WAKANDA #3-42

SECTION: 3  
TOWNSHIP: 4S  
RANGE: 50W

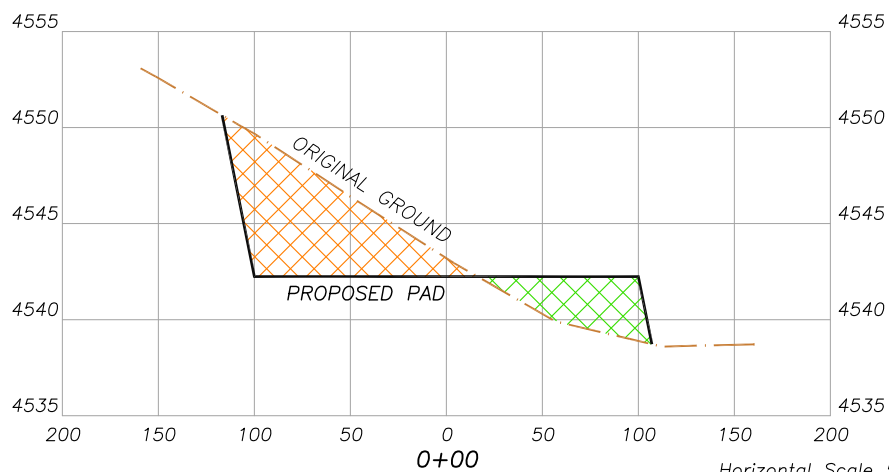
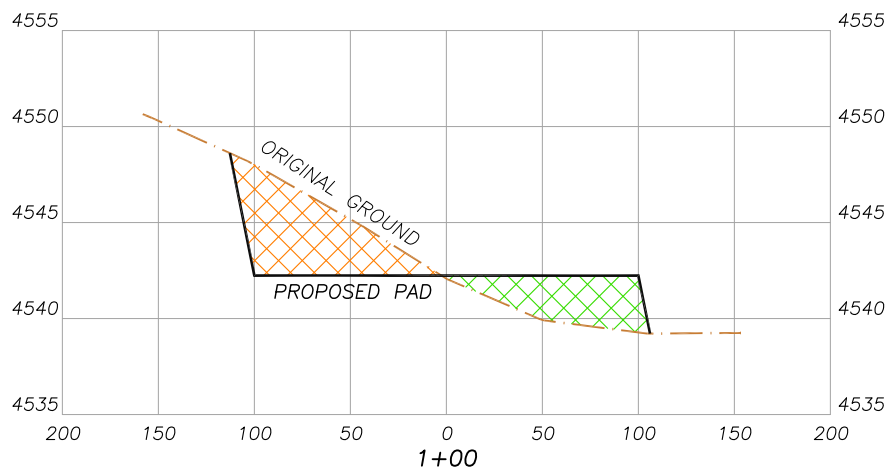
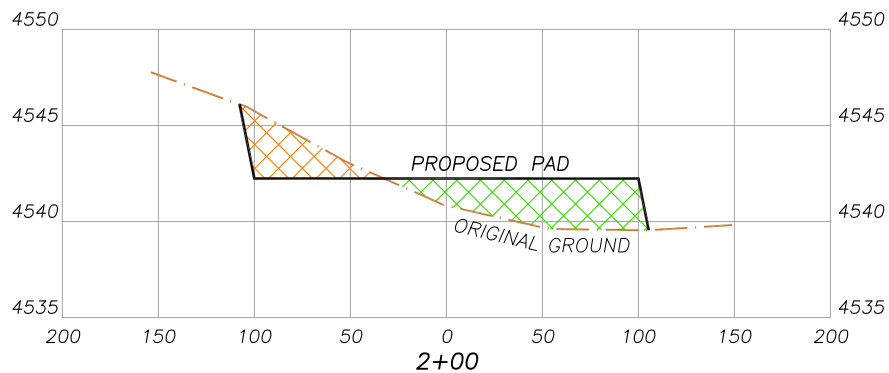

Horizontal Scale 50  
Vertical Scale 5