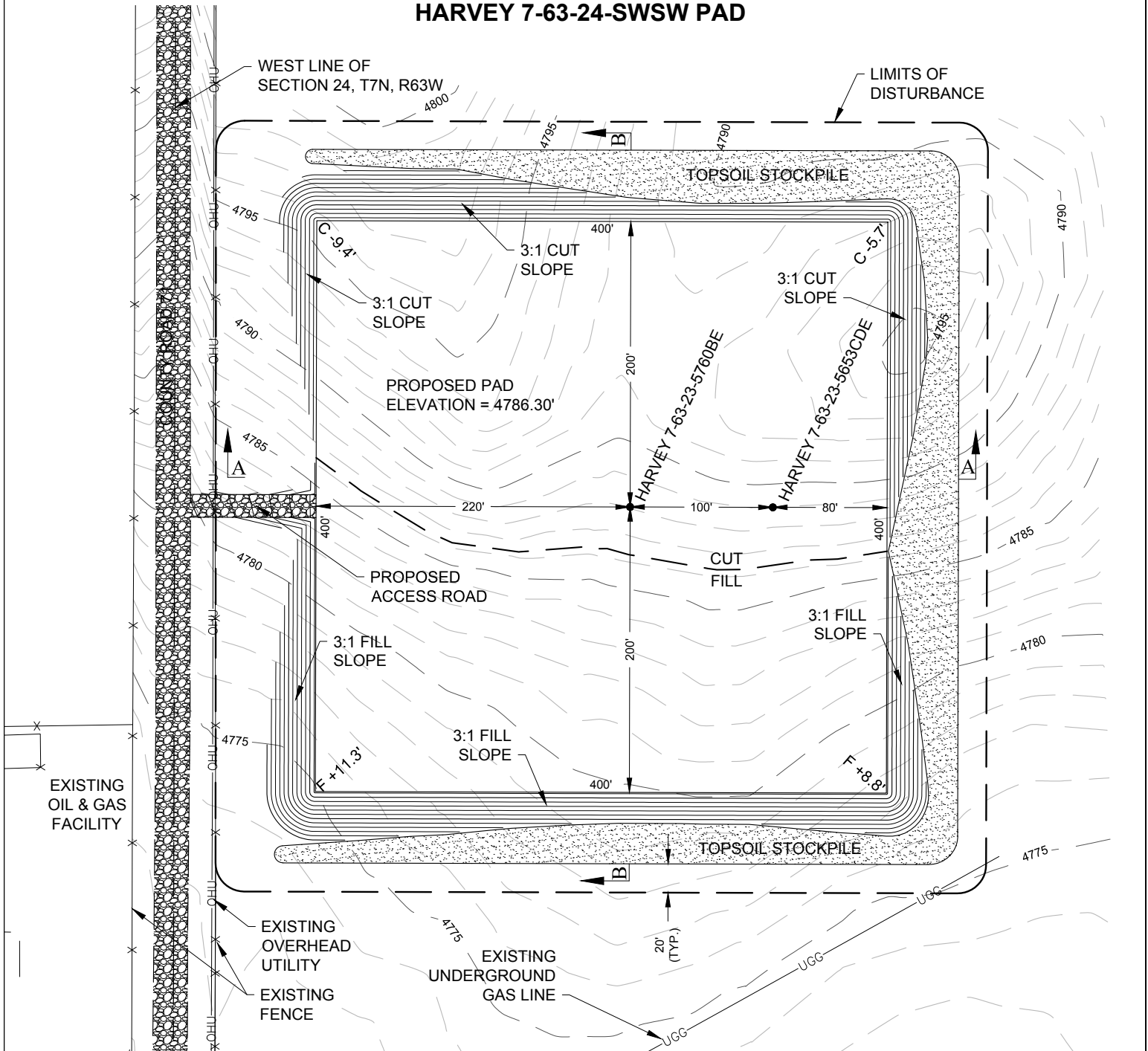

EXHIBIT A

HARVEY 7-63-24-SWSW PAD



NOTES:

1. A COMPLETE UTILITIES LOCATION IS RECOMMENDED BEFORE CONSTRUCTION.
2. GEOGRAPHIC POSITIONS/COORDINATES SHOWN HEREON ARE IN NAD83 DATUM.
3. EARTHWORK QUANTITIES ARE APPROXIMATE & FOR INFORMATION ONLY. 6" OF TOPSOIL HAS BEEN SUBTRACTED FROM EXISTING SURFACE PRIOR TO PERFORMING EARTHWORK CALCULATIONS.
4. STOCKPILES ARE ASSUMED TO BE 10' IN HEIGHT WITH 2:1 SIDE SLOPES.

DISCLAIMER:
THIS PLAN DOES NOT REPRESENT A MONUMENTED LAND SURVEY AND SHOULD NOT BE RELIED UPON TO DETERMINE BOUNDARY LINES, PROPERTY OWNERSHIP OR OTHER PROPERTY INTERESTS. PARCEL LINES, IF DEPICTED HAVE NOT BEEN FIELD VERIFIED AND MAY BE BASED UPON PUBLICLY AVAILABLE DATA THAT ALSO HAS NOT BEEN INDEPENDENTLY VERIFIED.

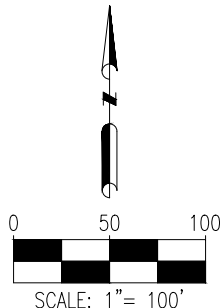

SITE QUANTITIES

FINISHED GRADE ELEVATION	4786.30'
TOTAL CUT FOR WELL PAD	18,000 CY
FILL FOR WELL PAD	16,365 CY
10% FILL FACTOR	1,635 CY
TOTAL FILL	18,000 CY

NET EXCESS MATERIAL 0 CY

TOPSOIL FROM GRADED AREA 3,660 CY
TOTAL DISTURBANCE AREA 6.7 ACRES

PREPARED BY:



FIELD DATE:

09-28-16

DRAWING DATE:

10-17-16

BY:

KAD

CHECKED BY:

MDC

SITE NAME:

HARVEY 7-63-24-SWSW PAD

SURFACE LOCATION:

SW 1/4 SW 1/4 SEC. 24, T7N, R63W, 6TH P.M.

WELD COUNTY, COLORADO

PREPARED FOR:



HARVEY 7-63-24-SWSW PAD CROSS SECTIONS

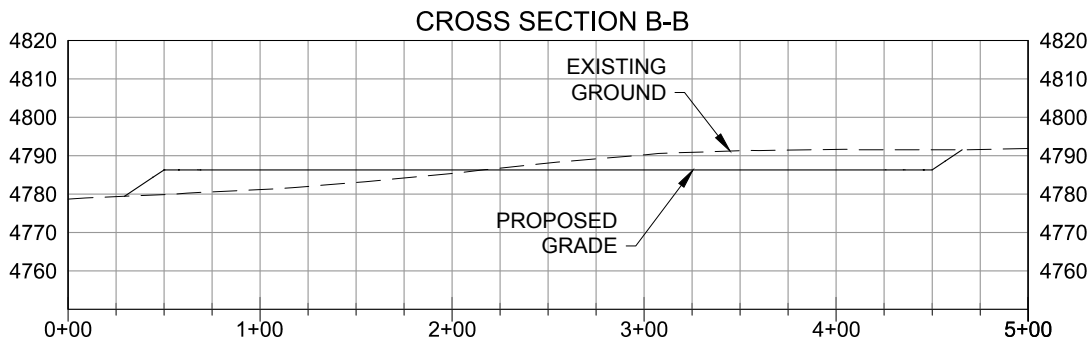
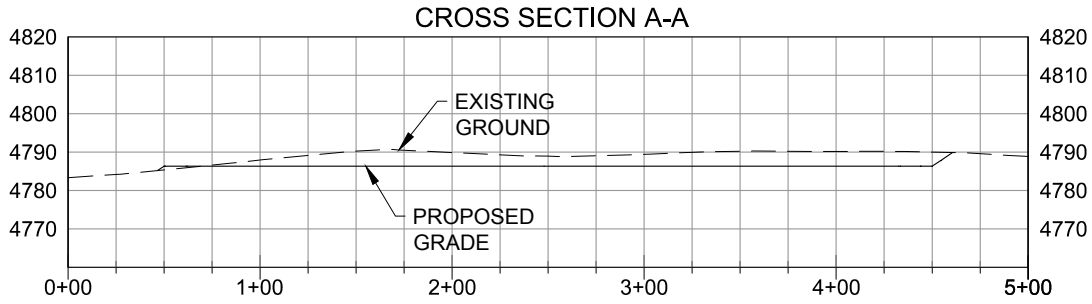

0 50 100
SCALE: 1" = 100'
VERT SCALE: 1" = 50'

DISCLAIMER:
THIS PLOT DOES NOT REPRESENT A MONUMENTED LAND SURVEY AND SHOULD NOT BE
RELIED UPON TO DETERMINE BOUNDARY LINES, PROPERTY OWNERSHIP OR OTHER
PROPERTY INTERESTS. PARCEL LINES, IF DEPICTED HAVE NOT BEEN FIELD VERIFIED AND
MAY BE BASED UPON PUBLICLY AVAILABLE DATA THAT ALSO HAS NOT BEEN
INDEPENDENTLY VERIFIED.

NOTE:

1. A COMPLETE UTILITIES LOCATION IS RECOMMENDED BEFORE CONSTRUCTION.

PREPARED BY:



FIELD DATE:

09-28-16

DRAWING DATE:

10-17-16

BY:
KAD

CHECKED BY:
MDC

SITE NAME:

HARVEY 7-63-24-SWSW PAD

SURFACE LOCATION:

SW 1/4 SW 1/4 SEC. 24, T7N, R63W, 6TH P.M.

WELD COUNTY, COLORADO

PREPARED FOR:



HARVEY 7-63-24-SWSW PAD PRODUCTION LAYOUT

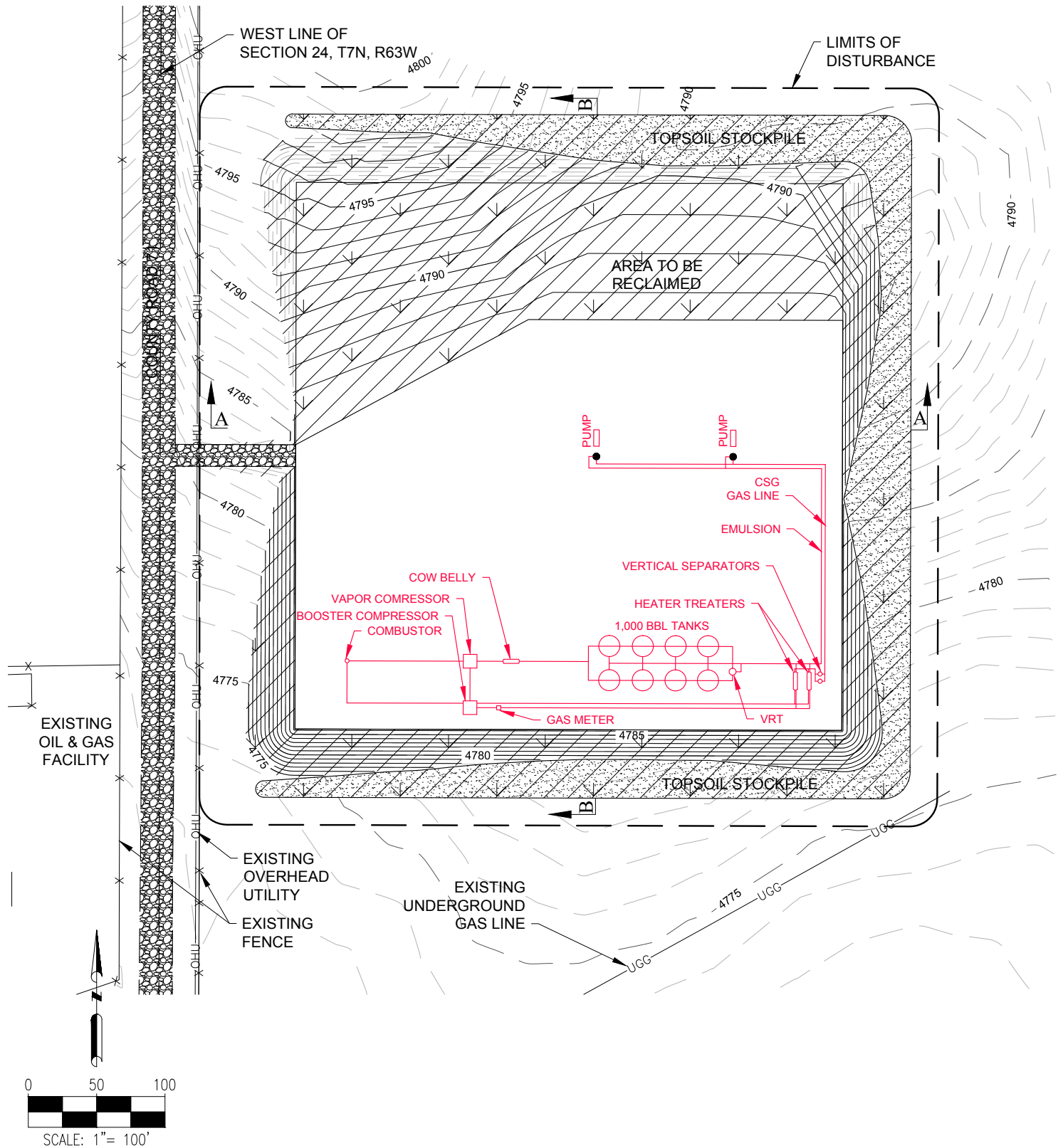

DISCLAIMER:
THIS PLOT DOES NOT REPRESENT A MONUMENTED LAND SURVEY AND SHOULD NOT BE
RELIED UPON TO DETERMINE BOUNDARY LINES, PROPERTY OWNERSHIP OR OTHER
PROPERTY INTERESTS. PARCEL LINES, IF DEPICTED HAVE NOT BEEN FIELD VERIFIED AND
MAY BE BASED UPON PUBLICLY AVAILABLE DATA THAT ALSO HAS NOT BEEN
INDEPENDENTLY VERIFIED.

NOTE:

1. A COMPLETE UTILITIES LOCATION IS RECOMMENDED BEFORE CONSTRUCTION.

PREPARED BY:



FIELD DATE:

09-28-16

DRAWING DATE:

10-17-16

BY:
KAD

CHECKED BY:
MDC

SITE NAME:

HARVEY 7-63-24-SWSW PAD

SURFACE LOCATION:

SW 1/4 SW 1/4 SEC. 24, T7N, R63W, 6TH P.M.

WELD COUNTY, COLORADO

PREPARED FOR:

