

# FRANE SURVEYING INC.

Physical Address: 34834 Annie Cir.  
Mail to: Box 2372, Elizabeth, CO 80107  
Ph. 303-243-0037  
www.franesurveying.com

Job # 078-16 The Searchers 2-25

Frane Surveying, in accordance with a request from **Grand Mesa Operating** has determined the location of **The Searchers 2-25** to be **2613 Feet FNL**, and **770 Feet FEL**, (90° off Section lines) of Section **25**, Township **5s**, Range **54w** of the 6th Principal Meridian, **Washington County**, Colorado.

Date: Staked on 03/10/17 drawn on 03/14/17.

Re:

Staked by Elijah Frane

Drawn:

Drawn by Elijah Frane

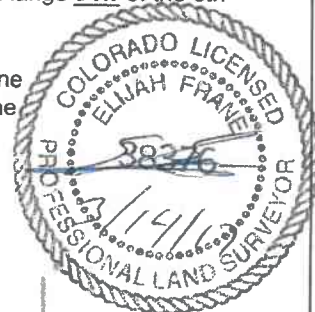

## Location Drawing

The center of an Oil Well road falls approx. 27' South of proposed well head, The Searchers Tank Battery site falls approx. 413' East of the proposed well pad.

Grand Mesa Operating  
NE 1/4 SEC. 25-5s-54w  
The Searchers #2-25  
Washington, Co. COLORADO

25

