

T9S

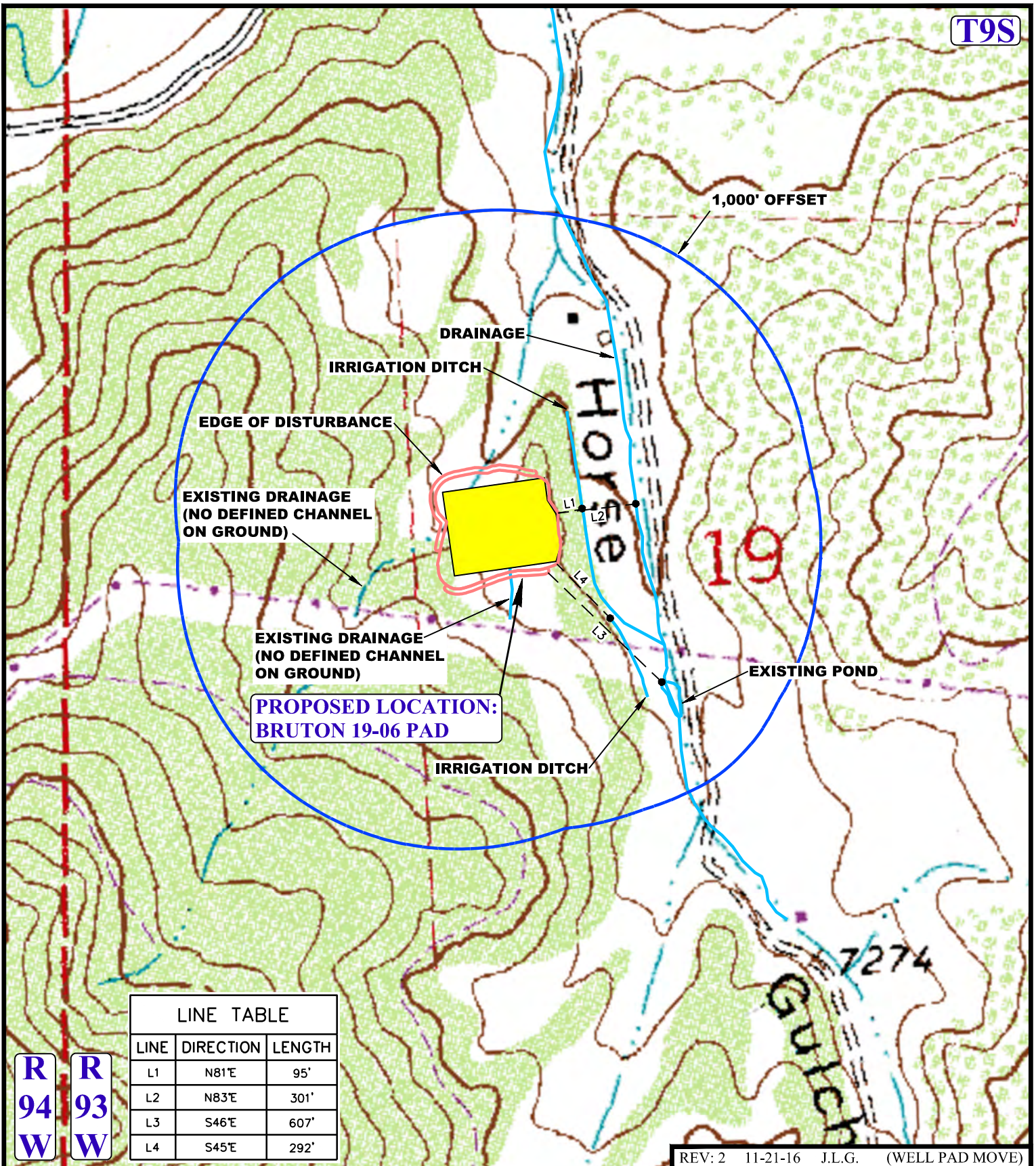

LINE TABLE		
LINE	DIRECTION	LENGTH
L1	N81°E	95'
L2	N83°E	301'
L3	S46°E	607'
L4	S45°E	292'

R
94
W

R
93
W

REV: 2 11-21-16 J.L.G. (WELL PAD MOVE)

LEGEND:

- 1000' OFFSET BOUNDARY (FROM EDGE OF DISTURBANCE)
- EXISTING DRAINAGE
- EDGE OF DISTURBANCE



LARAMIE ENERGY, LLC

BRUTON 19-06 PAD
SE 1/4 NW 1/4 SECTION 19, T9S, R93W, 6th P.M.
MESA COUNTY, COLORADO



UELS, LLC
Corporate Office * 85 South 200 East
Vernal, UT 84078 * (435) 789-1017

SURVEYED BY	G.M., N.F.	04-01-15	SCALE
DRAWN BY	B.D.	04-28-15	1 : 6,000
HYDROLOGY MAP			TOPO W