



Lat40°, Inc. 6250 W. 10th Street, Unit 2, Greeley, CO 970-515-5294

HYDROLOGY MAP

STELLA 5N65W22 1-4 PAD

SECTION: 22
TOWNSHIP: 5N
RANGE: 65W
6TH. P.M.
WELD COUNTY, CO

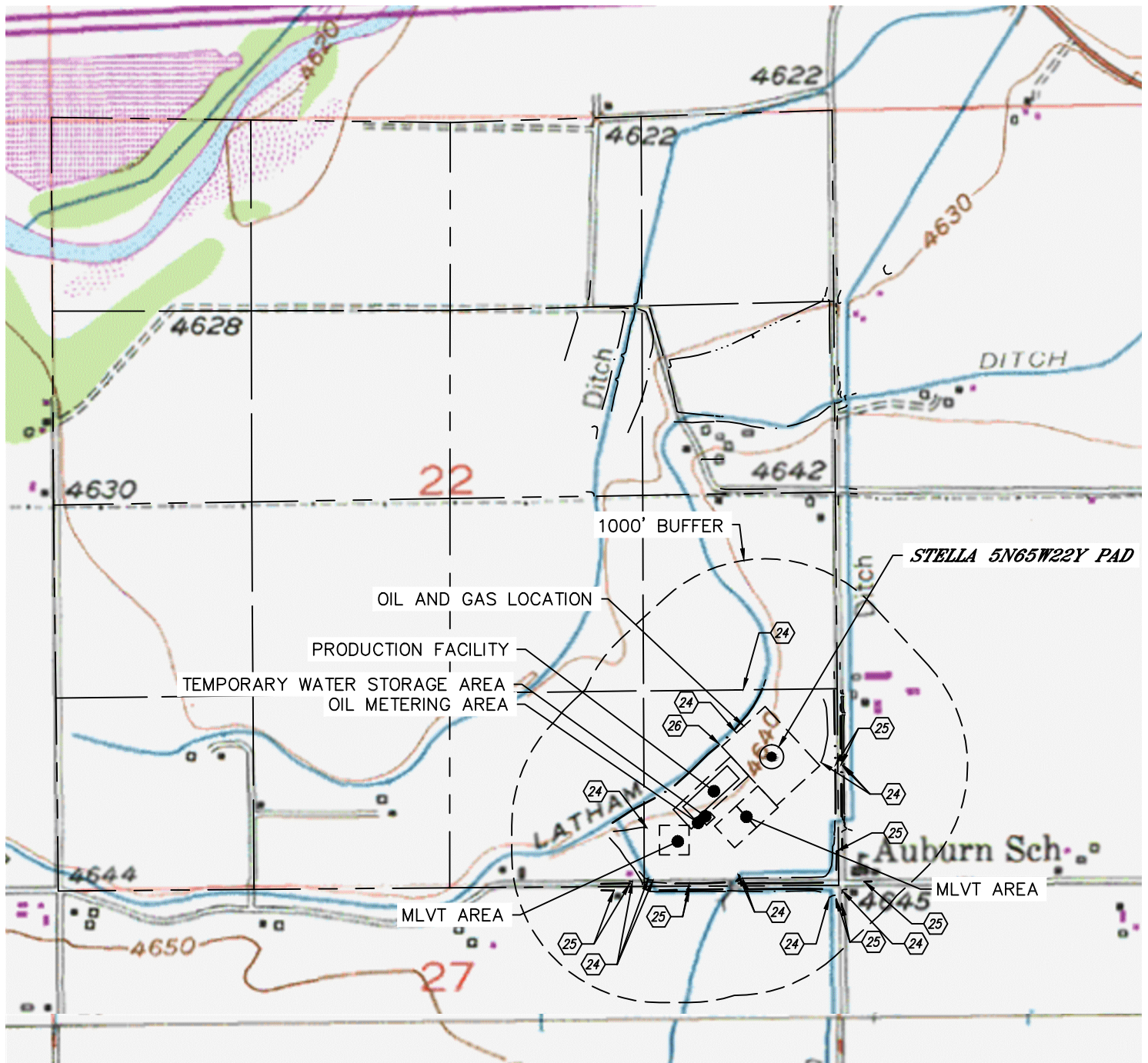

DISTANCES MEASURED FROM THE EDGE OF THE OIL AND GAS LOCATION.

- 24 DITCH 5' & 185' NW, 21' NE, 150' & 162' E, 86' W, 176', 177' & 257' SW, 184' & 214' S, 682' & 707' SE
- 25 BORROW DITCH 194' & 235' S, 104', 142' E, 279' & 392' SW, 494', 727', 770' & 771' SE
- 26 LATHAM DITCH 21' NW

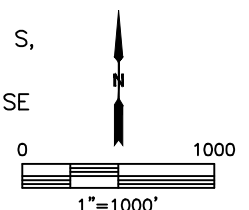

NEAREST DOWN GRADIENT SURFACE WATER: DITCH 5' NW

DATE: 1/13/2017
PROJECT#: 2016091