

PHOTO: VIEW FROM CORNER #1 TO LOCATION STAKES

CAMERA ANGLE: SOUTHERLY

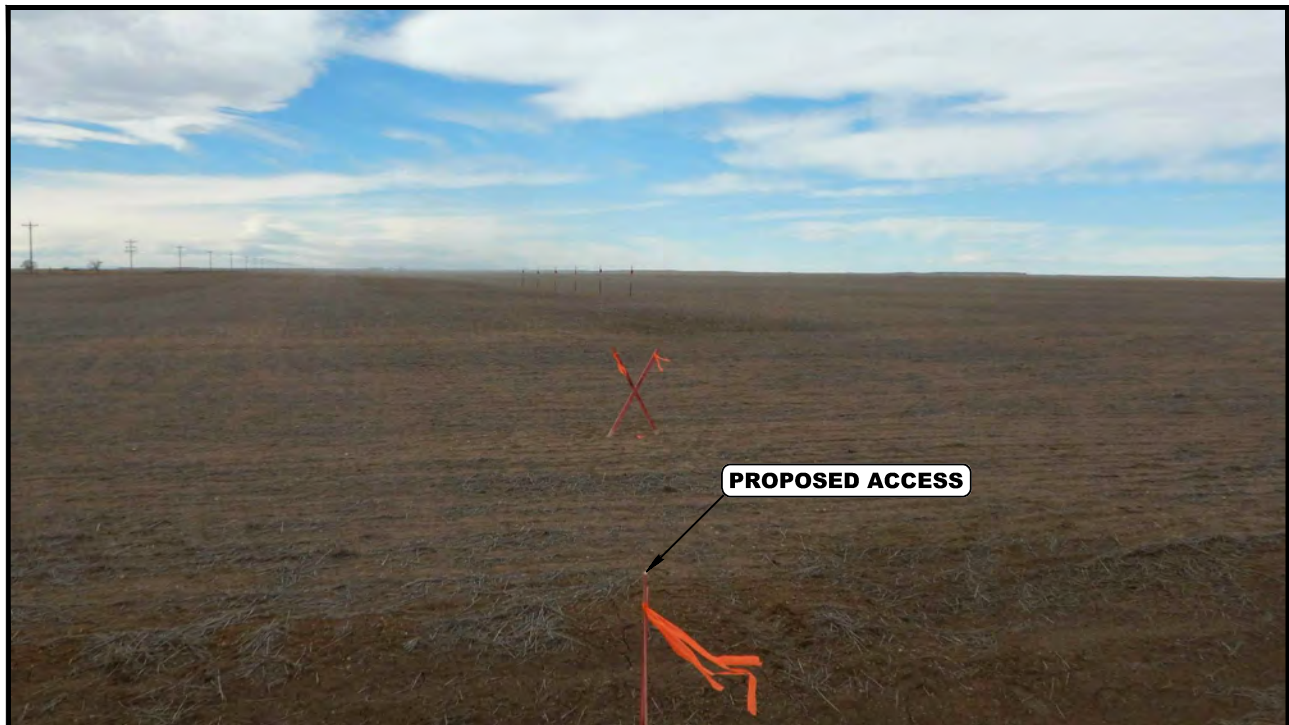

PHOTO: VIEW FROM BEGINNING OF PROPOSED ACCESS

CAMERA ANGLE: WESTERLY

REV: 2 02-22-17 B.R. (ADD WELLS, COMPANY NAME, PAD & WELL CHANGE)

## FIFTH CREEK ENERGY COMPANY, LLC

RANDALL CREEK 29 SESE  
SE 1/4 SE 1/4, SECTION 29, T12N, R62W, 6th P.M.  
WELD COUNTY, COLORADO

UELS, LLC

Corporate Office \* 85 South 200 East  
Vernal, UT 84078 \* (435) 789-1017

TAKEN BY	G.W., J.S.	02-10-17	
DRAWN BY	C.R.	01-27-15	
LOCATION PHOTOS			PHOTO 1





PHOTO: VIEW OF LOCATION STAKE

CAMERA ANGLE: NORTHERLY



PHOTO: VIEW OF LOCATION STAKES

CAMERA ANGLE: EASTERLY

REV: 2 02-22-17 B.R. (ADD WELLS, COMPANY NAME & WELL CHANGE)

## FIFTH CREEK ENERGY COMPANY, LLC

RANDALL CREEK 29 SESE  
SE 1/4 SE 1/4, SECTION 29, T12N, R62W, 6th P.M.  
WELD COUNTY, COLORADO

UELS, LLC

Corporate Office \* 85 South 200 East  
Vernal, UT 84078 \* (435) 789-1017

TAKEN BY	G.W., J.S.	02-10-17	
DRAWN BY	C.R.	01-27-15	
LOCATION PHOTOS			PHOTO 2







PHOTO: VIEW OF LOCATION STAKES

CAMERA ANGLE: SOUTHERLY



PHOTO: VIEW OF LOCATION STAKES

CAMERA ANGLE: WESTERLY

REV: 2 02-22-17 B.R. (ADD WELLS, COMPANY NAME & WELL CHANGE)

## FIFTH CREEK ENERGY COMPANY, LLC

RANDALL CREEK 29 SESE  
SE 1/4 SE 1/4, SECTION 29, T12N, R62W, 6th P.M.  
WELD COUNTY, COLORADO

UELS, LLC

Corporate Office \* 85 South 200 East  
Vernal, UT 84078 \* (435) 789-1017

TAKEN BY	G.W., J.S.	02-10-17	
DRAWN BY	C.R.	01-27-15	
LOCATION PHOTOS			PHOTO 3

