

Physical Address: 345 Comanche St.
Mail to: Box 384 Kiowa, CO 80117
Ph. 303-621-8672 - Fax 303-621-7749
www.highprairiesurvey.com

Job # 14164 MARY JANE #13-5

Inv # 3499

High Prairie Surveying of Kiowa, Colorado, in accordance with a request from **Nighthawk Production LLC**, has determined the location of **MARY JANE #13-5** to be **814 feet FSL**, and **642 feet FWL** (90° off Section lines) of Section **5**, Township **7s**, Range **54w** of the 6th Principal Meridian, **Lincoln County**, Colorado.

Date: Staked on 10/04/14 drawn on 10/08/14.

Re: Staked by Elijah Frane
Drawn: Drawn by Dustin Cotter

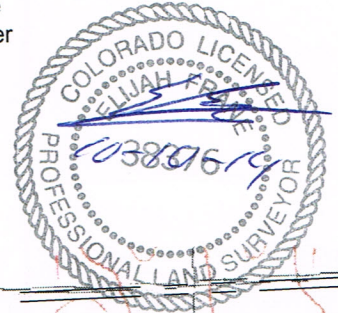

Access Road Map

