

EXTRACTION OIL & GAS

Location: COLORADO Slot: SLOT#05 MATRIX E-29HN (462'FSL & 2348'FWL SEC.29)
Field: WELD COUNTY (NAD83/TRUE NORTH) Well: MATRIX E-29HN
Facility: SEC.29-T06N-R65W Wellbore: MATRIX E-29HN PWB

Plot reference wellpath is MATRIX E-29HN REV-A.0 PWP	Grid System: NAD83 / Lambert Colorado SP, Northern Zone (501), US feet
True vertical depths are referenced to H&P 321 (RKB)	* = Wellpath was transformed from a different geodetic datum
Measured depths are referenced to H&P 321 (RKB)	North Reference: True north
H&P 321 (RKB) to Mean Sea Level: 4737 feet	Scale: True distance
Mean Sea Level to Mud line (At Slot: SLOT#05 MATRIX E-29HN (462'FSL & 2348'FWL SEC.29)): 0 feet	Depths are in feet
Coordinates are in feet referenced to Slot	Created by: hutaedr on 2017-02-21
	Database: WA_DEN_Denver_Defn

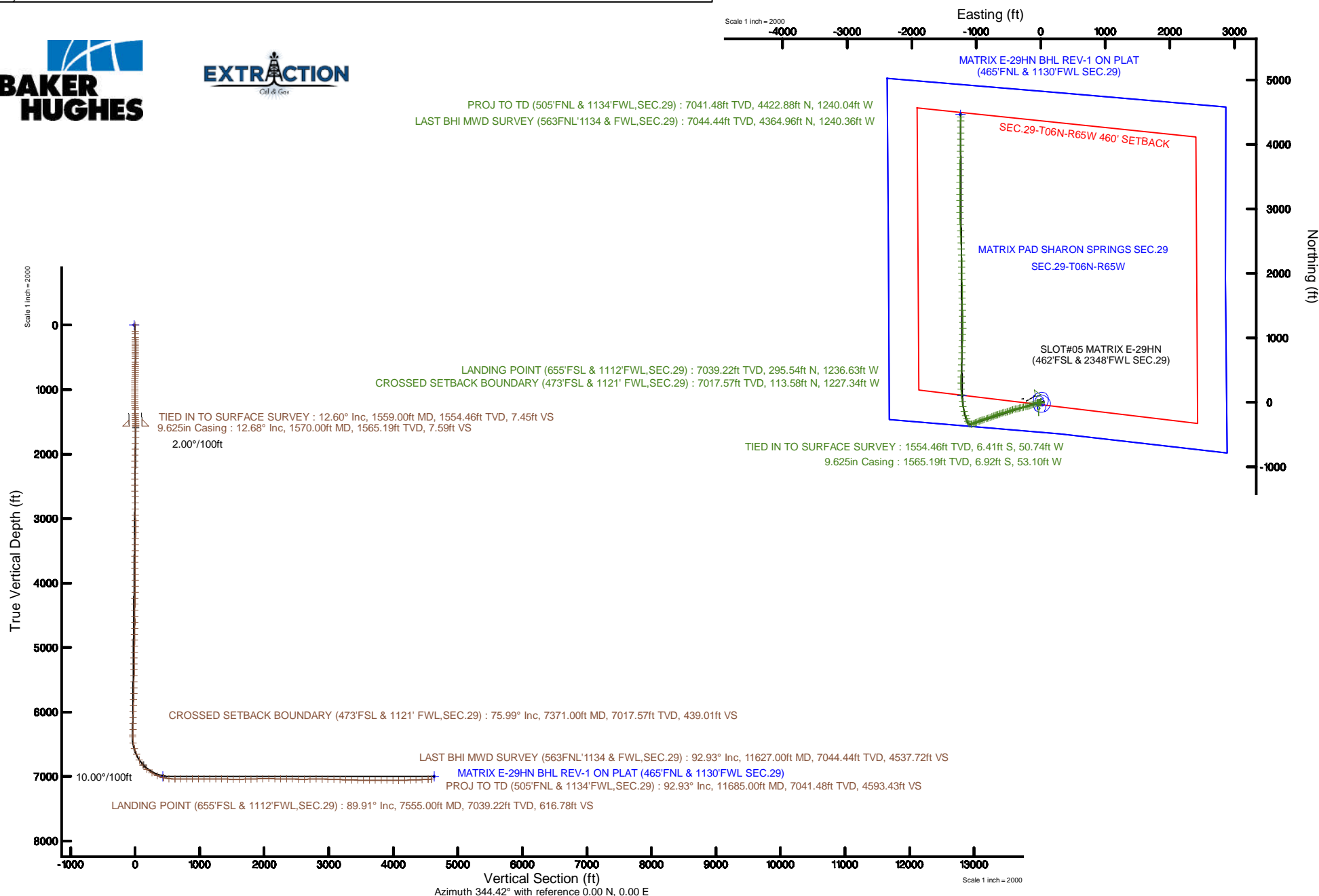

REFERENCE WELLPATH IDENTIFICATION			
Operator	EXTRACTION OIL & GAS	Slot	SLOT#05 MATRIX E-29HN (462'FSL & 2348'FWL SEC.29)
Area	COLORADO	Well	MATRIX E-29HN
Field	WELD COUNTY (NAD83/TRUE NORTH)	Wellbore	MATRIX E-29HN AWP
Facility	SEC.29-T06N-R65W		

REPORT SETUP INFORMATION			
Projection System	NAD83 / Lambert Colorado SP, Northern Zone (501), US feet	Software System	WellArchitect® 5.0
North Reference	True	User	Hutaedr
Scale	0.999963	Report Generated	21/Feb/2017 at 14:50
Convergence at slot	0.53° East	Database/Source file	WA_DEN_Denver_Defn/MATRIX_E-29HN_AWP.xml

WELLPATH LOCATION						
	Local coordinates		Grid coordinates		Geographic coordinates	
	North[ft]	East[ft]	Easting[US ft]	Northing[US ft]	Latitude	Longitude
Slot Location	30.66	51.49	3225893.89	1408787.80	40°27'09.670"N	104°41'17.804"W
Facility Reference Pt			3225842.68	1408756.67	40°27'09.367"N	104°41'18.470"W
Field Reference Pt			3185481.27	1419166.81	40°28'55.560"N	104°49'59.556"W

WELLPATH DATUM			
Calculation method	Minimum curvature	H&P 321 (RKB) to Facility Vertical Datum	4737.00ft
Horizontal Reference Pt	Slot	H&P 321 (RKB) to Mean Sea Level	4737.00ft
Vertical Reference Pt	H&P 321 (RKB)	H&P 321 (RKB) to Mud Line at Slot (SLOT#05 MATRIX E-29HN (462'FSL & 2348'FWL SEC.29))	4737.00ft
MD Reference Pt	H&P 321 (RKB)	Section Origin	N 0.00, E 0.00 ft
Field Vertical Reference	Mean Sea Level	Section Azimuth	344.34°

REFERENCE WELLPATH IDENTIFICATION

Operator	EXTRACTION OIL & GAS	Slot	SLOT#05 MATRIX E-29HN (462'FSL & 2348'FWL SEC.29)
Area	COLORADO	Well	MATRIX E-29HN
Field	WELD COUNTY (NAD83/TRUE NORTH)	Wellbore	MATRIX E-29HN AWB
Facility	SEC.29-T06N-R65W		

WELLPATH DATA (154 stations)

MD [ft]	Inclination [°]	Azimuth [°]	TVD [ft]	Vert Sect [ft]	North [ft]	East [ft]	Latitude	Longitude	DLS [°/100ft]	Comments
0.00	0.000	46.500	0.00	0.00	0.00	0.00	40°27'09.670"N	104°41'17.804"W	0.00	
100.00	0.800	46.500	100.00	0.33	0.48	0.51	40°27'09.675"N	104°41'17.797"W	0.80	
131.00	0.800	35.000	130.99	0.56	0.81	0.79	40°27'09.678"N	104°41'17.794"W	0.52	
195.00	1.100	40.200	194.98	1.19	1.64	1.44	40°27'09.686"N	104°41'17.785"W	0.49	
227.00	1.100	33.400	226.98	1.57	2.13	1.81	40°27'09.691"N	104°41'17.781"W	0.41	
259.00	1.100	34.400	258.97	1.96	2.64	2.15	40°27'09.696"N	104°41'17.776"W	0.06	
291.00	1.100	33.400	290.97	2.36	3.15	2.49	40°27'09.701"N	104°41'17.772"W	0.06	
322.00	1.000	5.700	321.96	2.81	3.67	2.68	40°27'09.706"N	104°41'17.769"W	1.65	
354.00	0.400	292.500	353.96	3.14	3.99	2.61	40°27'09.709"N	104°41'17.770"W	3.01	
386.00	1.000	248.200	385.96	3.18	3.93	2.25	40°27'09.709"N	104°41'17.775"W	2.40	
418.00	1.100	251.500	417.95	3.13	3.73	1.70	40°27'09.707"N	104°41'17.782"W	0.37	
450.00	1.100	241.500	449.95	3.05	3.48	1.13	40°27'09.704"N	104°41'17.789"W	0.60	
481.00	1.000	239.600	480.94	2.91	3.21	0.64	40°27'09.702"N	104°41'17.796"W	0.34	
513.00	1.100	218.800	512.94	2.66	2.83	0.21	40°27'09.698"N	104°41'17.801"W	1.22	
577.00	1.300	216.100	576.92	1.86	1.76	-0.61	40°27'09.687"N	104°41'17.812"W	0.32	
609.00	1.200	217.200	608.91	1.43	1.20	-1.02	40°27'09.682"N	104°41'17.817"W	0.32	
640.00	1.100	211.600	639.91	1.03	0.69	-1.38	40°27'09.677"N	104°41'17.822"W	0.48	
672.00	1.200	204.200	671.90	0.57	0.12	-1.67	40°27'09.671"N	104°41'17.826"W	0.56	
704.00	1.100	201.000	703.90	0.06	-0.47	-1.92	40°27'09.665"N	104°41'17.829"W	0.37	
736.00	1.200	198.800	735.89	-0.46	-1.08	-2.14	40°27'09.659"N	104°41'17.832"W	0.34	
768.00	1.200	195.600	767.88	-1.02	-1.72	-2.34	40°27'09.653"N	104°41'17.834"W	0.21	
800.00	1.400	192.200	799.87	-1.65	-2.42	-2.51	40°27'09.646"N	104°41'17.836"W	0.67	
832.00	1.600	188.000	831.86	-2.41	-3.25	-2.66	40°27'09.638"N	104°41'17.838"W	0.71	
863.00	1.500	178.600	862.85	-3.20	-4.08	-2.71	40°27'09.630"N	104°41'17.839"W	0.88	
895.00	1.200	164.500	894.84	-3.94	-4.82	-2.61	40°27'09.622"N	104°41'17.838"W	1.39	
927.00	1.100	98.800	926.84	-4.40	-5.19	-2.21	40°27'09.619"N	104°41'17.833"W	3.91	
959.00	2.000	75.600	958.83	-4.54	-5.10	-1.37	40°27'09.620"N	104°41'17.822"W	3.37	
991.00	2.500	69.700	990.80	-4.50	-4.72	-0.17	40°27'09.623"N	104°41'17.806"W	1.72	
1023.00	2.700	69.200	1022.77	-4.37	-4.21	1.19	40°27'09.628"N	104°41'17.789"W	0.63	
1054.00	2.600	66.000	1053.73	-4.20	-3.66	2.51	40°27'09.634"N	104°41'17.772"W	0.58	
1086.00	1.200	55.600	1085.72	-3.99	-3.18	3.45	40°27'09.639"N	104°41'17.759"W	4.49	
1118.00	0.400	271.400	1117.71	-3.85	-2.99	3.62	40°27'09.640"N	104°41'17.757"W	4.82	
1150.00	2.200	265.000	1149.70	-3.71	-3.04	2.89	40°27'09.640"N	104°41'17.767"W	5.63	
1182.00	3.200	270.000	1181.67	-3.35	-3.09	1.39	40°27'09.639"N	104°41'17.786"W	3.21	
1212.00	3.700	270.700	1211.61	-2.85	-3.08	-0.42	40°27'09.640"N	104°41'17.809"W	1.67	
1243.00	3.900	269.200	1242.55	-2.30	-3.08	-2.47	40°27'09.640"N	104°41'17.836"W	0.72	
1275.00	4.600	264.100	1274.46	-1.80	-3.23	-4.84	40°27'09.638"N	104°41'17.867"W	2.48	
1307.00	6.100	263.400	1306.32	-1.32	-3.56	-7.80	40°27'09.635"N	104°41'17.905"W	4.69	
1369.00	8.200	269.500	1367.83	0.36	-3.97	-15.50	40°27'09.631"N	104°41'18.004"W	3.60	
1401.00	8.800	266.200	1399.48	1.46	-4.16	-20.22	40°27'09.629"N	104°41'18.066"W	2.42	
1432.00	10.100	265.100	1430.06	2.45	-4.54	-25.30	40°27'09.625"N	104°41'18.131"W	4.23	
1464.00	11.300	267.700	1461.50	3.70	-4.91	-31.22	40°27'09.621"N	104°41'18.208"W	4.04	
1496.00	11.800	266.900	1492.86	5.14	-5.21	-37.62	40°27'09.618"N	104°41'18.291"W	1.64	
1528.00	12.000	267.000	1524.17	6.58	-5.56	-44.21	40°27'09.615"N	104°41'18.376"W	0.63	
1559.00	12.600	258.400	1554.46	7.52	-6.41	-50.74	40°27'09.607"N	104°41'18.460"W	6.21	TIED IN TO SURFACE SURVEY

REFERENCE WELLPATH IDENTIFICATION

Operator	EXTRACTION OIL & GAS	Slot	SLOT#05 MATRIX E-29HN (462'FSL & 2348'FWL SEC.29)
Area	COLORADO	Well	MATRIX E-29HN
Field	WELD COUNTY (NAD83/TRUE NORTH)	Wellbore	MATRIX E-29HN AWB
Facility	SEC.29-T06N-R65W		

WELLPATH DATA (154 stations)

MD [ft]	Inclination [°]	Azimuth [°]	TVD [ft]	Vert Sect [ft]	North [ft]	East [ft]	Latitude	Longitude	DLS [°/100ft]	Comments
1655.00	13.480	249.480	1647.99	7.32	-12.44	-71.48	40°27'09.547"N	104°41'18.729"W	2.29	
1749.00	12.480	247.930	1739.59	5.26	-20.10	-91.16	40°27'09.471"N	104°41'18.983"W	1.13	
1844.00	12.130	248.240	1832.41	3.05	-27.65	-109.94	40°27'09.397"N	104°41'19.226"W	0.37	
1939.00	11.100	244.940	1925.46	0.50	-35.23	-127.49	40°27'09.322"N	104°41'19.453"W	1.29	
2034.00	12.290	250.720	2018.49	-1.63	-42.44	-145.32	40°27'09.251"N	104°41'19.684"W	1.76	
2129.00	11.540	249.820	2111.44	-3.02	-49.06	-163.79	40°27'09.185"N	104°41'19.923"W	0.81	
2223.00	12.900	256.500	2203.32	-3.37	-54.75	-182.82	40°27'09.129"N	104°41'20.169"W	2.08	
2318.00	11.730	255.580	2296.13	-2.76	-59.63	-202.48	40°27'09.081"N	104°41'20.423"W	1.25	
2412.00	12.390	251.470	2388.05	-3.05	-65.22	-221.30	40°27'09.026"N	104°41'20.667"W	1.15	
2507.00	14.270	257.320	2480.50	-2.95	-71.03	-242.39	40°27'08.968"N	104°41'20.939"W	2.43	
2602.00	13.510	256.790	2572.72	-1.87	-76.13	-264.61	40°27'08.918"N	104°41'21.227"W	0.81	
2697.00	13.210	259.050	2665.15	-0.50	-80.73	-286.07	40°27'08.872"N	104°41'21.504"W	0.63	
2792.00	13.630	256.770	2757.55	0.86	-85.35	-307.63	40°27'08.827"N	104°41'21.783"W	0.71	
2887.00	13.720	255.890	2849.86	1.64	-90.66	-329.45	40°27'08.774"N	104°41'22.066"W	0.24	
2982.00	12.260	253.100	2942.43	1.73	-96.34	-350.03	40°27'08.718"N	104°41'22.332"W	1.67	
3077.00	13.890	261.310	3034.97	2.90	-101.00	-370.95	40°27'08.672"N	104°41'22.602"W	2.60	
3171.00	14.480	254.400	3126.11	4.28	-105.86	-393.43	40°27'08.624"N	104°41'22.893"W	1.91	
3266.00	12.920	250.660	3218.41	3.61	-112.57	-414.89	40°27'08.558"N	104°41'23.171"W	1.89	
3360.00	11.130	248.360	3310.34	1.99	-119.40	-433.24	40°27'08.490"N	104°41'23.408"W	1.97	
3455.00	11.900	251.900	3403.43	0.62	-125.82	-451.07	40°27'08.427"N	104°41'23.639"W	1.10	
3550.00	13.350	252.300	3496.13	-0.19	-132.20	-470.83	40°27'08.364"N	104°41'23.894"W	1.53	
3644.00	11.820	250.250	3587.87	-1.26	-138.76	-490.23	40°27'08.299"N	104°41'24.145"W	1.70	
3739.00	11.010	248.640	3680.99	-2.85	-145.35	-507.84	40°27'08.234"N	104°41'24.373"W	0.92	
3834.00	13.060	260.120	3773.91	-2.67	-150.49	-526.87	40°27'08.183"N	104°41'24.619"W	3.31	
3929.00	12.810	260.120	3866.50	-0.53	-154.14	-547.82	40°27'08.147"N	104°41'24.890"W	0.26	
4023.00	14.110	253.740	3957.92	0.40	-159.14	-569.09	40°27'08.097"N	104°41'25.165"W	2.10	
4118.00	13.750	253.530	4050.13	0.12	-165.58	-591.03	40°27'08.034"N	104°41'25.449"W	0.38	
4213.00	12.490	252.330	4142.64	-0.40	-171.90	-611.65	40°27'07.971"N	104°41'25.716"W	1.36	
4308.00	11.110	250.500	4235.63	-1.37	-178.08	-630.06	40°27'07.910"N	104°41'25.954"W	1.50	
4402.00	11.440	247.950	4327.82	-3.02	-184.60	-647.24	40°27'07.846"N	104°41'26.176"W	0.64	
4496.00	10.420	247.820	4420.11	-5.02	-191.31	-663.75	40°27'07.779"N	104°41'26.390"W	1.09	
4591.00	8.370	263.310	4513.85	-4.92	-195.36	-678.58	40°27'07.739"N	104°41'26.582"W	3.41	
4686.00	9.330	254.080	4607.72	-3.87	-198.28	-692.85	40°27'07.711"N	104°41'26.766"W	1.80	
4780.00	10.560	239.460	4700.32	-6.12	-204.74	-707.60	40°27'07.647"N	104°41'26.957"W	2.98	
4876.00	10.700	247.660	4794.68	-9.41	-212.60	-723.42	40°27'07.569"N	104°41'27.162"W	1.58	
4970.00	12.180	255.700	4886.82	-10.19	-218.37	-741.10	40°27'07.512"N	104°41'27.390"W	2.31	
5064.00	14.920	248.440	4978.20	-11.20	-225.27	-761.97	40°27'07.444"N	104°41'27.660"W	3.43	
5159.00	14.020	247.300	5070.18	-13.87	-234.20	-783.96	40°27'07.356"N	104°41'27.945"W	0.99	
5254.00	15.070	255.180	5162.15	-15.10	-241.80	-806.52	40°27'07.280"N	104°41'28.237"W	2.36	
5348.00	12.250	255.680	5253.48	-14.68	-247.40	-828.00	40°27'07.225"N	104°41'28.514"W	3.00	
5443.00	15.000	249.540	5345.80	-15.48	-254.19	-849.29	40°27'07.158"N	104°41'28.790"W	3.27	
5538.00	12.480	250.390	5438.08	-17.21	-261.93	-870.48	40°27'07.082"N	104°41'29.064"W	2.66	
5633.00	14.920	251.330	5530.37	-18.56	-269.29	-891.74	40°27'07.009"N	104°41'29.339"W	2.58	
5728.00	12.460	254.110	5622.66	-19.24	-276.01	-913.19	40°27'06.942"N	104°41'29.616"W	2.68	
5822.00	14.610	249.000	5714.05	-20.39	-283.04	-934.01	40°27'06.873"N	104°41'29.886"W	2.62	

REFERENCE WELLPATH IDENTIFICATION			
Operator	EXTRACTION OIL & GAS	Slot	SLOT#05 MATRIX E-29HN (462'FSL & 2348'FWL SEC.29)
Area	COLORADO	Well	MATRIX E-29HN
Field	WELD COUNTY (NAD83/TRUE NORTH)	Wellbore	MATRIX E-29HN AWB
Facility	SEC.29-T06N-R65W		

WELLPATH DATA (154 stations) † = interpolated/extrapolated station											
MD [ft]	Inclination [°]	Azimuth [°]	TVD [ft]	Vert Sect [ft]	North [ft]	East [ft]	Latitude	Longitude	DLS [°/100ft]	Comments	
5917.00	12.660	242.490	5806.37	-23.64	-292.14	-954.43	40°27'06.783"N	104°41'30.150"W	2.61		
6012.00	14.370	250.000	5898.74	-26.67	-300.99	-974.75	40°27'06.696"N	104°41'30.413"W	2.58		
6107.00	12.430	247.120	5991.16	-28.85	-308.99	-995.25	40°27'06.616"N	104°41'30.678"W	2.16		
6202.00	11.780	246.990	6084.04	-31.37	-316.76	-1013.59	40°27'06.540"N	104°41'30.915"W	0.68		
6296.00	10.070	256.080	6176.34	-32.35	-322.49	-1030.40	40°27'06.483"N	104°41'31.133"W	2.58		
6391.00	12.140	246.300	6269.57	-33.49	-328.50	-1047.62	40°27'06.424"N	104°41'31.355"W	2.94		
6486.00	14.300	256.460	6362.06	-34.45	-335.27	-1068.17	40°27'06.357"N	104°41'31.621"W	3.33		
6511.00	13.500	256.360	6386.32	-34.24	-336.68	-1074.01	40°27'06.343"N	104°41'31.697"W	3.20		
6606.00	13.640	286.030	6478.78	-27.95	-336.20	-1095.58	40°27'06.348"N	104°41'31.976"W	7.25		
6701.00	18.360	318.630	6570.26	-8.54	-321.84	-1116.29	40°27'06.489"N	104°41'32.243"W	10.49		
6795.00	21.140	336.000	6658.79	21.60	-295.22	-1132.98	40°27'06.753"N	104°41'32.459"W	6.88		
6890.00	32.250	338.810	6743.54	63.92	-255.81	-1149.16	40°27'07.142"N	104°41'32.669"W	11.77		
6985.00	38.710	339.850	6820.86	118.82	-204.24	-1168.58	40°27'07.652"N	104°41'32.920"W	6.83		
7079.00	49.390	346.190	6888.36	184.00	-141.78	-1187.29	40°27'08.269"N	104°41'33.162"W	12.28		
7175.00	58.570	349.240	6944.76	261.41	-65.98	-1203.67	40°27'09.018"N	104°41'33.374"W	9.90		
7269.00	68.610	353.480	6986.53	344.82	17.14	-1216.16	40°27'09.839"N	104°41'33.536"W	11.42		
7365.00	75.500	353.290	7016.09	434.96	107.80	-1226.68	40°27'10.735"N	104°41'33.672"W	7.18		
7371.00†	75.989	353.577	7017.57	440.70	113.58	-1227.34	40°27'10.792"N	104°41'33.680"W	9.38	CROSSED SETBACK BOUNDARY (473'FSL & 1121' FWL, SEC.29)	
7460.00	83.280	357.710	7033.58	526.46	200.80	-1233.95	40°27'11.654"N	104°41'33.766"W	9.38		
7555.00	89.910	359.040	7039.22	618.41	295.54	-1236.63	40°27'12.590"N	104°41'33.801"W	7.12	LANDING POINT (655'FSL & 1112'FWL, SEC.29)	
7650.00	90.740	2.670	7038.68	709.47	390.51	-1235.22	40°27'13.529"N	104°41'33.782"W	3.92		
7744.00	91.080	2.480	7037.18	798.74	484.40	-1230.99	40°27'14.456"N	104°41'33.728"W	0.41		
7839.00	88.520	1.620	7037.52	889.23	579.33	-1227.60	40°27'15.394"N	104°41'33.684"W	2.84		
7934.00	89.810	1.820	7038.90	979.88	674.28	-1224.75	40°27'16.333"N	104°41'33.647"W	1.37		
8029.00	90.460	2.510	7038.68	1070.31	769.21	-1221.16	40°27'17.271"N	104°41'33.601"W	1.00		
8123.00	91.080	2.660	7037.41	1159.58	863.10	-1216.92	40°27'18.199"N	104°41'33.546"W	0.68		
8218.00	89.910	2.180	7036.59	1249.88	958.01	-1212.91	40°27'19.136"N	104°41'33.494"W	1.33		
8313.00	88.180	0.570	7038.18	1340.69	1052.97	-1210.63	40°27'20.075"N	104°41'33.465"W	2.49		
8408.00	87.690	0.370	7041.60	1431.89	1147.90	-1209.85	40°27'21.013"N	104°41'33.455"W	0.56		
8502.00	89.600	359.440	7043.82	1522.41	1241.87	-1210.00	40°27'21.941"N	104°41'33.457"W	2.26		
8597.00	90.550	358.770	7043.70	1614.27	1336.86	-1211.49	40°27'22.880"N	104°41'33.476"W	1.22		
8692.00	91.140	358.660	7042.30	1706.29	1431.82	-1213.62	40°27'23.818"N	104°41'33.504"W	0.63		
8786.00	91.790	357.940	7039.89	1797.48	1525.75	-1216.41	40°27'24.746"N	104°41'33.540"W	1.03		
8881.00	92.250	359.860	7036.54	1889.37	1620.67	-1218.23	40°27'25.684"N	104°41'33.563"W	2.08		
8975.00	92.500	0.000	7032.65	1979.83	1714.59	-1218.34	40°27'26.612"N	104°41'33.565"W	0.30		
9070.00	87.690	358.700	7032.49	2071.56	1809.55	-1219.42	40°27'27.551"N	104°41'33.579"W	5.24		
9165.00	88.120	358.450	7035.96	2163.58	1904.46	-1221.78	40°27'28.489"N	104°41'33.610"W	0.52		
9260.00	90.550	359.400	7037.07	2255.50	1999.43	-1223.56	40°27'29.427"N	104°41'33.633"W	2.75		
9354.00	90.180	0.200	7036.47	2346.10	2093.42	-1223.89	40°27'30.356"N	104°41'33.637"W	0.94		
9449.00	87.350	358.230	7038.52	2437.88	2188.38	-1225.19	40°27'31.294"N	104°41'33.654"W	3.63		
9544.00	87.570	358.780	7042.73	2529.90	2283.25	-1227.67	40°27'32.232"N	104°41'33.686"W	0.62		
9639.00	91.110	357.820	7043.82	2622.07	2378.19	-1230.49	40°27'33.170"N	104°41'33.722"W	3.86		
9733.00	92.710	357.730	7040.69	2713.44	2472.06	-1234.13	40°27'34.097"N	104°41'33.770"W	1.70		
9828.00	89.690	356.590	7038.70	2806.04	2566.91	-1238.84	40°27'35.035"N	104°41'33.831"W	3.40		
9922.00	88.430	357.930	7040.24	2897.65	2660.79	-1243.33	40°27'35.962"N	104°41'33.889"W	1.96		

REFERENCE WELLPATH IDENTIFICATION

Operator	EXTRACTION OIL & GAS	Slot	SLOT#05 MATRIX E-29HN (462'FSL & 2348'FWL SEC.29)
Area	COLORADO	Well	MATRIX E-29HN
Field	WELD COUNTY (NAD83/TRUE NORTH)	Wellbore	MATRIX E-29HN AWB
Facility	SEC.29-T06N-R65W		

WELLPATH DATA (154 stations)

MD [ft]	Inclination [°]	Azimuth [°]	TVD [ft]	Vert Sect [ft]	North [ft]	East [ft]	Latitude	Longitude	DLS [°/100ft]	Comments
10017.00	88.240	358.280	7043.00	2989.88	2755.69	-1246.47	40°27'36.900"N	104°41'33.929"W	0.42	
10112.00	88.650	358.050	7045.58	3082.09	2850.61	-1249.51	40°27'37.838"N	104°41'33.969"W	0.49	
10206.00	88.030	0.540	7048.30	3172.86	2944.56	-1250.67	40°27'38.766"N	104°41'33.984"W	2.73	
10301.00	88.180	359.860	7051.44	3264.19	3039.50	-1250.34	40°27'39.705"N	104°41'33.980"W	0.73	
10396.00	88.640	358.910	7054.08	3355.90	3134.46	-1251.36	40°27'40.643"N	104°41'33.993"W	1.11	
10491.00	88.740	0.230	7056.25	3447.54	3229.43	-1252.07	40°27'41.581"N	104°41'34.002"W	1.39	
10585.00	89.140	359.300	7057.99	3538.13	3323.41	-1252.46	40°27'42.510"N	104°41'34.007"W	1.08	
10680.00	91.540	2.830	7057.43	3629.09	3418.37	-1250.69	40°27'43.448"N	104°41'33.985"W	4.49	
10775.00	89.170	0.720	7056.84	3719.71	3513.31	-1247.75	40°27'44.387"N	104°41'33.947"W	3.34	
10870.00	89.260	359.980	7058.14	3811.02	3608.30	-1247.17	40°27'45.325"N	104°41'33.939"W	0.78	
10964.00	89.230	359.860	7059.38	3901.55	3702.29	-1247.30	40°27'46.254"N	104°41'33.941"W	0.13	
11059.00	89.510	1.150	7060.42	3992.79	3797.28	-1246.46	40°27'47.193"N	104°41'33.930"W	1.39	
11153.00	91.020	0.810	7059.99	4082.85	3891.26	-1244.86	40°27'48.121"N	104°41'33.909"W	1.65	
11248.00	91.540	0.870	7057.87	4173.91	3986.23	-1243.46	40°27'49.060"N	104°41'33.891"W	0.55	
11343.00	91.320	0.540	7055.50	4265.03	4081.19	-1242.29	40°27'49.998"N	104°41'33.876"W	0.42	
11437.00	92.030	0.510	7052.75	4355.27	4175.15	-1241.43	40°27'50.927"N	104°41'33.865"W	0.76	
11532.00	92.530	0.240	7048.97	4446.50	4270.07	-1240.81	40°27'51.865"N	104°41'33.857"W	0.60	
11627.00	92.930	0.310	7044.44	4537.74	4364.96	-1240.36	40°27'52.802"N	104°41'33.851"W	0.43	LAST BHI MWD SURVEY (563 FNL'1134 & FWL,SEC.29)
11685.00	92.930	0.310	7041.48	4593.43	4422.88	-1240.04	40°27'53.375"N	104°41'33.847"W	0.00	PROJ TO TD (505'FNL & 1134'FWL,SEC.29)

HOLE & CASING SECTIONS - Ref Wellbore: MATRIX E-29HN AWB Ref Wellpath: MATRIX E-29HN AWP

String/Diameter	Start MD [ft]	End MD [ft]	Interval [ft]	Start TVD [ft]	End TVD [ft]	Start N/S [ft]	Start E/W [ft]	End N/S [ft]	End E/W [ft]
9.625in Casing	30.00	1570.00	1540.00	30.00	1565.19	0.04	0.05	-6.92	-53.10

TARGETS

Name	TVD [ft]	North [ft]	East [ft]	Grid East [US ft]	Grid North [US ft]	Latitude	Longitude	Shape
SEC.29-T06N-R65W	-1.00	-30.66	-51.49	3225842.68	1408756.67	40°27'09.367"N	104°41'18.470"W	polygon
MATRIX PAD SHARON SPRINGS SEC.29	6719.00	-30.66	-51.49	3225842.68	1408756.67	40°27'09.367"N	104°41'18.470"W	polygon
SEC.29-T06N-R65W 460' SETBACK	6924.00	-30.66	-51.49	3225842.68	1408756.67	40°27'09.367"N	104°41'18.470"W	polygon
MATRIX E-29HN BHL REV-1 ON PLAT (465'FNL & 1130'FWL SEC.29)	7000.00	4462.50	-1244.11	3224609.03	1413238.55	40°27'53.766"N	104°41'33.900"W	point
MATRIX E-29HN LP ON PLAT (465'FSL & 1130'FWL SEC.29)	7000.00	105.28	-1218.74	3224674.28	1408881.92	40°27'10.710"N	104°41'33.569"W	point



Actual Wellpath Report

MATRIX E-29HN AWP

Page 6 of 7



REFERENCE WELLPATH IDENTIFICATION			
Operator	EXTRACTION OIL & GAS	Slot	SLOT#05 MATRIX E-29HN (462'FSL & 2348'FWL SEC.29)
Area	COLORADO	Well	MATRIX E-29HN
Field	WELD COUNTY (NAD83/TRUE NORTH)	Wellbore	MATRIX E-29HN AWB
Facility	SEC.29-T06N-R65W		

WELLPATH COMPOSITION - Ref Wellbore: MATRIX E-29HN AWB					Ref Wellpath: MATRIX E-29HN AWP	
Start MD	End MD	Positional Uncertainty Model		Log Name/Comment	Wellbore	
[ft]	[ft]					
0.00	1559.00	ISCWSA MWD, Rev. 4 (Standard)		MWD SURVEY-SURFACE HOLE <100-1559>	MATRIX E-29HN AWB	
1559.00	11627.00	Custom BHI NaviTrak (Standard Rotating+Axial Corr) (Rockies 0.03Gt model)		BHI NAVITRAK MWD, STD ROTATING, AXIAL, ROCKIES GT <1655-11627>	MATRIX E-29HN AWB	
11627.00	11685.00	Blind Drilling (std)		Projection to bit	MATRIX E-29HN AWB	



Actual Wellpath Report

MATRIX E-29HN AWP

Page 7 of 7



REFERENCE WELLPATH IDENTIFICATION			
Operator	EXTRACTION OIL & GAS	Slot	SLOT#05 MATRIX E-29HN (462'FSL & 2348'FWL SEC.29)
Area	COLORADO	Well	MATRIX E-29HN
Field	WELD COUNTY (NAD83/TRUE NORTH)	Wellbore	MATRIX E-29HN AWB
Facility	SEC.29-T06N-R65W		

WELLPATH COMMENTS				
MD [ft]	Inclination [°]	Azimuth [°]	TVD [ft]	Comment
1559.00	12.600	258.400	1554.46	TIED IN TO SURFACE SURVEY
7371.00	75.989	353.577	7017.57	CROSSED SETBACK BOUNDARY (473'FSL & 1121' FWL,SEC.29)
7555.00	89.910	359.040	7039.22	LANDING POINT (655'FSL & 1112'FWL,SEC.29)
11627.00	92.930	0.310	7044.44	LAST BHI MWD SURVEY (563 FNL'1134 & FWL,SEC.29)
11685.00	92.930	0.310	7041.48	PROJ TO TD (505'FNL & 1134'FWL,SEC.29)