

EXTRACTION OIL & GAS

Location: COLORADO Slot: SLOT#09 MATRIX T-29HN (488'FSL & 2387'FWL SEC.29)
Field: WELD COUNTY (NAD83/TRUE NORTH) Well: MATRIX T-29HN
Facility: SEC.29-T06N-R65W Wellbore: MATRIX T-29HN PWB

Plot reference wellpath is MATRIX T-29HN REV-B.0 PWP	Grid System: NAD83 / Lambert Colorado SP, Northern Zone (601), US feet
True vertical depths are referenced to H&P 321 (RKB)	* = Wellpath was transformed from a different geodetic datum
Measured depths are referenced to H&P 321 (RKB)	North Reference: True north
H&P 321 (RKB) to Mean Sea Level: 4737 feet	Scale: True distance
Mean Sea Level to Mud line (At Slot: SLOT#09 MATRIX T-29HN (488'FSL & 2387'FWL SEC.29)): 0 feet	Depths are in feet
Coordinates are in feet referenced to Slot	Created by: hutsaer on 2017-02-22
	Database: WA_DEN_Denver.Dbn

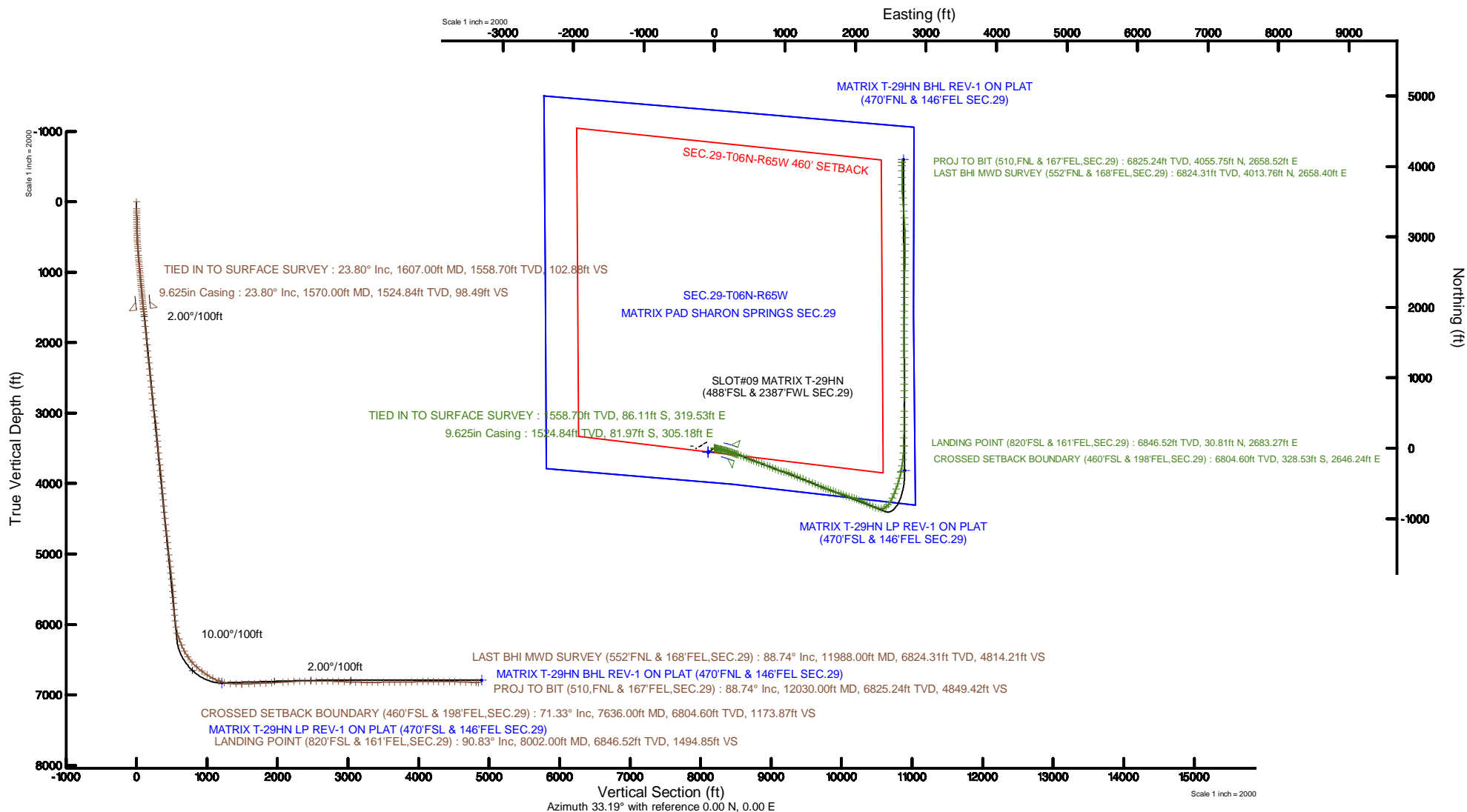



Actual Wellpath Report

MATRIX T-29HN AWP

Page 1 of 7



REFERENCE WELLPATH IDENTIFICATION

Operator	EXTRACTION OIL & GAS	Slot	SLOT#09 MATRIX T-29HN (488'FSL & 2387'FWL SEC.29)
Area	COLORADO	Well	MATRIX T-29HN
Field	WELD COUNTY (NAD83/TRUE NORTH)	Wellbore	MATRIX T-29HN AWB
Facility	SEC.29-T06N-R65W		

REPORT SETUP INFORMATION

Projection System	NAD83 / Lambert Colorado SP, Northern Zone (501), US feet	Software System	WellArchitect® 5.0
North Reference	True	User	Hutaedr
Scale	0.999963	Report Generated	22/Feb/2017 at 10:49
Convergence at slot	0.53° East	Database/Source file	WA_DEN_Denver_Defn/MATRIX_T-29HN_AWP.xml

WELLPATH LOCATION

	Local coordinates		Grid coordinates		Geographic coordinates	
	North[ft]	East[ft]	Easting[US ft]	Northing[US ft]	Latitude	Longitude
Slot Location	53.53	90.14	3225932.33	1408811.03	40°27'09.896"N	104°41'17.304"W
Facility Reference Pt			3225842.68	1408756.67	40°27'09.367"N	104°41'18.470"W
Field Reference Pt			3185481.27	1419166.81	40°28'55.560"N	104°49'59.556"W

WELLPATH DATUM

Calculation method	Minimum curvature	H&P 321 (RKB) to Facility Vertical Datum	4737.00ft
Horizontal Reference Pt	Slot	H&P 321 (RKB) to Mean Sea Level	4737.00ft
Vertical Reference Pt	H&P 321 (RKB)	H&P 321 (RKB) to Mud Line at Slot (SLOT#09 MATRIX T-29HN (488'FSL & 2387'FWL SEC.29))	4737.00ft
MD Reference Pt	H&P 321 (RKB)	Section Origin	N 0.00, E 0.00 ft
Field Vertical Reference	Mean Sea Level	Section Azimuth	33.19°

REFERENCE WELLPATH IDENTIFICATION

Operator	EXTRACTION OIL & GAS	Slot	SLOT#09 MATRIX T-29HN (488'FSL & 2387'FWL SEC.29)
Area	COLORADO	Well	MATRIX T-29HN
Field	WELD COUNTY (NAD83/TRUE NORTH)	Wellbore	MATRIX T-29HN AWB
Facility	SEC.29-T06N-R65W		

WELLPATH DATA (159 stations)

MD [ft]	Inclination [°]	Azimuth [°]	TVD [ft]	Vert Sect [ft]	North [ft]	East [ft]	Latitude	Longitude	DLS [°/100ft]	Comments
0.00	0.000	357.900	0.00	0.00	0.00	0.00	40°27'09.896"N	104°41'17.304"W	0.00	
99.00	1.100	357.900	98.99	0.78	0.95	-0.03	40°27'09.905"N	104°41'17.304"W	1.11	
131.00	0.600	14.000	130.99	1.18	1.42	-0.01	40°27'09.910"N	104°41'17.304"W	1.72	
163.00	1.100	81.100	162.99	1.55	1.63	0.34	40°27'09.912"N	104°41'17.300"W	3.21	
194.00	2.200	107.300	193.97	1.91	1.50	1.20	40°27'09.911"N	104°41'17.288"W	4.21	
226.00	2.600	108.100	225.95	2.27	1.09	2.48	40°27'09.907"N	104°41'17.272"W	1.25	
258.00	2.600	108.800	257.91	2.64	0.63	3.85	40°27'09.902"N	104°41'17.254"W	0.10	
290.00	3.400	108.200	289.87	3.06	0.10	5.44	40°27'09.897"N	104°41'17.234"W	2.50	
321.00	5.100	104.900	320.78	3.73	-0.54	7.65	40°27'09.891"N	104°41'17.205"W	5.54	
353.00	6.100	105.100	352.63	4.71	-1.35	10.66	40°27'09.883"N	104°41'17.166"W	3.13	
385.00	6.100	105.200	384.45	5.76	-2.24	13.95	40°27'09.874"N	104°41'17.124"W	0.03	
417.00	5.900	105.000	416.27	6.80	-3.11	17.18	40°27'09.865"N	104°41'17.082"W	0.63	
449.00	6.000	103.900	448.10	7.87	-3.94	20.39	40°27'09.857"N	104°41'17.040"W	0.47	
480.00	5.900	101.100	478.93	9.00	-4.63	23.52	40°27'09.850"N	104°41'17.000"W	0.99	
512.00	6.200	102.000	510.76	10.25	-5.31	26.83	40°27'09.844"N	104°41'16.957"W	0.98	
544.00	7.300	102.200	542.53	11.60	-6.10	30.51	40°27'09.836"N	104°41'16.909"W	3.44	
576.00	9.200	102.000	574.20	13.25	-7.06	34.99	40°27'09.826"N	104°41'16.851"W	5.94	
608.00	10.100	102.700	605.75	15.16	-8.21	40.23	40°27'09.815"N	104°41'16.784"W	2.84	
640.00	10.200	102.300	637.25	17.15	-9.43	45.74	40°27'09.803"N	104°41'16.712"W	0.38	
672.00	10.600	101.000	668.72	19.27	-10.59	51.40	40°27'09.791"N	104°41'16.639"W	1.45	
703.00	10.700	99.600	699.19	21.50	-11.62	57.03	40°27'09.781"N	104°41'16.566"W	0.89	
767.00	11.500	97.400	761.99	26.66	-13.43	69.22	40°27'09.763"N	104°41'16.409"W	1.41	
799.00	13.100	102.200	793.25	29.35	-14.61	75.93	40°27'09.752"N	104°41'16.322"W	5.93	
831.00	13.700	104.700	824.38	31.85	-16.34	83.14	40°27'09.735"N	104°41'16.229"W	2.61	
862.00	13.900	104.100	854.49	34.23	-18.17	90.30	40°27'09.716"N	104°41'16.136"W	0.79	
894.00	13.800	103.300	885.56	36.79	-19.99	97.74	40°27'09.698"N	104°41'16.040"W	0.68	
926.00	13.900	101.500	916.63	39.51	-21.63	105.22	40°27'09.682"N	104°41'15.943"W	1.38	
958.00	14.100	100.000	947.68	42.46	-23.08	112.83	40°27'09.668"N	104°41'15.845"W	1.29	
990.00	15.400	102.800	978.62	45.48	-24.69	120.81	40°27'09.652"N	104°41'15.741"W	4.63	
1022.00	16.200	105.200	1009.41	48.34	-26.81	129.26	40°27'09.631"N	104°41'15.632"W	3.23	
1054.00	16.300	105.400	1040.14	51.09	-29.17	137.90	40°27'09.608"N	104°41'15.520"W	0.36	
1085.00	16.000	104.000	1069.91	53.82	-31.36	146.24	40°27'09.586"N	104°41'15.412"W	1.59	
1117.00	16.100	102.700	1100.67	56.83	-33.40	154.85	40°27'09.566"N	104°41'15.301"W	1.17	
1149.00	17.500	105.400	1131.30	59.85	-35.65	163.81	40°27'09.544"N	104°41'15.185"W	5.01	
1181.00	18.400	107.900	1161.74	62.65	-38.48	173.26	40°27'09.516"N	104°41'15.063"W	3.70	
1211.00	18.400	108.200	1190.21	65.13	-41.42	182.26	40°27'09.487"N	104°41'14.946"W	0.32	
1243.00	18.100	107.900	1220.60	67.74	-44.52	191.79	40°27'09.456"N	104°41'14.823"W	0.98	
1274.00	18.300	106.200	1250.05	70.44	-47.36	201.05	40°27'09.428"N	104°41'14.703"W	1.83	
1306.00	19.700	106.400	1280.30	73.46	-50.29	211.04	40°27'09.399"N	104°41'14.574"W	4.38	
1336.00	20.800	107.500	1308.45	76.37	-53.32	220.98	40°27'09.369"N	104°41'14.446"W	3.88	
1368.00	20.800	107.200	1338.36	79.47	-56.70	231.82	40°27'09.336"N	104°41'14.305"W	0.33	
1400.00	22.200	109.400	1368.14	82.48	-60.39	242.95	40°27'09.299"N	104°41'14.161"W	5.05	
1432.00	23.000	111.000	1397.68	85.24	-64.64	254.49	40°27'09.257"N	104°41'14.012"W	3.15	
1463.00	22.900	111.000	1426.23	87.79	-68.97	265.78	40°27'09.214"N	104°41'13.866"W	0.32	
1495.00	22.600	109.700	1455.74	90.54	-73.28	277.38	40°27'09.172"N	104°41'13.716"W	1.83	

REFERENCE WELLPATH IDENTIFICATION

Operator	EXTRACTION OIL & GAS	Slot	SLOT#09 MATRIX T-29HN (488'FSL & 2387'FWL SEC.29)
Area	COLORADO	Well	MATRIX T-29HN
Field	WELD COUNTY (NAD83/TRUE NORTH)	Wellbore	MATRIX T-29HN AWB
Facility	SEC.29-T06N-R65W		

WELLPATH DATA (159 stations)

MD [ft]	Inclination [°]	Azimuth [°]	TVD [ft]	Vert Sect [ft]	North [ft]	East [ft]	Latitude	Longitude	DLS [°/100ft]	Comments
1527.00	22.200	107.300	1485.32	93.63	-77.15	288.94	40°27'09.134"N	104°41'13.566"W	3.12	
1559.00	23.800	106.100	1514.78	97.19	-80.74	300.91	40°27'09.098"N	104°41'13.412"W	5.21	
1607.00	23.800	106.100	1558.70	102.88	-86.11	319.53	40°27'09.045"N	104°41'13.171"W	0.00	TIED IN TO SURFACE SURVEY
1653.00	24.700	106.490	1600.64	108.37	-91.41	337.66	40°27'08.993"N	104°41'12.936"W	1.99	
1748.00	26.410	115.180	1686.37	117.03	-106.04	375.83	40°27'08.848"N	104°41'12.443"W	4.33	
1843.00	25.770	112.870	1771.69	123.67	-123.05	413.98	40°27'08.680"N	104°41'11.949"W	1.26	
1938.00	25.030	112.190	1857.51	131.21	-138.67	451.61	40°27'08.526"N	104°41'11.462"W	0.84	
2032.00	23.920	110.880	1943.06	139.07	-152.97	487.83	40°27'08.384"N	104°41'10.994"W	1.31	
2128.00	22.470	109.100	2031.30	147.69	-165.91	523.35	40°27'08.256"N	104°41'10.534"W	1.68	
2222.00	23.980	112.250	2117.68	155.69	-179.03	558.01	40°27'08.127"N	104°41'10.086"W	2.08	
2317.00	24.750	109.640	2204.22	164.02	-193.02	594.61	40°27'07.989"N	104°41'09.612"W	1.39	
2411.00	23.260	108.070	2290.09	173.48	-205.39	630.79	40°27'07.866"N	104°41'09.145"W	1.72	
2506.00	24.940	110.700	2376.81	182.70	-218.29	667.36	40°27'07.739"N	104°41'08.671"W	2.10	
2600.00	27.730	110.120	2461.05	191.94	-232.82	706.44	40°27'07.595"N	104°41'08.166"W	2.98	
2696.00	26.350	110.140	2546.55	201.81	-247.84	747.42	40°27'07.447"N	104°41'07.636"W	1.44	
2791.00	25.180	109.670	2632.11	211.30	-261.90	786.25	40°27'07.308"N	104°41'07.134"W	1.25	
2886.00	27.110	114.880	2717.39	219.15	-277.82	824.92	40°27'07.151"N	104°41'06.633"W	3.16	
2981.00	27.100	114.670	2801.96	225.49	-295.95	864.22	40°27'06.971"N	104°41'06.125"W	0.10	
3075.00	27.120	108.390	2885.65	234.14	-311.65	904.02	40°27'06.816"N	104°41'05.610"W	3.04	
3170.00	25.540	106.570	2970.79	245.54	-324.33	944.20	40°27'06.691"N	104°41'05.091"W	1.87	
3265.00	23.740	101.450	3057.15	258.48	-333.97	982.58	40°27'06.596"N	104°41'04.594"W	2.94	
3359.00	24.660	105.860	3142.89	271.34	-343.08	1019.99	40°27'06.506"N	104°41'04.110"W	2.16	
3454.00	22.710	110.910	3229.90	281.15	-355.04	1056.19	40°27'06.387"N	104°41'03.642"W	2.96	
3549.00	28.730	114.070	3315.45	288.68	-370.92	1094.20	40°27'06.231"N	104°41'03.150"W	6.50	
3643.00	28.750	114.040	3397.87	295.86	-389.34	1135.48	40°27'06.048"N	104°41'02.616"W	0.03	
3738.00	26.040	112.850	3482.21	303.24	-406.75	1175.57	40°27'05.876"N	104°41'02.098"W	2.91	
3832.00	23.340	111.540	3567.61	310.70	-421.60	1211.91	40°27'05.730"N	104°41'01.628"W	2.93	
3927.00	30.580	110.850	3652.23	319.68	-437.13	1252.05	40°27'05.576"N	104°41'01.108"W	7.63	
4022.00	31.460	111.800	3733.64	329.75	-454.94	1297.65	40°27'05.400"N	104°41'00.519"W	1.06	
4117.00	31.800	112.590	3814.53	339.25	-473.76	1343.78	40°27'05.214"N	104°40'59.922"W	0.56	
4212.00	30.410	112.920	3895.87	348.15	-492.74	1389.04	40°27'05.027"N	104°40'59.337"W	1.47	
4306.00	28.450	114.680	3977.74	355.71	-511.36	1431.30	40°27'04.843"N	104°40'58.790"W	2.28	
4401.00	26.910	112.760	4061.86	362.95	-529.12	1471.69	40°27'04.667"N	104°40'58.267"W	1.87	
4495.00	24.430	113.060	4146.58	370.23	-544.97	1509.19	40°27'04.510"N	104°40'57.782"W	2.64	
4590.00	23.250	113.840	4233.47	376.73	-560.24	1544.42	40°27'04.359"N	104°40'57.327"W	1.29	
4685.00	20.380	107.480	4321.67	384.26	-572.80	1577.36	40°27'04.235"N	104°40'56.901"W	3.91	
4779.00	24.700	109.720	4408.47	393.28	-584.34	1611.48	40°27'04.121"N	104°40'56.459"W	4.68	
4874.00	22.820	109.760	4495.42	402.18	-597.27	1647.50	40°27'03.993"N	104°40'55.993"W	1.98	
4969.00	26.130	109.360	4581.87	411.47	-610.44	1684.59	40°27'03.863"N	104°40'55.514"W	3.49	
5063.00	23.430	107.750	4667.21	421.40	-623.00	1721.92	40°27'03.739"N	104°40'55.031"W	2.96	
5158.00	23.930	110.030	4754.21	430.82	-635.36	1758.01	40°27'03.617"N	104°40'54.564"W	1.10	
5253.00	24.440	109.650	4840.87	439.81	-648.57	1794.62	40°27'03.487"N	104°40'54.090"W	0.56	
5347.00	21.740	109.580	4927.33	448.46	-660.94	1829.34	40°27'03.364"N	104°40'53.641"W	2.87	
5442.00	26.890	109.230	5013.88	457.79	-673.92	1866.23	40°27'03.236"N	104°40'53.164"W	5.42	
5537.00	25.390	106.200	5099.16	468.93	-686.68	1906.08	40°27'03.110"N	104°40'52.649"W	2.11	

REFERENCE WELLPATH IDENTIFICATION

Operator	EXTRACTION OIL & GAS	Slot	SLOT#09 MATRIX T-29HN (488'FSL & 2387'FWL SEC.29)
Area	COLORADO	Well	MATRIX T-29HN
Field	WELD COUNTY (NAD83/TRUE NORTH)	Wellbore	MATRIX T-29HN AWP
Facility	SEC.29-T06N-R65W		

WELLPATH DATA (159 stations) † = interpolated/extrapolated station

MD [ft]	Inclination [°]	Azimuth [°]	TVD [ft]	Vert Sect [ft]	North [ft]	East [ft]	Latitude	Longitude	DLS [°/100ft]	Comments
5632.00	25.840	111.140	5184.83	479.21	-699.83	1944.95	40°27'02.980"N	104°40'52.146"W	2.30	
5727.00	23.260	108.640	5271.24	488.25	-713.30	1982.04	40°27'02.847"N	104°40'51.666"W	2.93	
5821.00	22.760	107.910	5357.76	497.71	-724.82	2016.93	40°27'02.733"N	104°40'51.215"W	0.61	
5916.00	21.300	110.220	5445.82	506.43	-736.44	2050.61	40°27'02.618"N	104°40'50.779"W	1.79	
6010.00	25.160	111.540	5532.19	514.30	-749.68	2085.23	40°27'02.487"N	104°40'50.331"W	4.14	
6105.00	25.090	115.970	5618.21	520.91	-765.91	2122.13	40°27'02.327"N	104°40'49.854"W	1.98	
6201.00	28.990	114.860	5703.70	526.85	-784.61	2161.55	40°27'02.142"N	104°40'49.344"W	4.10	
6295.00	30.810	115.890	5785.18	533.21	-804.70	2203.88	40°27'01.943"N	104°40'48.797"W	2.01	
6390.00	27.840	115.660	5868.00	539.21	-824.94	2245.77	40°27'01.743"N	104°40'48.255"W	3.13	
6485.00	27.810	109.030	5952.04	547.55	-841.77	2286.72	40°27'01.577"N	104°40'47.725"W	3.26	
6579.00	24.310	107.530	6036.47	558.14	-854.75	2325.91	40°27'01.449"N	104°40'47.218"W	3.79	
6674.00	26.210	88.120	6122.53	575.51	-859.97	2365.60	40°27'01.397"N	104°40'46.705"W	8.91	
6769.00	24.820	65.460	6208.47	604.49	-850.97	2404.80	40°27'01.486"N	104°40'46.198"W	10.32	
6863.00	22.510	45.000	6294.70	638.85	-830.02	2435.53	40°27'01.693"N	104°40'45.800"W	9.03	
6958.00	28.690	39.120	6380.35	679.38	-799.43	2462.81	40°27'01.995"N	104°40'45.447"W	7.03	
7053.00	33.850	36.620	6461.52	728.51	-760.48	2493.00	40°27'02.380"N	104°40'45.057"W	5.60	
7148.00	42.600	25.000	6536.18	786.93	-709.94	2522.46	40°27'02.879"N	104°40'44.676"W	11.89	
7243.00	47.560	21.790	6603.25	853.17	-648.20	2549.08	40°27'03.489"N	104°40'44.331"W	5.74	
7338.00	53.820	18.760	6663.41	924.74	-579.27	2574.46	40°27'04.171"N	104°40'44.003"W	7.04	
7433.00	58.130	18.120	6716.56	1000.86	-504.59	2599.34	40°27'04.908"N	104°40'43.681"W	4.57	
7528.00	63.250	16.510	6763.05	1080.50	-425.53	2623.96	40°27'05.690"N	104°40'43.362"W	5.59	
7623.00	70.520	10.310	6800.35	1162.56	-340.62	2644.07	40°27'06.529"N	104°40'43.102"W	9.72	
7636.00†	71.332	10.016	6804.60	1173.87	-328.53	2646.24	40°27'06.648"N	104°40'43.074"W	6.60	CROSSED SETBACK BOUNDARY (460'FSL & 198'FEL, SEC.29)
7718.00	76.460	8.220	6827.34	1245.76	-250.77	2658.71	40°27'07.417"N	104°40'42.913"W	6.60	
7812.00	87.910	5.850	6840.10	1329.19	-158.50	2670.07	40°27'08.328"N	104°40'42.766"W	12.43	
7907.00	86.760	4.900	6844.52	1413.12	-64.02	2678.95	40°27'09.262"N	104°40'42.651"W	1.57	
8002.00	90.830	0.320	6846.52	1494.85	30.81	2683.27	40°27'10.199"N	104°40'42.595"W	6.45	LANDING POINT (820'FSL & 161'FEL, SEC.29)
8121.00	92.460	0.930	6843.10	1595.09	149.75	2684.57	40°27'11.374"N	104°40'42.578"W	1.46	
8216.00	92.400	0.820	6839.07	1675.30	244.65	2686.02	40°27'12.312"N	104°40'42.559"W	0.13	
8311.00	92.000	0.750	6835.42	1755.44	339.58	2687.32	40°27'13.250"N	104°40'42.542"W	0.43	
8406.00	92.280	0.880	6831.88	1835.61	434.50	2688.67	40°27'14.188"N	104°40'42.524"W	0.32	
8500.00	91.940	0.880	6828.42	1915.00	528.42	2690.12	40°27'15.116"N	104°40'42.505"W	0.36	
8690.00	93.140	0.520	6820.00	2075.09	718.22	2692.43	40°27'16.992"N	104°40'42.475"W	0.66	
8784.00	93.050	0.480	6814.92	2154.08	812.08	2693.25	40°27'17.919"N	104°40'42.464"W	0.10	
8879.00	93.540	358.850	6809.46	2233.14	906.92	2692.70	40°27'18.856"N	104°40'42.471"W	1.79	
8973.00	90.520	359.270	6806.13	2310.89	1000.83	2691.16	40°27'19.784"N	104°40'42.491"W	3.24	
9068.00	90.950	359.210	6804.91	2389.68	1095.82	2689.90	40°27'20.723"N	104°40'42.507"W	0.46	
9163.00	89.020	0.590	6804.94	2469.08	1190.81	2689.73	40°27'21.662"N	104°40'42.509"W	2.50	
9258.00	90.150	359.730	6805.63	2548.72	1285.81	2690.00	40°27'22.600"N	104°40'42.506"W	1.49	
9352.00	89.570	0.530	6805.86	2627.50	1379.80	2690.21	40°27'23.529"N	104°40'42.503"W	1.05	
9447.00	90.460	359.780	6805.83	2707.13	1474.80	2690.47	40°27'24.468"N	104°40'42.499"W	1.23	
9542.00	87.840	359.980	6807.24	2786.51	1569.78	2690.27	40°27'25.406"N	104°40'42.502"W	2.77	
9637.00	87.690	0.100	6810.94	2865.98	1664.71	2690.34	40°27'26.344"N	104°40'42.501"W	0.20	
9731.00	88.150	0.160	6814.36	2944.70	1758.65	2690.55	40°27'27.273"N	104°40'42.498"W	0.49	
9826.00	88.800	0.440	6816.88	3024.44	1853.61	2691.05	40°27'28.211"N	104°40'42.491"W	0.74	

REFERENCE WELLPATH IDENTIFICATION

Operator	EXTRACTION OIL & GAS	Slot	SLOT#09 MATRIX T-29HN (488'FSL & 2387'FWL SEC.29)
Area	COLORADO	Well	MATRIX T-29HN
Field	WELD COUNTY (NAD83/TRUE NORTH)	Wellbore	MATRIX T-29HN AWB
Facility	SEC.29-T06N-R65W		

WELLPATH DATA (159 stations)

MD [ft]	Inclination [°]	Azimuth [°]	TVD [ft]	Vert Sect [ft]	North [ft]	East [ft]	Latitude	Longitude	DLS [°/100ft]	Comments
9920.00	89.040	1.180	6818.66	3103.81	1947.59	2692.37	40°27'29.140"N	104°40'42.474"W	0.83	
10015.00	88.120	2.240	6821.01	3184.80	2042.51	2695.21	40°27'30.078"N	104°40'42.437"W	1.48	
10110.00	90.770	0.400	6821.93	3265.46	2137.47	2697.40	40°27'31.016"N	104°40'42.409"W	3.40	
10204.00	89.630	0.250	6821.60	3344.41	2231.47	2697.93	40°27'31.945"N	104°40'42.402"W	1.22	
10299.00	90.520	359.410	6821.48	3423.75	2326.46	2697.65	40°27'32.884"N	104°40'42.405"W	1.29	
10394.00	90.400	0.330	6820.72	3503.12	2421.46	2697.43	40°27'33.822"N	104°40'42.408"W	0.98	
10489.00	90.310	0.470	6820.13	3582.98	2516.46	2698.10	40°27'34.761"N	104°40'42.399"W	0.18	
10583.00	89.480	0.180	6820.30	3661.93	2610.45	2698.63	40°27'35.690"N	104°40'42.392"W	0.94	
10678.00	91.110	0.510	6819.81	3741.73	2705.45	2699.20	40°27'36.629"N	104°40'42.385"W	1.75	
10773.00	91.170	0.950	6817.92	3821.87	2800.42	2700.41	40°27'37.567"N	104°40'42.369"W	0.47	
10868.00	91.140	0.680	6816.00	3902.08	2895.39	2701.76	40°27'38.505"N	104°40'42.351"W	0.29	
10962.00	92.150	0.050	6813.31	3981.04	2989.35	2702.36	40°27'39.434"N	104°40'42.343"W	1.27	
11057.00	91.660	357.040	6810.15	4059.14	3084.25	2699.95	40°27'40.372"N	104°40'42.375"W	3.21	
11151.00	89.540	357.500	6809.16	4135.25	3178.14	2695.47	40°27'41.299"N	104°40'42.432"W	2.31	
11246.00	89.540	355.530	6809.93	4211.43	3272.95	2689.70	40°27'42.236"N	104°40'42.507"W	2.07	
11341.00	89.010	355.770	6811.13	4286.75	3367.67	2682.49	40°27'43.172"N	104°40'42.600"W	0.61	
11435.00	89.910	355.620	6812.01	4361.32	3461.40	2675.44	40°27'44.099"N	104°40'42.691"W	0.97	
11530.00	89.290	355.760	6812.68	4436.68	3556.13	2668.30	40°27'45.035"N	104°40'42.783"W	0.67	
11625.00	89.450	357.830	6813.72	4513.14	3650.97	2662.99	40°27'45.972"N	104°40'42.852"W	2.19	
11720.00	88.250	359.380	6815.63	4591.32	3745.92	2660.67	40°27'46.910"N	104°40'42.882"W	2.06	
11815.00	88.030	359.020	6818.71	4670.04	3840.86	2659.35	40°27'47.848"N	104°40'42.899"W	0.44	
11910.00	87.940	359.830	6822.05	4748.97	3935.79	2658.40	40°27'48.786"N	104°40'42.911"W	0.86	
11988.00	88.740	0.170	6824.31	4814.21	4013.76	2658.40	40°27'49.557"N	104°40'42.911"W	1.11	LAST BHI MWD SURVEY (552'FNL & 168'FEL, SEC.29)
12030.00	88.740	0.170	6825.24	4849.42	4055.75	2658.52	40°27'49.972"N	104°40'42.909"W	0.00	PROJ TO BIT (510'FNL & 167'FEL, SEC.29)

HOLE & CASING SECTIONS - Ref Wellbore: MATRIX T-29HN AWB Ref Wellpath: MATRIX T-29HN AWP

String/Diameter	Start MD [ft]	End MD [ft]	Interval [ft]	Start TVD [ft]	End TVD [ft]	Start N/S [ft]	Start E/W [ft]	End N/S [ft]	End E/W [ft]
9.625in Casing	30.00	1570.00	1540.00	30.00	1524.84	0.09	0.00	-81.97	305.18



Actual Wellpath Report

MATRIX T-29HN AWP

Page 6 of 7



REFERENCE WELLPATH IDENTIFICATION

Operator	EXTRACTION OIL & GAS	Slot	SLOT#09 MATRIX T-29HN (488'FSL & 2387'FWL SEC.29)
Area	COLORADO	Well	MATRIX T-29HN
Field	WELD COUNTY (NAD83/TRUE NORTH)	Wellbore	MATRIX T-29HN AWB
Facility	SEC.29-T06N-R65W		

TARGETS

Name	TVD [ft]	North [ft]	East [ft]	Grid East [US ft]	Grid North [US ft]	Latitude	Longitude	Shape
SEC.29-T06N-R65W	-1.00	-53.53	-90.14	3225842.68	1408756.67	40°27'09.367"N	104°41'18.470"W	polygon
MATRIX PAD SHARON SPRINGS SEC.29	6719.00	-53.53	-90.14	3225842.68	1408756.67	40°27'09.367"N	104°41'18.470"W	polygon
MATRIX T-29HN BHL REV-1 ON PLAT (470'FNL & 146'FEL SEC.29)	6792.00	4096.17	2679.94	3228574.55	1412931.40	40°27'50.371"N	104°40'42.632"W	point
MATRIX T-29HN LP REV-1 ON PLAT (470'FSL & 146'FEL SEC.29)	6830.00	-318.93	2698.20	3228633.22	1408516.82	40°27'06.743"N	104°40'42.402"W	point
SEC.29-T06N-R65W 460' SETBACK	6924.00	-53.53	-90.14	3225842.68	1408756.67	40°27'09.367"N	104°41'18.470"W	polygon

WELLPATH COMPOSITION - Ref Wellbore: MATRIX T-29HN AWB Ref Wellpath: MATRIX T-29HN AWP

Start MD [ft]	End MD [ft]	Positional Uncertainty Model	Log Name/Comment	Wellbore
0.00	1607.00	ISCWSA MWD, Rev. 4 (Standard)	MWD SURVEY-SURFACE HOLE <99-1607>	MATRIX T-29HN AWB
1607.00	11988.00	Custom BHI NaviTrak (Standard Rotating+Axial Corr) (Rockies 0.03Gt model)	BHI NAVITRAK MWD, STD ROTATING, AXIAL, ROCKIES GT<1653-11988>	MATRIX T-29HN AWB
11988.00	12030.00	Blind Drilling (std)	Projection to bit	MATRIX T-29HN AWB



Actual Wellpath Report

MATRIX T-29HN AWP

Page 7 of 7



REFERENCE WELLPATH IDENTIFICATION

Operator	EXTRACTION OIL & GAS	Slot	SLOT#09 MATRIX T-29HN (488'FSL & 2387'FWL SEC.29)
Area	COLORADO	Well	MATRIX T-29HN
Field	WELD COUNTY (NAD83/TRUE NORTH)	Wellbore	MATRIX T-29HN AWB
Facility	SEC.29-T06N-R65W		

WELLPATH COMMENTS

MD [ft]	Inclination [°]	Azimuth [°]	TVD [ft]	Comment
1607.00	23.800	106.100	1558.70	TIED IN TO SURFACE SURVEY
7636.00	71.332	10.016	6804.60	CROSSED SETBACK BOUNDARY (460'FSL & 198'FEL, SEC.29)
8002.00	90.830	0.320	6846.52	LANDING POINT (820'FSL & 161'FEL, SEC.29)
11988.00	88.740	0.170	6824.31	LAST BHI MWD SURVEY (552'FNL & 168'FEL, SEC.29)
12030.00	88.740	0.170	6825.24	PROJ TO BIT (510,FNL & 167'FEL, SEC.29)