

PHOTO: VIEW FROM CORNER #5 TO LOCATION STAKE

CAMERA ANGLE: NORTHERLY

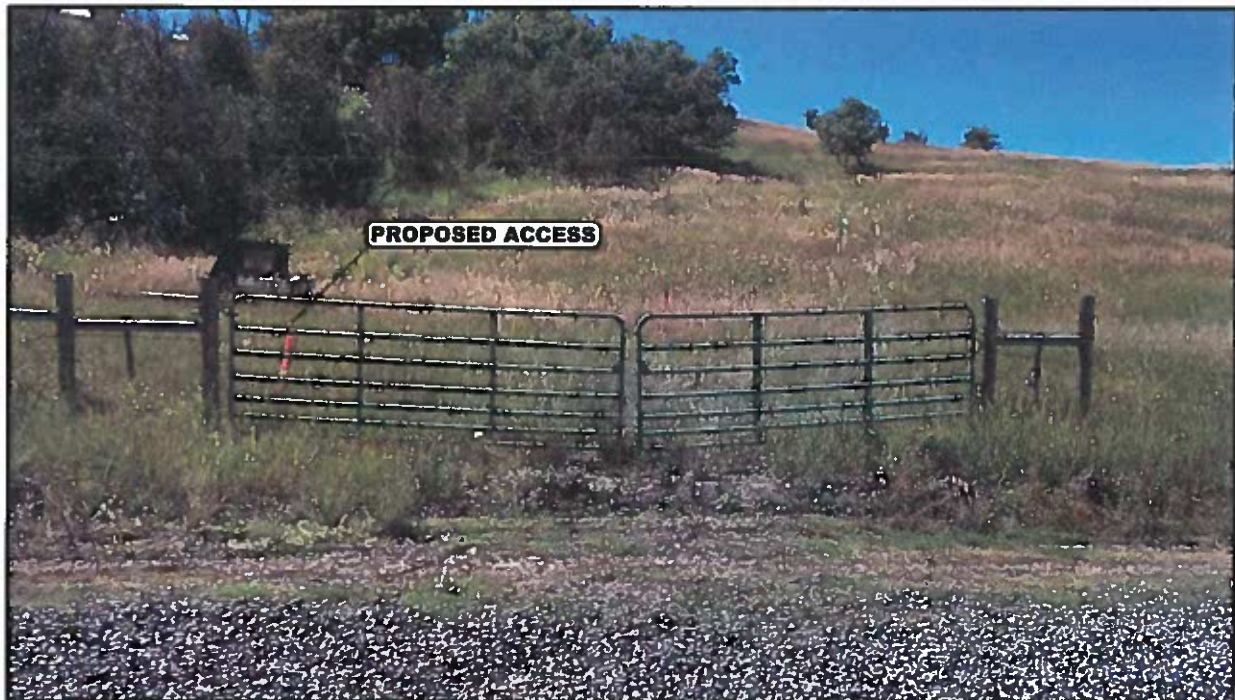

PHOTO: VIEW FROM BEGINNING OF PROPOSED ACCESS

CAMERA ANGLE: SOUTHWESTERLY

LARAMIE ENERGY, LLC

**NICHOLS 24-7 PAD
SE 1/4 NW 1/4, SECTION 24, T9S, R94W, 6th P.M.
MESA COUNTY, COLORADO**

TAKEN BY	C.R. B.H.	08-30-16	
DRAWN BY	J.L.G.	01-31-17	
LOCATION PHOTOS			PHOTO 1



UELS, LLC
Corporate Office * 85 South 200 East
Vernal, UT 84078 * (435) 789-1017

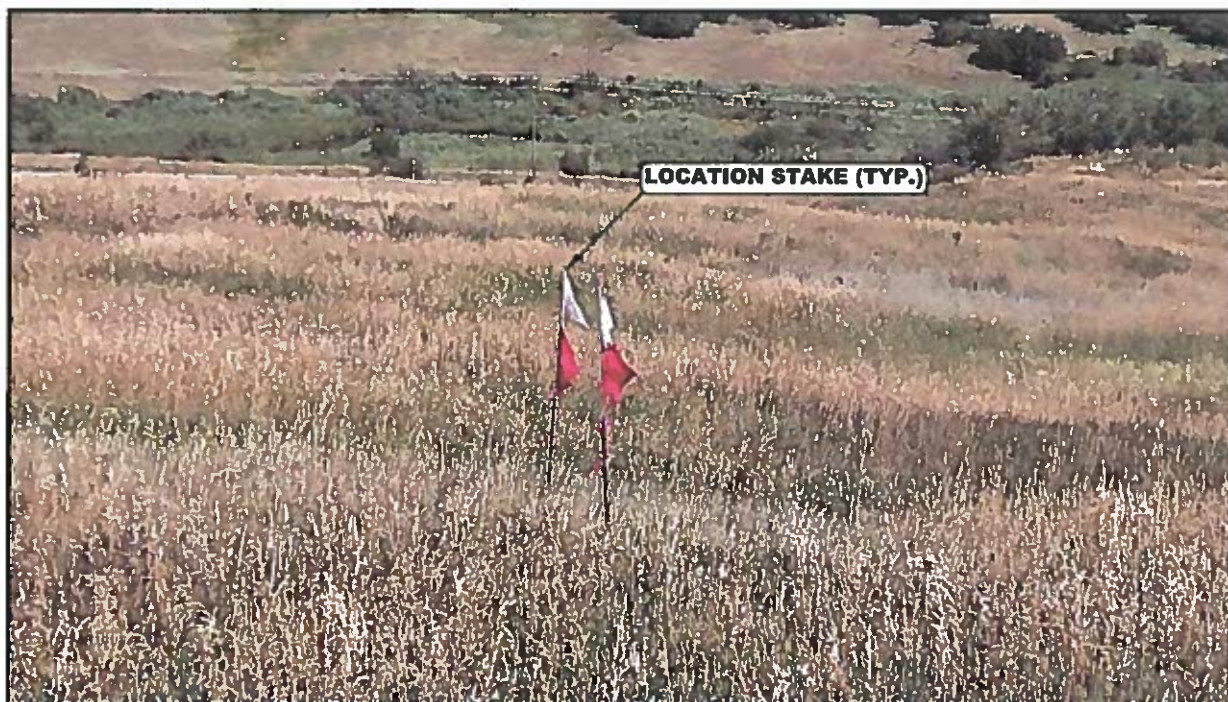

PHOTO: VIEW OF LOCATION STAKES

CAMERA ANGLE: NORTHERLY



PHOTO: VIEW OF LOCATION STAKES

CAMERA ANGLE: EASTERLY

LARAMIE ENERGY, LLC

**NICHOLS 24-7 PAD
SE 1/4 NW 1/4, SECTION 24, T9S, R94W, 6th P.M.
MESA COUNTY, COLORADO**

TAKEN BY	C.R. B.H.	08-30-16	
DRAWN BY	J.L.G.	01-31-17	
LOCATION PHOTOS			PHOTO 2



UELS, LLC
Corporate Office * 85 South 200 East
Vernal, UT 84078 * (435) 789-1017



PHOTO: VIEW OF LOCATION STAKES

CAMERA ANGLE: SOUTHERLY

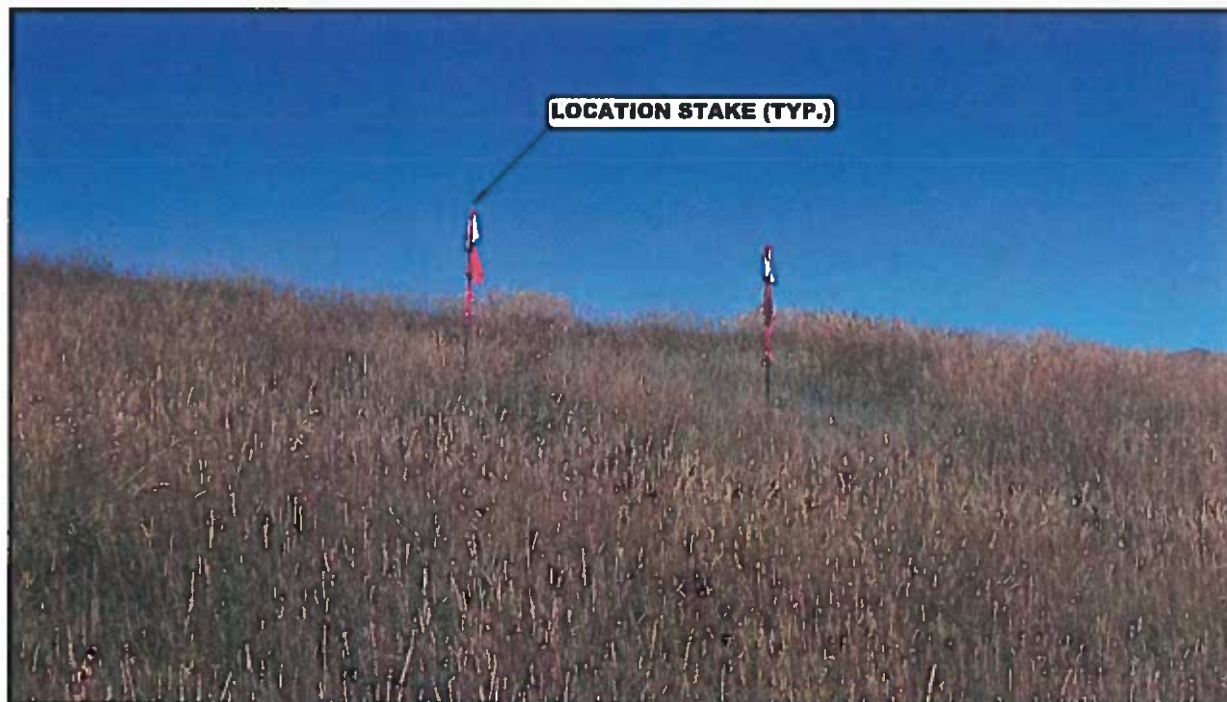

PHOTO: VIEW OF LOCATION STAKES

CAMERA ANGLE: WESTERLY

LARAMIE ENERGY, LLC

**NICHOLS 24-7 PAD
SE 1/4 NW 1/4, SECTION 24, T9S, R94W, 6th P.M.
MESA COUNTY, COLORADO**

TAKEN BY	C.R., B.H.	08-30-16	
DRAWN BY	J.L.G.	01-31-17	
LOCATION PHOTOS		PHOTO 3	



UELS, LLC
Corporate Office * 85 South 200 East
Vernal, UT 84078 * (435) 789-1017