

EXTRACTION OIL & GAS

Location: COLORADO Slot: SLOT#06 MATRIX F-29HN (470°FSL & 2361°FWL SEC.29)
Field: WELD COUNTY (NAD83/TRUE NORTH) Well: MATRIX F-29HN
Facility: SEC.29-T06N-R65W Wellbore: MATRIX F-29HN PWB

Plot reference wellpath is MATRIX F-29HN REV-8.0 PWP	Grid System: NAD83 / Lambert Colorado SP, Northern Zone (501), US feet
True vertical depths are referenced to H&P 321 (RKB)	* = Wellpath was transformed from a different geodetic datum
Measured depths are referenced to H&P 321 (RKB)	North Reference: True north
H&P 321 (RKB) to Mean Sea Level: 4737 feet	Scale: True distance
Mean Sea Level to Mud line (At Slot: SLOT#06 MATRIX F-29HN (470°FSL & 2361°FWL SEC.29)): 0 feet	Depths are in feet
Coordinates are in feet referenced to Slot	Created by: hutaed on 2017-02-21
	Database: WA_DEN_Denver_Delta

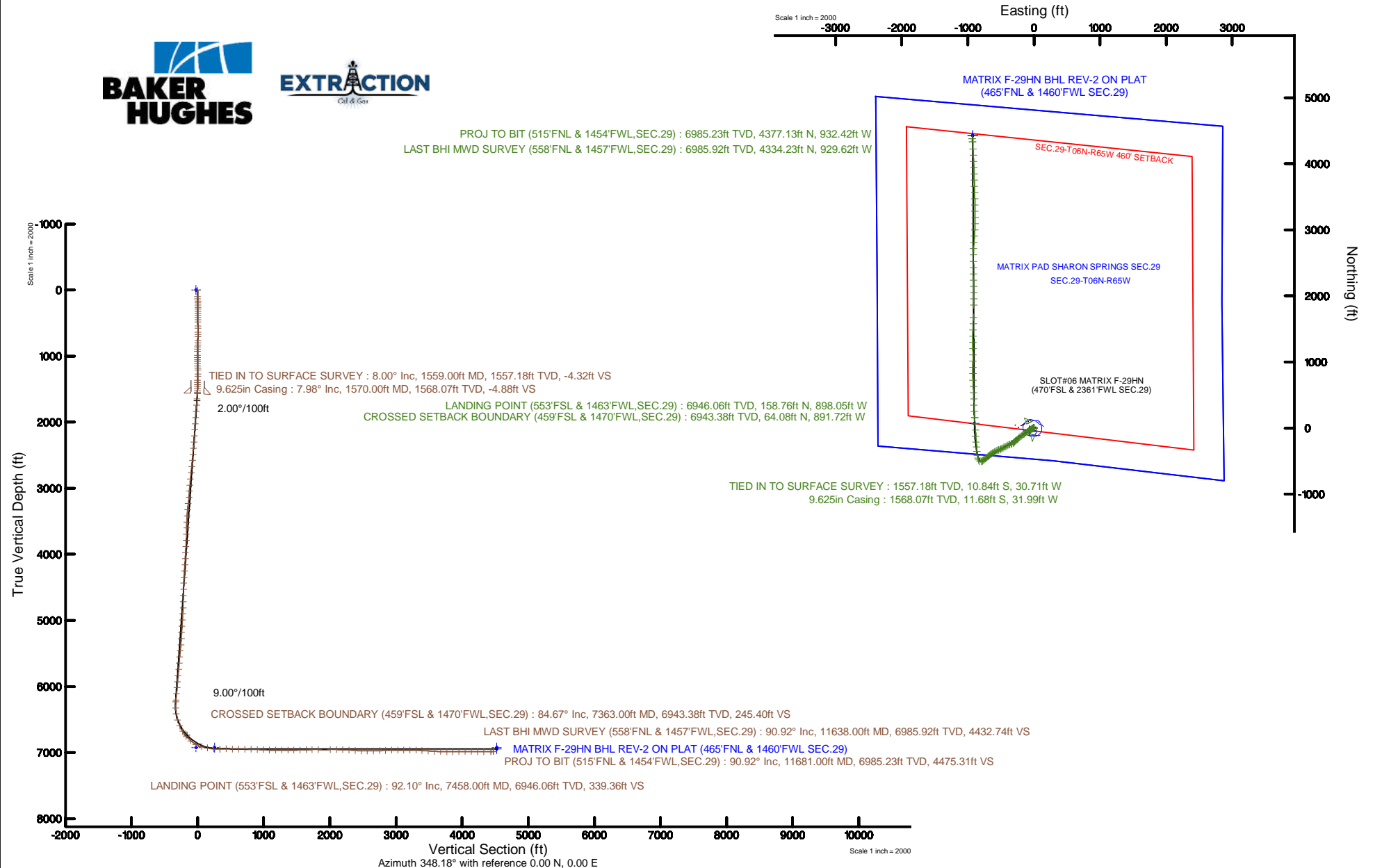



Actual Wellpath Report

MATRIX F-29HN AWP

Page 1 of 7



REFERENCE WELLPATH IDENTIFICATION

Operator	EXTRACTION OIL & GAS	Slot	SLOT#06 MATRIX F-29HN (470'FSL & 2361'FWL SEC.29)
Area	COLORADO	Well	MATRIX F-29HN
Field	WELD COUNTY (NAD83/TRUE NORTH)	Wellbore	MATRIX F-29HN AWB
Facility	SEC.29-T06N-R65W		

REPORT SETUP INFORMATION

Projection System	NAD83 / Lambert Colorado SP, Northern Zone (501), US feet	Software System	WellArchitect® 5.0
North Reference	True	User	Hutaedr
Scale	0.999963	Report Generated	21/Feb/2017 at 15:24
Convergence at slot	0.53° East	Database/Source file	WA_DEN_Denver_Defn/MATRIX_F-29HN_AWP.xml

WELLPATH LOCATION

	Local coordinates		Grid coordinates		Geographic coordinates	
	North[ft]	East[ft]	Easting[US ft]	Northing[US ft]	Latitude	Longitude
Slot Location	38.25	64.24	3225906.57	1408795.51	40°27'09.745"N	104°41'17.639"W
Facility Reference Pt			3225842.68	1408756.67	40°27'09.367"N	104°41'18.470"W
Field Reference Pt			3185481.27	1419166.81	40°28'55.560"N	104°49'59.556"W

WELLPATH DATUM

Calculation method	Minimum curvature	H&P 321 (RKB) to Facility Vertical Datum	4737.00ft
Horizontal Reference Pt	Slot	H&P 321 (RKB) to Mean Sea Level	4737.00ft
Vertical Reference Pt	H&P 321 (RKB)	H&P 321 (RKB) to Mud Line at Slot (SLOT#06 MATRIX F-29HN (470'FSL & 2361'FWL SEC.29))	4737.00ft
MD Reference Pt	H&P 321 (RKB)	Section Origin	N 0.00, E 0.00 ft
Field Vertical Reference	Mean Sea Level	Section Azimuth	348.18°

REFERENCE WELLPATH IDENTIFICATION

Operator	EXTRACTION OIL & GAS	Slot	SLOT#06 MATRIX F-29HN (470'FSL & 2361'FWL SEC.29)
Area	COLORADO	Well	MATRIX F-29HN
Field	WELD COUNTY (NAD83/TRUE NORTH)	Wellbore	MATRIX F-29HN AWB
Facility	SEC.29-T06N-R65W		

WELLPATH DATA (149 stations)

MD [ft]	Inclination [°]	Azimuth [°]	TVD [ft]	Vert Sect [ft]	North [ft]	East [ft]	Latitude	Longitude	DLS [°/100ft]	Comments
0.00	0.000	322.100	0.00	0.00	0.00	0.00	40°27'09.745"N	104°41'17.639"W	0.00	
100.00	0.600	322.100	100.00	0.47	0.41	-0.32	40°27'09.749"N	104°41'17.643"W	0.60	
131.00	0.800	333.100	131.00	0.83	0.73	-0.52	40°27'09.752"N	104°41'17.646"W	0.77	
164.00	0.700	310.600	163.99	1.21	1.07	-0.78	40°27'09.756"N	104°41'17.649"W	0.94	
195.00	0.700	316.700	194.99	1.52	1.33	-1.05	40°27'09.758"N	104°41'17.653"W	0.24	
227.00	0.800	315.800	226.99	1.87	1.63	-1.34	40°27'09.761"N	104°41'17.656"W	0.31	
259.00	0.900	320.000	258.98	2.28	1.99	-1.66	40°27'09.765"N	104°41'17.660"W	0.37	
291.00	0.900	314.800	290.98	2.72	2.36	-2.00	40°27'09.768"N	104°41'17.665"W	0.26	
322.00	0.800	308.100	321.98	3.08	2.66	-2.34	40°27'09.771"N	104°41'17.669"W	0.45	
354.00	0.600	309.700	353.97	3.39	2.91	-2.64	40°27'09.774"N	104°41'17.673"W	0.63	
386.00	0.600	307.900	385.97	3.65	3.12	-2.91	40°27'09.776"N	104°41'17.677"W	0.06	
418.00	0.500	303.300	417.97	3.87	3.30	-3.15	40°27'09.778"N	104°41'17.680"W	0.34	
450.00	0.500	261.400	449.97	3.98	3.35	-3.41	40°27'09.778"N	104°41'17.683"W	1.12	
481.00	0.700	280.800	480.97	4.06	3.37	-3.73	40°27'09.778"N	104°41'17.687"W	0.91	
545.00	0.800	278.000	544.96	4.36	3.50	-4.56	40°27'09.780"N	104°41'17.698"W	0.17	
577.00	0.900	277.000	576.96	4.52	3.56	-5.03	40°27'09.780"N	104°41'17.704"W	0.32	
640.00	0.800	259.800	639.95	4.69	3.55	-5.95	40°27'09.780"N	104°41'17.716"W	0.43	
672.00	1.000	261.100	671.95	4.71	3.46	-6.45	40°27'09.779"N	104°41'17.722"W	0.63	
704.00	0.700	232.900	703.95	4.64	3.30	-6.88	40°27'09.778"N	104°41'17.728"W	1.58	
768.00	2.100	121.500	767.93	3.67	2.45	-6.19	40°27'09.769"N	104°41'17.719"W	3.82	
800.00	2.800	118.200	799.90	2.77	1.78	-5.00	40°27'09.763"N	104°41'17.704"W	2.23	
832.00	3.200	116.600	831.86	1.71	1.01	-3.51	40°27'09.755"N	104°41'17.684"W	1.28	
863.00	3.500	115.800	862.80	0.59	0.21	-1.89	40°27'09.747"N	104°41'17.663"W	0.98	
895.00	3.200	113.200	894.75	-0.52	-0.57	-0.19	40°27'09.739"N	104°41'17.641"W	1.05	
927.00	1.800	122.000	926.72	-1.38	-1.19	1.06	40°27'09.733"N	104°41'17.625"W	4.52	
991.00	0.800	278.600	990.71	-1.92	-1.65	1.47	40°27'09.729"N	104°41'17.620"W	3.99	
1023.00	1.100	299.900	1022.71	-1.63	-1.46	0.98	40°27'09.731"N	104°41'17.626"W	1.43	
1054.00	1.400	304.500	1053.70	-1.16	-1.10	0.41	40°27'09.734"N	104°41'17.634"W	1.02	
1086.00	1.400	310.100	1085.69	-0.57	-0.63	-0.21	40°27'09.739"N	104°41'17.642"W	0.43	
1118.00	1.500	310.000	1117.68	0.06	-0.11	-0.83	40°27'09.744"N	104°41'17.650"W	0.31	
1150.00	1.600	306.900	1149.67	0.73	0.43	-1.51	40°27'09.749"N	104°41'17.658"W	0.41	
1182.00	1.500	304.700	1181.66	1.37	0.94	-2.21	40°27'09.754"N	104°41'17.668"W	0.36	
1212.00	1.500	288.000	1211.65	1.85	1.28	-2.90	40°27'09.758"N	104°41'17.677"W	1.45	
1275.00	3.900	250.200	1274.58	1.96	0.81	-5.70	40°27'09.753"N	104°41'17.713"W	4.55	
1307.00	4.500	247.700	1306.49	1.58	-0.03	-7.89	40°27'09.745"N	104°41'17.741"W	1.96	
1369.00	5.100	249.000	1368.27	0.70	-1.95	-12.71	40°27'09.726"N	104°41'17.803"W	0.98	
1401.00	5.400	248.400	1400.14	0.22	-3.01	-15.44	40°27'09.715"N	104°41'17.839"W	0.95	
1432.00	5.500	248.400	1431.00	-0.28	-4.09	-18.18	40°27'09.705"N	104°41'17.874"W	0.32	
1464.00	5.700	246.600	1462.84	-0.86	-5.29	-21.06	40°27'09.693"N	104°41'17.911"W	0.83	
1496.00	6.200	242.000	1494.67	-1.66	-6.73	-24.05	40°27'09.678"N	104°41'17.950"W	2.16	
1528.00	7.200	237.800	1526.45	-2.84	-8.61	-27.27	40°27'09.660"N	104°41'17.992"W	3.48	
1559.00	8.000	236.500	1557.18	-4.32	-10.84	-30.71	40°27'09.638"N	104°41'18.036"W	2.64	TIED IN TO SURFACE SURVEY
1654.00	7.840	234.780	1651.27	-9.33	-18.22	-41.52	40°27'09.565"N	104°41'18.176"W	0.30	
1749.00	9.710	228.550	1745.16	-15.86	-27.26	-52.82	40°27'09.476"N	104°41'18.322"W	2.21	
1843.00	12.550	238.480	1837.39	-23.23	-37.85	-67.47	40°27'09.371"N	104°41'18.512"W	3.63	

REFERENCE WELLPATH IDENTIFICATION

Operator	EXTRACTION OIL & GAS	Slot	SLOT#06 MATRIX F-29HN (470'FSL & 2361'FWL SEC.29)
Area	COLORADO	Well	MATRIX F-29HN
Field	WELD COUNTY (NAD83/TRUE NORTH)	Wellbore	MATRIX F-29HN AWB
Facility	SEC.29-T06N-R65W		

WELLPATH DATA (149 stations)

MD [ft]	Inclination [°]	Azimuth [°]	TVD [ft]	Vert Sect [ft]	North [ft]	East [ft]	Latitude	Longitude	DLS [°/100ft]	Comments
1938.00	11.640	239.310	1930.28	-29.81	-48.14	-84.51	40°27'09.269"N	104°41'18.732"W	0.98	
2032.00	11.040	240.060	2022.45	-35.67	-57.47	-100.46	40°27'09.177"N	104°41'18.939"W	0.66	
2127.00	10.350	239.770	2115.80	-41.20	-66.31	-115.72	40°27'09.090"N	104°41'19.136"W	0.73	
2222.00	10.210	238.470	2209.27	-46.73	-75.01	-130.27	40°27'09.004"N	104°41'19.324"W	0.29	
2316.00	11.420	232.240	2301.60	-53.61	-85.06	-144.73	40°27'08.904"N	104°41'19.511"W	1.79	
2411.00	10.800	233.000	2394.82	-61.51	-96.18	-159.27	40°27'08.795"N	104°41'19.699"W	0.67	
2506.00	13.620	233.080	2487.66	-70.05	-108.26	-175.33	40°27'08.675"N	104°41'19.907"W	2.97	
2600.00	12.890	232.500	2579.16	-79.28	-121.29	-192.49	40°27'08.546"N	104°41'20.129"W	0.79	
2696.00	12.220	230.620	2672.86	-88.62	-134.25	-208.84	40°27'08.418"N	104°41'20.340"W	0.82	
2791.00	12.310	230.500	2765.69	-97.98	-147.08	-224.43	40°27'08.292"N	104°41'20.542"W	0.10	
2886.00	12.150	230.730	2858.54	-107.29	-159.84	-239.98	40°27'08.165"N	104°41'20.743"W	0.18	
2981.00	10.890	230.460	2951.62	-116.08	-171.89	-254.64	40°27'08.046"N	104°41'20.933"W	1.33	
3075.00	10.420	230.670	3044.00	-124.13	-182.93	-268.07	40°27'07.937"N	104°41'21.107"W	0.50	
3170.00	9.190	227.420	3137.61	-131.98	-193.50	-280.30	40°27'07.833"N	104°41'21.265"W	1.42	
3265.00	10.280	220.210	3231.25	-141.08	-205.11	-291.36	40°27'07.718"N	104°41'21.408"W	1.72	
3359.00	9.290	223.060	3323.88	-150.60	-217.06	-301.95	40°27'07.600"N	104°41'21.545"W	1.17	
3454.00	12.260	239.390	3417.22	-158.26	-227.81	-315.87	40°27'07.494"N	104°41'21.725"W	4.45	
3549.00	10.560	242.510	3510.34	-163.86	-236.96	-332.28	40°27'07.403"N	104°41'21.937"W	1.90	
3643.00	11.390	253.930	3602.63	-166.88	-243.51	-348.84	40°27'07.339"N	104°41'22.151"W	2.47	
3738.00	10.630	253.520	3695.88	-168.29	-248.59	-366.26	40°27'07.289"N	104°41'22.377"W	0.80	
3833.00	11.940	244.050	3789.05	-171.40	-255.38	-383.50	40°27'07.221"N	104°41'22.600"W	2.38	
3927.00	12.310	243.530	3880.95	-176.30	-264.10	-401.21	40°27'07.135"N	104°41'22.829"W	0.41	
4022.00	12.450	242.810	3973.74	-181.58	-273.29	-419.39	40°27'07.044"N	104°41'23.064"W	0.22	
4117.00	12.120	241.960	4066.56	-187.08	-282.66	-437.30	40°27'06.952"N	104°41'23.296"W	0.40	
4212.00	10.810	238.610	4159.67	-192.85	-291.99	-453.71	40°27'06.860"N	104°41'23.508"W	1.55	
4306.00	11.730	244.910	4251.86	-197.99	-300.63	-469.89	40°27'06.774"N	104°41'23.717"W	1.63	
4400.00	10.670	240.690	4344.07	-202.80	-308.94	-486.13	40°27'06.692"N	104°41'23.927"W	1.42	
4495.00	10.540	235.240	4437.45	-208.83	-318.20	-500.94	40°27'06.601"N	104°41'24.119"W	1.06	
4590.00	10.790	248.470	4530.82	-213.72	-326.42	-516.35	40°27'06.519"N	104°41'24.318"W	2.59	
4685.00	9.620	250.090	4624.32	-216.34	-332.39	-532.08	40°27'06.460"N	104°41'24.522"W	1.27	
4779.00	10.030	253.680	4716.94	-218.08	-337.36	-547.32	40°27'06.411"N	104°41'24.719"W	0.78	
4874.00	10.210	243.960	4810.47	-220.80	-343.38	-562.83	40°27'06.352"N	104°41'24.919"W	1.81	
4968.00	12.100	242.460	4902.69	-225.52	-351.60	-579.05	40°27'06.271"N	104°41'25.129"W	2.03	
5063.00	11.350	241.710	4995.70	-230.86	-360.63	-596.11	40°27'06.181"N	104°41'25.350"W	0.81	
5158.00	10.320	240.520	5089.01	-236.10	-369.25	-611.75	40°27'06.096"N	104°41'25.552"W	1.11	
5252.00	11.130	237.830	5181.37	-241.81	-378.22	-626.76	40°27'06.007"N	104°41'25.746"W	1.01	
5347.00	9.140	235.580	5274.88	-247.89	-387.37	-640.75	40°27'05.917"N	104°41'25.927"W	2.14	
5441.00	10.810	232.570	5367.46	-254.57	-396.95	-653.91	40°27'05.822"N	104°41'26.097"W	1.86	
5536.00	11.830	229.470	5460.61	-263.10	-408.69	-668.39	40°27'05.706"N	104°41'26.285"W	1.25	
5631.00	9.960	230.010	5553.89	-271.66	-420.30	-682.08	40°27'05.592"N	104°41'26.462"W	1.97	
5726.00	11.690	233.800	5647.20	-279.51	-431.27	-696.15	40°27'05.483"N	104°41'26.644"W	1.97	
5821.00	9.720	229.650	5740.54	-287.31	-442.14	-710.02	40°27'05.376"N	104°41'26.823"W	2.23	
5915.00	10.020	225.860	5833.15	-295.48	-452.98	-721.94	40°27'05.269"N	104°41'26.977"W	0.76	
6010.00	11.600	234.810	5926.47	-303.68	-464.24	-735.68	40°27'05.157"N	104°41'27.155"W	2.42	
6105.00	10.040	225.710	6019.79	-311.92	-475.53	-749.41	40°27'05.046"N	104°41'27.333"W	2.43	

REFERENCE WELLPATH IDENTIFICATION

Operator	EXTRACTION OIL & GAS	Slot	SLOT#06 MATRIX F-29HN (470'FSL & 2361'FWL SEC.29)
Area	COLORADO	Well	MATRIX F-29HN
Field	WELD COUNTY (NAD83/TRUE NORTH)	Wellbore	MATRIX F-29HN AWB
Facility	SEC.29-T06N-R65W		

WELLPATH DATA (149 stations)

MD (ft)	Inclination [°]	Azimuth [°]	TVD (ft)	Vert Sect (ft)	North (ft)	East (ft)	Latitude	Longitude	DLS [°/100ft]	Comments
6200.00	11.370	232.480	6113.13	-320.43	-487.01	-762.77	40°27'04.932"N	104°41'27.506"W	1.92	
6295.00	9.550	227.660	6206.55	-328.49	-498.03	-776.02	40°27'04.824"N	104°41'27.677"W	2.12	
6320.00	9.180	226.710	6231.22	-330.58	-500.79	-779.01	40°27'04.796"N	104°41'27.716"W	1.60	
6415.00	12.550	262.680	6324.61	-333.73	-507.31	-794.78	40°27'04.732"N	104°41'27.920"W	7.79	
6509.00	16.650	295.690	6415.71	-324.71	-502.76	-817.10	40°27'04.777"N	104°41'28.208"W	9.69	
6604.00	18.040	331.990	6506.64	-302.23	-483.82	-836.33	40°27'04.964"N	104°41'28.457"W	11.30	
6699.00	22.360	352.380	6595.89	-270.03	-452.87	-845.65	40°27'05.270"N	104°41'28.578"W	8.63	
6793.00	31.570	344.570	6679.61	-227.54	-411.33	-854.59	40°27'05.680"N	104°41'28.693"W	10.48	
6888.00	42.000	354.790	6755.66	-170.94	-355.50	-864.12	40°27'06.232"N	104°41'28.817"W	12.70	
6983.00	49.410	359.830	6821.98	-103.92	-287.66	-867.12	40°27'06.902"N	104°41'28.855"W	8.67	
7077.00	60.870	353.720	6875.65	-27.80	-210.85	-871.74	40°27'07.661"N	104°41'28.915"W	13.30	
7172.00	74.160	356.870	6911.91	59.08	-123.57	-878.80	40°27'08.524"N	104°41'29.007"W	14.32	
7267.00	81.560	356.320	6931.87	150.89	-30.92	-884.32	40°27'09.439"N	104°41'29.078"W	7.81	
7363.00	84.670	354.780	6943.38	245.40	64.08	-891.72	40°27'10.378"N	104°41'29.174"W	3.61	CROSSED SETBACK BOUNDARY (459'FSL & 1470'FWL,SEC.29)
7458.00	92.100	357.570	6946.06	339.36	158.76	-898.05	40°27'11.314"N	104°41'29.256"W	8.35	LANDING POINT (553'FSL & 1463'FWL,SEC.29)
7553.00	89.260	357.510	6944.93	433.08	253.65	-902.12	40°27'12.251"N	104°41'29.308"W	2.99	
7648.00	89.750	357.430	6945.75	526.83	348.56	-906.32	40°27'13.189"N	104°41'29.363"W	0.52	
7742.00	89.720	357.780	6946.18	619.56	442.47	-910.24	40°27'14.117"N	104°41'29.414"W	0.37	
7837.00	87.630	358.270	6948.38	713.13	537.38	-913.52	40°27'15.055"N	104°41'29.456"W	2.26	
7932.00	87.930	357.760	6952.06	806.66	632.26	-916.81	40°27'15.992"N	104°41'29.499"W	0.62	
8027.00	88.460	357.220	6955.05	900.36	727.12	-920.96	40°27'16.930"N	104°41'29.552"W	0.80	
8122.00	86.770	0.060	6959.01	993.69	821.99	-923.22	40°27'17.867"N	104°41'29.582"W	3.48	
8217.00	88.710	0.370	6962.75	1086.52	916.92	-922.86	40°27'18.805"N	104°41'29.577"W	2.07	
8311.00	89.170	0.660	6964.49	1178.34	1010.90	-922.02	40°27'19.734"N	104°41'29.566"W	0.58	
8406.00	90.060	359.880	6965.13	1271.23	1105.89	-921.57	40°27'20.673"N	104°41'29.560"W	1.25	
8501.00	90.370	359.220	6964.77	1364.36	1200.89	-922.31	40°27'21.611"N	104°41'29.570"W	0.77	
8595.00	91.170	359.610	6963.51	1456.55	1294.87	-923.27	40°27'22.540"N	104°41'29.583"W	0.95	
8690.00	91.630	359.300	6961.19	1549.69	1389.84	-924.18	40°27'23.479"N	104°41'29.594"W	0.58	
8785.00	92.350	3.860	6957.89	1642.02	1484.72	-921.56	40°27'24.416"N	104°41'29.561"W	4.86	
8879.00	90.580	1.450	6955.49	1733.00	1578.58	-917.21	40°27'25.344"N	104°41'29.504"W	3.18	
8974.00	89.170	2.570	6955.69	1825.24	1673.52	-913.88	40°27'26.282"N	104°41'29.461"W	1.90	
9163.00	90.920	359.640	6955.54	2009.42	1862.45	-910.23	40°27'28.149"N	104°41'29.414"W	1.81	
9258.00	88.980	0.780	6955.63	2102.33	1957.45	-909.89	40°27'29.087"N	104°41'29.410"W	2.37	
9353.00	90.220	0.010	6956.29	2195.17	2052.44	-909.23	40°27'30.026"N	104°41'29.401"W	1.54	
9448.00	84.600	358.120	6960.58	2288.32	2147.29	-910.78	40°27'30.963"N	104°41'29.421"W	6.24	
9542.00	86.520	357.130	6967.86	2380.77	2240.92	-914.66	40°27'31.889"N	104°41'29.472"W	2.30	
9637.00	86.860	0.690	6973.35	2473.93	2335.73	-916.46	40°27'32.825"N	104°41'29.495"W	3.76	
9732.00	90.180	359.340	6975.80	2566.87	2430.68	-916.44	40°27'33.764"N	104°41'29.495"W	3.77	
9826.00	91.140	359.710	6974.72	2659.02	2524.67	-917.22	40°27'34.692"N	104°41'29.505"W	1.09	
9921.00	93.080	1.360	6971.22	2751.75	2619.59	-916.33	40°27'35.630"N	104°41'29.493"W	2.68	
10016.00	92.470	3.160	6966.62	2843.79	2714.40	-912.59	40°27'36.567"N	104°41'29.445"W	2.00	
10110.00	89.320	4.060	6965.15	2934.37	2808.19	-906.67	40°27'37.494"N	104°41'29.369"W	3.49	
10205.00	90.620	3.850	6965.20	3025.79	2902.96	-900.12	40°27'38.431"N	104°41'29.284"W	1.39	
10300.00	91.600	3.130	6963.36	3117.40	2997.77	-894.34	40°27'39.367"N	104°41'29.209"W	1.28	
10394.00	88.770	0.810	6963.06	3208.68	3091.70	-891.11	40°27'40.296"N	104°41'29.167"W	3.89	

REFERENCE WELLPATH IDENTIFICATION

Operator	EXTRACTION OIL & GAS	Slot	SLOT#06 MATRIX F-29HN (470'FSL & 2361'FWL SEC.29)
Area	COLORADO	Well	MATRIX F-29HN
Field	WELD COUNTY (NAD83/TRUE NORTH)	Wellbore	MATRIX F-29HN AWP
Facility	SEC.29-T06N-R65W		

WELLPATH DATA (149 stations)

MD [ft]	Inclination [°]	Azimuth [°]	TVD [ft]	Vert Sect [ft]	North [ft]	East [ft]	Latitude	Longitude	DLS [°/100ft]	Comments
10489.00	88.710	359.240	6965.15	3301.63	3186.67	-891.07	40°27'41.234"N	104°41'29.167"W	1.65	
10584.00	86.330	359.330	6969.26	3394.75	3281.57	-892.25	40°27'42.172"N	104°41'29.182"W	2.51	
10679.00	85.900	359.230	6975.69	3487.76	3376.34	-893.44	40°27'43.108"N	104°41'29.198"W	0.46	
10774.00	87.600	358.800	6981.08	3580.92	3471.17	-895.07	40°27'44.045"N	104°41'29.219"W	1.85	
10868.00	87.540	358.940	6985.06	3673.20	3565.07	-896.93	40°27'44.973"N	104°41'29.243"W	0.16	
10963.00	89.970	358.290	6987.13	3766.60	3660.01	-899.22	40°27'45.911"N	104°41'29.273"W	2.65	
11057.00	90.460	358.270	6986.78	3859.14	3753.97	-902.04	40°27'46.840"N	104°41'29.309"W	0.52	
11152.00	91.420	358.140	6985.22	3952.68	3848.91	-905.02	40°27'47.778"N	104°41'29.348"W	1.02	
11247.00	89.260	357.690	6984.65	4046.30	3943.84	-908.47	40°27'48.716"N	104°41'29.392"W	2.32	
11341.00	89.020	357.210	6986.06	4139.06	4037.73	-912.66	40°27'49.644"N	104°41'29.447"W	0.57	
11436.00	89.570	356.870	6987.23	4232.92	4132.60	-917.56	40°27'50.581"N	104°41'29.510"W	0.68	
11531.00	90.460	356.610	6987.21	4326.86	4227.44	-922.96	40°27'51.518"N	104°41'29.580"W	0.98	
11638.00	90.920	356.260	6985.92	4432.74	4334.23	-929.62	40°27'52.574"N	104°41'29.666"W	0.54	LAST BHI MWD SURVEY (558'FNL & 1457'FWL, SEC.29)
11681.00	90.920	356.260	6985.23	4475.31	4377.13	-932.42	40°27'52.998"N	104°41'29.702"W	0.00	PROJ TO BIT (515'FNL & 1454'FWL, SEC.29)

HOLE & CASING SECTIONS - Ref Wellbore: MATRIX F-29HN AWP Ref Wellpath: MATRIX F-29HN AWP

String/Diameter	Start MD [ft]	End MD [ft]	Interval [ft]	Start TVD [ft]	End TVD [ft]	Start N/S [ft]	Start E/W [ft]	End N/S [ft]	End E/W [ft]
9.625in Casing	30.00	1570.00	1540.00	30.00	1568.07	0.04	-0.03	-11.68	-31.99

TARGETS

Name	TVD [ft]	North [ft]	East [ft]	Grid East [US ft]	Grid North [US ft]	Latitude	Longitude	Shape
SEC.29-T06N-R65W	-1.00	-38.25	-64.24	3225842.68	1408756.67	40°27'09.367"N	104°41'18.470"W	polygon
MATRIX PAD SHARON SPRINGS SEC.29	6719.00	-38.25	-64.24	3225842.68	1408756.67	40°27'09.367"N	104°41'18.470"W	polygon
SEC.29-T06N-R65W 460' SETBACK	6924.00	-38.25	-64.24	3225842.68	1408756.67	40°27'09.367"N	104°41'18.470"W	polygon
MATRIX F-29HN BHL REV-1 ON PLAT (465'FNL & 1460'FWL SEC.29)	6925.00	4427.16	-926.59	3224939.53	1413213.83	40°27'53.492"N	104°41'29.627"W	point
MATRIX F-29HN LP REV-1 ON PLAT (465'FSL & 1460'FWL SEC.29)	6925.00	70.35	-901.40	3225004.60	1408857.60	40°27'10.440"N	104°41'29.299"W	point
MATRIX F-29HN BHL REV-2 ON PLAT (465'FNL & 1460'FWL SEC.29)	6948.00	4427.16	-926.59	3224939.53	1413213.83	40°27'53.492"N	104°41'29.627"W	point



Actual Wellpath Report

MATRIX F-29HN AWP

Page 6 of 7



REFERENCE WELLPATH IDENTIFICATION			
Operator	EXTRACTION OIL & GAS	Slot	SLOT#06 MATRIX F-29HN (470'FSL & 2361'FWL SEC.29)
Area	COLORADO	Well	MATRIX F-29HN
Field	WELD COUNTY (NAD83/TRUE NORTH)	Wellbore	MATRIX F-29HN AWB
Facility	SEC.29-T06N-R65W		

WELLPATH COMPOSITION - Ref Wellbore: MATRIX F-29HN AWB				Ref Wellpath: MATRIX F-29HN AWP
Start MD	End MD	Positional Uncertainty Model	Log Name/Comment	Wellbore
[ft]	[ft]			
0.00	1559.00	ISCWSA MWD, Rev. 4 (Standard)	MWD SURVEY-SURFACE HOLE <100-1559>	MATRIX F-29HN AWB
1559.00	11638.00	Custom BHI NaviTrak (Standard Rotating+Axial Corr) (Rockies 0.03Gt model)	BHI NAVITRAK MWD STD ROTATING, AXIAL, ROCKIES GT <1654-11638>	MATRIX F-29HN AWB
11638.00	11681.00	Blind Drilling (std)	Projection to bit	MATRIX F-29HN AWB



Actual Wellpath Report

MATRIX F-29HN AWP

Page 7 of 7



REFERENCE WELLPATH IDENTIFICATION

Operator	EXTRACTION OIL & GAS	Slot	SLOT#06 MATRIX F-29HN (470'FSL & 2361'FWL SEC.29)
Area	COLORADO	Well	MATRIX F-29HN
Field	WELD COUNTY (NAD83/TRUE NORTH)	Wellbore	MATRIX F-29HN AWB
Facility	SEC.29-T06N-R65W		

WELLPATH COMMENTS

MD [ft]	Inclination [°]	Azimuth [°]	TVD [ft]	Comment
1559.00	8.000	236.500	1557.18	TIED IN TO SURFACE SURVEY
7363.00	84.670	354.780	6943.38	CROSSED SETBACK BOUNDARY (459'FSL & 1470'FWL,SEC.29)
7458.00	92.100	357.570	6946.06	LANDING POINT (553'FSL & 1463'FWL,SEC.29)
11638.00	90.920	356.260	6985.92	LAST BHI MWD SURVEY (558'FNL & 1457'FWL,SEC.29)
11681.00	90.920	356.260	6985.23	PROJ TO BIT (515'FNL & 1454'FWL,SEC.29)