

Plot reference wellpath is MATRIX C-29H REV-C-0 PWP	Grid System: NAD83 / Lambert Colorado SP, Northern Zone (501), US feet
True vertical depths are referenced to H&P 321 (RKB)	* = Wellpath was transformed from a different geodetic datum
Measured depths are referenced to H&P 321 (RKB)	North Reference: True north
H&P 321 (RKB) to Mean Sea Level: 473' feet	Scale: True distance
Mean Sea Level to Mud line (At Slot: SLOTR03 MATRIX C-29H (444'PSL & 2322'PWL SEC.29)): 0 feet	Depths are in feet
Coordinates are in feet referenced to Slot	Created by: hutaезд on 2017-02-21
	Database: WA_DEN_Denver_Dein

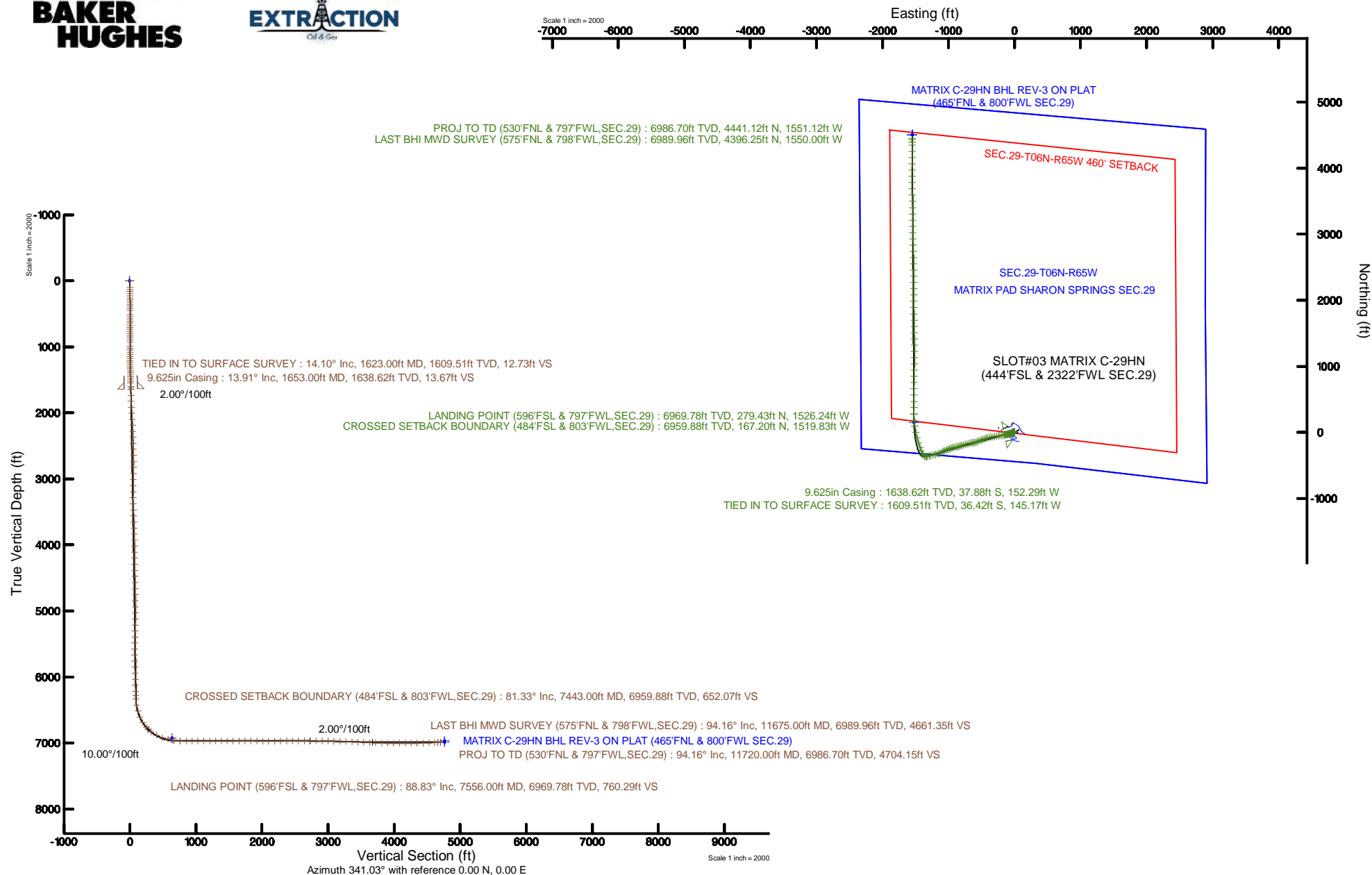

REFERENCE WELLPATH IDENTIFICATION			
Operator	EXTRACTION OIL & GAS	Slot	SLOT#03 MATRIX C-29HN (444'FSL & 2322'FWL SEC.29)
Area	COLORADO	Well	MATRIX C-29HN
Field	WELD COUNTY (NAD83/TRUE NORTH)	Wellbore	MATRIX C-29HN AWP
Facility	SEC.29-T06N-R65W		

REPORT SETUP INFORMATION			
Projection System	NAD83 / Lambert Colorado SP, Northern Zone (501), US feet	Software System	WellArchitect® 5.0
North Reference	True	User	Hutaedr
Scale	0.999963	Report Generated	21/Feb/2017 at 13:24
Convergence at slot	0.53° East	Database/Source file	WA_DEN_Denver_Defn/MATRIX_C-29HN_AWP.xml

WELLPATH LOCATION						
	Local coordinates		Grid coordinates		Geographic coordinates	
	North[ft]	East[ft]	Easting[US ft]	Northing[US ft]	Latitude	Longitude
Slot Location	15.28	25.59	3225868.13	1408772.19	40°27'09.518"N	104°41'18.139"W
Facility Reference Pt			3225842.68	1408756.67	40°27'09.367"N	104°41'18.470"W
Field Reference Pt			3185481.27	1419166.81	40°28'55.560"N	104°49'59.556"W

WELLPATH DATUM			
Calculation method	Minimum curvature	H&P 321 (RKB) to Facility Vertical Datum	4737.00ft
Horizontal Reference Pt	Slot	H&P 321 (RKB) to Mean Sea Level	4737.00ft
Vertical Reference Pt	H&P 321 (RKB)	H&P 321 (RKB) to Mud Line at Slot (SLOT#03 MATRIX C-29HN (444'FSL & 2322'FWL SEC.29))	4737.00ft
MD Reference Pt	H&P 321 (RKB)	Section Origin	N 0.00, E 0.00 ft
Field Vertical Reference	Mean Sea Level	Section Azimuth	341.03°

## REFERENCE WELLPATH IDENTIFICATION

Operator	EXTRACTION OIL & GAS	Slot	SLOT#03 MATRIX C-29HN (444'FSL & 2322'FWL SEC.29)
Area	COLORADO	Well	MATRIX C-29HN
Field	WELD COUNTY (NAD83/TRUE NORTH)	Wellbore	MATRIX C-29HN AWP
Facility	SEC.29-T06N-R65W		

## WELLPATH DATA (156 stations)

MD [ft]	Inclination [°]	Azimuth [°]	TVD [ft]	Vert Sect [ft]	North [ft]	East [ft]	Latitude	Longitude	DLS [°/100ft]	Comments
0.00	0.000	334.700	0.00	0.00	0.00	0.00	40°27'09.518"N	104°41'18.139"W	0.00	
100.00	0.400	334.700	100.00	0.35	0.32	-0.15	40°27'09.521"N	104°41'18.141"W	0.40	
131.00	0.200	0.000	131.00	0.51	0.47	-0.20	40°27'09.523"N	104°41'18.142"W	0.76	
163.00	0.500	331.400	163.00	0.70	0.65	-0.26	40°27'09.524"N	104°41'18.142"W	1.06	
195.00	0.400	310.600	195.00	0.93	0.84	-0.41	40°27'09.526"N	104°41'18.144"W	0.59	
227.00	0.500	355.600	227.00	1.16	1.05	-0.51	40°27'09.528"N	104°41'18.146"W	1.11	
259.00	0.500	332.300	259.00	1.43	1.32	-0.59	40°27'09.531"N	104°41'18.147"W	0.63	
291.00	0.500	341.800	290.99	1.71	1.57	-0.69	40°27'09.534"N	104°41'18.148"W	0.26	
322.00	0.600	340.700	321.99	2.01	1.85	-0.79	40°27'09.536"N	104°41'18.149"W	0.32	
354.00	0.400	345.500	353.99	2.29	2.12	-0.87	40°27'09.539"N	104°41'18.150"W	0.64	
386.00	0.400	325.300	385.99	2.51	2.32	-0.96	40°27'09.541"N	104°41'18.151"W	0.44	
418.00	0.400	312.600	417.99	2.71	2.49	-1.11	40°27'09.543"N	104°41'18.153"W	0.28	
450.00	0.400	321.300	449.99	2.92	2.65	-1.26	40°27'09.544"N	104°41'18.155"W	0.19	
513.00	0.400	351.900	512.99	3.34	3.04	-1.43	40°27'09.548"N	104°41'18.158"W	0.34	
545.00	0.600	313.000	544.99	3.60	3.26	-1.57	40°27'09.550"N	104°41'18.159"W	1.20	
577.00	0.600	326.700	576.98	3.91	3.52	-1.78	40°27'09.553"N	104°41'18.162"W	0.45	
609.00	0.900	281.200	608.98	4.20	3.71	-2.12	40°27'09.555"N	104°41'18.166"W	2.01	
640.00	1.800	258.400	639.97	4.38	3.66	-2.84	40°27'09.554"N	104°41'18.176"W	3.33	
672.00	2.400	253.800	671.95	4.48	3.37	-3.97	40°27'09.551"N	104°41'18.190"W	1.95	
704.00	2.800	245.100	703.92	4.43	2.85	-5.33	40°27'09.546"N	104°41'18.208"W	1.75	
736.00	2.700	246.500	735.88	4.29	2.22	-6.73	40°27'09.540"N	104°41'18.226"W	0.38	
768.00	3.000	239.700	767.84	4.06	1.50	-8.14	40°27'09.533"N	104°41'18.244"W	1.41	
800.00	3.600	243.800	799.79	3.77	0.63	-9.76	40°27'09.524"N	104°41'18.265"W	2.01	
832.00	4.900	247.100	831.70	3.55	-0.34	-11.93	40°27'09.515"N	104°41'18.293"W	4.13	
863.00	5.500	247.500	862.57	3.37	-1.42	-14.52	40°27'09.504"N	104°41'18.327"W	1.94	
895.00	5.400	247.400	894.43	3.18	-2.59	-17.32	40°27'09.492"N	104°41'18.363"W	0.31	
927.00	5.900	247.700	926.27	2.99	-3.79	-20.24	40°27'09.481"N	104°41'18.401"W	1.57	
991.00	7.600	247.200	989.83	2.52	-6.68	-27.18	40°27'09.452"N	104°41'18.491"W	2.66	
1023.00	7.500	246.400	1021.55	2.21	-8.34	-31.05	40°27'09.436"N	104°41'18.541"W	0.45	
1054.00	7.800	246.800	1052.27	1.89	-9.98	-34.83	40°27'09.419"N	104°41'18.590"W	0.98	
1086.00	8.900	250.700	1083.93	1.71	-11.65	-39.17	40°27'09.403"N	104°41'18.646"W	3.86	
1118.00	9.200	252.700	1115.54	1.77	-13.23	-43.94	40°27'09.387"N	104°41'18.707"W	1.36	
1150.00	9.100	251.300	1147.13	1.86	-14.80	-48.78	40°27'09.372"N	104°41'18.770"W	0.76	
1182.00	9.100	251.100	1178.73	1.87	-16.43	-53.57	40°27'09.356"N	104°41'18.832"W	0.10	
1212.00	10.400	257.200	1208.29	2.17	-17.80	-58.46	40°27'09.342"N	104°41'18.895"W	5.53	
1243.00	10.700	259.000	1238.77	2.86	-18.97	-64.01	40°27'09.331"N	104°41'18.967"W	1.44	
1275.00	10.600	257.500	1270.22	3.61	-20.17	-69.80	40°27'09.319"N	104°41'19.042"W	0.92	
1307.00	10.900	256.300	1301.66	4.22	-21.53	-75.62	40°27'09.305"N	104°41'19.117"W	1.17	
1337.00	11.900	258.000	1331.06	4.85	-22.84	-81.40	40°27'09.292"N	104°41'19.192"W	3.52	
1369.00	12.300	259.300	1362.35	5.74	-24.16	-87.97	40°27'09.279"N	104°41'19.277"W	1.51	
1401.00	12.700	259.300	1393.59	6.74	-25.45	-94.78	40°27'09.267"N	104°41'19.365"W	1.25	
1432.00	13.600	260.400	1423.78	7.82	-26.69	-101.72	40°27'09.254"N	104°41'19.455"W	3.01	
1464.00	13.600	260.400	1454.88	9.05	-27.94	-109.14	40°27'09.242"N	104°41'19.551"W	0.00	
1496.00	13.100	256.600	1486.02	10.01	-29.41	-116.38	40°27'09.227"N	104°41'19.644"W	3.16	
1528.00	12.800	254.300	1517.21	10.56	-31.21	-123.32	40°27'09.210"N	104°41'19.734"W	1.86	

## REFERENCE WELLPATH IDENTIFICATION

Operator	EXTRACTION OIL & GAS	Slot	SLOT#03 MATRIX C-29HN (444'FSL & 2322'FWL SEC.29)
Area	COLORADO	Well	MATRIX C-29HN
Field	WELD COUNTY (NAD83/TRUE NORTH)	Wellbore	MATRIX C-29HN AWP
Facility	SEC.29-T06N-R65W		

## WELLPATH DATA (156 stations)

MD [ft]	Inclination [°]	Azimuth [°]	TVD [ft]	Vert Sect [ft]	North [ft]	East [ft]	Latitude	Longitude	DLS [°/100ft]	Comments
1559.00	13.700	255.600	1547.38	11.05	-33.05	-130.18	40°27'09.191"N	104°41'19.823"W	3.06	
1623.00	14.100	259.000	1609.51	12.73	-36.42	-145.17	40°27'09.158"N	104°41'20.017"W	1.42	TIED IN TO SURFACE SURVEY
1750.00	13.320	254.260	1732.89	15.70	-43.34	-174.44	40°27'09.090"N	104°41'20.395"W	1.08	
1845.00	14.300	261.520	1825.15	18.45	-48.04	-196.58	40°27'09.043"N	104°41'20.682"W	2.09	
1940.00	15.030	265.080	1917.06	23.58	-50.83	-220.46	40°27'09.016"N	104°41'20.991"W	1.22	
2034.00	14.080	264.620	2008.04	29.22	-52.95	-243.99	40°27'08.995"N	104°41'21.295"W	1.02	
2129.00	19.450	260.150	2098.97	34.45	-56.74	-271.10	40°27'08.957"N	104°41'21.646"W	5.81	
2224.00	18.460	259.060	2188.82	39.05	-62.30	-301.45	40°27'08.902"N	104°41'22.038"W	1.11	
2318.00	16.860	260.720	2278.39	43.42	-67.32	-329.51	40°27'08.853"N	104°41'22.401"W	1.78	
2413.00	15.390	260.260	2369.65	47.76	-71.68	-355.54	40°27'08.810"N	104°41'22.738"W	1.55	
2507.00	17.090	254.300	2459.90	50.55	-77.53	-381.13	40°27'08.752"N	104°41'23.069"W	2.53	
2602.00	15.600	254.380	2551.06	52.09	-84.74	-406.87	40°27'08.681"N	104°41'23.402"W	1.57	
2697.00	14.190	255.500	2642.86	53.74	-91.10	-430.45	40°27'08.618"N	104°41'23.707"W	1.51	
2793.00	13.540	254.700	2736.07	55.38	-97.01	-452.68	40°27'08.559"N	104°41'23.995"W	0.71	
2888.00	15.880	246.420	2827.96	55.04	-105.15	-475.32	40°27'08.479"N	104°41'24.288"W	3.31	
2982.00	14.450	246.840	2918.68	53.15	-114.90	-497.89	40°27'08.383"N	104°41'24.579"W	1.53	
3077.00	13.700	246.450	3010.83	51.38	-124.06	-519.11	40°27'08.292"N	104°41'24.854"W	0.80	
3171.00	16.910	251.120	3101.49	50.51	-132.93	-542.25	40°27'08.204"N	104°41'25.153"W	3.66	
3266.00	14.090	247.920	3193.02	49.91	-141.75	-566.05	40°27'08.117"N	104°41'25.461"W	3.10	
3361.00	11.720	248.350	3285.62	48.83	-149.66	-585.73	40°27'08.039"N	104°41'25.716"W	2.50	
3455.00	12.660	257.880	3377.51	49.61	-155.35	-604.68	40°27'07.983"N	104°41'25.961"W	2.36	
3550.00	12.770	262.130	3470.18	52.87	-158.97	-625.26	40°27'07.947"N	104°41'26.227"W	0.99	
3645.00	13.120	268.670	3562.77	58.16	-160.66	-646.44	40°27'07.930"N	104°41'26.501"W	1.58	
3739.00	14.180	258.440	3654.13	62.87	-163.21	-668.39	40°27'07.905"N	104°41'26.785"W	2.80	
3834.00	16.850	255.180	3745.66	65.37	-169.07	-693.10	40°27'07.847"N	104°41'27.105"W	2.96	
3929.00	17.010	254.230	3836.54	67.14	-176.37	-719.79	40°27'07.775"N	104°41'27.450"W	0.34	
4024.00	16.900	254.200	3927.41	68.67	-183.90	-746.45	40°27'07.701"N	104°41'27.795"W	0.12	
4119.00	17.010	253.710	4018.28	70.09	-191.56	-773.07	40°27'07.625"N	104°41'28.139"W	0.19	
4214.00	15.230	251.070	4109.54	70.74	-199.51	-798.21	40°27'07.546"N	104°41'28.464"W	2.03	
4308.00	13.240	250.080	4200.65	70.57	-207.18	-820.02	40°27'07.471"N	104°41'28.746"W	2.13	
4402.00	12.460	252.120	4292.30	70.58	-213.96	-839.79	40°27'07.404"N	104°41'29.002"W	0.96	
4497.00	12.760	261.580	4385.02	72.70	-218.65	-859.92	40°27'07.357"N	104°41'29.262"W	2.19	
4592.00	14.420	260.060	4477.36	76.47	-222.22	-881.95	40°27'07.322"N	104°41'29.547"W	1.79	
4687.00	14.660	253.980	4569.32	78.95	-227.58	-905.16	40°27'07.269"N	104°41'29.848"W	1.63	
4781.00	12.060	254.980	4660.77	80.23	-233.41	-926.08	40°27'07.211"N	104°41'30.118"W	2.78	
4876.00	11.850	260.150	4753.71	82.46	-237.65	-945.28	40°27'07.169"N	104°41'30.366"W	1.15	
4970.00	14.550	251.360	4845.23	84.06	-243.08	-965.98	40°27'07.116"N	104°41'30.634"W	3.57	
5065.00	14.230	247.210	4937.25	83.35	-251.42	-988.05	40°27'07.033"N	104°41'30.920"W	1.14	
5160.00	12.920	257.430	5029.61	83.75	-258.25	-1009.19	40°27'06.966"N	104°41'31.193"W	2.87	
5254.00	14.580	246.100	5120.92	83.91	-265.33	-1030.27	40°27'06.896"N	104°41'31.466"W	3.36	
5349.00	15.330	242.500	5212.71	81.01	-275.98	-1052.34	40°27'06.791"N	104°41'31.751"W	1.26	
5444.00	15.770	244.270	5304.23	77.63	-287.38	-1075.11	40°27'06.678"N	104°41'32.046"W	0.68	
5538.00	15.380	238.670	5394.78	73.46	-299.41	-1097.26	40°27'06.559"N	104°41'32.332"W	1.65	
5633.00	14.790	248.740	5486.53	70.27	-310.36	-1119.33	40°27'06.451"N	104°41'32.618"W	2.82	
5728.00	17.290	248.710	5577.82	69.21	-319.88	-1143.79	40°27'06.357"N	104°41'32.934"W	2.63	

REFERENCE WELLPATH IDENTIFICATION			
Operator	EXTRACTION OIL & GAS	Slot	SLOT#03 MATRIX C-29HN (444'FSL & 2322'FWL SEC.29)
Area	COLORADO	Well	MATRIX C-29HN
Field	WELD COUNTY (NAD83/TRUE NORTH)	Wellbore	MATRIX C-29HN AWP
Facility	SEC.29-T06N-R65W		

WELLPATH DATA (156 stations) † = interpolated/extrapolated station										
MD (ft)	Inclination [°]	Azimuth [°]	TVD [ft]	Vert Sect [ft]	North [ft]	East [ft]	Latitude	Longitude	DLS [°/100ft]	Comments
5823.00	16.100	255.810	5668.82	69.74	-328.24	-1169.71	40°27'06.274"N	104°41'33.270"W	2.48	
5917.00	16.090	257.720	5759.14	72.34	-334.20	-1195.08	40°27'06.215"N	104°41'33.598"W	0.56	
6012.00	14.130	256.220	5850.85	74.92	-339.77	-1219.21	40°27'06.160"N	104°41'33.910"W	2.10	
6107.00	15.520	257.980	5942.69	77.51	-345.18	-1242.90	40°27'06.107"N	104°41'34.216"W	1.54	
6202.00	16.040	255.420	6034.11	80.05	-351.13	-1268.04	40°27'06.048"N	104°41'34.541"W	0.91	
6297.00	16.000	256.880	6125.42	82.38	-357.40	-1293.49	40°27'05.986"N	104°41'34.871"W	0.43	
6392.00	14.650	256.170	6217.04	84.79	-363.25	-1317.91	40°27'05.928"N	104°41'35.186"W	1.43	
6454.00	11.830	255.860	6277.39	86.03	-366.67	-1331.68	40°27'05.894"N	104°41'35.365"W	4.55	
6512.00	9.610	263.850	6334.37	87.60	-368.64	-1342.26	40°27'05.875"N	104°41'35.502"W	4.60	
6607.00	17.710	294.580	6426.72	99.35	-363.47	-1363.35	40°27'05.926"N	104°41'35.774"W	11.17	
6702.00	16.150	325.820	6517.79	122.10	-346.49	-1383.96	40°27'06.094"N	104°41'36.041"W	9.60	
6796.00	21.330	338.270	6606.81	151.82	-319.77	-1397.64	40°27'06.358"N	104°41'36.218"W	6.93	
6891.00	32.440	338.330	6691.41	194.67	-279.91	-1413.50	40°27'06.752"N	104°41'36.423"W	11.69	
6986.00	42.050	343.550	6766.96	252.05	-225.58	-1431.96	40°27'07.288"N	104°41'36.662"W	10.64	
7080.00	50.890	341.910	6831.64	320.10	-160.59	-1452.24	40°27'07.931"N	104°41'36.924"W	9.49	
7176.00	63.810	344.450	6883.33	400.69	-83.36	-1475.46	40°27'08.694"N	104°41'37.225"W	13.64	
7270.00	71.180	349.240	6919.30	486.98	1.14	-1495.11	40°27'09.529"N	104°41'37.479"W	9.14	
7366.00	77.140	351.790	6945.50	578.02	92.19	-1510.29	40°27'10.428"N	104°41'37.675"W	6.71	
7443.00†	81.329	353.692	6959.88	652.07	167.20	-1519.83	40°27'11.170"N	104°41'37.799"W	5.96	CROSSED SETBACK BOUNDARY (484'FSL & 803'FWL, SEC.29)
7461.00	82.310	354.130	6962.44	669.44	184.92	-1521.72	40°27'11.345"N	104°41'37.823"W	5.96	
7556.00	88.830	0.370	6969.78	760.29	279.43	-1526.24	40°27'12.279"N	104°41'37.882"W	9.48	LANDING POINT (596'FSL & 797'FWL, SEC.29)
7651.00	89.290	0.410	6971.34	849.91	374.42	-1525.59	40°27'13.217"N	104°41'37.874"W	0.49	
7745.00	90.150	0.180	6971.80	938.64	468.41	-1525.11	40°27'14.146"N	104°41'37.867"W	0.95	
7840.00	91.290	359.700	6970.61	1028.51	563.40	-1525.21	40°27'15.085"N	104°41'37.869"W	1.30	
7935.00	88.580	1.300	6970.71	1118.07	658.39	-1524.38	40°27'16.023"N	104°41'37.858"W	3.31	
8030.00	89.720	1.240	6972.12	1207.19	753.35	-1522.27	40°27'16.962"N	104°41'37.831"W	1.20	
8124.00	90.280	1.520	6972.12	1295.33	847.32	-1520.01	40°27'17.890"N	104°41'37.802"W	0.67	
8219.00	90.460	1.750	6971.51	1384.25	942.28	-1517.30	40°27'18.829"N	104°41'37.767"W	0.31	
8314.00	90.550	1.490	6970.67	1473.18	1037.24	-1514.61	40°27'19.767"N	104°41'37.732"W	0.29	
8409.00	90.490	0.090	6969.81	1562.59	1132.23	-1513.30	40°27'20.706"N	104°41'37.715"W	1.47	
8503.00	90.890	359.590	6968.68	1651.56	1226.22	-1513.57	40°27'21.634"N	104°41'37.719"W	0.68	
8598.00	91.720	359.000	6966.51	1741.75	1321.19	-1514.74	40°27'22.573"N	104°41'37.734"W	1.07	
8693.00	86.860	359.700	6967.69	1831.90	1416.14	-1515.81	40°27'23.511"N	104°41'37.748"W	5.17	
8787.00	88.030	359.420	6971.88	1920.94	1510.04	-1516.53	40°27'24.439"N	104°41'37.757"W	1.28	
8882.00	89.480	359.020	6973.95	2011.17	1605.01	-1517.83	40°27'25.378"N	104°41'37.774"W	1.58	
8976.00	90.340	359.160	6974.09	2100.54	1699.00	-1519.32	40°27'26.306"N	104°41'37.793"W	0.93	
9071.00	91.140	358.640	6972.87	2190.95	1793.97	-1521.14	40°27'27.245"N	104°41'37.817"W	1.00	
9166.00	92.060	357.950	6970.21	2281.64	1888.89	-1523.97	40°27'28.183"N	104°41'37.854"W	1.21	
9261.00	91.020	359.750	6967.66	2372.05	1983.83	-1525.87	40°27'29.121"N	104°41'37.878"W	2.19	
9355.00	89.910	0.610	6966.90	2460.84	2077.83	-1525.58	40°27'30.050"N	104°41'37.875"W	1.49	
9450.00	90.590	0.220	6966.48	2550.46	2172.82	-1524.89	40°27'30.988"N	104°41'37.866"W	0.83	
9545.00	89.910	1.220	6966.07	2639.90	2267.81	-1523.70	40°27'31.927"N	104°41'37.851"W	1.27	
9640.00	88.640	359.160	6967.27	2729.63	2362.80	-1523.38	40°27'32.866"N	104°41'37.847"W	2.55	
9734.00	89.170	358.420	6969.07	2819.13	2456.76	-1525.37	40°27'33.794"N	104°41'37.872"W	0.97	
9829.00	89.630	359.750	6970.06	2909.45	2551.74	-1526.88	40°27'34.733"N	104°41'37.892"W	1.48	

### REFERENCE WELLPATH IDENTIFICATION

Operator	EXTRACTION OIL & GAS	Slot	SLOT#03 MATRIX C-29HN (444'FSL & 2322'FWL SEC.29)
Area	COLORADO	Well	MATRIX C-29HN
Field	WELD COUNTY (NAD83/TRUE NORTH)	Wellbore	MATRIX C-29HN AWB
Facility	SEC.29-T06N-R65W		

### WELLPATH DATA (156 stations)

MD [ft]	Inclination [°]	Azimuth [°]	TVD [ft]	Vert Sect [ft]	North [ft]	East [ft]	Latitude	Longitude	DLS [°/100ft]	Comments
9924.00	88.670	358.350	6971.47	2999.78	2646.71	-1528.46	40°27'35.671"N	104°41'37.912"W	1.79	
10018.00	89.260	358.470	6973.17	3089.48	2740.66	-1531.07	40°27'36.599"N	104°41'37.946"W	0.64	
10113.00	87.690	358.040	6975.70	3180.18	2835.58	-1533.96	40°27'37.537"N	104°41'37.984"W	1.71	
10208.00	88.800	357.120	6978.61	3271.20	2930.45	-1537.97	40°27'38.475"N	104°41'38.036"W	1.52	
10302.00	86.800	359.890	6982.22	3360.79	3024.33	-1540.42	40°27'39.403"N	104°41'38.067"W	3.63	
10397.00	87.100	359.750	6987.27	3450.60	3119.20	-1540.72	40°27'40.340"N	104°41'38.071"W	0.35	
10492.00	87.690	359.960	6991.59	3540.43	3214.10	-1540.96	40°27'41.278"N	104°41'38.075"W	0.66	
10586.00	88.280	359.160	6994.89	3629.50	3308.03	-1541.68	40°27'42.206"N	104°41'38.084"W	1.06	
10681.00	88.000	359.240	6997.98	3719.72	3402.98	-1543.00	40°27'43.144"N	104°41'38.101"W	0.31	
10776.00	88.000	358.070	7001.29	3810.20	3497.89	-1545.23	40°27'44.082"N	104°41'38.130"W	1.23	
10871.00	87.880	357.610	7004.71	3901.09	3592.76	-1548.81	40°27'45.020"N	104°41'38.176"W	0.50	
10965.00	90.220	358.730	7006.27	3990.89	3686.69	-1551.81	40°27'45.948"N	104°41'38.215"W	2.76	
11060.00	90.550	0.330	7005.63	4080.98	3781.68	-1552.59	40°27'46.886"N	104°41'38.226"W	1.72	
11154.00	91.510	359.890	7003.94	4169.81	3875.67	-1552.41	40°27'47.815"N	104°41'38.223"W	1.12	
11249.00	89.570	1.370	7003.04	4259.29	3970.65	-1551.37	40°27'48.754"N	104°41'38.210"W	2.57	
11344.00	90.090	1.370	7003.32	4348.37	4065.62	-1549.09	40°27'49.692"N	104°41'38.181"W	0.55	
11439.00	91.450	0.020	7002.05	4437.82	4160.60	-1547.94	40°27'50.631"N	104°41'38.166"W	2.02	
11533.00	92.720	359.680	6998.63	4526.74	4254.54	-1548.19	40°27'51.559"N	104°41'38.169"W	1.40	
11628.00	93.800	359.220	6993.23	4616.72	4349.38	-1549.10	40°27'52.496"N	104°41'38.181"W	1.24	
11675.00	94.160	358.570	6989.96	4661.35	4396.25	-1550.00	40°27'52.959"N	104°41'38.193"W	1.58	LAST BHI MWD SURVEY (575'FNL & 798'FWL, SEC.29)
11720.00	94.160	358.570	6986.70	4704.15	4441.12	-1551.12	40°27'53.403"N	104°41'38.207"W	0.00	PROJ TO TD (530'FNL & 797'FWL, SEC.29)

### HOLE & CASING SECTIONS - Ref Wellbore: MATRIX C-29HN AWB Ref Wellpath: MATRIX C-29HN AWP

String/Diameter	Start MD [ft]	End MD [ft]	Interval [ft]	Start TVD [ft]	End TVD [ft]	Start N/S [ft]	Start E/W [ft]	End N/S [ft]	End E/W [ft]
9.625in Casing	30.00	1653.00	1623.00	30.00	1638.62	0.03	-0.01	-37.88	-152.29

REFERENCE WELLPATH IDENTIFICATION			
Operator	EXTRACTION OIL & GAS	Slot	SLOT#03 MATRIX C-29HN (444'FSL & 2322'FWL SEC.29)
Area	COLORADO	Well	MATRIX C-29HN
Field	WELD COUNTY (NAD83/TRUE NORTH)	Wellbore	MATRIX C-29HN AWB
Facility	SEC.29-T06N-R65W		

TARGETS								
Name	TVD [ft]	North [ft]	East [ft]	Grid East [US ft]	Grid North [US ft]	Latitude	Longitude	Shape
SEC.29-T06N-R65W	-1.00	-15.28	-25.59	3225842.68	1408756.67	40°27'09.367"N	104°41'18.470"W	polygon
MATRIX PAD SHARON SPRINGS SEC.29	6719.00	-15.28	-25.59	3225842.68	1408756.67	40°27'09.367"N	104°41'18.470"W	polygon
SEC.29-T06N-R65W 460' SETBACK	6924.00	-15.28	-25.59	3225842.68	1408756.67	40°27'09.367"N	104°41'18.470"W	polygon
MATRIX C-29HN BHL REV-1 ON PLAT (465'FNL & 800'FWL SEC.29)	6925.00	4505.93	-1548.48	3224278.53	1413263.58	40°27'54.043"N	104°41'38.173"W	point
MATRIX C-29HN LP REV-1 ON PLAT (465'FSL & 800'FWL SEC.29)	6925.00	148.40	-1522.86	3224344.04	1408906.64	40°27'10.984"N	104°41'37.838"W	point
MATRIX C-29HN BHL REV-2 ON PLAT (465'FNL & 800'FWL SEC.29)	6969.00	4505.93	-1548.48	3224278.53	1413263.58	40°27'54.043"N	104°41'38.173"W	point
MATRIX C-29HN BHL REV-3 ON PLAT (465'FNL & 800'FWL SEC.29)	6986.00	4505.93	-1548.48	3224278.53	1413263.58	40°27'54.043"N	104°41'38.173"W	point

WELLPATH COMPOSITION - Ref Wellbore: MATRIX C-29HN AWB				Ref Wellpath: MATRIX C-29HN AWP	
Start MD [ft]	End MD [ft]	Positional Uncertainty Model	Log Name/Comment		Wellbore
0.00	1623.00	ISCWSA MWD, Rev. 4 (Standard)	MWD SURVEY-SURFACE HOLE <100-1623>		MATRIX C-29HN AWB
1623.00	11675.00	Custom BHI NaviTrak (Standard Rotating+Axial Corr) (Rockies 0.03Gt model)	BHI NAVITRAK MWD, STD ROTATING, AXIAL, ROCKIES GT <1750-11675>		MATRIX C-29HN AWB
11675.00	11720.00	Blind Drilling (std)	Projection to bit		MATRIX C-29HN AWB



# Actual Wellpath Report

MATRIX C-29HN AWP

Page 7 of 7



REFERENCE WELLPATH IDENTIFICATION			
Operator	EXTRACTION OIL & GAS	Slot	SLOT#03 MATRIX C-29HN (444'FSL & 2322'FWL SEC.29)
Area	COLORADO	Well	MATRIX C-29HN
Field	WELD COUNTY (NAD83/TRUE NORTH)	Wellbore	MATRIX C-29HN AWB
Facility	SEC.29-T06N-R65W		

WELLPATH COMMENTS				
MD [ft]	Inclination [°]	Azimuth [°]	TVD [ft]	Comment
1623.00	14.100	259.000	1609.51	TIED IN TO SURFACE SURVEY
7443.00	81.329	353.692	6959.88	CROSSED SETBACK BOUNDARY (484'FSL & 803'FWL,SEC.29)
7556.00	88.830	0.370	6969.78	LANDING POINT (596'FSL & 797'FWL,SEC.29)
11675.00	94.160	358.570	6989.96	LAST BHI MWD SURVEY (575'FNL & 798'FWL,SEC.29)
11720.00	94.160	358.570	6986.70	PROJ TO TD (530'FNL & 797'FWL,SEC.29)