

# EXTRACTION OIL & GAS

Location: COLORADO Slot: SLOT#01 MATRIX A-29HN (427'FSL & 2297'FWL SEC.29)  
Field: WELD COUNTY (NAD83/TRUE NORTH) Well: MATRIX A-29HN  
Facility: SEC.29-T06N-R65W Wellbore: MATRIX A-29HN PWB

|   |  |
|---|--|
| Plot reference wellpath is MATRIX A-29HN REV-A.0 PWP  | Grid System: NAD83 / Lambert Colorado SP, Northern Zone (501), US feet |
| True vertical depths are referenced to H&P 321 (RKB)  | * = Wellpath was transformed from a different geodetic datum           |
| Measured depths are referenced to H&P 321 (RKB)   | North Reference: True north  |
| H&P 321 (RKB) to Mean Sea Level: 4738 feet  | Scale: True distance   |
| Mean Sea Level to Mud line (At Slot: SLOT#01 MATRIX A-29HN (427'FSL & 2297'FWL SEC.29)): 0 feet | Depths are in feet   |
| Coordinates are in feet referenced to Slot  | Created by: hutaedr on 2017-02-20                                      |
|   | Database: WA_DEN_Demer_Defn  |

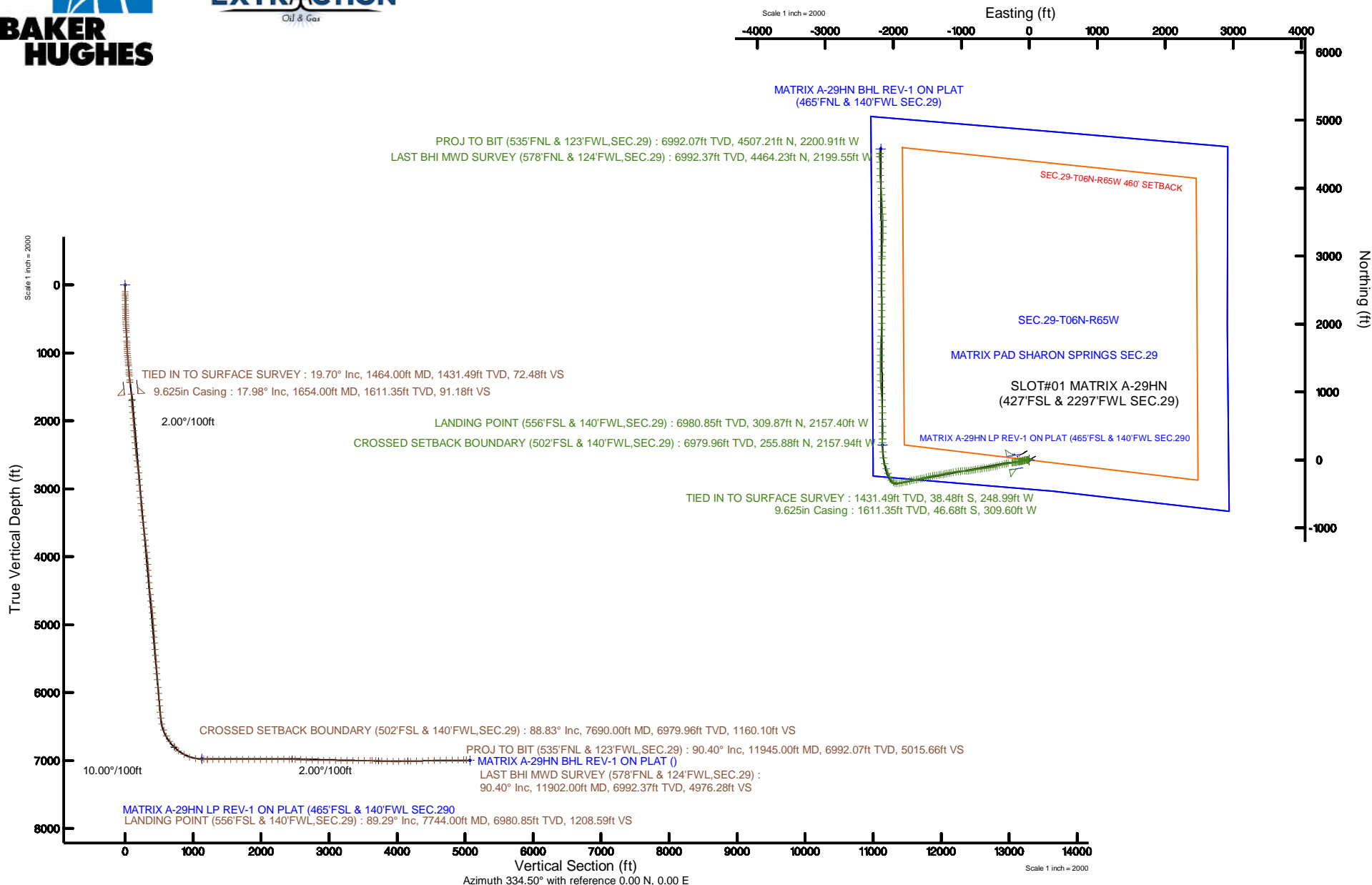

| REFERENCE WELLPATH IDENTIFICATION |                                |          |   |
|-----------------------------------|--------------------------------|----------|---|
| Operator                          | EXTRACTION OIL & GAS           | Slot     | SLOT#01 MATRIX A-29HN (427'FSL & 2297'FWL SEC.29) |
| Area                              | COLORADO                       | Well     | MATRIX A-29HN                                     |
| Field                             | WELD COUNTY (NAD83/TRUE NORTH) | Wellbore | MATRIX A-29HN AWP                                 |
| Facility                          | SEC.29-T06N-R65W               |          |   |

| REPORT SETUP INFORMATION |   |                      |  |
|--------------------------|---|----------------------|--|
| Projection System        | NAD83 / Lambert Colorado SP, Northern Zone (501), US feet | Software System      | WellArchitect® 5.0                       |
| North Reference          | True  | User                 | Hutaedr                                  |
| Scale                    | 0.999963  | Report Generated     | 20/Feb/2017 at 20:58                     |
| Convergence at slot      | 0.53° East  | Database/Source file | WA_DEN_Denver_Defn/MATRIX_A-29HN_AWP.xml |

| WELLPATH LOCATION     |                   |          |                  |                 |                        |                 |
|-----------------------|-------------------|----------|------------------|-----------------|------------------------|-----------------|
|                       | Local coordinates |          | Grid coordinates |                 | Geographic coordinates |                 |
|                       | North[ft]         | East[ft] | Easting[US ft]   | Northing[US ft] | Latitude               | Longitude       |
| Slot Location         | 0.00              | 0.00     | 3225842.68       | 1408756.67      | 40°27'09.367"N         | 104°41'18.470"W |
| Facility Reference Pt |                   |          | 3225842.68       | 1408756.67      | 40°27'09.367"N         | 104°41'18.470"W |
| Field Reference Pt    |                   |          | 3185481.27       | 1419166.81      | 40°28'55.560"N         | 104°49'59.556"W |

| WELLPATH DATUM           |                   |   |                   |
|--------------------------|-------------------|---|-------------------|
| Calculation method       | Minimum curvature | H&P 321 (RKB) to Facility Vertical Datum  | 4738.00ft         |
| Horizontal Reference Pt  | Slot              | H&P 321 (RKB) to Mean Sea Level   | 4738.00ft         |
| Vertical Reference Pt    | H&P 321 (RKB)     | H&P 321 (RKB) to Mud Line at Slot (SLOT#01 MATRIX A-29HN (427'FSL & 2297'FWL SEC.29)) | 4738.00ft         |
| MD Reference Pt          | H&P 321 (RKB)     | Section Origin  | N 0.00, E 0.00 ft |
| Field Vertical Reference | Mean Sea Level    | Section Azimuth   | 334.50°           |

| REFERENCE WELLPATH IDENTIFICATION |                                |          |   |
|-----------------------------------|--------------------------------|----------|---|
| Operator                          | EXTRACTION OIL & GAS           | Slot     | SLOT#01 MATRIX A-29HN (427'FSL & 2297'FWL SEC.29) |
| Area                              | COLORADO                       | Well     | MATRIX A-29HN                                     |
| Field                             | WELD COUNTY (NAD83/TRUE NORTH) | Wellbore | MATRIX A-29HN AWB                                 |
| Facility                          | SEC.29-T06N-R65W               |          |   |

| WELLPATH DATA (151 stations) |                    |                |             |                   |               |              |                |                 |                  |          |
|------------------------------|--------------------|----------------|-------------|-------------------|---------------|--------------|----------------|-----------------|------------------|----------|
| MD<br>[ft]                   | Inclination<br>[°] | Azimuth<br>[°] | TVD<br>[ft] | Vert Sect<br>[ft] | North<br>[ft] | East<br>[ft] | Latitude       | Longitude       | DLS<br>[°/100ft] | Comments |
| 0.00                         | 0.000              | 357.800        | 0.00        | 0.00              | 0.00          | 0.00         | 40°27'09.367"N | 104°41'18.470"W | 0.00             |          |
| 100.00                       | 1.500              | 357.800        | 99.99       | 1.20              | 1.31          | -0.05        | 40°27'09.380"N | 104°41'18.471"W | 1.50             |          |
| 131.00                       | 1.600              | 351.200        | 130.98      | 1.99              | 2.14          | -0.13        | 40°27'09.388"N | 104°41'18.472"W | 0.66             |          |
| 163.00                       | 1.700              | 353.000        | 162.96      | 2.87              | 3.05          | -0.26        | 40°27'09.397"N | 104°41'18.473"W | 0.35             |          |
| 195.00                       | 1.200              | 344.000        | 194.95      | 3.65              | 3.85          | -0.41        | 40°27'09.405"N | 104°41'18.475"W | 1.71             |          |
| 227.00                       | 0.900              | 293.400        | 226.95      | 4.17              | 4.27          | -0.73        | 40°27'09.409"N | 104°41'18.479"W | 2.93             |          |
| 291.00                       | 1.700              | 277.300        | 290.93      | 5.06              | 4.59          | -2.13        | 40°27'09.412"N | 104°41'18.498"W | 1.36             |          |
| 322.00                       | 2.600              | 263.500        | 321.91      | 5.54              | 4.57          | -3.29        | 40°27'09.412"N | 104°41'18.513"W | 3.33             |          |
| 354.00                       | 2.900              | 258.400        | 353.87      | 5.97              | 4.32          | -4.80        | 40°27'09.410"N | 104°41'18.532"W | 1.21             |          |
| 386.00                       | 3.100              | 258.300        | 385.83      | 6.37              | 3.98          | -6.44        | 40°27'09.406"N | 104°41'18.553"W | 0.63             |          |
| 418.00                       | 3.400              | 255.500        | 417.78      | 6.76              | 3.57          | -8.21        | 40°27'09.402"N | 104°41'18.576"W | 1.06             |          |
| 450.00                       | 4.700              | 256.100        | 449.70      | 7.20              | 3.02          | -10.40       | 40°27'09.397"N | 104°41'18.605"W | 4.06             |          |
| 481.00                       | 5.300              | 259.000        | 480.58      | 7.82              | 2.44          | -13.04       | 40°27'09.391"N | 104°41'18.639"W | 2.10             |          |
| 513.00                       | 6.600              | 264.000        | 512.41      | 8.80              | 1.97          | -16.32       | 40°27'09.386"N | 104°41'18.681"W | 4.37             |          |
| 545.00                       | 7.100              | 267.800        | 544.18      | 10.20             | 1.70          | -20.12       | 40°27'09.384"N | 104°41'18.730"W | 2.11             |          |
| 577.00                       | 7.700              | 267.000        | 575.91      | 11.80             | 1.51          | -24.24       | 40°27'09.382"N | 104°41'18.784"W | 1.90             |          |
| 609.00                       | 9.400              | 266.500        | 607.55      | 13.60             | 1.24          | -28.99       | 40°27'09.379"N | 104°41'18.845"W | 5.32             |          |
| 640.00                       | 10.200             | 266.300        | 638.10      | 15.57             | 0.91          | -34.26       | 40°27'09.376"N | 104°41'18.913"W | 2.58             |          |
| 672.00                       | 10.800             | 264.700        | 669.57      | 17.66             | 0.45          | -40.07       | 40°27'09.371"N | 104°41'18.988"W | 2.08             |          |
| 704.00                       | 11.200             | 262.000        | 700.98      | 19.63             | -0.26         | -46.13       | 40°27'09.364"N | 104°41'19.067"W | 2.04             |          |
| 768.00                       | 11.600             | 257.200        | 763.72      | 22.91             | -2.55         | -58.56       | 40°27'09.342"N | 104°41'19.228"W | 1.61             |          |
| 832.00                       | 12.100             | 254.200        | 826.35      | 25.46             | -5.80         | -71.29       | 40°27'09.310"N | 104°41'19.392"W | 1.24             |          |
| 863.00                       | 12.600             | 253.200        | 856.64      | 26.52             | -7.67         | -77.65       | 40°27'09.291"N | 104°41'19.474"W | 1.75             |          |
| 895.00                       | 14.200             | 255.100        | 887.76      | 27.77             | -9.69         | -84.79       | 40°27'09.271"N | 104°41'19.567"W | 5.19             |          |
| 927.00                       | 15.200             | 255.700        | 918.72      | 29.30             | -11.73        | -92.65       | 40°27'09.251"N | 104°41'19.668"W | 3.16             |          |
| 959.00                       | 15.000             | 254.500        | 949.61      | 30.84             | -13.87        | -100.70      | 40°27'09.230"N | 104°41'19.773"W | 1.16             |          |
| 991.00                       | 15.600             | 259.100        | 980.48      | 32.64             | -15.79        | -108.92      | 40°27'09.211"N | 104°41'19.879"W | 4.23             |          |
| 1023.00                      | 15.700             | 262.300        | 1011.29     | 35.05             | -17.19        | -117.44      | 40°27'09.197"N | 104°41'19.989"W | 2.72             |          |
| 1054.00                      | 15.800             | 262.000        | 1041.13     | 37.60             | -18.34        | -125.77      | 40°27'09.186"N | 104°41'20.097"W | 0.42             |          |
| 1086.00                      | 15.300             | 259.800        | 1071.96     | 40.03             | -19.69        | -134.24      | 40°27'09.172"N | 104°41'20.206"W | 2.42             |          |
| 1118.00                      | 15.600             | 259.300        | 1102.80     | 42.24             | -21.24        | -142.62      | 40°27'09.157"N | 104°41'20.315"W | 1.03             |          |
| 1150.00                      | 16.300             | 260.400        | 1133.57     | 44.57             | -22.79        | -151.28      | 40°27'09.142"N | 104°41'20.427"W | 2.38             |          |
| 1182.00                      | 16.400             | 260.300        | 1164.27     | 47.03             | -24.30        | -160.16      | 40°27'09.127"N | 104°41'20.542"W | 0.32             |          |
| 1212.00                      | 18.000             | 261.600        | 1192.93     | 49.55             | -25.69        | -168.92      | 40°27'09.113"N | 104°41'20.655"W | 5.48             |          |
| 1275.00                      | 18.700             | 260.200        | 1252.73     | 55.15             | -28.83        | -188.50      | 40°27'09.082"N | 104°41'20.908"W | 1.31             |          |
| 1307.00                      | 18.600             | 257.900        | 1283.05     | 57.72             | -30.77        | -198.55      | 40°27'09.063"N | 104°41'21.038"W | 2.32             |          |
| 1337.00                      | 18.400             | 256.700        | 1311.50     | 59.83             | -32.86        | -207.83      | 40°27'09.042"N | 104°41'21.158"W | 1.43             |          |
| 1369.00                      | 18.700             | 259.800        | 1341.84     | 62.25             | -34.93        | -217.80      | 40°27'09.022"N | 104°41'21.287"W | 3.22             |          |
| 1432.00                      | 19.600             | 264.800        | 1401.35     | 68.58             | -37.68        | -238.26      | 40°27'08.995"N | 104°41'21.552"W | 2.97             |          |
| 1464.00                      | 19.700             | 266.700        | 1431.49     | 72.48             | -38.48        | -248.99      | 40°27'08.987"N | 104°41'21.691"W | 2.02             |          |
| 1749.00                      | 17.300             | 252.260        | 1701.89     | 96.38             | -54.16        | -337.37      | 40°27'08.832"N | 104°41'22.834"W | 1.81             |          |
| 1844.00                      | 20.520             | 257.970        | 1791.76     | 102.17            | -61.94        | -367.12      | 40°27'08.755"N | 104°41'23.219"W | 3.91             |          |
| 1939.00                      | 22.060             | 259.080        | 1880.27     | 110.54            | -68.79        | -400.92      | 40°27'08.687"N | 104°41'23.656"W | 1.68             |          |
| 2033.00                      | 21.560             | 258.590        | 1967.54     | 119.19            | -75.55        | -435.18      | 40°27'08.620"N | 104°41'24.099"W | 0.57             |          |
| 2128.00                      | 20.620             | 256.210        | 2056.18     | 126.84            | -82.99        | -468.54      | 40°27'08.547"N | 104°41'24.531"W | 1.34             |          |

## REFERENCE WELLPATH IDENTIFICATION

|          |                                |          |   |
|----------|--------------------------------|----------|---|
| Operator | EXTRACTION OIL & GAS           | Slot     | SLOT#01 MATRIX A-29HN (427°FSL & 2297°FWL SEC.29) |
| Area     | COLORADO                       | Well     | MATRIX A-29HN                                     |
| Field    | WELD COUNTY (NAD83/TRUE NORTH) | Wellbore | MATRIX A-29HN AWP                                 |
| Facility | SEC.29-T06N-R65W               |          |   |

## WELLPATH DATA (151 stations)

| MD<br>[ft] | Inclination<br>[°] | Azimuth<br>[°] | TVD<br>[ft] | Vert Sect<br>[ft] | North<br>[ft] | East<br>[ft] | Latitude       | Longitude       | DLS<br>[°/100ft] | Comments |
|------------|--------------------|----------------|-------------|-------------------|---------------|--------------|----------------|-----------------|------------------|----------|
| 2223.00    | 21.420             | 255.670        | 2144.86     | 133.59            | -91.27        | -501.60      | 40°27'08.465"N | 104°41'24.958"W | 0.87             |          |
| 2318.00    | 20.430             | 254.730        | 2233.59     | 139.90            | -99.93        | -534.40      | 40°27'08.379"N | 104°41'25.383"W | 1.10             |          |
| 2412.00    | 18.630             | 260.170        | 2322.19     | 146.87            | -106.82       | -565.02      | 40°27'08.311"N | 104°41'25.779"W | 2.72             |          |
| 2506.00    | 19.660             | 258.430        | 2410.99     | 154.74            | -112.55       | -595.31      | 40°27'08.255"N | 104°41'26.171"W | 1.25             |          |
| 2601.00    | 20.840             | 263.840        | 2500.12     | 164.19            | -117.57       | -627.77      | 40°27'08.205"N | 104°41'26.590"W | 2.33             |          |
| 2697.00    | 20.150             | 263.000        | 2590.04     | 175.09            | -121.42       | -661.16      | 40°27'08.167"N | 104°41'27.022"W | 0.78             |          |
| 2792.00    | 19.310             | 262.660        | 2679.47     | 185.18            | -125.42       | -692.98      | 40°27'08.128"N | 104°41'27.434"W | 0.89             |          |
| 2887.00    | 19.260             | 261.930        | 2769.13     | 194.77            | -129.63       | -724.07      | 40°27'08.086"N | 104°41'27.836"W | 0.26             |          |
| 2982.00    | 19.280             | 261.240        | 2858.81     | 203.98            | -134.22       | -755.09      | 40°27'08.041"N | 104°41'28.237"W | 0.24             |          |
| 3076.00    | 17.930             | 261.030        | 2947.90     | 212.57            | -138.84       | -784.72      | 40°27'07.995"N | 104°41'28.621"W | 1.44             |          |
| 3170.00    | 18.770             | 258.740        | 3037.12     | 220.41            | -144.04       | -813.84      | 40°27'07.943"N | 104°41'28.997"W | 1.18             |          |
| 3265.00    | 17.570             | 259.630        | 3127.38     | 227.92            | -149.61       | -842.94      | 40°27'07.888"N | 104°41'29.374"W | 1.30             |          |
| 3360.00    | 15.810             | 256.790        | 3218.38     | 234.42            | -155.15       | -869.65      | 40°27'07.834"N | 104°41'29.719"W | 2.04             |          |
| 3455.00    | 15.900             | 263.370        | 3309.77     | 241.38            | -159.61       | -895.17      | 40°27'07.790"N | 104°41'30.049"W | 1.89             |          |
| 3550.00    | 16.190             | 268.570        | 3401.07     | 250.99            | -161.44       | -921.34      | 40°27'07.772"N | 104°41'30.388"W | 1.54             |          |
| 3644.00    | 18.550             | 270.780        | 3490.78     | 262.96            | -161.57       | -949.40      | 40°27'07.770"N | 104°41'30.751"W | 2.61             |          |
| 3739.00    | 19.420             | 268.960        | 3580.61     | 276.19            | -161.65       | -980.30      | 40°27'07.769"N | 104°41'31.150"W | 1.11             |          |
| 3833.00    | 20.830             | 261.750        | 3668.89     | 287.63            | -164.33       | -1012.47     | 40°27'07.743"N | 104°41'31.567"W | 3.03             |          |
| 3928.00    | 21.320             | 261.520        | 3757.53     | 297.69            | -169.30       | -1046.27     | 40°27'07.694"N | 104°41'32.004"W | 0.52             |          |
| 4023.00    | 21.610             | 261.380        | 3845.94     | 307.83            | -174.47       | -1080.64     | 40°27'07.643"N | 104°41'32.448"W | 0.31             |          |
| 4118.00    | 21.650             | 259.820        | 3934.25     | 317.54            | -180.19       | -1115.19     | 40°27'07.586"N | 104°41'32.895"W | 0.61             |          |
| 4213.00    | 21.070             | 259.830        | 4022.73     | 326.69            | -186.30       | -1149.24     | 40°27'07.526"N | 104°41'33.336"W | 0.61             |          |
| 4307.00    | 18.750             | 260.530        | 4111.10     | 335.33            | -191.77       | -1180.78     | 40°27'07.472"N | 104°41'33.744"W | 2.48             |          |
| 4402.00    | 19.430             | 255.530        | 4200.88     | 342.57            | -198.23       | -1211.14     | 40°27'07.408"N | 104°41'34.137"W | 1.86             |          |
| 4496.00    | 17.240             | 254.580        | 4290.11     | 348.00            | -205.84       | -1239.72     | 40°27'07.333"N | 104°41'34.506"W | 2.35             |          |
| 4591.00    | 17.400             | 260.180        | 4380.81     | 354.31            | -212.01       | -1267.28     | 40°27'07.272"N | 104°41'34.863"W | 1.76             |          |
| 4686.00    | 18.970             | 261.430        | 4471.06     | 362.65            | -216.73       | -1296.55     | 40°27'07.225"N | 104°41'35.241"W | 1.70             |          |
| 4780.00    | 21.100             | 263.390        | 4559.37     | 372.58            | -220.96       | -1328.47     | 40°27'07.183"N | 104°41'35.654"W | 2.38             |          |
| 4875.00    | 18.500             | 261.600        | 4648.74     | 382.55            | -225.13       | -1360.37     | 40°27'07.142"N | 104°41'36.067"W | 2.81             |          |
| 4970.00    | 19.010             | 261.220        | 4738.70     | 391.44            | -229.69       | -1390.57     | 40°27'07.097"N | 104°41'36.458"W | 0.55             |          |
| 5064.00    | 20.830             | 258.680        | 4827.07     | 399.94            | -235.31       | -1422.10     | 40°27'07.041"N | 104°41'36.865"W | 2.14             |          |
| 5159.00    | 18.060             | 257.230        | 4916.64     | 407.32            | -241.88       | -1453.03     | 40°27'06.976"N | 104°41'37.265"W | 2.96             |          |
| 5253.00    | 20.990             | 257.440        | 5005.23     | 414.31            | -248.77       | -1483.68     | 40°27'06.908"N | 104°41'37.662"W | 3.12             |          |
| 5348.00    | 21.690             | 257.340        | 5093.72     | 422.02            | -256.31       | -1517.41     | 40°27'06.834"N | 104°41'38.098"W | 0.74             |          |
| 5443.00    | 17.350             | 253.430        | 5183.24     | 428.13            | -264.20       | -1548.13     | 40°27'06.756"N | 104°41'38.496"W | 4.77             |          |
| 5538.00    | 18.320             | 257.230        | 5273.67     | 433.62            | -271.54       | -1576.27     | 40°27'06.683"N | 104°41'38.860"W | 1.59             |          |
| 5633.00    | 17.090             | 260.860        | 5364.18     | 440.84            | -277.06       | -1604.62     | 40°27'06.629"N | 104°41'39.226"W | 1.74             |          |
| 5727.00    | 18.440             | 261.330        | 5453.69     | 449.04            | -281.50       | -1632.95     | 40°27'06.585"N | 104°41'39.593"W | 1.44             |          |
| 5822.00    | 20.420             | 258.060        | 5543.28     | 457.28            | -287.19       | -1664.02     | 40°27'06.529"N | 104°41'39.995"W | 2.38             |          |
| 5917.00    | 21.610             | 254.820        | 5631.96     | 464.30            | -295.20       | -1697.12     | 40°27'06.449"N | 104°41'40.423"W | 1.75             |          |
| 6011.00    | 18.750             | 254.210        | 5720.18     | 469.95            | -303.85       | -1728.37     | 40°27'06.364"N | 104°41'40.827"W | 3.05             |          |
| 6106.00    | 19.210             | 259.260        | 5810.02     | 476.51            | -310.91       | -1758.42     | 40°27'06.294"N | 104°41'41.216"W | 1.79             |          |
| 6227.00    | 19.140             | 259.340        | 5924.31     | 486.67            | -318.29       | -1797.47     | 40°27'06.221"N | 104°41'41.721"W | 0.06             |          |
| 6322.00    | 18.510             | 258.070        | 6014.23     | 494.20            | -324.29       | -1827.53     | 40°27'06.162"N | 104°41'42.110"W | 0.79             |          |
| 6417.00    | 17.880             | 254.310        | 6104.48     | 500.22            | -331.35       | -1856.33     | 40°27'06.092"N | 104°41'42.482"W | 1.40             |          |

## REFERENCE WELLPATH IDENTIFICATION

|          |                                |          |   |
|----------|--------------------------------|----------|---|
| Operator | EXTRACTION OIL & GAS           | Slot     | SLOT#01 MATRIX A-29HN (427'FSL & 2297'FWL SEC.29) |
| Area     | COLORADO                       | Well     | MATRIX A-29HN                                     |
| Field    | WELD COUNTY (NAD83/TRUE NORTH) | Wellbore | MATRIX A-29HN AWP                                 |
| Facility | SEC.29-T06N-R65W               |          |   |

## WELLPATH DATA (151 stations) † = interpolated/extrapolated station

| MD<br>[ft] | Inclination<br>[°] | Azimuth<br>[°] | TVD<br>[ft] | Vert Sect<br>[ft] | North<br>[ft] | East<br>[ft] | Latitude       | Longitude       | DLS<br>[°/100ft] | Comments   |
|------------|--------------------|----------------|-------------|-------------------|---------------|--------------|----------------|-----------------|------------------|--|
| 6511.00    | 16.960             | 262.450        | 6194.18     | 506.91            | -337.06       | -1883.82     | 40°27'06.036"N | 104°41'42.838"W | 2.77             |  |
| 6606.00    | 17.820             | 266.910        | 6284.84     | 516.72            | -339.66       | -1912.07     | 40°27'06.010"N | 104°41'43.203"W | 1.67             |  |
| 6700.00    | 19.860             | 263.590        | 6373.81     | 527.43            | -342.22       | -1942.30     | 40°27'05.985"N | 104°41'43.594"W | 2.45             |  |
| 6795.00    | 17.930             | 286.690        | 6463.81     | 542.56            | -339.82       | -1972.39     | 40°27'06.008"N | 104°41'43.983"W | 8.08             |  |
| 6890.00    | 22.620             | 304.490        | 6552.98     | 568.24            | -325.25       | -2001.50     | 40°27'06.152"N | 104°41'44.360"W | 8.11             |  |
| 6984.00    | 28.690             | 326.370        | 6637.86     | 606.35            | -296.14       | -2028.98     | 40°27'06.440"N | 104°41'44.715"W | 11.87            |  |
| 7079.00    | 36.480             | 333.410        | 6717.88     | 657.25            | -251.81       | -2054.30     | 40°27'06.878"N | 104°41'45.043"W | 9.11             |  |
| 7174.00    | 42.040             | 339.830        | 6791.44     | 717.23            | -196.63       | -2077.94     | 40°27'07.423"N | 104°41'45.349"W | 7.24             |  |
| 7269.00    | 52.060             | 339.630        | 6856.08     | 786.39            | -131.49       | -2102.01     | 40°27'08.067"N | 104°41'45.660"W | 10.55            |  |
| 7365.00    | 60.030             | 346.320        | 6909.70     | 864.98            | -55.42        | -2125.07     | 40°27'08.818"N | 104°41'45.959"W | 10.11            |  |
| 7460.00    | 73.730             | 351.700        | 6946.94     | 949.27            | 30.14         | -2141.48     | 40°27'09.664"N | 104°41'46.171"W | 15.33            |  |
| 7555.00    | 79.400             | 353.290        | 6969.00     | 1037.10           | 121.71        | -2153.52     | 40°27'10.569"N | 104°41'46.327"W | 6.19             |  |
| 7650.00    | 88.490             | 0.710          | 6979.03     | 1124.21           | 215.89        | -2158.41     | 40°27'11.499"N | 104°41'46.390"W | 12.32            |  |
| 7690.00†   | 88.830             | 0.629          | 6979.96     | 1160.10           | 255.88        | -2157.94     | 40°27'11.895"N | 104°41'46.384"W | 0.87             | CROSSED SETBACK BOUNDARY (502'FSL & 140'FWL, SEC.29) |
| 7744.00    | 89.290             | 0.520          | 6980.85     | 1208.59           | 309.87        | -2157.40     | 40°27'12.428"N | 104°41'46.377"W | 0.87             | LANDING POINT (556'FSL & 140'FWL, SEC.29)            |
| 7839.00    | 89.480             | 0.470          | 6981.87     | 1293.97           | 404.86        | -2156.58     | 40°27'13.367"N | 104°41'46.367"W | 0.21             |  |
| 7933.00    | 90.030             | 359.510        | 6982.27     | 1378.82           | 498.85        | -2156.59     | 40°27'14.296"N | 104°41'46.367"W | 1.18             |  |
| 8029.00    | 89.570             | 359.000        | 6982.61     | 1465.99           | 594.85        | -2157.84     | 40°27'15.244"N | 104°41'46.383"W | 0.72             |  |
| 8123.00    | 90.310             | 358.720        | 6982.70     | 1551.62           | 688.83        | -2159.71     | 40°27'16.173"N | 104°41'46.408"W | 0.84             |  |
| 8218.00    | 90.180             | 357.850        | 6982.30     | 1638.55           | 783.78        | -2162.56     | 40°27'17.111"N | 104°41'46.445"W | 0.93             |  |
| 8313.00    | 89.750             | 357.010        | 6982.36     | 1726.04           | 878.68        | -2166.82     | 40°27'18.049"N | 104°41'46.500"W | 0.99             |  |
| 8407.00    | 90.550             | 356.440        | 6982.11     | 1813.05           | 972.53        | -2172.19     | 40°27'18.976"N | 104°41'46.569"W | 1.04             |  |
| 8502.00    | 90.090             | 354.450        | 6981.58     | 1901.76           | 1067.22       | -2179.73     | 40°27'19.912"N | 104°41'46.667"W | 2.15             |  |
| 8597.00    | 89.940             | 358.810        | 6981.55     | 1989.74           | 1162.04       | -2185.31     | 40°27'20.849"N | 104°41'46.739"W | 4.59             |  |
| 8691.00    | 90.490             | 359.210        | 6981.20     | 2075.27           | 1256.02       | -2186.94     | 40°27'21.777"N | 104°41'46.760"W | 0.72             |  |
| 8786.00    | 89.750             | 1.300          | 6981.00     | 2160.82           | 1351.01       | -2186.51     | 40°27'22.716"N | 104°41'46.755"W | 2.33             |  |
| 8881.00    | 90.150             | 359.680        | 6981.09     | 2246.21           | 1446.01       | -2185.70     | 40°27'23.655"N | 104°41'46.745"W | 1.76             |  |
| 8975.00    | 90.770             | 359.700        | 6980.33     | 2331.26           | 1540.00       | -2186.21     | 40°27'24.584"N | 104°41'46.751"W | 0.66             |  |
| 9070.00    | 88.460             | 1.900          | 6980.97     | 2416.41           | 1634.98       | -2184.88     | 40°27'25.522"N | 104°41'46.734"W | 3.36             |  |
| 9164.00    | 88.370             | 2.430          | 6983.57     | 2499.63           | 1728.88       | -2181.34     | 40°27'26.450"N | 104°41'46.689"W | 0.57             |  |
| 9260.00    | 88.000             | 2.970          | 6986.61     | 2584.19           | 1824.72       | -2176.82     | 40°27'27.397"N | 104°41'46.630"W | 0.68             |  |
| 9354.00    | 87.380             | 3.030          | 6990.40     | 2666.73           | 1918.51       | -2171.90     | 40°27'28.324"N | 104°41'46.567"W | 0.66             |  |
| 9449.00    | 88.610             | 0.750          | 6993.72     | 2751.02           | 2013.40       | -2168.77     | 40°27'29.262"N | 104°41'46.526"W | 2.73             |  |
| 9543.00    | 90.250             | 359.980        | 6994.66     | 2835.59           | 2107.39       | -2168.17     | 40°27'30.190"N | 104°41'46.519"W | 1.93             |  |
| 9638.00    | 89.290             | 359.390        | 6995.04     | 2921.55           | 2202.38       | -2168.69     | 40°27'31.129"N | 104°41'46.526"W | 1.19             |  |
| 9733.00    | 88.980             | 359.050        | 6996.47     | 3007.84           | 2297.36       | -2169.99     | 40°27'32.068"N | 104°41'46.542"W | 0.48             |  |
| 9828.00    | 90.000             | 0.330          | 6997.32     | 3093.79           | 2392.35       | -2170.50     | 40°27'33.006"N | 104°41'46.549"W | 1.72             |  |
| 9922.00    | 89.750             | 0.460          | 6997.52     | 3178.35           | 2486.35       | -2169.85     | 40°27'33.935"N | 104°41'46.541"W | 0.30             |  |
| 10017.00   | 89.690             | 0.450          | 6997.99     | 3263.77           | 2581.35       | -2169.10     | 40°27'34.874"N | 104°41'46.531"W | 0.06             |  |
| 10112.00   | 89.940             | 0.100          | 6998.29     | 3349.31           | 2676.35       | -2168.64     | 40°27'35.812"N | 104°41'46.525"W | 0.45             |  |
| 10206.00   | 89.780             | 0.270          | 6998.52     | 3434.02           | 2770.34       | -2168.34     | 40°27'36.741"N | 104°41'46.522"W | 0.25             |  |
| 10301.00   | 90.340             | 0.940          | 6998.43     | 3519.32           | 2865.34       | -2167.33     | 40°27'37.680"N | 104°41'46.509"W | 0.92             |  |
| 10395.00   | 88.580             | 2.060          | 6999.31     | 3603.07           | 2959.30       | -2164.87     | 40°27'38.608"N | 104°41'46.477"W | 2.22             |  |
| 10427.00   | 88.310             | 1.490          | 7000.18     | 3631.50           | 2991.27       | -2163.88     | 40°27'38.924"N | 104°41'46.464"W | 1.97             |  |
| 10490.00   | 88.590             | 1.030          | 7001.88     | 3687.73           | 3054.23       | -2162.50     | 40°27'39.547"N | 104°41'46.446"W | 0.85             |  |

### REFERENCE WELLPATH IDENTIFICATION

|          |                                |          |   |
|----------|--------------------------------|----------|---|
| Operator | EXTRACTION OIL & GAS           | Slot     | SLOT#01 MATRIX A-29HN (427'FSL & 2297'FWL SEC.29) |
| Area     | COLORADO                       | Well     | MATRIX A-29HN                                     |
| Field    | WELD COUNTY (NAD83/TRUE NORTH) | Wellbore | MATRIX A-29HN AWB                                 |
| Facility | SEC.29-T06N-R65W               |          |   |

### WELLPATH DATA (151 stations)

| MD<br>[ft] | Inclination<br>[°] | Azimuth<br>[°] | TVD<br>[ft] | Vert Sect<br>[ft] | North<br>[ft] | East<br>[ft] | Latitude       | Longitude       | DLS<br>[°/100ft] | Comments  |
|------------|--------------------|----------------|-------------|-------------------|---------------|--------------|----------------|-----------------|------------------|---|
| 10585.00   | 87.810             | 2.550          | 7004.87     | 3772.11           | 3149.13       | -2159.53     | 40°27'40.484"N | 104°41'46.408"W | 1.80             |   |
| 10680.00   | 87.500             | 2.250          | 7008.75     | 3855.99           | 3243.97       | -2155.56     | 40°27'41.421"N | 104°41'46.357"W | 0.45             |   |
| 10775.00   | 89.200             | 0.750          | 7011.49     | 3940.59           | 3338.89       | -2153.07     | 40°27'42.359"N | 104°41'46.325"W | 2.39             |   |
| 10869.00   | 90.980             | 0.760          | 7011.34     | 4024.89           | 3432.88       | -2151.83     | 40°27'43.288"N | 104°41'46.309"W | 1.89             |   |
| 10964.00   | 90.800             | 357.760        | 7009.87     | 4111.13           | 3527.85       | -2153.06     | 40°27'44.227"N | 104°41'46.325"W | 3.16             |   |
| 11058.00   | 90.340             | 356.510        | 7008.93     | 4197.88           | 3621.73       | -2157.76     | 40°27'45.154"N | 104°41'46.386"W | 1.42             |   |
| 11153.00   | 91.630             | 357.230        | 7007.30     | 4285.72           | 3716.57       | -2162.95     | 40°27'46.091"N | 104°41'46.453"W | 1.56             |   |
| 11248.00   | 92.210             | 356.980        | 7004.12     | 4373.37           | 3811.39       | -2167.74     | 40°27'47.028"N | 104°41'46.515"W | 0.66             |   |
| 11343.00   | 92.930             | 356.260        | 6999.86     | 4461.28           | 3906.13       | -2173.34     | 40°27'47.965"N | 104°41'46.588"W | 1.07             |   |
| 11437.00   | 91.080             | 355.490        | 6996.57     | 4548.76           | 3999.83       | -2180.09     | 40°27'48.890"N | 104°41'46.675"W | 2.13             |   |
| 11532.00   | 91.510             | 355.090        | 6994.42     | 4637.54           | 4094.48       | -2187.89     | 40°27'49.826"N | 104°41'46.776"W | 0.62             |   |
| 11627.00   | 90.250             | 359.110        | 6992.96     | 4725.22           | 4189.33       | -2192.70     | 40°27'50.763"N | 104°41'46.838"W | 4.43             |   |
| 11722.00   | 89.880             | 359.160        | 6992.85     | 4811.57           | 4284.31       | -2194.13     | 40°27'51.702"N | 104°41'46.857"W | 0.39             |   |
| 11816.00   | 90.180             | 357.850        | 6992.80     | 4897.43           | 4378.28       | -2196.58     | 40°27'52.630"N | 104°41'46.889"W | 1.43             |   |
| 11902.00   | 90.400             | 358.190        | 6992.37     | 4976.28           | 4464.23       | -2199.55     | 40°27'53.479"N | 104°41'46.927"W | 0.47             | LAST BHI MWD SURVEY (578'FNL & 124'FWL, SEC.29) |
| 11945.00   | 90.400             | 358.190        | 6992.07     | 5015.66           | 4507.21       | -2200.91     | 40°27'53.904"N | 104°41'46.945"W | 0.00             | PROJ TO BIT (535 FNL 123 FWL SEC.29)            |

### TARGETS

| Name  | TVD<br>[ft] | North<br>[ft] | East<br>[ft] | Grid East<br>[US ft] | Grid North<br>[US ft] | Latitude       | Longitude       | Shape   |
|---|-------------|---------------|--------------|----------------------|-----------------------|----------------|-----------------|---------|
| SEC.29-T06N-R65W  | 0.00        | 0.00          | 0.00         | 3225842.68           | 1408756.67            | 40°27'09.367"N | 104°41'18.470"W | polygon |
| MATRIX PAD SHARON SPRINGS SEC.29                          | 6720.00     | 0.00          | 0.00         | 3225842.68           | 1408756.67            | 40°27'09.367"N | 104°41'18.470"W | polygon |
| SEC.29-T06N-R65W 460' SETBACK                             | 6925.00     | 0.00          | 0.00         | 3225842.68           | 1408756.67            | 40°27'09.367"N | 104°41'18.470"W | polygon |
| MATRIX A-29HN LP REV-1 ON PLAT (465'FSL & 140'FWL SEC.290 | 6974.00     | 219.09        | -2157.70     | 3223683.16           | 1408956.00            | 40°27'11.531"N | 104°41'46.381"W | point   |
| MATRIX A-29HN BHL REV-1 ON PLAT ()                        | 6997.00     | 4577.02       | -2183.52     | 3223617.46           | 1413313.34            | 40°27'54.594"N | 104°41'46.720"W | point   |

### WELLPATH COMPOSITION - Ref Wellbore: MATRIX A-29HN AWB Ref Wellpath: MATRIX A-29HN AWP

| Start MD<br>[ft] | End MD<br>[ft] | Positional Uncertainty Model  | Log Name/Comment  | Wellbore          |
|------------------|----------------|---|---|-------------------|
| 0.00             | 1464.00        | ISCWSA MWD, Rev. 4 (Standard)   | MWD SURVEY-SURFACE HOLE <100-1464>                              | MATRIX A-29HN AWB |
| 1464.00          | 11902.00       | Custom BHI NaviTrak (Standard Rotating+Axial Corr) (Rockies 0.03Gt model) | BHI NAVITRAK MWD, STD ROTATING, AXIAL, ROCKIES GT <17949-11902> | MATRIX A-29HN AWB |
| 11902.00         | 11945.00       | Blind Drilling (std)  | Projection to bit   | MATRIX A-29HN AWB |



# Actual Wellpath Report

MATRIX A-29HN AWP

Page 6 of 6



| REFERENCE WELLPATH IDENTIFICATION |                                |          |   |
|-----------------------------------|--------------------------------|----------|---|
| Operator                          | EXTRACTION OIL & GAS           | Slot     | SLOT#01 MATRIX A-29HN (427'FSL & 2297'FWL SEC.29) |
| Area                              | COLORADO                       | Well     | MATRIX A-29HN                                     |
| Field                             | WELD COUNTY (NAD83/TRUE NORTH) | Wellbore | MATRIX A-29HN AWB                                 |
| Facility                          | SEC.29-T06N-R65W               |          |   |

| WELLPATH COMMENTS |                    |                |             |   |
|-------------------|--------------------|----------------|-------------|---|
| MD<br>[ft]        | Inclination<br>[°] | Azimuth<br>[°] | TVD<br>[ft] | Comment   |
| 7690.00           | 88.830             | 0.629          | 6979.96     | CROSSED SETBACK BOUNDARY (502'FSL & 140'FWL,SEC.29) |
| 7744.00           | 89.290             | 0.520          | 6980.85     | LANDING POINT (556'FSL & 140'FWL,SEC.29)            |
| 11902.00          | 90.400             | 358.190        | 6992.37     | LAST BHI MWD SURVEY (578'FNL & 124'FWL,SEC.29)      |
| 11945.00          | 90.400             | 358.190        | 6992.07     | PROJ TO BIT (535 FNL 123 FWL SEC.29)                |