

→ FIRST OCCUPATION
→ SECOND OCCUPATION

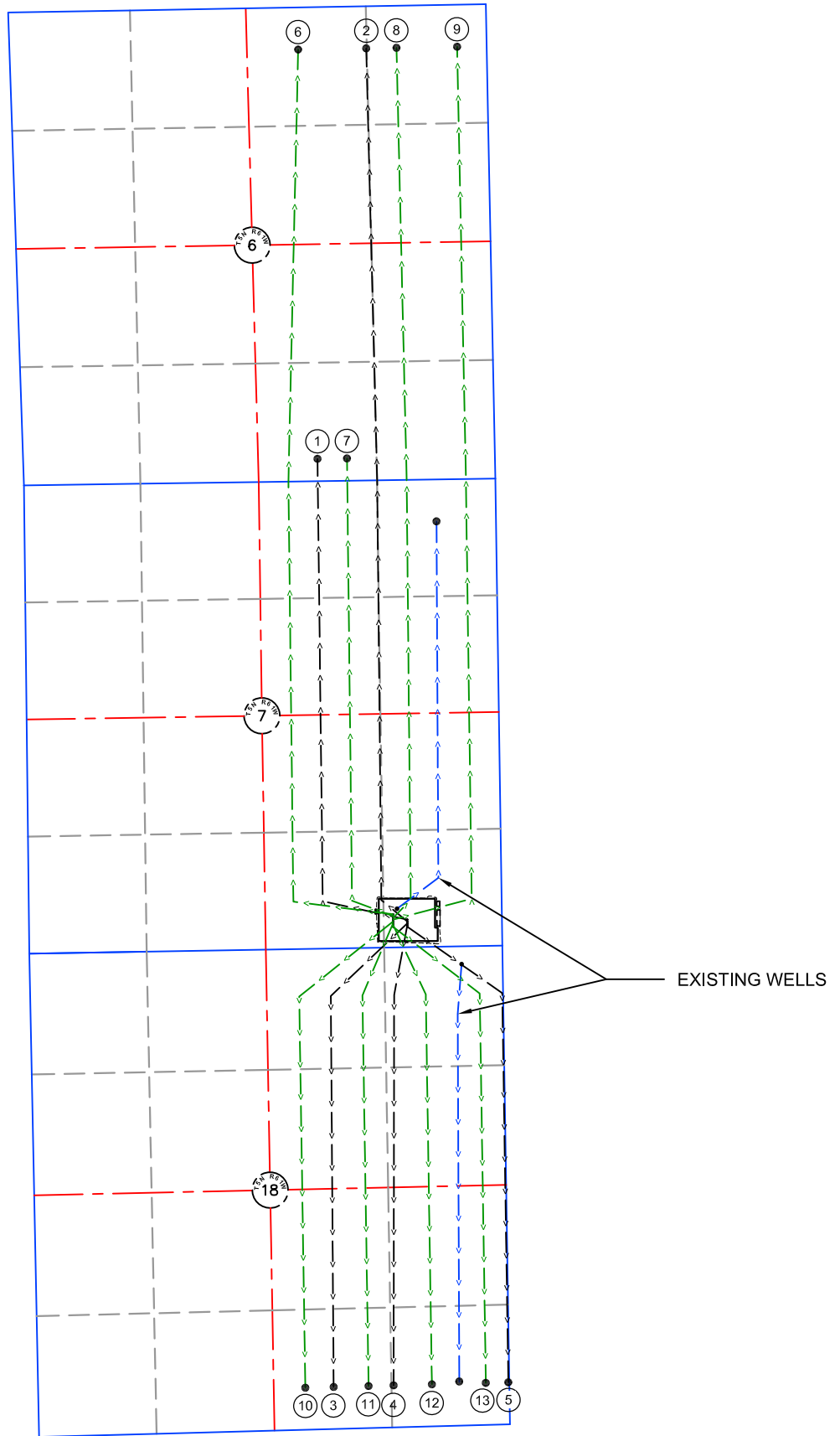

**WILLIAM H. SMITH &
ASSOCIATES, Inc.**
155 N. 1st Street
Lander, WY 82520
Phone: 307-335-5646

Drawn By: MAM
Job No.: 15043
Revision:
Checked By: DAF
Date: 08/19/16

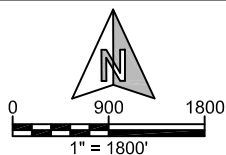

IF BAR LENGTH DOES NOT EQUAL
1"(ONE INCH), THIS PAGE WAS NOT
PLOTTED TO THE INTENDED SCALE.

MULTIWELL LAYOUT

PRONGHORN T-7 PAD
SW $\frac{1}{4}$ SE $\frac{1}{4}$ & SE $\frac{1}{4}$ SE $\frac{1}{4}$,
SECTION 7,
T.5N., R.61W., 6th PM
WELD COUNTY, COLORADO



410 17th Street
Denver, CO 80202
(720) 440-6100

SHEET

1

OF

3

Z:\PROJECTS\1319-01_BONANZA\5N-61W\DWG\PRONGHORN T-7 PRELIM\PRONGHORN T-7 MULTIWELL 2ND OCC.dwg SAVED DATE 2016-09-23 11:24

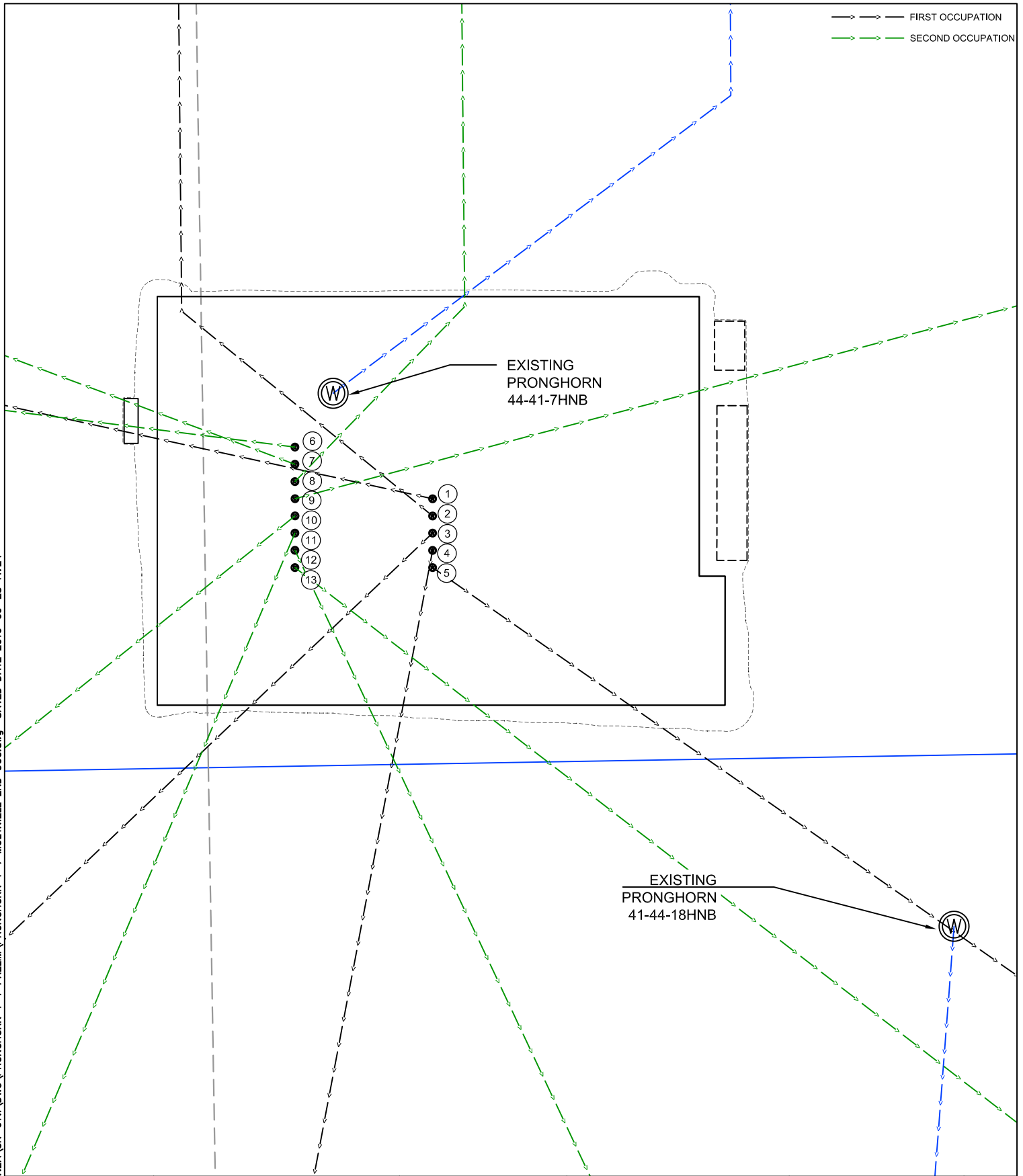

WILLIAM H. SMITH & ASSOCIATES, Inc.
155 N. 1st Street
Lander, WY 82520
Phone: 307-335-5646

Drawn By: MAM	Checked By: DAF
Job No.: 15043	Date: 09/19/16
Revision:	

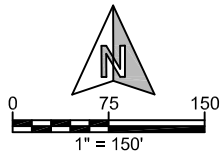

IF BAR LENGTH DOES NOT EQUAL 1" (ONE INCH), THIS PAGE WAS NOT PLOTTED TO THE INTENDED SCALE.

MULTIWELL PAD VIEW

PRONGHORN T-7 PAD
SW $\frac{1}{4}$ SE $\frac{1}{4}$ & SE $\frac{1}{4}$ SE $\frac{1}{4}$,
SECTION 7,
T.5N., R.61W., 6th PM
WELD COUNTY, COLORADO



410 17th Street
Denver, CO 80202
(720) 440-6100

SHEET

2

OF

3

1	NAD 83			SECTION TIES			
34-7-6MRLNB	LATITUDE	LONGITUDE	EXIST. ELV.	QQ			
SURFACE	40.4093738	-104.2466844	4563.5	SESE S7	308	FSL	1059
TARGET 1	40.4099779	-104.250076			531	FSL	2003
BOTTOM HOLE	40.4235659	-104.250035			250	FSL	1985
2							
T-7-6XRLNB	LATITUDE	LONGITUDE	EXIST. ELV.	QQ			
SURFACE	40.4093189	-104.2466855	4563.4	SESE S7	288	FSL	1059
TARGET 1	40.4099832	-104.2477203			531	FSL	1347
MID LATERAL	40.4228801	-104.2476483			0	FNL	1322
BOTTOM HOLE	40.4361517	-104.2478446			470	FNL	1348
3							
31-34-18HNB	LATITUDE	LONGITUDE	EXIST. ELV.	QQ			
SURFACE	40.4092641	-104.2466862	4563.3	SESE S7	268	FSL	1059
TARGET 1	40.4070633	-104.249805			531	FNL	1929
BOTTOM HOLE	40.395052	-104.2499119			470	FSL	1966
4							
P-T-18HNB	LATITUDE	LONGITUDE	EXIST. ELV.	QQ			
SURFACE	40.4092091	-104.2466875	4563.6	SESE S7	248	FSL	1060
TARGET 1	40.407069	-104.2472591			531	FNL	1220
BOTTOM HOLE	40.3950753	-104.2475029			470	FSL	1295
5							
U-Y-18HNB	LATITUDE	LONGITUDE	EXIST. ELV.	QQ			
SURFACE	40.4091542	-104.2466883	4563.8	SESE S7	228	FSL	1060
TARGET 1	40.4070786	-104.2429141			531	FNL	10
BOTTOM HOLE	40.3951197	-104.2428895			470	FSL	10
6							
O34-7-6XRLNC	LATITUDE	LONGITUDE	EXIST. ELV.	QQ			
SURFACE	40.4095449	-104.2472559	4563.8	SESE S7	371	FSL	1218
TARGET 1	40.4099752	-104.2512574			531	FSL	2332
MID LATERAL	40.4228793	-104.2512186			0	FNL	2316
BOTTOM HOLE	40.4361447	-104.250582			470	FNL	2110
7							
T34-7-6MRLNC	LATITUDE	LONGITUDE	EXIST. ELV.	QQ			
SURFACE	40.40949	-104.2472567	4563.9	SESE S7	351	FSL	1218
TARGET 1	40.4099805	-104.2488981			531	FSL	1675
BOTTOM HOLE	40.4235661	-104.2488497			250	FSL	1655
8							
T44-7-6XRLNC	LATITUDE	LONGITUDE	EXIST. ELV.	QQ			
SURFACE	40.4094348	-104.2472577	4563.8	SESE S7	331	FSL	1218
TARGET 1	40.4099858	-104.2465388			531	FSL	1018
MID LATERAL	40.4228804	-104.246463			0	FNL	992
BOTTOM HOLE	40.4361548	-104.2466267			470	FNL	1009
9							
Y44-7-6XRLNC	LATITUDE	LONGITUDE	EXIST. ELV.	QQ			
SURFACE	40.4093802	-104.2472584	4563.9	SESE S7	311	FSL	1219
TARGET 1	40.4099912	-104.2440861			531	FSL	335
MID LATERAL	40.4228808	-104.2440817			0	FNL	329
BOTTOM HOLE	40.436161	-104.2441875			470	FNL	330
10							
K31-O34-18HNC	LATITUDE	LONGITUDE	EXIST. ELV.	QQ			
SURFACE	40.4093252	-104.2472594	4564	SESE S7	291	FSL	1219
TARGET 1	40.4070604	-104.2510762			531	FNL	2283
BOTTOM HOLE	40.3950404	-104.2511182			470	FSL	2302
11							
P31-T34-18HNC	LATITUDE	LONGITUDE	EXIST. ELV.	QQ			
SURFACE	40.4092705	-104.2472608	4564	SESE S7	271	FSL	1219
TARGET 1	40.4070661	-104.2485339			531	FNL	1575
BOTTOM HOLE	40.3950637	-104.2487092			470	FSL	1631
12							
P41-T44-18HNC	LATITUDE	LONGITUDE	EXIST. ELV.	QQ			
SURFACE	40.4092154	-104.2472616	4564.1	SESE S7	251	FSL	1220
TARGET 1	40.4070718	-104.2459879			531	FNL	866
BOTTOM HOLE	40.3950869	-104.2463002			470	FSL	960
13							
U41-Y44-18HNC	LATITUDE	LONGITUDE	EXIST. ELV.	QQ			
SURFACE	40.4091604	-104.2472627	4564.1	SESE S7	231	FSL	1220
TARGET 1	40.4070766	-104.243819			531	FNL	262
BOTTOM HOLE	40.3951091	-104.2439917			470	FSL	317



**WILLIAM H. SMITH &
ASSOCIATES, Inc.**
155 N. 1st Street
Lander, WY 82520
Phone: 307-335-5646

Drawn By: MAM
Job No.: 15043
Revision:

Checked By: DAF
Date: 09/19/16



NO SCALE
IF BAR LENGTH DOES NOT EQUAL
1" (ONE INCH), THIS PAGE WAS NOT
PLOTTED TO THE INTENDED SCALE.

MULTIWELL TABULATION

PRONGHORN T-7 PAD
SW $\frac{1}{4}$ SE $\frac{1}{4}$ & SE $\frac{1}{4}$ SE $\frac{1}{4}$,
SECTION 7,
T.5N., R.61W., 6th PM
WELD COUNTY, COLORADO



410 17th Street
Denver, CO 80202
(720) 440-6100

SHEET

3

OF

3