

T11N

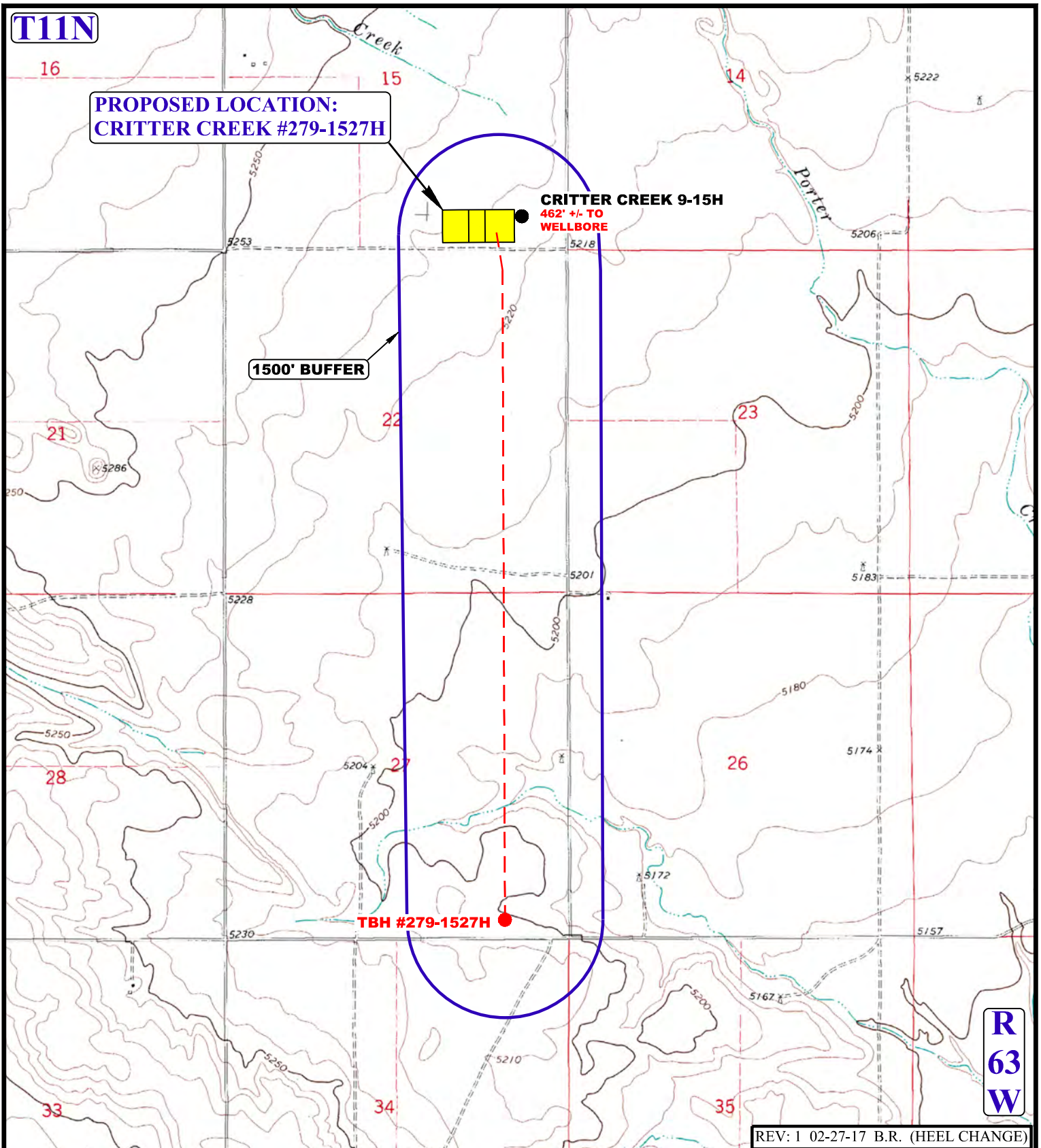

REV: 1 02-27-17 B.R. (HEEL CHANGE)

LEGEND:

- Ø DISPOSAL WELLS
- PRODUCING WELLS
- SHUT IN WELLS
- ABANDONED WELLS
- TEMPORARILY ABANDONED



FIFTH CREEK ENERGY COMPANY, LLC

**CRITTER CREEK #279-1527H
S 1/2 SE 1/4, SECTION 15, T11N, R63W, 6th P.M.
WELD COUNTY, COLORADO**



UELS, LLC
Corporate Office * 85 South 200 East
Vernal, UT 84078 * (435) 789-1017

SURVEYED BY	G.W., N.P.	01-20-17	SCALE
DRAWN BY	T.I.	01-30-17	1 : 24,000
WELL PROXIMITY MAP			TOPO C6