

T11N

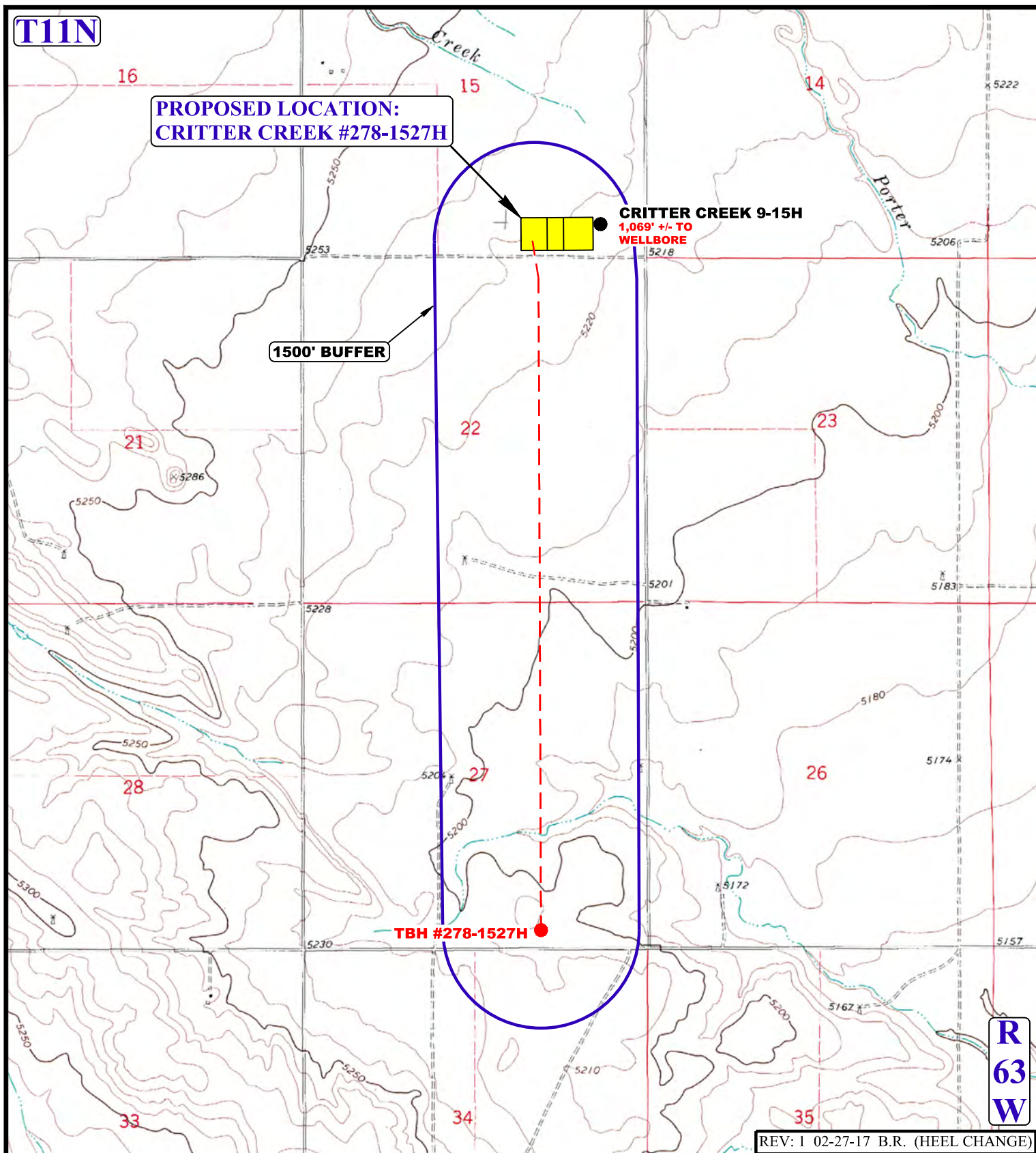

**R
63
W**

REV: 1 02-27-17 B.R. (HEEL CHANGE)

LEGEND:

- Ø DISPOSAL WELLS
- PRODUCING WELLS
- SHUT IN WELLS
- ABANDONED WELLS
- TEMPORARILY ABANDONED



UELS, LLC
Corporate Office * 85 South 200 East
Vernal, UT 84078 * (435) 789-1017



FIFTH CREEK ENERGY COMPANY, LLC

CRITTER CREEK #278-1527H
S 1/2 SE 1/4, SECTION 15, T11N, R63W, 6th P.M.
WELD COUNTY, COLORADO

SURVEYED BY	G.W., N.P.	01-20-17	SCALE
DRAWN BY	T.I.	01-30-17	1 : 24,000
WELL PROXIMITY MAP			TOPO C10