

CANNON 29N-4HZ

HORIZONTAL MULTI-WELL PAD

N1/2 NW1/4 SECTION 33, TOWNSHIP 3 NORTH, RANGE 65 WEST, 6TH P.M.

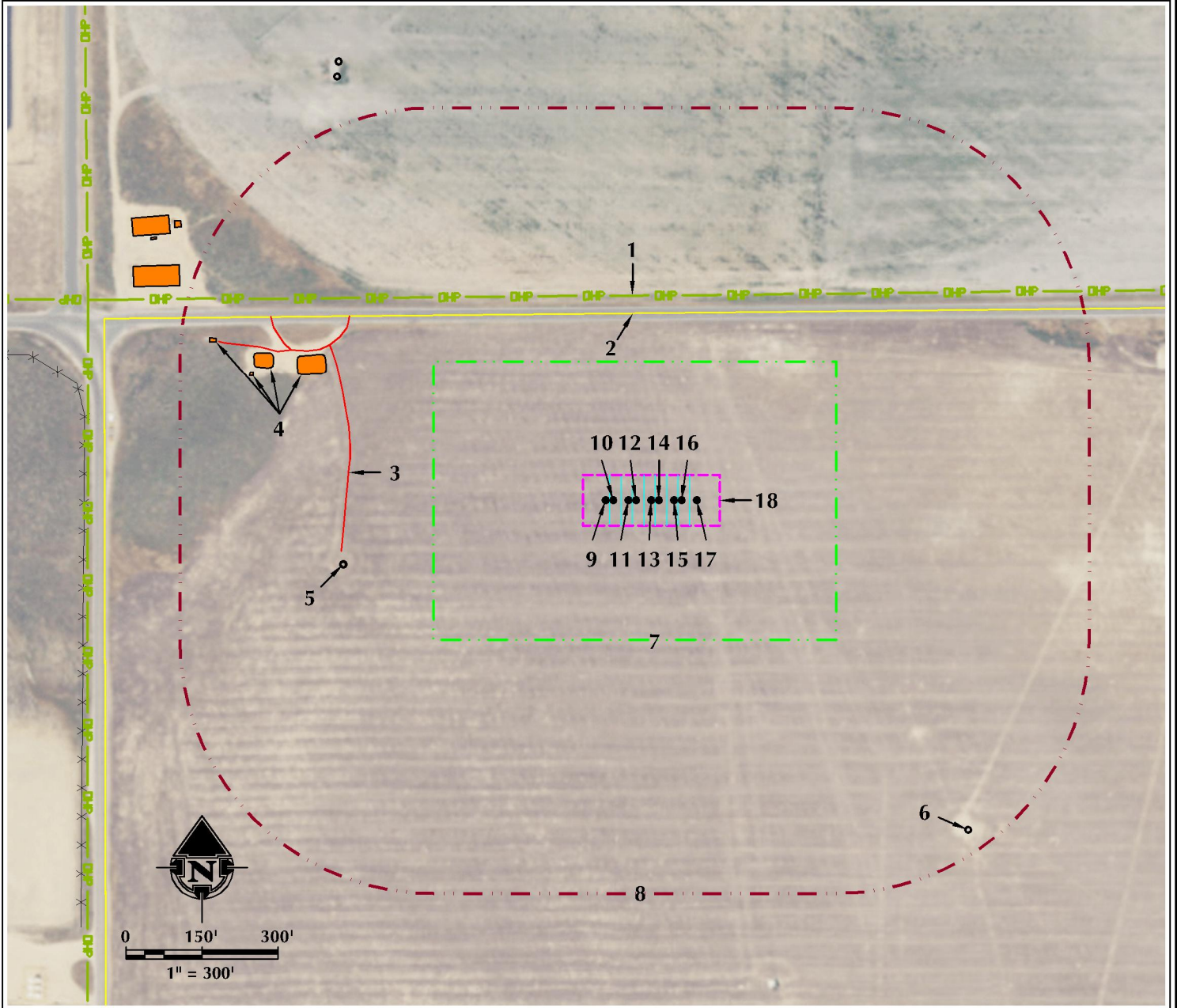

- | | | |
|---|---|------------------------------------|
| 1. OVERHEAD POWER LINE IS ±405' N. | 6. EXISTING WELL: MOSER 21-33 #1 IS ±902' SE. | 13. PROPOSED WELL: CANNON 29N-4HZ |
| 2. COUNTY ROAD 28 IS ±355' N. | 7. OPERATIONAL DISTURBANCE AREA | 14. PROPOSED WELL: CANNON 3N-4HZ |
| 3. EXISTING PRIVATE ROAD IS ±600' W. | 8. 500' BUFFER | 15. PROPOSED WELL: CANNON 28N-W4HZ |
| 4. EXISTING FACILITIES ARE ±691' W, ±793' W, ±824' W AND ±915' W. | 9. PROPOSED WELL: CANNON 34N-33HZ | 16. PROPOSED WELL: CANNON 28N-E4HZ |
| 5. EXISTING WELL: UPRC 33-4J5 IS ±621' W. | 10. PROPOSED WELL: CANNON 30N-4HZ | 17. PROPOSED WELL: CANNON 2N-4HZ |
| | 11. PROPOSED WELL: CANNON 4N-4HZ | 18. PUMP JACK OPERATIONS AREA |
| | 12. PROPOSED WELL: CANNON 29C-4HZ | |

LEGEND

- | | | |
|--------------------|----------------------|-------------------------|
| ● EXISTING WELL | --- 500' BUFFER | OP OVERHEAD POWER LINE |
| ○ PROPOSED WELL | --- DISTURBANCE AREA | EXISTING FACILITY |
| ○ WATER WELL | --- PUMP JACK AREA | EXISTING BUILDINGS |
| --- EXISTING FENCE | | RESIDENCE/BUILDING UNIT |
| --- PUBLIC ROAD | | |
| --- PRIVATE ROAD | | |

*** REFERENCE LOCATION ***
 ALL MEASUREMENTS ARE MADE FROM REFERENCE WELL: CANNON 29N-4HZ
 LAT: 40.188148° LONG: -104.674061° (NAD83)
 EXISTING GROUND ELEVATION = 4862.0'
 WELL FOOTAGES: 370' FNL & 1079' FWL

SURFACE USE: IRRIGATED CROPLAND

609 CONSULTING, LLC
 LOVELAND OFFICE: 1615 Foxtrail Drive, Suite 204, Loveland, Colorado 80538, Phone 970-776-4331
 SHERIDAN OFFICE: 1099 Saberton Avenue, Sheridan, Wyoming 82801, Phone 307-674-0609

DATE SURVEYED: 9/15/16
 DATE: 11/10/16
 DRAFTER: CDJ
 REVISED:

DATA SOURCES:
 - AERIAL COURTESY OF ESRI, INC.
 - WATER WELLS COURTESY OF COLORADO DIVISION OF WATER RESOURCES

NEAREST BUILDING UNIT: ±2648' W

PREPARED FOR:
Kerr-McGee Oil & Gas Onshore L.P.

K:\MADARCO\2016\2016_75_CANNON LAND_T3H_R65W_SEC_33\DWG\CANNON LAND.dwg, 1/27/2016 9:24:09 AM, jbr