

LOCATION DRAWING

MATIRA EAST WELL PAD

SECTION: 30

TOWNSHIP: 12N

RANGE: 65W

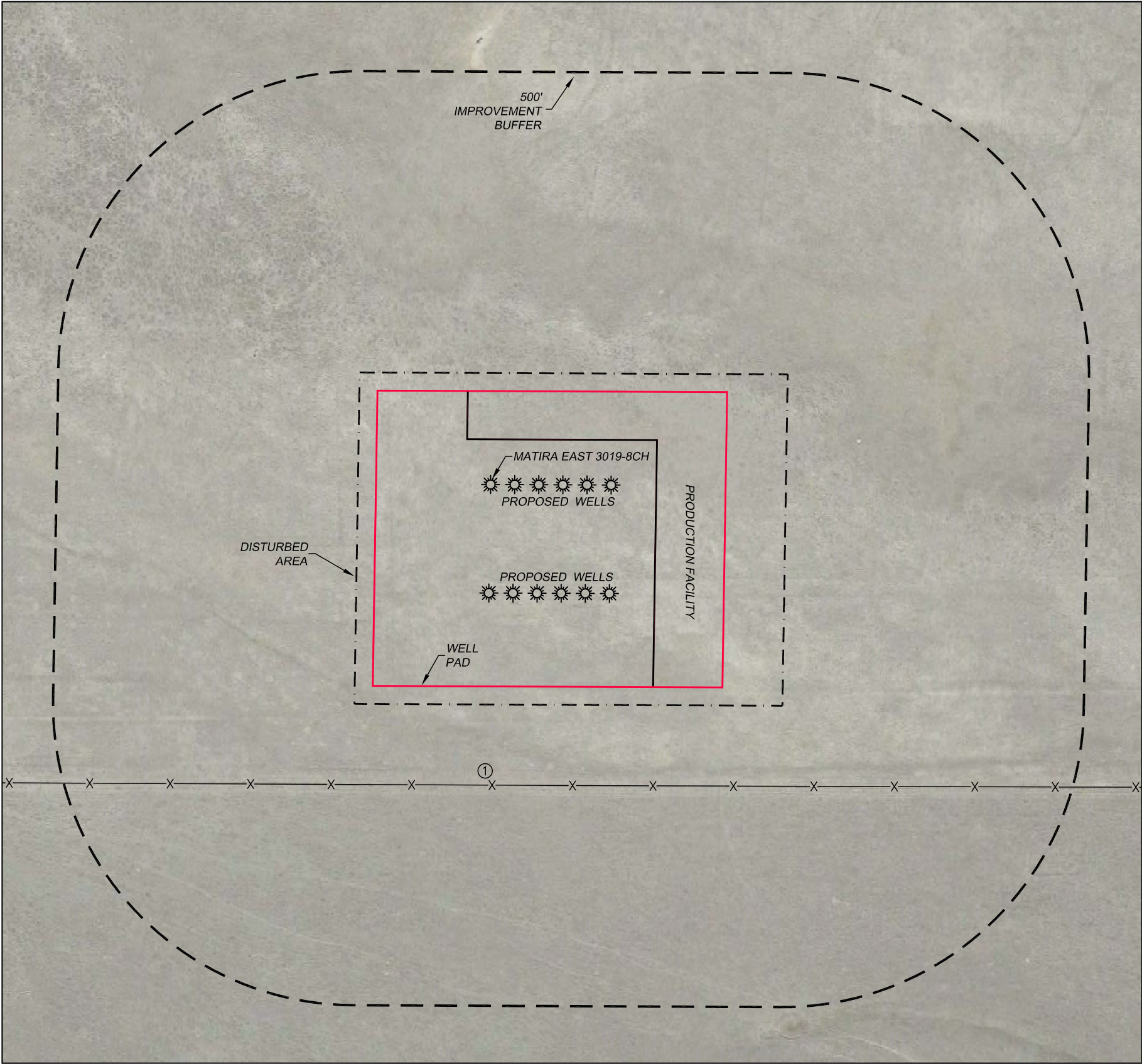

CULTURAL ITEMS:	
MEASURED FROM THE NEAREST PROPOSED WELLHEAD	
BUILDING:	1918'± SE
BUILDING UNIT:	1898'± SE
HIGH OCC. BLD. UNIT:	5280'+
DES. OUTSIDE ACTIVITY AREA:	5280'+
PUBLIC ROAD:	1565± E
ABOVE GROUND UTILITY:	1572'± SE
RAILROAD:	5280'+
PROPERTY LINE:	195'± N

IMPROVEMENTS	
(MEASURED FROM PROPOSED MATIRA EAST 3019-8CH WELL LOCATION)	
1. WIRE FENCE:	499'± S

CULTURAL ITEMS:	
MEASURED FROM THE NEAREST EDGE OF PRODUCTION	
BUILDING:	1682'± SE
BUILDING UNIT:	1660'± SE
HIGH OCC. BLD. UNIT:	5280'+
DES. OUTSIDE ACTIVITY AREA:	5280'+
PUBLIC ROAD:	1376'± E
ABOVE GROUND UTILITY:	1364'± E
RAILROAD:	5280'+
PROPERTY LINE:	40'± S

