

LOCATION DRAWING
MOTU WEST WELL PAD

SECTION: 28
TOWNSHIP: 12N
RANGE: 65W

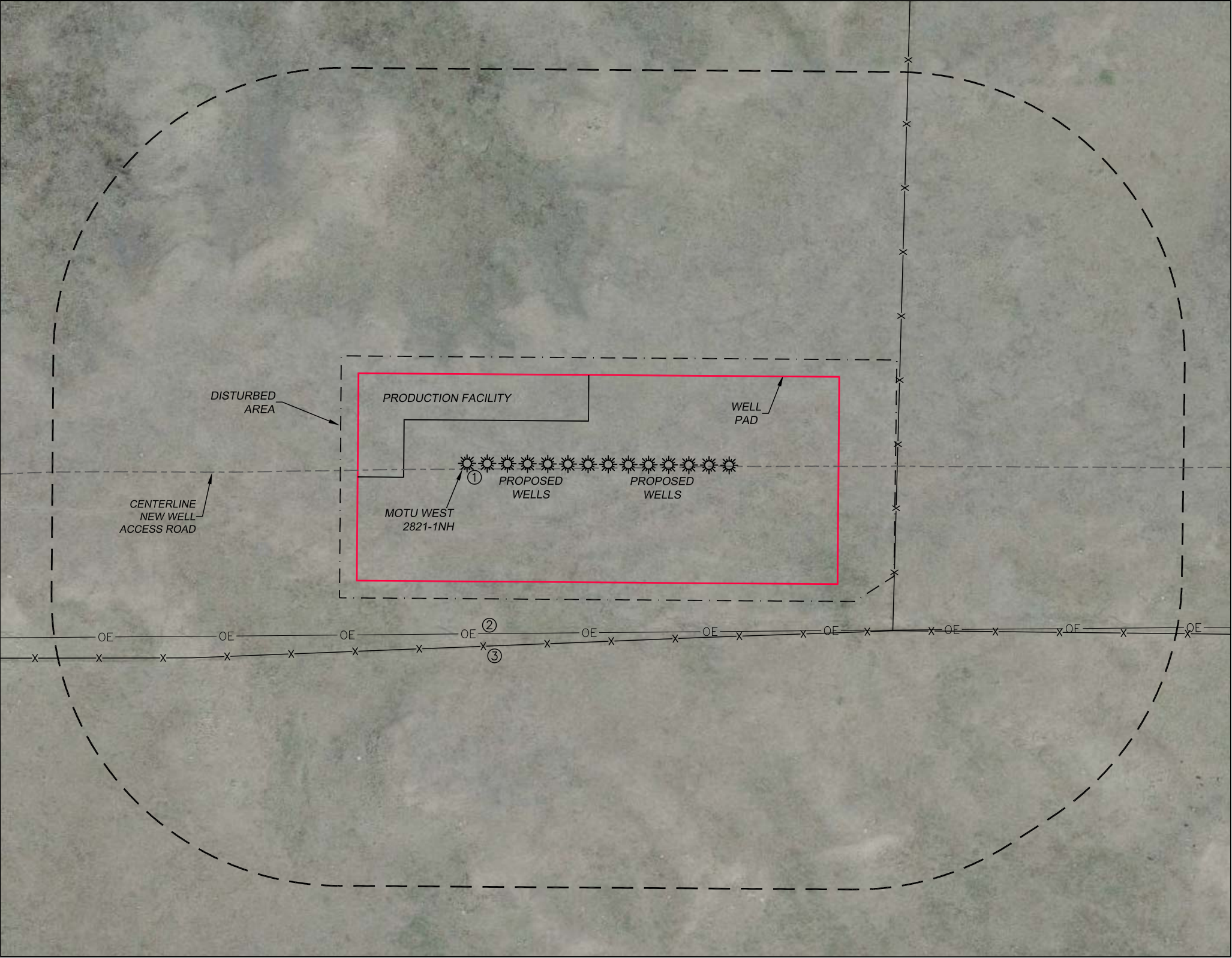

CULTURAL ITEMS:	
MEASURED FROM THE NEAREST PROPOSED WELLHEAD	
BUILDING:	5280'+
BUILDING UNIT:	5280'+
HIGH OCC. BLD. UNIT:	5280'+
DES. OUTSIDE ACTIVITY AREA:	5280'+
PUBLIC ROAD:	1528'± SW
ABOVE GROUND UTILITY:	288± S
RAILROAD:	5280'+
PROPERTY LINE:	250'± S

CULTURAL ITEMS:	
MEASURED FROM THE NEAREST EDGE OF PRODUCTION	
BUILDING:	5280'+
BUILDING UNIT:	5280'+
HIGH OCC. BLD. UNIT:	5280'+
DES. OUTSIDE ACTIVITY AREA:	5280'+
PUBLIC ROAD:	1420'± SW
ABOVE GROUND UTILITY:	272± S
RAILROAD:	5280'+
PROPERTY LINE:	225'± S

IMPROVEMENTS	
(MEASURED FROM PROPOSED MOTU WEST 2821-1NH WELL LOCATION)	
1. ACCESS ROAD:	10'± S
2. O.H. UTILITY:	296'± S
3. WIRE FENCE:	318'± S
	747'± E

