

# Great Western Operating Company, LLC

**Location** Colorado  
**Field** Wattenburg  
**Installation** Schneider - South  
**Slot** Slot 15 - Schneider HD 11-342HNX  
**Well** Schneider HD 11-342HNX  
**Wellbore** Schneider HD 11-342HNX (PWB)

Created by admin  
Date plotted 22-Dec-2016

Plot reference is Schneider HD 11-342HNX (PWB).  
Ref wellpath is Schneider HD 11-352HNX (PWP#1).  
Coordinates are in Feet reference Slot 15 - Schneider HD 11-342HNX.  
True Vertical Depths are reference Rig Datum.  
Measured Depths are reference Rig Datum.  
Rig Datum: Planned Datum #1  
Rig Datum to Mean Sea Level: 4755.10 ft.  
Plot North is aligned to TRUE North.

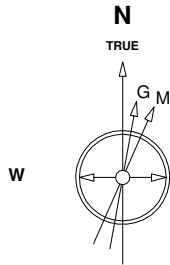

Scale 1 cm = 400 ft

East (Feet) ->

-14400 -13600 -12800 -12000 -11200 -10400 -9600 -8800 -8000 -7200 -6400 -5600 -4800 -4000 -3200 -2400 -1600 -800 0 800

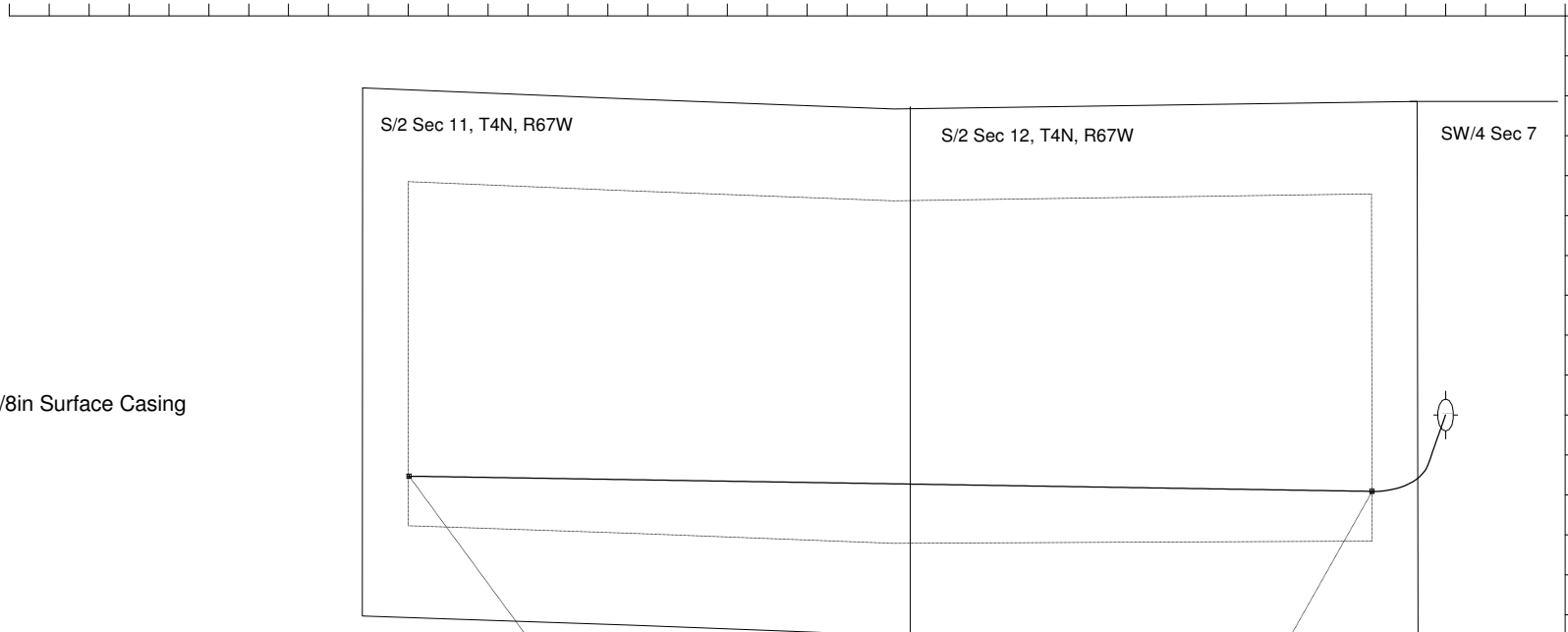

<- North(Feet)

Scale 1 cm = 200 ft

22-Jul-2014  
IGRF Model [1900.0-2020.0] Dip: 66.86 deg Field: 52682.2 nT  
Lat: N40 19 21.9792 Long: W104 49 43.4100 Elev: 4735.10 ft  
Magnetic North is 8.55 deg East of TRUE North  
To correct azimuth from Magnetic to TRUE add 8.55 deg

Scale 1 cm = 400 ft  
9 5/8in Surface Casing

<- True Vertical Depth (Feet)

1600  
2400  
3200  
4000  
4800  
5600  
6400  
7200  
8000  
8800

BHL - 16,952 / 6903 MD/TVD, 709 FSL, 470 FWL Sec 11

TPZ - 7299 / 6903 MD/TVD, 710 FSL, 460 FEL Sec 12

5 1/2in Production Casing

TPZ - 7299 / 6903 MD/TVD, 710 FSL, 460 FEL Sec 12

BHL - 16,952 / 6903 MD/TVD, 709 FSL, 470 FWL Sec 11

Scale 1 cm = 800 ft

Vertical Section (Feet) ->

Azimuth 268.31 with reference 0.00 N, 0.00 E from Slot 15 - Schneider HD 11-342HNX

## WELL PROFILE DATA

Point	MD	Inc	Azi	TVD	North	East	deg/100ft	V. Sect
Tie on	0.00	0.00	0.00	0.00	S 0.00	W 0.00		-0.00
KOP	5326.00	0.00	215.32	5326.00	S 0.00	W 0.00	0.00	-0.00
End of Build	6033.15	21.21	215.32	6017.10	S 105.60	W 74.83	9.84	77.91
End of Hold	6518.98	21.21	215.32	6470.01	S 249.04	W 176.47	0.00	183.74
Target TPZ - ...Sec 12	7299.58	90.00	270.45	6903.00	S 382.51	W 738.11	32.81	749.06
T.D. & Target BHL... 11	16952.68	90.00	270.45	6903.00	S 306.38	W 10390.91	0.00	10395.43