

Great Western Operating Company, LLC

Location Colorado
Field Wattenburg
Installation T&M

Slot T&M DE 15-358HC
Well T&M DE 15-358HC
Wellbore T&M DE 15-358HC (PWB)

Created by admin
Date plotted 15-Feb-2017

Plot reference is T&M DE 15-358HC (PWB).
Ref wellpath is T&M DE 15-358HC (PWP#1).
Coordinates are in Feet reference T&M DE 15-358HC.
True Vertical Depths are reference Rig Datum.
Measured Depths are reference Rig Datum.
Rig Datum: Planned Datum #1
Rig Datum to Mean Sea Level: 5104.80 ft.
Plot North is aligned to TRUE North.

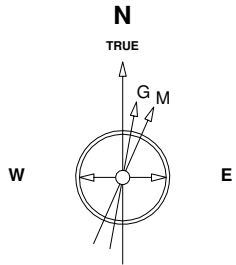

26-Jan-2016
IGRF Model [1900.0-2020.0] Dip: 67.09 deg Field: 52681.3 nT
Lat: N40 39 19.1088 Long: W104 46 18.2784 Elev: 5088.60 ft
Magnetic North is 8.38 deg East of TRUE North
To correct azimuth from Magnetic to TRUE add 8.38 deg

Scale 1 cm = 250 ft

East (Feet) ->

-1000 -500 0 500 1000 1500 2000 2500 3000 3500 4000 4500 5000 5500 6000

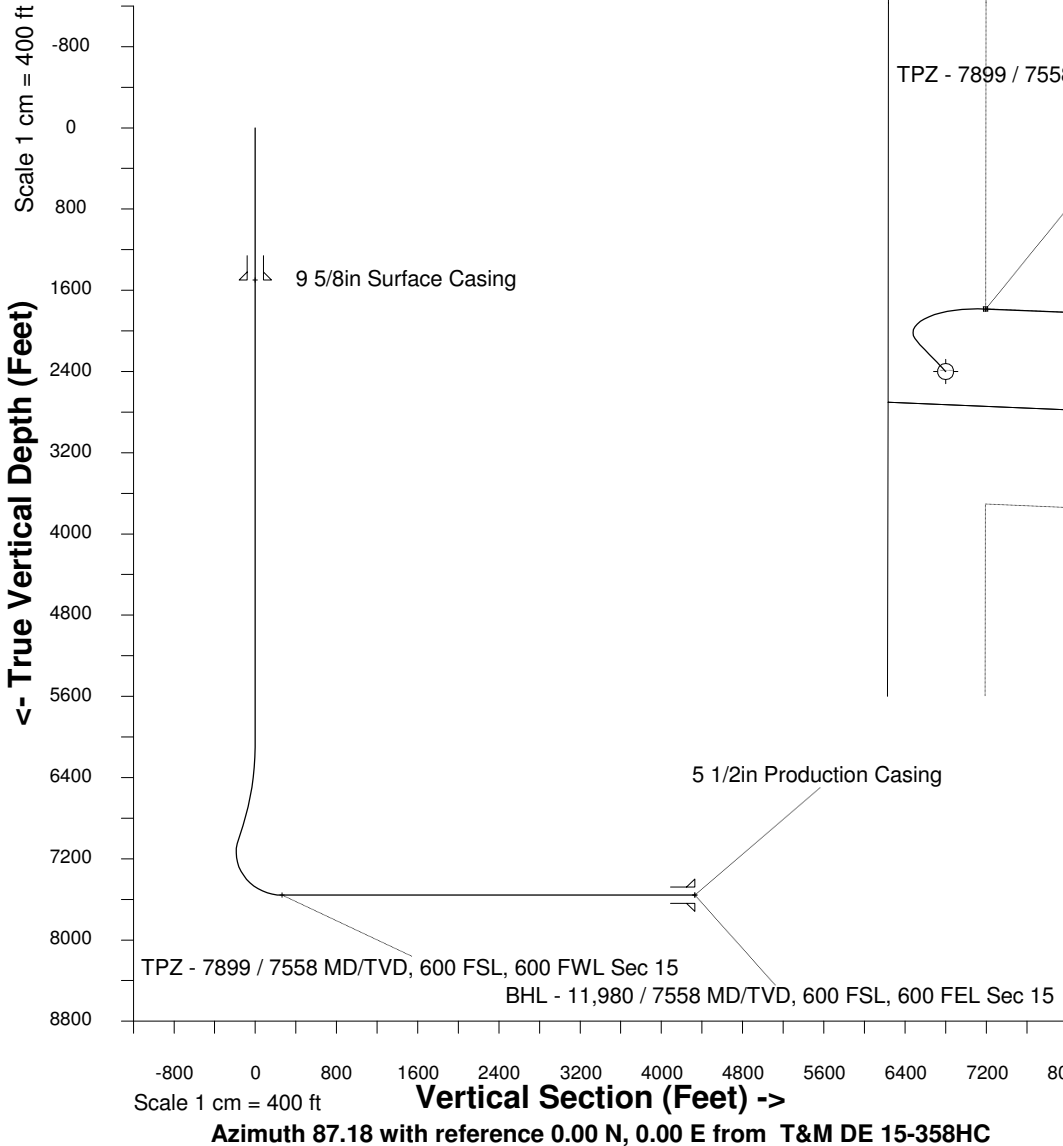

North(Feet)

Scale 1 cm = 250 ft

3000
2500
2000
1500
1000
500
0
-500
-1000
-1500
-2000

Sec 15, T8N, R66W

Sec 22, T8N, R66W

WELL PROFILE DATA

Point	MD	Inc	Azi	TVD	North	East	deg/100ft	V. Sect
Tie on	16.20	0.00	0.00	16.20	S 0.00	W 0.00		0.00
KOP	6054.00	0.00	316.32	6054.00	S 0.00	W 0.00	0.00	0.00
End of Build	7044.46	29.71	316.32	7000.66	N 181.62	W 173.43	9.84	-164.28
End of Hold	7045.85	29.71	316.32	7001.86	N 182.11	W 173.91	0.00	-164.73
Target TPZ - ...Sec 15	7899.09	90.00	92.41	7558.00	N 384.73	E 246.66	42.65	265.31
T.D. & Target BHL... 15	11979.77	90.00	92.41	7558.00	N 213.15	E 4323.73	0.00	4328.98