

Great Western Operating Company, LLC

Location	Colorado	Slot	Slot W04 - Kodak South FD 25-241HN
Field	Wattenburg	Well	Kodak South FD 25-241HN
Installation	Kodak South	Wellbore	Kodak South FD 25-241HN (PWB)

Created by	admin
Date plotted	15-Feb-2017
Plot reference is Kodak South FD 25-241HN (PWB).	
Ref wellpath is Kodak South FD 25-241HN (PWP#1).	
Coordinates are in Feet reference Slot W04 - Kodak South FD 25-241HN.	
True Vertical Depths are reference Rig Datum.	
Measured Depths are reference Rig Datum.	
Rig Datum: Planned Datum #1	
Rig Datum to Mean Sea Level: 4762.60 ft.	
Plot North is aligned to TRUE North.	

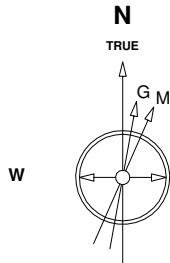

Scale 1 cm = 400 ft

East (Feet) ->

-5600 -4800 -4000 -3200 -2400 -1600 -800 0 800 1600 2400 3200 4000 4800 5600 6400 7200 8000 8800 9600

15-Jul-2016
IGRF Model [1900.0-2020.0] Dip: 66.91 deg Field: 52519.4 nT
Lat: N40 27 32.4396 Long: W104 51 49.7592 Elev: 4742.60 ft
Magnetic North is 8.37 deg East of TRUE North
To correct azimuth from Magnetic to TRUE add 8.37 deg

Scale 1 cm = 500 ft

<- True Vertical Depth (Feet)

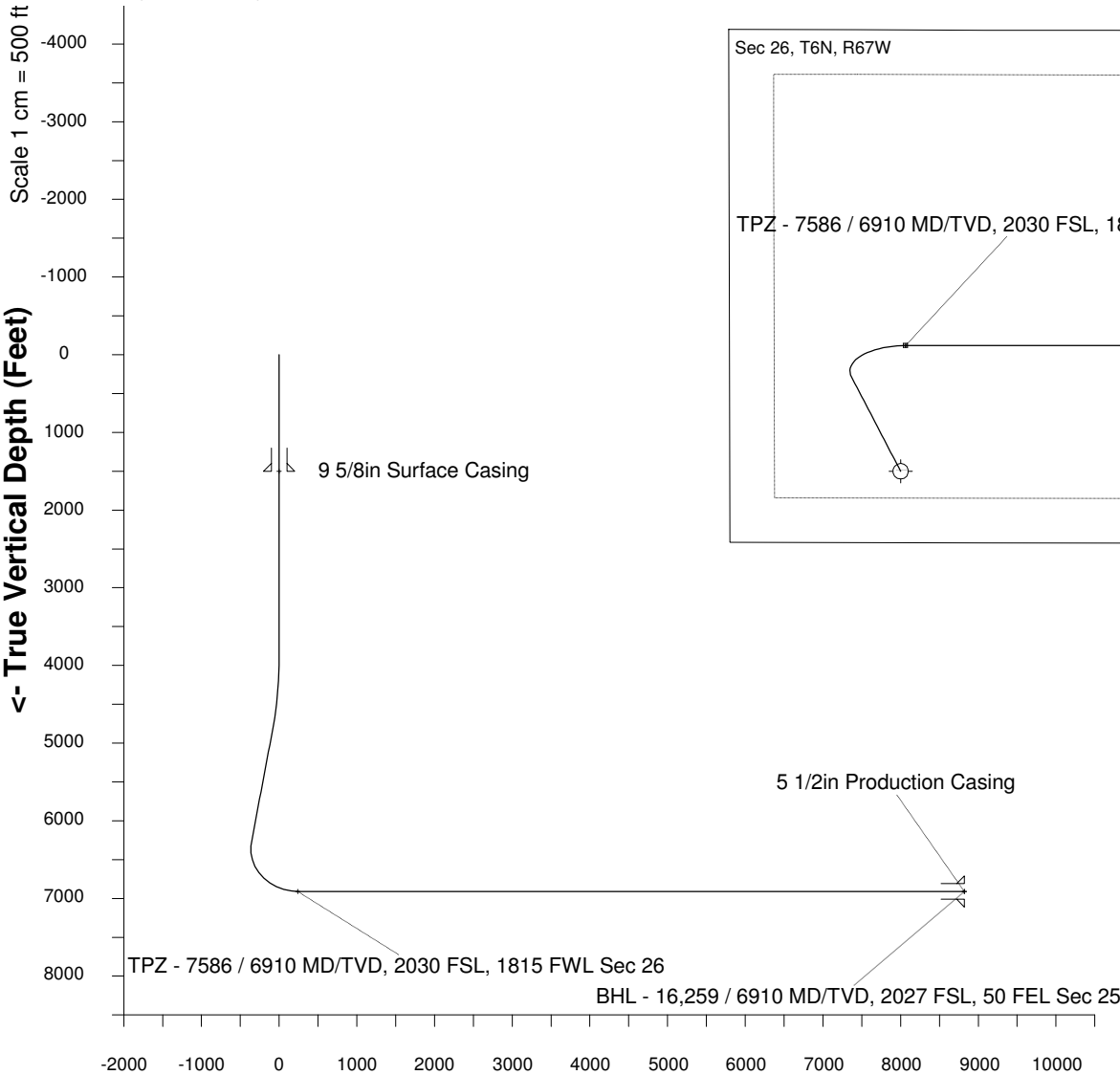

Scale 1 cm = 500 ft

Vertical Section (Feet) ->

Azimuth 81.56 with reference 0.00 N, 0.00 E from Slot W04 - Kodak South FD 25-241HN

<- North(Feet)

Scale 1 cm = 400 ft

WELL PROFILE DATA

Point	MD	Inc	Azi	TVD	North	East	deg/100ft	V. Sect
Tie on	0.00	0.00	0.00	0.00	S 0.00	W 0.00		0.00
KOP	3873.00	0.00	332.51	3873.00	S 0.00	W 0.00	0.00	0.00
End of Build	4872.90	30.00	332.51	4827.84	N 226.94	W 118.09	9.84	-83.50
End of Hold	6552.40	30.00	332.51	6282.38	N 971.80	W 505.69	0.00	-357.57
Target TPZ - ...Sec 26	7585.79	90.00	89.99	6910.00	N 1293.32	E 51.76	32.81	241.03
T.D. & Target BHL... 25	16259.34	90.00	89.99	6910.00	N 1294.72	E 8725.31	0.00	8820.85