

No Hydrological Features within 1,000 ft. of the Proposed CD-3 Well Location

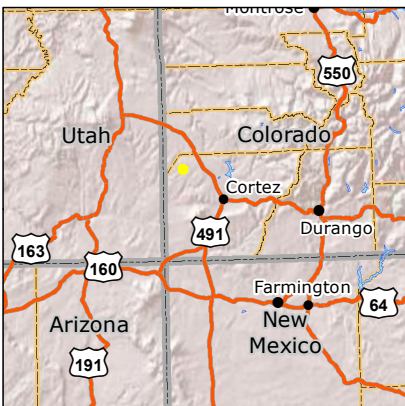

- ★ Proposed CD-3 Wellhead
- Access Route
- ▭ Disturbance Extent
- ▭ Wellpad
- 1,000' Buffer Zone
- County Road
- Intermittent Stream
- Pipeline
- ▭ Bureau of Land Management

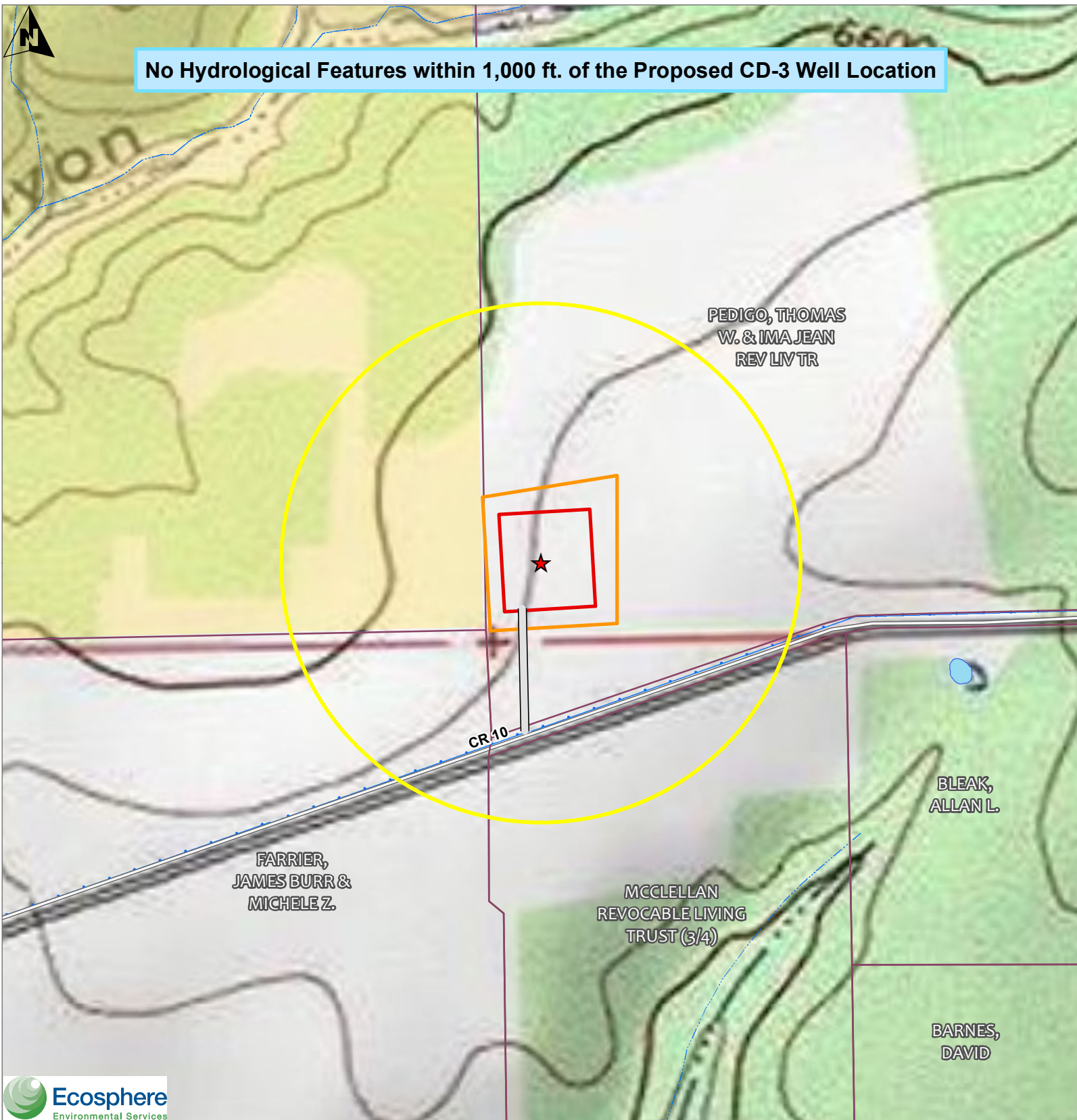
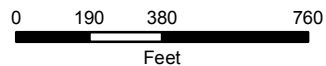

1:6,000

Coordinate System: NAD 1983 UTM Zone 12N

## Kinder Morgan CO<sub>2</sub> Company, LP

### CD-3 CO<sub>2</sub> Well

#### Location Drawing

Montezuma County, Colorado  
 Township 38N, Range 19W, Section 13  
 Ruin Canyon Quad  
 Date: 7/2/2015