

PROPOSED PAD CONTOURS  
VERMILLION #1

SECTION: 2  
TOWNSHIP: 13S  
RANGE: 58W

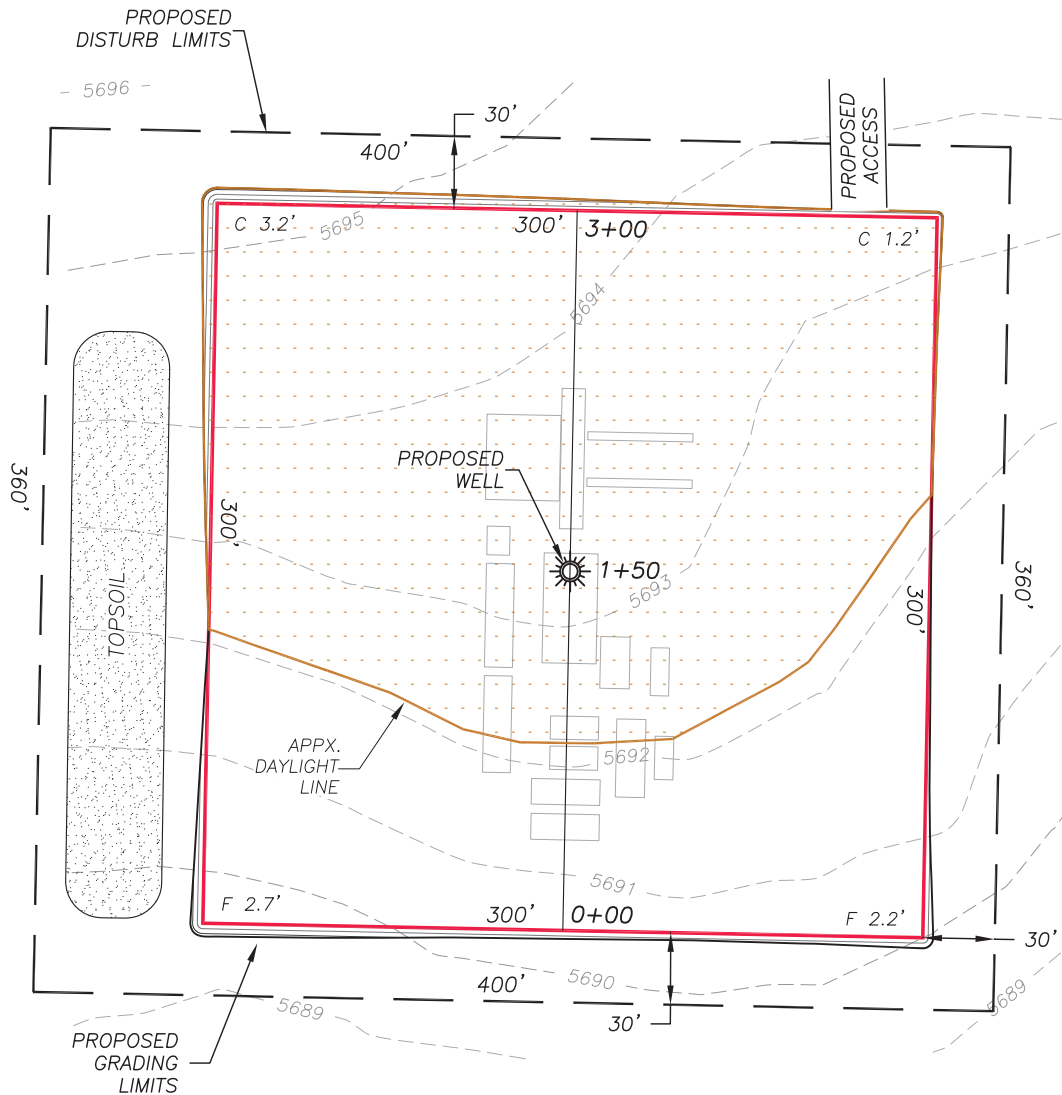

PROPOSED PAD DETAILS

Existing grade at well: 5693.2'  
Proposed pad elevation: 5692.1'  
Rig Pad: 2.1 Ac.±  
Graded Area: 2.2 Ac.  
Disturbed Area: 3.3 Ac.±

Cut slope ratio: 2.0  
Fill slope ratio: 2.0  
Cut Swell Factor: 1.00  
Fill Shrink Factor: 1.00

PAD EARTHWORK VOLUMES

Total cut: 2795± C.Y.  
Total fill: 1045± C.Y.  
Balance Export: 175± C.Y.  
(6" Topsoil)



Area of  
Proposed Cut



# PROPOSED PAD CROSS SECTIONS VERMILLION #1

SECTION: 2  
TOWNSHIP: 13S  
RANGE: 58W

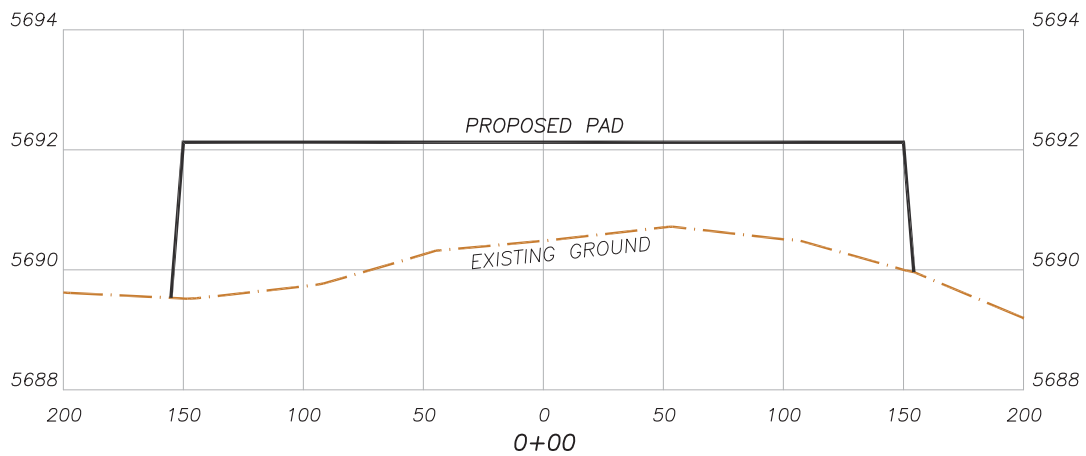
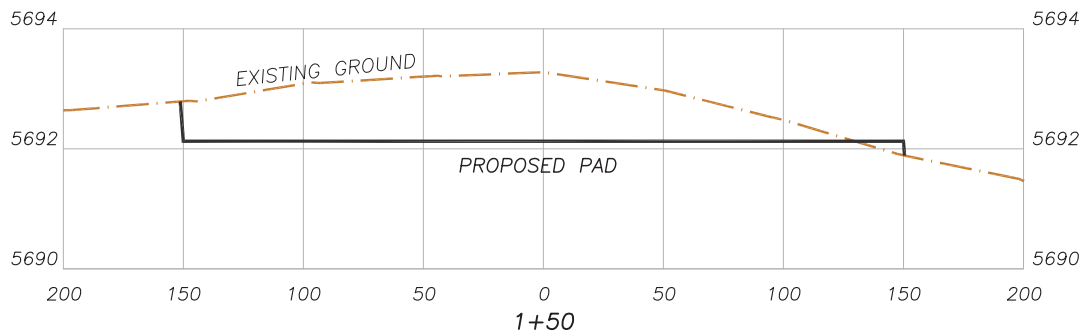
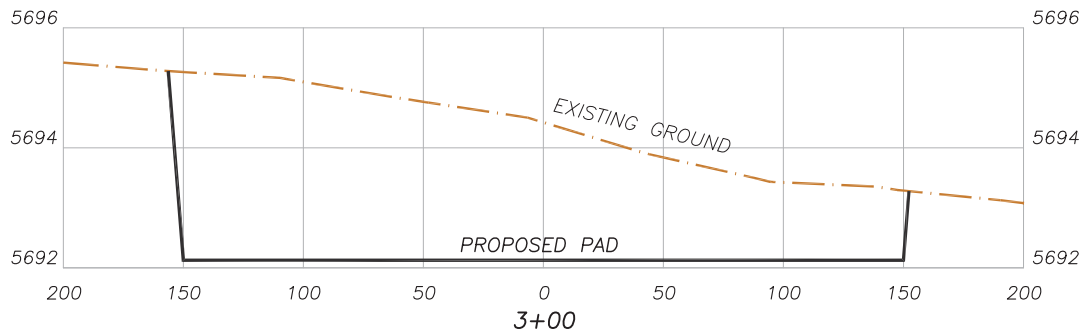

Horizontal Scale 50  
Vertical Scale 2