

# MLD 22-A PAD HYDROLOGY MAP

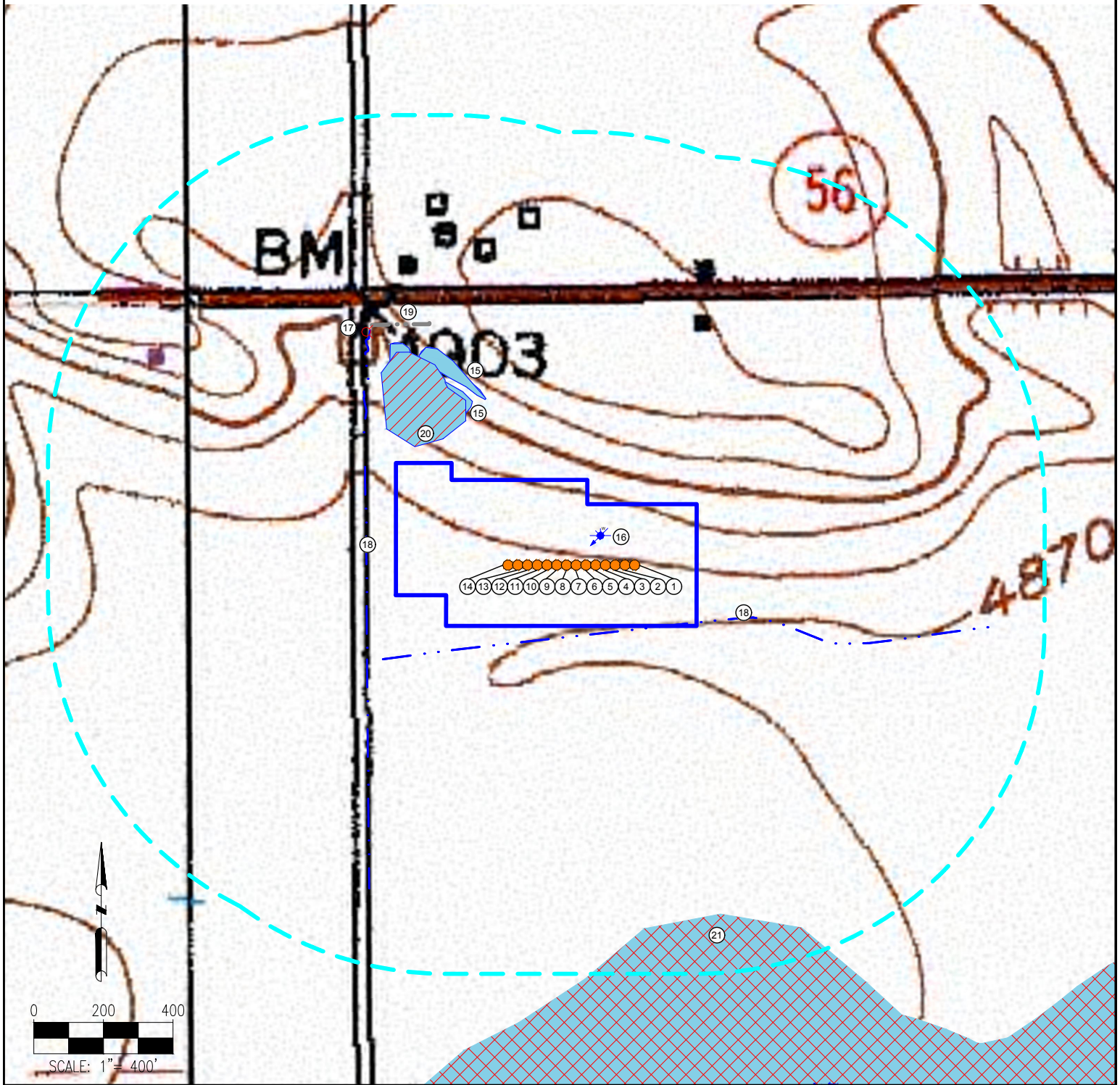

MEASUREMENTS ARE MADE FROM THE NEAREST EDGE OF THE DISTURBANCE AREA.

- |          |            |   |   |
|----------|------------|---|---|
| 1. MLD 1 | 7. MLD 7   | 13. MLD 13  | 18. DITCHES ARE $\pm 0'$ E, $\pm 84'$ W |
| 2. MLD 2 | 8. MLD 8   | 14. MLD 14  | 19. CONCRETE DITCH IS $\pm 398'$ N      |
| 3. MLD 3 | 9. MLD 9   | 15. PONDS ARE $\pm 122'$ N, $\pm 207'$ N  | 20. WETLANDS ARE $\pm 47'$ N            |
| 4. MLD 4 | 10. MLD 10 | 16. WATER WELL (PERMIT #51015-DW, NOT AT THIS LOCATION PER FIELD VERIFICATION) IS $\pm 90'$ S | 21. FLOODPLAIN IS $\pm 828'$ S          |
| 5. MLD 5 | 11. MLD 11 | 17. HYDRANT IS $\pm 387'$ NW  |   |
| 6. MLD 6 | 12. MLD 12 |   |   |

## LEGEND:

- |  |                 |  |                    |
|--|-----------------|--|--------------------|
|  | = PROPOSED WELL |  | = DITCH            |
|  | = FIRE HYDRANT  |  | = CONCRETE DITCH   |
|  | = WATER WELL    |  | = DISTURBANCE AREA |
|  | = POND          |  | = 1000' RADIUS     |
|  | = WETLANDS      |  |                    |
|  | = FLOODPLAIN    |  |                    |

DISCLAIMER:  
THIS PLOT DOES NOT REPRESENT A MONUMENTED LAND SURVEY AND SHOULD NOT BE RELIED UPON TO DETERMINE BOUNDARY LINES, PROPERTY OWNERSHIP OR OTHER PROPERTY INTERESTS. PARCEL LINES, IF DEPICTED HAVE NOT BEEN FIELD VERIFIED AND MAY BE BASED UPON PUBLICLY AVAILABLE DATA THAT ALSO HAS NOT BEEN INDEPENDENTLY VERIFIED.

DATA SOURCE:  
TOPO MAP: USGS  
NHD: USGS

PUBLICLY AVAILABLE DATA SOURCES HAVE NOT BEEN INDEPENDENTLY VERIFIED BY PFS.

PREPARED BY:

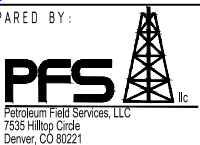

FIELD DATE:  
10-21-15

DRAWING DATE:  
01-27-17

BY:  
KWH

CHECKED BY:  
JLG

SITE NAME:  
MLD 22-A PAD

SURFACE LOCATION:

NW 1/4 NW 1/4 SEC. 22, T4N, R68W, 6TH P.M.  
WELD COUNTY, COLORADO

PREPARED FOR:

