

WELL LOCATION CERTIFICATE: MLD 10

SECTION 22, TOWNSHIP 4 NORTH, RANGE 68 WEST, 6TH P.M.

N 1/4 COR. SEC. 22

2 1/2" ALUM. CAP

PLS 12374

NW COR. SEC. 22

2 1/2" ALUM. CAP
ILLEGIBLE

N 88°55'25" E 2662.46'

N 88°59'47" E 2662.64'

NE COR. SEC. 22

2 1/2" ALUM. CAP
PLS 12374

N 10°02'46" W
537.94'

LP-270' FNL
460' FWL

N 88°57'36" E 4404.23'

BH-270' FNL
460' FEL

N 00°39'29" W 2656.54'

MLD 10

22

W 1/4 COR. SEC. 22

3" BRASS CAP
PLS 20142

N 00°40'13" W 2656.45'

NOTES:

BH LOCATION PROVIDED BY CLIENT.
LAND SURFACE USE- DRY LAND CROP
SEE ATTACHED MAP FOR ADDITIONAL
IMPROVEMENTS WITHIN 500'.

PDOP= 1.3

GPS OPERATOR: BEN HARDENBERGH

SURFACE LOCATION

GROUND ELEVATION= 4875'

NAD83

LATITUDE= 40.303972°

LONGITUDE= 104.996868°

LANDING POINT LOCATION

NAD83

LATITUDE= 40.305427°

LONGITUDE= 104.997194°

BOTTOM HOLE LOCATION

NAD83

LATITUDE= 40.305577°

LONGITUDE= 104.981404°

S 1/4 COR. SEC. 22

3 1/4" ALUM. CAP
PLS 4846

SW COR. SEC. 22

2 1/2" ALUM. CAP
PLS 24307

S 88°21'54" W 2654.41'

S 88°22'05" W 2654.81'
(BASIS OF BEARINGS) SEE NOTE 2

SE COR. SEC. 22

2 1/2" ALUM. CAP
PLS 24305

WELL MLD 10 TO BE LOCATED 801' FNL AND 548' FWL

LEGEND

- = EXISTING MONUMENT
- = PROPOSED WELL
- ◆ = EXISTING WELL
- ◆ = BOTTOM HOLE
- ▲ = LANDING POINT
- LP = LANDING POINT
- BH = BOTTOM HOLE

NOTES:

- THIS FIELD SURVEY CONFORMS TO THE MINIMUM STANDARDS SET BY THE C.O.G.C.C., RULE NO. 215
- BEARINGS AND DISTANCE SHOWN HEREON ARE GRID AND BASED ON THE COLORADO STATE PLANE COORDINATE SYSTEM, NAD 83/2011 BETWEEN MONUMENTS AS LABELED HEREON AND ELEVATIONS SHOWN ARE NAVD 88, AS DERIVED BY GPS OBSERVATIONS.
- GRID DISTANCES ARE SHOWN, AS MEASURED IN THE FIELD, WITH TIES TO WELLS MEASURED PERPENDICULAR TO SECTION LINES.

I, MICHAEL L. POOL, A LICENSED PROFESSIONAL LAND SURVEYOR IN THE STATE OF COLORADO DO HEREBY CERTIFY TO **EXTRACTION OIL & GAS**, THAT THE SURVEY AND WELL LOCATION CERTIFICATE SHOWN HEREON WERE DONE BY ME OR UNDER MY DIRECT SUPERVISION AND THAT THE DRAWING SHOWN HEREON ACCURATELY DEPICTS THE PROPOSED LOCATION OF THE WELL. THIS CERTIFICATE DOES NOT REPRESENT A LAND SURVEY PLAT OR IMPROVEMENT SURVEY PLAT AS DEFINED BY C.R.S. 38-51-102 AND CANNOT BE RELIED UPON TO DETERMINE OWNERSHIP.

MICHAEL L. POOL, PLS 38304
COLORADO LICENSED PROFESSIONAL LAND SURVEYOR
FOR AND ON BEHALF OF P.F.S., LLC

0 500 1000

SCALE: 1"=1000'

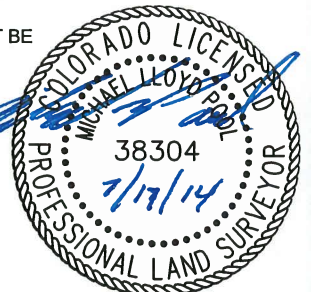

PREPARED BY:



FIELD DATE:

07-12-14

DRAWING DATE:

07-15-14

BY:

SMF

CHECKED:

JAH

SURFACE LOCATION:

NW 1/4 NW 1/4,

SEC. 22, T4N, R68W, 6TH P.M.

WELD COUNTY, COLORADO

NOTICE: ACCORDING TO COLORADO LAW YOU MUST COMMENCE ANY LEGAL ACTION BASED UPON ANY DEFECT IN THIS SURVEY WITHIN THREE YEARS AFTER YOU FIRST DISCOVER SUCH DEFECT. IN NO EVENT MAY ANY ACTION BASED UPON ANY DEFECT IN THIS SURVEY BE COMMENCED MORE THAN TEN YEARS FROM THIS SAID DATE OF THIS CERTIFICATION SHOWN HEREON.