

PROFILE: ACCESS ROAD STA: 9+50.00 TO 20+00.00  
HORIZONTAL: 1" = 50'  
VERTICAL: 1" = 5'

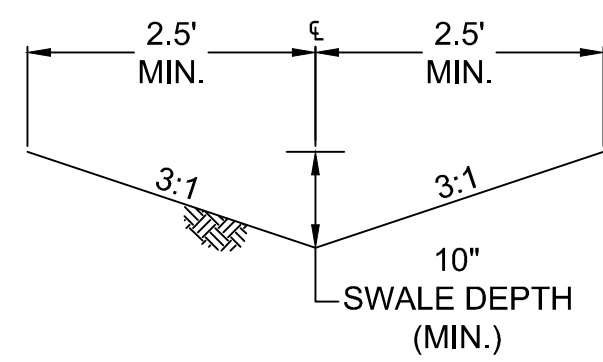

TYPICAL DIVERSION DITCH  
CROSS SECTION  
(PRIVATE)  
N.T.S.

LEGEND	
HP	HIGH POINT ELEVATION
SM	SEEDING AND MULCHING
IPC	CULVERT INLET PROTECTION
OP	OUTLET PROTECTION
RS	ROCK SOCKS/WATTLES
SF	SILT FENCE
ECB	EROSION CONTROL BLANKET
DD	DIVERSION DITCH
SCL	SEDIMENT CONTROL LOG
LOC	LIMITS OF CONSTRUCTION
SB	SEDIMENT BASIN
	EXISTING EASEMENT
	PROPOSED EASEMENT
	WILDLIFE FENCE
	SECTION LINE
	OVERHEAD POWER LINE
	F = X.X' FILL
	C = X.X' CUT

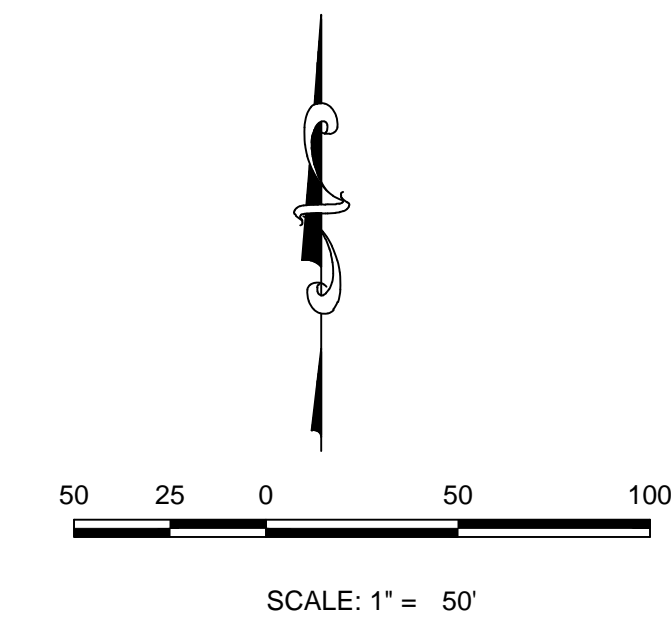
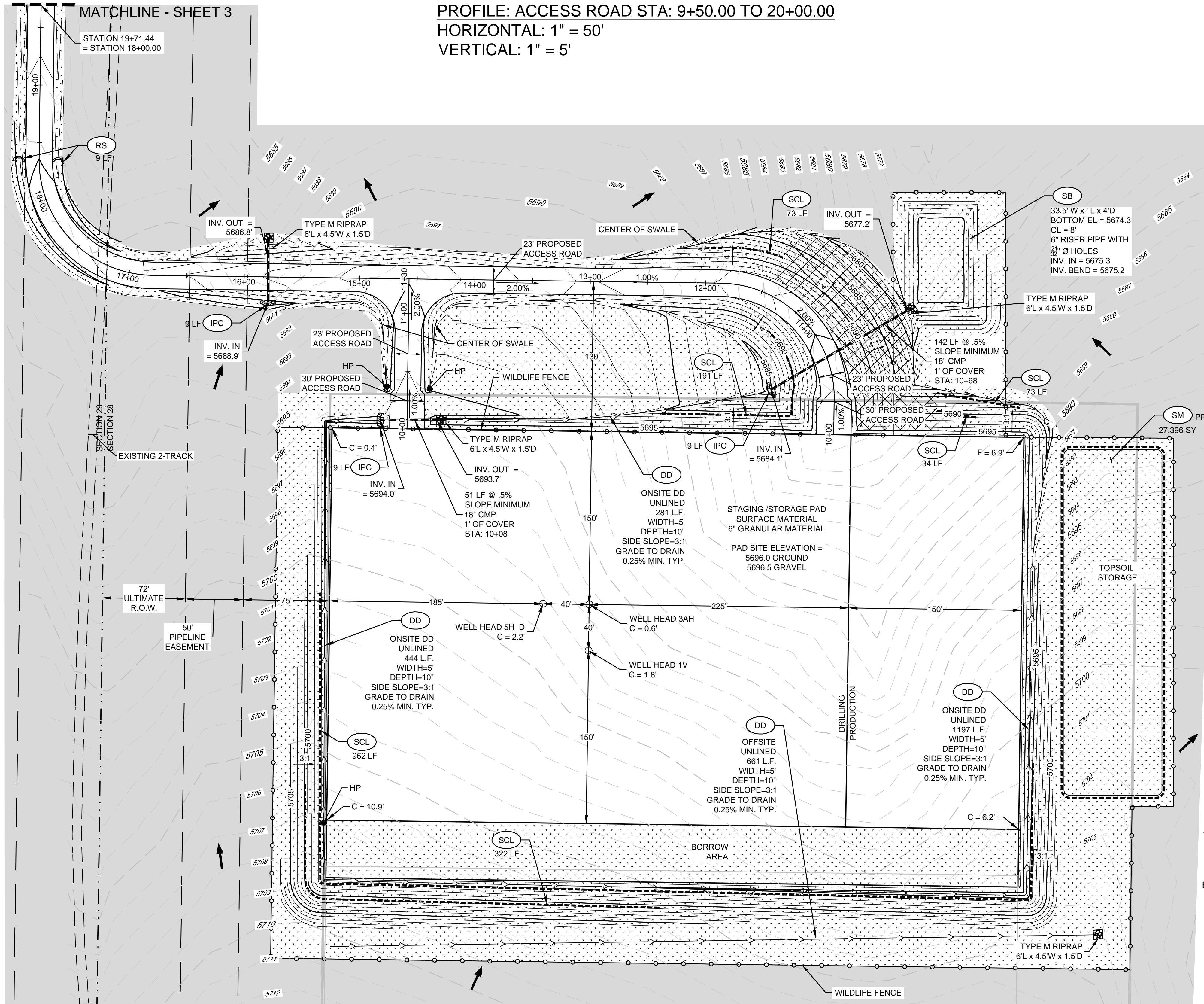

SOILS:

USING THE US DEPARTMENT OF AGRICULTURE'S WEB SOIL SURVEY, TWO SOIL TYPES EXIST WITHIN THE PROJECT BOUNDARY, ADENA-COLBY SILT LOAMS, 1 TO 5 PERCENT SLOPES (AdC), AND TRUCKTON LOAMY SAND, 1 TO 5 PERCENT SLOPES (TtC). THE SOILS LISTED ABOVE FALL INTO THE HYDROLOGIC CLASSIFICATION GROUP B/C, WHICH HAS A SLOW TO MODERATE INFILTRATION RATE. THE K FACTOR DESCRIBES A SOIL'S SUSCEPTIBILITY FOR RILL AND SHEET EROSION POTENTIAL (RATED 0.02 TO 0.69); THE HIGHER THE VALUE THE MORE SUSCEPTIBLE THE SOIL IS TO EROSION. THIS PROJECTS AREA'S SOIL HAS AN AVERAGE K OF 0.26.

DEWATERING

IF DEWATERING IS REQUIRED, A STATE CONSTRUCTION DEWATERING DISCHARGE PERMIT IS REQUIRED FOR DISCHARGES TO A STORM SEWER, CHANNEL, IRRIGATION DITCH, ANY STREET THAT IS TRIBUTARY TO THE MENTIONED FACILITIES, OR ANY WATER OF THE UNITED STATES.

SEDIMENT BASIN:

CALCULATIONS IN NARRATIVE AMENDMENTS TO APPROVED PLANS.

DIVERSION DITCH CAPACITY: 2.39 CFS @ 0.25%

CITY OF AURORA NOTE:

2.03.5.01 CITY OF AURORA PLAN REVIEW IS ONLY FOR GENERAL CONFORMANCE WITH CITY OF AURORA DESIGN CRITERIA AND THE CITY CODE. THE CITY IS ONLY RESPONSIBLE FOR THE ACCURACY AND ADEQUACY OF THE DESIGN, DIMENSIONS, AND ELEVATIONS WHICH SHALL BE CONFIRMED AND CORRELATED AT THE JOB SITE. THE CITY OF AURORA, THROUGH THE APPROVAL OF THIS DOCUMENT, ASSUMES NO RESPONSIBILITY FOR THE COMPLETENESS AND/OR ACCURACY OF THIS DOCUMENT.

NOTES:

- SEE THE STANDARD NOTES AND DETAILS IN FIELD WIDE REPORT. REVISED JANUARY 2010 (3 SHEETS) FOR ALL STANDARD DETAILS & CITY OF AURORA RULES AND REGULATIONS REGARDING STORMWATER DISCHARGES ASSOCIATED WITH CONSTRUCTION ACTIVITIES, NOTES AND LEGENDS OF BMP NAMES AND SYMBOLS.
- QUANTITIES:
  - EXISTING GRADE AT WELL HEAD 3AH = 5696.6'
  - EXISTING GRADE AT WELL HEAD 5H\_D = 5698.2'
  - EXISTING GRADE AT WELL HEAD 1V = 5697.8'
  - PAD SITE ELEVATION = 5696.0' (GROUND), 5696.5' (GRAVEL)
  - CUT SLOPES = 3:1
  - FILL SLOPES = 3:1
  - PHASE 1 TOPSOIL = 6757 CY, 1313 CY PLACED AT 3' DEPTH ON PAD
  - CUT/FILL SLOPES, 5444 CY STOCKPILED
  - PHASE 1 TOTAL CUT = 32,341 CY (DOES NOT INCLUDE TOPSOIL, INCLUDES DD & SB)
  - PHASE 1 TOTAL FILL = 26,897 CY (INCLUDES 10% ADJUSTMENT FOR COMPACTION)
  - PHASE 1 GRAVEL BASE AT 6" DEPTH = 3777 CY
  - PHASE 1 TOTAL DISTURBED AREA = 10.52 ACRES (INCLUDING ACCESS ROADWAY)
  - PHASE 1 FENCED AREA = 9.25 ACRES
  - PHASE 1 GRAVEL PAD AREA = 4.68 ACRES
- ALL DIVERSION DITCHES ARE ANTICIPATED TO BE UNLINED.
- ENSURE THAT THE PROVISIONS OF CRS 37-92-602, AS AMENDED BY SENATE BILL 15-212, REGARDING NOTIFICATION OF DOWNSTREAM WATER RIGHTS HOLDERS ARE UPHOLD.

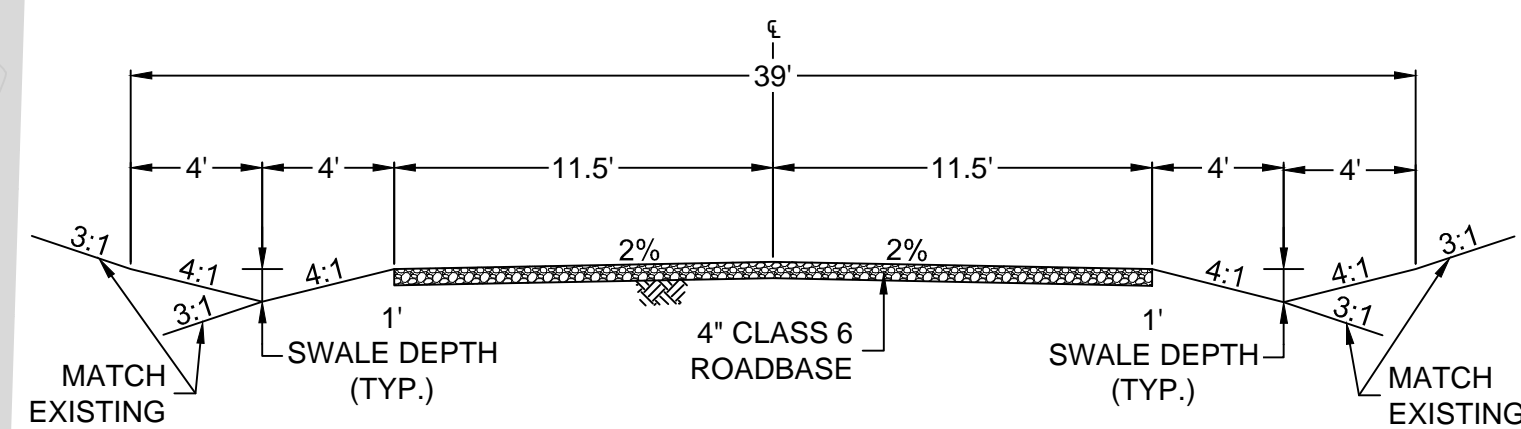

TYPICAL ACCESS ROAD CROSS SECTION  
(PRIVATE)  
N.T.S.

PROJECT AREA IS FOUND ON FIRM PANEL XXXXXXXXXX, DATED DECEMBER 17, 2010, AND IS LOCATED IN FLOOD ZONE X.

BENCH MARK  
COA BM 458517NE001, A 3 INCH DIAMETER BRASS  
CAP STAMPED (C.O.A. BM 23-50) ATOP THE N.E.  
CORNER CONC. BASE FOR POWER TOWER ON THE  
WEST SIDE OF POWHATON ROAD BEING THE 1ST  
POWER TOWER SOUTH OF THE W. 1/4 CORNER  
SECTION 4, T4S, R66W, AND BEING 125' SOUTH  
THEREOF. EL. = 5627.698, NAVD 1988

CALL 811  
TWO WORKING DAYS  
BEFORE YOU DIG  
UNCC 1-800-922-1987  
UTILITY NOTIFICATION  
CENTER OF COLORADO

10333 E. Dry Creek Rd. Suite 410 Englewood, CO 80150 Tel: (720) 482-9526 Fax: (720) 482-9546	<b>CONOCOPHILIPS COMPANY</b> ATTN: MAXWELL BLAIR 3401 E. QUINCY AVE. MAYNARD, CO. 80137 PHONE: (303) 505-5711	<b>RUSH #4-65 29-30 PHASE 1 OIL &amp; GAS WELLS NORTH OF YALE AVE AND EAST OF POWHATON ROAD PHASE 1 PAD SITE</b>	SCALE: K/D AS SHOWN FILE NO: 8.13.0201601	DRAWN BY: KID CHECKED BY: MEL DATE: 01-30-17	SHEET NUMBER <b>2</b> SWMP PHASE 1 PHASE 12_RUSH.dwg	Date Appr. Init. Date Revisions No.
--	---	--	---	---	--	--