

PHOTO: VIEW FROM CORNER #5 TO LOCATION STAKES

CAMERA ANGLE: SOUTHERLY



PHOTO: VIEW FROM BEGINNING OF PROPOSED ACCESS

CAMERA ANGLE: SOUTHERLY

## WARD PETROLEUM CORPORATION

RITCHEY PAD  
NE 1/4 NE 1/4, SECTION 26, T1N, R66W, 6th P.M.  
WELD COUNTY, COLORADO



UELS, LLC  
Corporate Office \* 85 South 200 East  
Vernal, UT 84078 \* (435) 789-1017

TAKEN BY	G.W., C.M.	01-04-17	
DRAWN BY	J.L.G.	01-10-17	
LOCATION PHOTOS			PHOTO 1

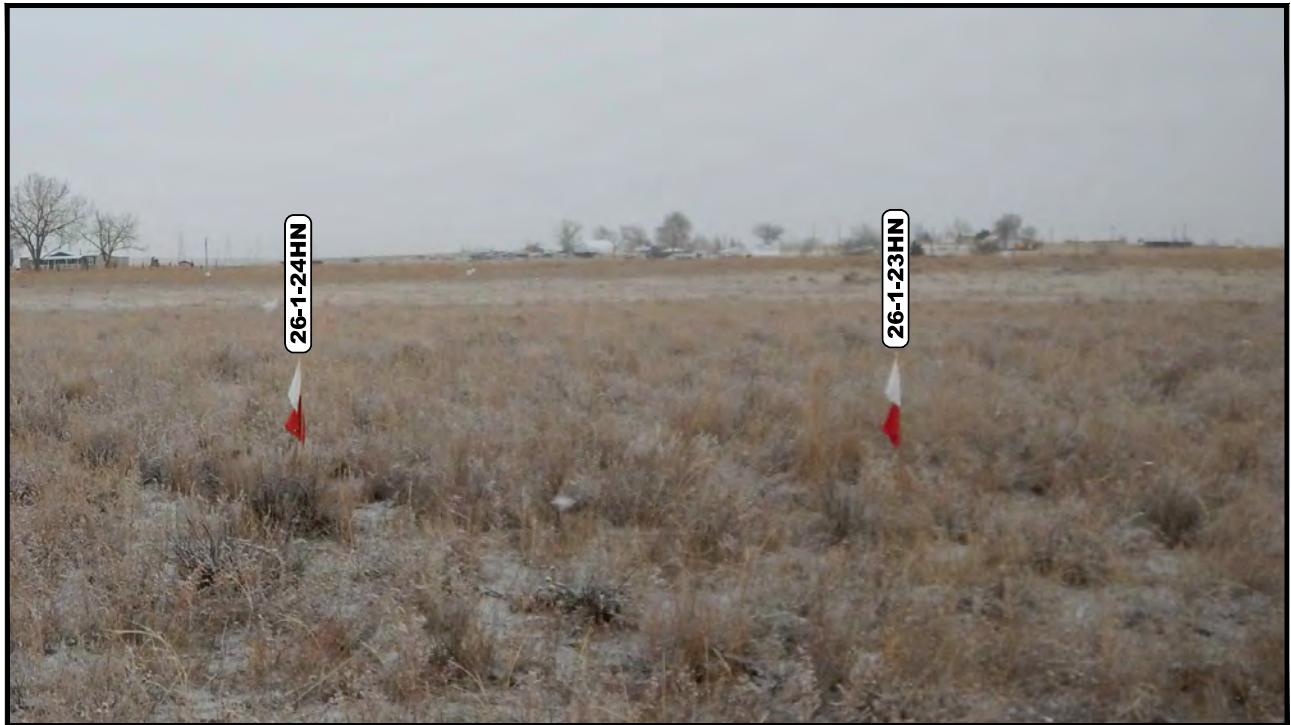

PHOTO: VIEW OF LOCATION STAKES

CAMERA ANGLE: NORTHERLY



PHOTO: VIEW OF LOCATION STAKES

CAMERA ANGLE: EASTERLY

## WARD PETROLEUM CORPORATION

RITCHEY PAD  
NE 1/4 NE 1/4, SECTION 26, T1N, R66W, 6th P.M.  
WELD COUNTY, COLORADO



UELS, LLC  
Corporate Office \* 85 South 200 East  
Vernal, UT 84078 \* (435) 789-1017

TAKEN BY	G.W., C.M.	01-04-17	
DRAWN BY	J.L.G.	01-10-17	
LOCATION PHOTOS			PHOTO 2





PHOTO: VIEW OF LOCATION STAKES

CAMERA ANGLE: SOUTHERLY



PHOTO: VIEW OF LOCATION STAKES

CAMERA ANGLE: WESTERLY

## WARD PETROLEUM CORPORATION

RITCHEY PAD  
NE 1/4 NE 1/4, SECTION 26, T1N, R66W, 6th P.M.  
WELD COUNTY, COLORADO

UELS, LLC

Corporate Office \* 85 South 200 East  
Vernal, UT 84078 \* (435) 789-1017

TAKEN BY	G.W., C.M.	01-04-17	
DRAWN BY	J.L.G.	01-10-17	
LOCATION PHOTOS			PHOTO 3