

HRM Resources

Location	DJ Basin	Slot	PC SOUTH 1S-66-2928-14NH
Field	WATTENBERG	Well	W PC SOUTH 1S-66-2928-14NH
Installation	PC 1S-66-2928 PAD	Wellbore	W PC SOUTH 1S-66-2928-14NH (PWB)

N
GRID

East (Feet) ->

-3200 -1600 0 1600 3200 4800 6400 8000 9600 11200
Scale 1 cm = 800 ft

Jan-24-2017
EMMA-2015 [2000.0-2020.0] Dip: 66.34 deg Field: 52071.6 nT
Lat: N39 56 7.4760 Long: W104 48 15.5520 Elev: 9723.01 ft
Magnetic North is 8.36 deg East of True North
GRID North is 0.45 deg East of True North
To correct azimuth from True to GRID subtract 0.45 deg
To correct azimuth from Magnetic to GRID add 7.91 deg

Created by	admin
Date plotted	1-Feb-2017
Plot reference is W PC SOUTH 1S-66-2928-14NH (PWB). Ref wellpath is W PC SOUTH 1S-66-2928-14NH (PWP#1). Coordinates are in Feet reference PC SOUTH 1S-66-2928-14NH. True Vertical Depths are reference Rig Datum. Measured Depths are reference Rig Datum. Rig Datum: Planned Datum #1 Rig Datum to Mean Sea Level: 5062.05 ft. Plot North is aligned to GRID North.	

Surface 0.00 N 0.00 E

PC SOUTH 1S-66-2928-14NH - EPL

PC SOUTH 1S-66-2928-14NH - BHL

PC North Block Boundary

1600
0
-1600
Scale 1 cm = 800 ft
« North (Feet) | South (Feet) »

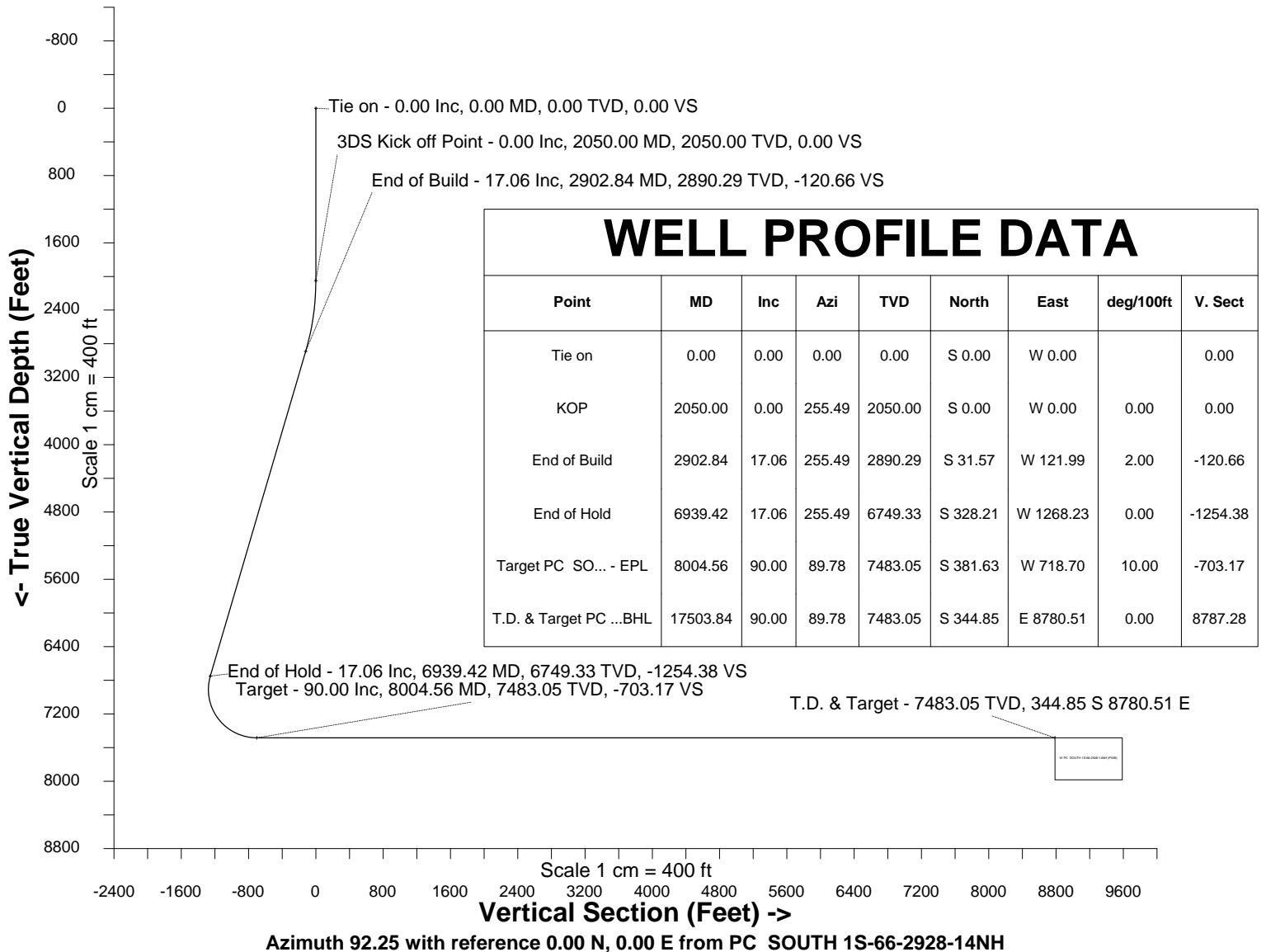



Wellhead Details

Name	Latitude	Longitude	Northing	Easting	North	East	Slot Elevation Above Ground
PC SOUTH 1S-66-2928-14NH	N39 56 7.0440	W104 48 15.1560	1220040.2128	3195111.0241	43.47S	31.19E	0.00

Declination

Date	Source	Time
Jan-24-2017	EMM-2015 [2000.0-2020.0]	09:32

Installation Details

Name	Installation Position (Latitude)	Installation Position (Longitude)	Northing	Easting	Coord System Name	North Alignment
PC 1S-66-2928 PAD	N39 56 7.4760	W104 48 15.5520	1220083.6821	3195079.8360	CO83-NF on NORTH AMERICAN DATUM 1983 datum	Grid

Summary Wellpath

MD[ft]	Inc[deg]	Azi[deg]	TVD[ft]	North[ft]	East[ft]	Dogleg [deg/100ft]	Vertical Section[ft]	Northing	Easting
0.00	0.00	0.000	0.00	0.00N	0.00E		0.00	1220040.21	3195111.02
2050.00	0.00	255.490	2050.00	0.00N	0.00E	==>	0.00	1220040.21	3195111.02
2902.84	17.06	255.490	2890.29	31.57S	121.99W	2.00	-120.66	1220008.64	3194989.04
6939.42	17.06	255.490	6749.33	328.21S	1268.23W	==>	-1254.38	1219712.02	3193842.83
8004.56	90.00	89.780	7483.05	381.63S	718.70W	10.00	-703.17	1219658.59	3194392.35
17503.84	90.00	89.780	7483.05	344.85S	8780.51E	==>	8787.28	1219695.38	3203891.27

Interpolated Wellpath

MD[ft]	Inc[deg]	Azi[deg]	TVD[ft]	North[ft]	East[ft]	Dogleg [deg/100ft]	Vertical Section[ft]	All Station Comments
0.00	0.00	0.000	0.00	0.00N	0.00E		0.00	Slot Datum
100.00	0.00	0.000	100.00	0.00N	0.00E	==>	0.00	
200.00	0.00	0.000	200.00	0.00N	0.00E	==>	0.00	
300.00	0.00	0.000	300.00	0.00N	0.00E	==>	0.00	
400.00	0.00	0.000	400.00	0.00N	0.00E	==>	0.00	
500.00	0.00	0.000	500.00	0.00N	0.00E	==>	0.00	
600.00	0.00	0.000	600.00	0.00N	0.00E	==>	0.00	
700.00	0.00	0.000	700.00	0.00N	0.00E	==>	0.00	
800.00	0.00	0.000	800.00	0.00N	0.00E	==>	0.00	
900.00	0.00	0.000	900.00	0.00N	0.00E	==>	0.00	
1000.00	0.00	0.000	1000.00	0.00N	0.00E	==>	0.00	
1100.00	0.00	0.000	1100.00	0.00N	0.00E	==>	0.00	
1200.00	0.00	0.000	1200.00	0.00N	0.00E	==>	0.00	
1300.00	0.00	0.000	1300.00	0.00N	0.00E	==>	0.00	
1400.00	0.00	0.000	1400.00	0.00N	0.00E	==>	0.00	
1500.00	0.00	0.000	1500.00	0.00N	0.00E	==>	0.00	
1600.00	0.00	0.000	1600.00	0.00N	0.00E	==>	0.00	
1700.00	0.00	0.000	1700.00	0.00N	0.00E	==>	0.00	
1800.00	0.00	0.000	1800.00	0.00N	0.00E	==>	0.00	
1900.00	0.00	0.000	1900.00	0.00N	0.00E	==>	0.00	
2000.00	0.00	0.000	2000.00	0.00N	0.00E	==>	0.00	
2100.00	1.00	255.490	2100.00	0.11S	0.42W	2.00	-0.42	
2200.00	3.00	255.490	2199.93	0.98S	3.80W	2.00	-3.76	
2300.00	5.00	255.490	2299.68	2.73S	10.55W	2.00	-10.44	
2400.00	7.00	255.490	2399.13	5.35S	20.67W	2.00	-20.45	
2500.00	9.00	255.490	2498.15	8.84S	34.15W	2.00	-33.77	
2600.00	11.00	255.490	2596.63	13.19S	50.96W	2.00	-50.40	
2700.00	13.00	255.490	2694.44	18.40S	71.08W	2.00	-70.31	
2800.00	15.00	255.490	2791.46	24.46S	94.50W	2.00	-93.47	
2900.00	17.00	255.490	2887.58	31.36S	121.19W	2.00	-119.86	
3000.00	17.06	255.490	2983.19	38.71S	149.58W	==>	-147.95	
3100.00	17.06	255.490	3078.79	46.06S	177.98W	==>	-176.03	

All data is in Feet unless otherwise stated
Coordinates are from Slot MD's are from Rig and TVD's are from Rig (Planned Datum #1 5062.1ft above Mean Sea Level)
Vertical Section is from 0.00N 0.00E on azimuth 92.250 degrees
Bottom hole distance is 8787.28 Feet on azimuth 92.25 degrees from Wellhead
Calculation method uses Minimum Curvature method
Prepared by IPT
Date Printed: 1-Feb-2017



SYSDRILL
Well Design Combined Report
Wellbore: W PC SOUTH 1S-66-2928-14NH (PWB)



Interpolated Wellpath								
MD[ft]	Inc[deg]	Azi[deg]	TVD[ft]	North[ft]	East[ft]	Dogleg [deg/100ft]	Vertical Section[ft]	All Station Comments
3200.00	17.06	255.490	3174.39	53.41S	206.37W	==>	-204.12	
3300.00	17.06	255.490	3269.99	60.76S	234.77W	==>	-232.20	
3400.00	17.06	255.490	3365.59	68.10S	263.17W	==>	-260.29	
3500.00	17.06	255.490	3461.19	75.45S	291.56W	==>	-288.38	
3600.00	17.06	255.490	3556.79	82.80S	319.96W	==>	-316.46	
3700.00	17.06	255.490	3652.40	90.15S	348.35W	==>	-344.55	
3800.00	17.06	255.490	3748.00	97.50S	376.75W	==>	-372.63	
3900.00	17.06	255.490	3843.60	104.85S	405.15W	==>	-400.72	
4000.00	17.06	255.490	3939.20	112.20S	433.54W	==>	-428.81	
4100.00	17.06	255.490	4034.80	119.55S	461.94W	==>	-456.89	
4200.00	17.06	255.490	4130.40	126.89S	490.34W	==>	-484.98	
4300.00	17.06	255.490	4226.00	134.24S	518.73W	==>	-513.07	
4400.00	17.06	255.490	4321.61	141.59S	547.13W	==>	-541.15	
4500.00	17.06	255.490	4417.21	148.94S	575.53W	==>	-569.24	
4600.00	17.06	255.490	4512.81	156.29S	603.92W	==>	-597.32	
4700.00	17.06	255.490	4608.41	163.64S	632.32W	==>	-625.41	
4800.00	17.06	255.490	4704.01	170.99S	660.71W	==>	-653.50	
4900.00	17.06	255.490	4799.61	178.34S	689.11W	==>	-681.58	
5000.00	17.06	255.490	4895.21	185.68S	717.51W	==>	-709.67	
5100.00	17.06	255.490	4990.82	193.03S	745.90W	==>	-737.75	
5200.00	17.06	255.490	5086.42	200.38S	774.30W	==>	-765.84	
5300.00	17.06	255.490	5182.02	207.73S	802.70W	==>	-793.93	
5400.00	17.06	255.490	5277.62	215.08S	831.09W	==>	-822.01	
5500.00	17.06	255.490	5373.22	222.43S	859.49W	==>	-850.10	
5600.00	17.06	255.490	5468.82	229.78S	887.89W	==>	-878.18	
5700.00	17.06	255.490	5564.43	237.12S	916.28W	==>	-906.27	
5800.00	17.06	255.490	5660.03	244.47S	944.68W	==>	-934.36	
5900.00	17.06	255.490	5755.63	251.82S	973.07W	==>	-962.44	
6000.00	17.06	255.490	5851.23	259.17S	1001.47W	==>	-990.53	
6100.00	17.06	255.490	5946.83	266.52S	1029.87W	==>	-1018.61	
6200.00	17.06	255.490	6042.43	273.87S	1058.26W	==>	-1046.70	
6300.00	17.06	255.490	6138.03	281.22S	1086.66W	==>	-1074.79	
6400.00	17.06	255.490	6233.64	288.57S	1115.06W	==>	-1102.87	
6500.00	17.06	255.490	6329.24	295.91S	1143.45W	==>	-1130.96	
6600.00	17.06	255.490	6424.84	303.26S	1171.85W	==>	-1159.05	
6700.00	17.06	255.490	6520.44	310.61S	1200.25W	==>	-1187.13	
6800.00	17.06	255.490	6616.04	317.96S	1228.64W	==>	-1215.22	
6900.00	17.06	255.490	6711.64	325.31S	1257.04W	==>	-1243.30	
7000.00	11.31	247.530	6808.04	332.71S	1282.33W	10.00	-1268.29	
7100.00	4.35	185.800	6907.18	340.25S	1291.80W	10.00	-1277.45	
7200.00	10.47	113.960	7006.46	347.74S	1283.86W	10.00	-1269.22	
7300.00	20.00	101.790	7102.85	354.94S	1258.75W	10.00	-1243.85	
7400.00	29.83	97.370	7193.44	361.64S	1217.24W	10.00	-1202.11	
7500.00	39.74	95.000	7275.47	367.63S	1160.58W	10.00	-1145.26	
7600.00	49.68	93.460	7346.45	372.73S	1090.51W	10.00	-1075.04	
7700.00	59.64	92.320	7404.22	376.79S	1009.14W	10.00	-993.57	
7800.00	69.60	91.390	7447.02	379.68S	918.95W	10.00	-903.34	
7900.00	79.57	90.580	7473.56	381.32S	822.68W	10.00	-807.08	
8000.00	89.55	89.810	7483.03	381.65S	723.26W	10.00	-707.72	
8100.00	90.00	89.780	7483.05	381.26S	623.26W	==>	-607.82	
8200.00	90.00	89.780	7483.05	380.88S	523.26W	==>	-507.91	
8300.00	90.00	89.780	7483.05	380.49S	423.26W	==>	-408.00	
8400.00	90.00	89.780	7483.05	380.10S	323.26W	==>	-308.10	
8500.00	90.00	89.780	7483.05	379.71S	223.26W	==>	-208.19	
8600.00	90.00	89.780	7483.05	379.33S	123.26W	==>	-108.28	
8700.00	90.00	89.780	7483.05	378.94S	23.26W	==>	-8.37	
8800.00	90.00	89.780	7483.05	378.55S	76.74E	==>	91.53	
8900.00	90.00	89.780	7483.05	378.17S	176.74E	==>	191.44	
9000.00	90.00	89.780	7483.05	377.78S	276.73E	==>	291.35	

All data is in Feet unless otherwise stated
Coordinates are from Slot MD's are from Rig and TVD's are from Rig (Planned Datum #1 5062.1ft above Mean Sea Level)
Vertical Section is from 0.00N 0.00E on azimuth 92.250 degrees
Bottom hole distance is 8787.28 Feet on azimuth 92.25 degrees from Wellhead
Calculation method uses Minimum Curvature method
Prepared by IPT
Date Printed: 1-Feb-2017



SYSDRILL
Well Design Combined Report
Wellbore: W PC SOUTH 1S-66-2928-14NH (PWB)



Interpolated Wellpath								
MD[ft]	Inc[deg]	Azi[deg]	TVD[ft]	North[ft]	East[ft]	Dogleg [deg/100ft]	Vertical Section[ft]	All Station Comments
9100.00	90.00	89.780	7483.05	377.39S	376.73E	==>	391.25	
9200.00	90.00	89.780	7483.05	377.00S	476.73E	==>	491.16	
9300.00	90.00	89.780	7483.05	376.62S	576.73E	==>	591.07	
9400.00	90.00	89.780	7483.05	376.23S	676.73E	==>	690.98	
9500.00	90.00	89.780	7483.05	375.84S	776.73E	==>	790.88	
9600.00	90.00	89.780	7483.05	375.46S	876.73E	==>	890.79	
9700.00	90.00	89.780	7483.05	375.07S	976.73E	==>	990.70	
9800.00	90.00	89.780	7483.05	374.68S	1076.73E	==>	1090.60	
9900.00	90.00	89.780	7483.05	374.29S	1176.73E	==>	1190.51	
10000.00	90.00	89.780	7483.05	373.91S	1276.73E	==>	1290.42	
10100.00	90.00	89.780	7483.05	373.52S	1376.73E	==>	1390.32	
10200.00	90.00	89.780	7483.05	373.13S	1476.73E	==>	1490.23	
10300.00	90.00	89.780	7483.05	372.74S	1576.72E	==>	1590.14	
10400.00	90.00	89.780	7483.05	372.36S	1676.72E	==>	1690.05	
10500.00	90.00	89.780	7483.05	371.97S	1776.72E	==>	1789.95	
10600.00	90.00	89.780	7483.05	371.58S	1876.72E	==>	1889.86	
10700.00	90.00	89.780	7483.05	371.20S	1976.72E	==>	1989.77	
10800.00	90.00	89.780	7483.05	370.81S	2076.72E	==>	2089.67	
10900.00	90.00	89.780	7483.05	370.42S	2176.72E	==>	2189.58	
11000.00	90.00	89.780	7483.05	370.03S	2276.72E	==>	2289.49	
11100.00	90.00	89.780	7483.05	369.65S	2376.72E	==>	2389.39	
11200.00	90.00	89.780	7483.05	369.26S	2476.72E	==>	2489.30	
11300.00	90.00	89.780	7483.05	368.87S	2576.72E	==>	2589.21	
11400.00	90.00	89.780	7483.05	368.48S	2676.72E	==>	2689.12	
11500.00	90.00	89.780	7483.05	368.10S	2776.72E	==>	2789.02	
11600.00	90.00	89.780	7483.05	367.71S	2876.72E	==>	2888.93	
11700.00	90.00	89.780	7483.05	367.32S	2976.71E	==>	2988.84	
11800.00	90.00	89.780	7483.05	366.94S	3076.71E	==>	3088.74	
11900.00	90.00	89.780	7483.05	366.55S	3176.71E	==>	3188.65	
12000.00	90.00	89.780	7483.05	366.16S	3276.71E	==>	3288.56	
12100.00	90.00	89.780	7483.05	365.77S	3376.71E	==>	3388.46	
12200.00	90.00	89.780	7483.05	365.39S	3476.71E	==>	3488.37	
12300.00	90.00	89.780	7483.05	365.00S	3576.71E	==>	3588.28	
12400.00	90.00	89.780	7483.05	364.61S	3676.71E	==>	3688.19	
12500.00	90.00	89.780	7483.05	364.22S	3776.71E	==>	3788.09	
12600.00	90.00	89.780	7483.05	363.84S	3876.71E	==>	3888.00	
12700.00	90.00	89.780	7483.05	363.45S	3976.71E	==>	3987.91	
12800.00	90.00	89.780	7483.05	363.06S	4076.71E	==>	4087.81	
12900.00	90.00	89.780	7483.05	362.68S	4176.71E	==>	4187.72	
13000.00	90.00	89.780	7483.05	362.29S	4276.70E	==>	4287.63	
13100.00	90.00	89.780	7483.05	361.90S	4376.70E	==>	4387.53	
13200.00	90.00	89.780	7483.05	361.51S	4476.70E	==>	4487.44	
13300.00	90.00	89.780	7483.05	361.13S	4576.70E	==>	4587.35	
13400.00	90.00	89.780	7483.05	360.74S	4676.70E	==>	4687.26	
13500.00	90.00	89.780	7483.05	360.35S	4776.70E	==>	4787.16	
13600.00	90.00	89.780	7483.05	359.97S	4876.70E	==>	4887.07	
13700.00	90.00	89.780	7483.05	359.58S	4976.70E	==>	4986.98	
13800.00	90.00	89.780	7483.05	359.19S	5076.70E	==>	5086.88	
13900.00	90.00	89.780	7483.05	358.80S	5176.70E	==>	5186.79	
14000.00	90.00	89.780	7483.05	358.42S	5276.70E	==>	5286.70	
14100.00	90.00	89.780	7483.05	358.03S	5376.70E	==>	5386.60	
14200.00	90.00	89.780	7483.05	357.64S	5476.70E	==>	5486.51	
14300.00	90.00	89.780	7483.05	357.25S	5576.69E	==>	5586.42	
14400.00	90.00	89.780	7483.05	356.87S	5676.69E	==>	5686.33	
14500.00	90.00	89.780	7483.05	356.48S	5776.69E	==>	5786.23	
14600.00	90.00	89.780	7483.05	356.09S	5876.69E	==>	5886.14	
14700.00	90.00	89.780	7483.05	355.71S	5976.69E	==>	5986.05	
14800.00	90.00	89.780	7483.05	355.32S	6076.69E	==>	6085.95	
14900.00	90.00	89.780	7483.05	354.93S	6176.69E	==>	6185.86	

All data is in Feet unless otherwise stated
Coordinates are from Slot MD's are from Rig and TVD's are from Rig (Planned Datum #1 5062.1ft above Mean Sea Level)
Vertical Section is from 0.00N 0.00E on azimuth 92.250 degrees
Bottom hole distance is 8787.28 Feet on azimuth 92.25 degrees from Wellhead
Calculation method uses Minimum Curvature method
Prepared by IPT
Date Printed: 1-Feb-2017



SYSDRILL
Well Design Combined Report
Wellbore: W PC SOUTH 1S-66-2928-14NH (PWB)



Interpolated Wellpath								
MD[ft]	Inc[deg]	Azi[deg]	TVD[ft]	North[ft]	East[ft]	Dogleg [deg/100ft]	Vertical Section[ft]	All Station Comments
15000.00	90.00	89.780	7483.05	354.54S	6276.69E	==>	6285.77	
15100.00	90.00	89.780	7483.05	354.16S	6376.69E	==>	6385.68	
15200.00	90.00	89.780	7483.05	353.77S	6476.69E	==>	6485.58	
15300.00	90.00	89.780	7483.05	353.38S	6576.69E	==>	6585.49	
15400.00	90.00	89.780	7483.05	352.99S	6676.69E	==>	6685.40	
15500.00	90.00	89.780	7483.05	352.61S	6776.69E	==>	6785.30	
15600.00	90.00	89.780	7483.05	352.22S	6876.69E	==>	6885.21	
15700.00	90.00	89.780	7483.05	351.83S	6976.68E	==>	6985.12	
15800.00	90.00	89.780	7483.05	351.45S	7076.68E	==>	7085.02	
15900.00	90.00	89.780	7483.05	351.06S	7176.68E	==>	7184.93	
16000.00	90.00	89.780	7483.05	350.67S	7276.68E	==>	7284.84	
16100.00	90.00	89.780	7483.05	350.28S	7376.68E	==>	7384.75	
16200.00	90.00	89.780	7483.05	349.90S	7476.68E	==>	7484.65	
16300.00	90.00	89.780	7483.05	349.51S	7576.68E	==>	7584.56	
16400.00	90.00	89.780	7483.05	349.12S	7676.68E	==>	7684.47	
16500.00	90.00	89.780	7483.05	348.74S	7776.68E	==>	7784.37	
16600.00	90.00	89.780	7483.05	348.35S	7876.68E	==>	7884.28	
16700.00	90.00	89.780	7483.05	347.96S	7976.68E	==>	7984.19	
16800.00	90.00	89.780	7483.05	347.57S	8076.68E	==>	8084.09	
16900.00	90.00	89.780	7483.05	347.19S	8176.68E	==>	8184.00	
17000.00	90.00	89.780	7483.05	346.80S	8276.67E	==>	8283.91	
17100.00	90.00	89.780	7483.05	346.41S	8376.67E	==>	8383.82	
17200.00	90.00	89.780	7483.05	346.02S	8476.67E	==>	8483.72	
17300.00	90.00	89.780	7483.05	345.64S	8576.67E	==>	8583.63	
17400.00	90.00	89.780	7483.05	345.25S	8676.67E	==>	8683.54	
17500.00	90.00	89.780	7483.05	344.86S	8776.67E	==>	8783.44	
17503.84	90.00	89.780	7483.05	344.85S	8780.51E	==>	8787.28	

All data is in Feet unless otherwise stated
Coordinates are from Slot MD's are from Rig and TVD's are from Rig (Planned Datum #1 5062.1ft above Mean Sea Level)
Vertical Section is from 0.00N 0.00E on azimuth 92.250 degrees
Bottom hole distance is 8787.28 Feet on azimuth 92.25 degrees from Wellhead
Calculation method uses Minimum Curvature method
Prepared by IPT
Date Printed: 1-Feb-2017



SYSDRILL
Well Design Combined Report
Wellbore: W PC SOUTH 1S-66-2928-14NH (PWB)



Targets							
Name	North[ft]	East[ft]	TVD[ft]	Latitude	Longitude	Northing	Easting
PC SOUTH 1S-66-2928-14NH - BHL	344.85S	8780.51E	7483.05	N39 56 2.9400	W104 46 22.4760	1219695.38	3203891.27
PC SOUTH 1S-66-2928-14NH - EPL	381.63S	818.70W	7483.05	N39 56 3.3360	W104 48 25.7040	1219658.59	3194292.35

Survey Tool Program					
Reference	Survey Name	MD[ft]	TVD[ft]	Survey Tool	Error Model
523276	Planned	1500.00	1500.00	WdW Rate Gyro	Standard
523275	Planned	17503.84	7483.05	ISCWSA MWD	Rev 4 + SAG + FLT

Notes

All data is in Feet unless otherwise stated
Coordinates are from Slot MD's are from Rig and TVD's are from Rig (Planned Datum #1 5062.1ft above Mean Sea Level)
Vertical Section is from 0.00N 0.00E on azimuth 92.250 degrees
Bottom hole distance is 8787.28 Feet on azimuth 92.25 degrees from Wellhead
Calculation method uses Minimum Curvature method
Prepared by IPT
Date Printed: 1-Feb-2017



SYSDRILL
Closest Approach + Clearance Factor Summary Report
Wellbore: W PC SOUTH 1S-66-2928-14NH (PWB)



Ellipse separations are reported ONLY if BOTH wells have uncertainty data
Only Depth and Magnetic Reference Field error terms are correlated across tie points
Scan limit is calculated on CENTRE to CENTRE distance
Summary data uses Closest Approach clearance calculation for all minima
Hole size/Casings ARE included
Hole size/Casings are NOT subtracted from Centre-Centre distance
Confidence limit of 95.00% / 2.80 SD.

Wellbore		
Name	Created	Last Revised
W PC SOUTH 1S-66-2928-14NH (PWB)	Jan-24-2017	Jan-24-2017

Well		
Name	Government ID	Last Revised
W PC SOUTH 1S-66-2928-14NH		Jan-24-2017

Slot						
Name	Latitude	Longitude	Grid Northing	Grid Easting	North	East
PC SOUTH 1S-66-2928-14NH	N39 56 7.0440	W104 48 15.1560	1220040.2128	3195111.0241	43.47S	31.19E

Installation						
Name	Installation Position (Latitude)	Installation Position (Longitude)	Easting	Northing	Coord System Name	North Alignment
PC 1S-66-2928 PAD	N39 56 7.4760	W104 48 15.5520	3195079.8360	1220083.6821	CO83-NF on NORTH AMERICAN DATUM 1983 datum	Grid

Clearance Summary							
Offset WellName	Separation [ft]	MD[ft]	Diverging From[ft]	Ellipse Separation [ft]	Ellipse MD[ft]	Clearance Factor	Clearance MD[ft]
W PC SOUTH 1S-66-2928-13C DH	14.57	2050.52	7187.28	-147.80	17503.28	0.67	17503.28
W PC SOUTH 1S-66-2928-15N H	18.21	2000.00	17502.66	-366.11	17503.84	0.51	17503.84
W PC SOUTH 1S-66-2928-12N H	29.14	2050.52	2050.00	-359.62	17503.84	0.52	17503.84
W PC NORTH 1S-66-2928-4CD H	30.85	1249.95	17503.84	28.83	1249.95	3.19	17503.84
W PC SOUTH 1S-66-2928-16C DH	32.79	1949.69	17503.84	-18.21	17503.84	0.97	17503.84
W PC NORTH 1S-66-2928-3NH	34.12	1200.00	1181.10	32.18	1200.00	3.40	17503.84
W PC NORTH 1S-66-2928-5NH	35.82	1300.00	1279.53	33.70	1328.74	2.93	17503.84
W PC NORTH 1S-66-2928-2NH	42.44	1150.11	17503.84	40.58	1150.11	3.80	17503.84
W PC NORTH 1S-66-2928-11N H	43.71	2050.52	17503.84	-3.02	17503.84	1.00	17503.84
W PC NORTH 1S-66-2928-6NH	44.96	1460.31	17503.84	42.58	1500.00	2.41	17503.84
W PC SOUTH 1S-66-2928-17N H	47.36	1900.00	17503.84	9.52	17503.84	1.01	17503.84

All data is in Feet unless otherwise stated
Coordinates are from Slot MD's are from Rig and TVD's are from Rig (Planned Datum #1 5062.1ft above Mean Sea Level)
Vertical Section is from 0.00N 0.00E on azimuth 92.250 degrees
Prepared by IPT
Date Printed: 1-Feb-2017



SYSDRILL
Closest Approach + Clearance Factor Summary Report
Wellbore: W PC SOUTH 1S-66-2928-14NH (PWB)



Clearance Summary							
Offset WellName	Separation [ft]	MD[ft]	Diverging From[ft]	Ellipse Separation [ft]	Ellipse MD[ft]	Clearance Factor	Clearance MD[ft]
W PC NORTH 1S-66-2928-7CD H	55.77	1628.56	17503.84	53.19	1656.82	2.16	17503.84
W PC SOUTH 1S-66-2928-18N H	61.93	1849.45	17503.84	57.96	1886.48	1.51	17503.84
W PC NORTH 1S-66-2928-8NH	67.60	1739.43	1739.43	64.31	1771.65	1.96	17503.84
W PC SOUTH 1S-66-2928-19C DH	76.50	1800.00	17503.84	72.90	1837.27	1.97	17503.84
W PC NORTH 1S-66-2928-9NH	81.80	1745.57	1745.57	78.41	1820.87	1.48	17503.84
W PC SOUTH 1S-66-2928-20N H	91.07	1749.30	17503.84	87.85	1771.65	2.05	17503.84
W PC NORTH 1S-66-2928-10C DH	95.78	1771.65	2908.92	92.03	1853.67	1.37	17503.84
W POLLARD #1	1285.20	13385.83	13385.83	1026.80	13435.04	4.94	13517.06

