

# HRM Resources

Location	DJ Basin	Slot	PC NORTH 1S-66-2928-6NH
Field	WATTENBERG	Well	W PC NORTH 1S-66-2928-6NH
Installation	PC 1S-66-2928 PAD	Wellbore	W PC NORTH 1S-66-2928-6NH (PWB)

## WELL PROFILE DATA

Point	MD	Inc	Azi	TVD	North	East	deg/100ft	V. Sect
Tie on	0.00	0.00	0.00	0.00	S 0.00	W 0.00		0.00
KOP	1350.00	0.00	315.57	1350.00	S 0.00	W 0.00	0.00	0.00
End of Build	2337.84	19.76	315.57	2318.38	N 120.41	W 118.06	2.00	-96.51
End of Hold	7097.28	19.76	315.57	6797.66	N 1269.22	W 1244.36	0.00	-1017.27
Target PC NOR... - EPL	8133.73	90.00	89.82	7483.45	N 1447.36	W 688.12	10.00	-439.22
T.D. & Target PC ...BHL	17626.74	90.00	89.82	7483.45	N 1476.82	E 8804.85	0.00	8927.84

East (Feet) ->

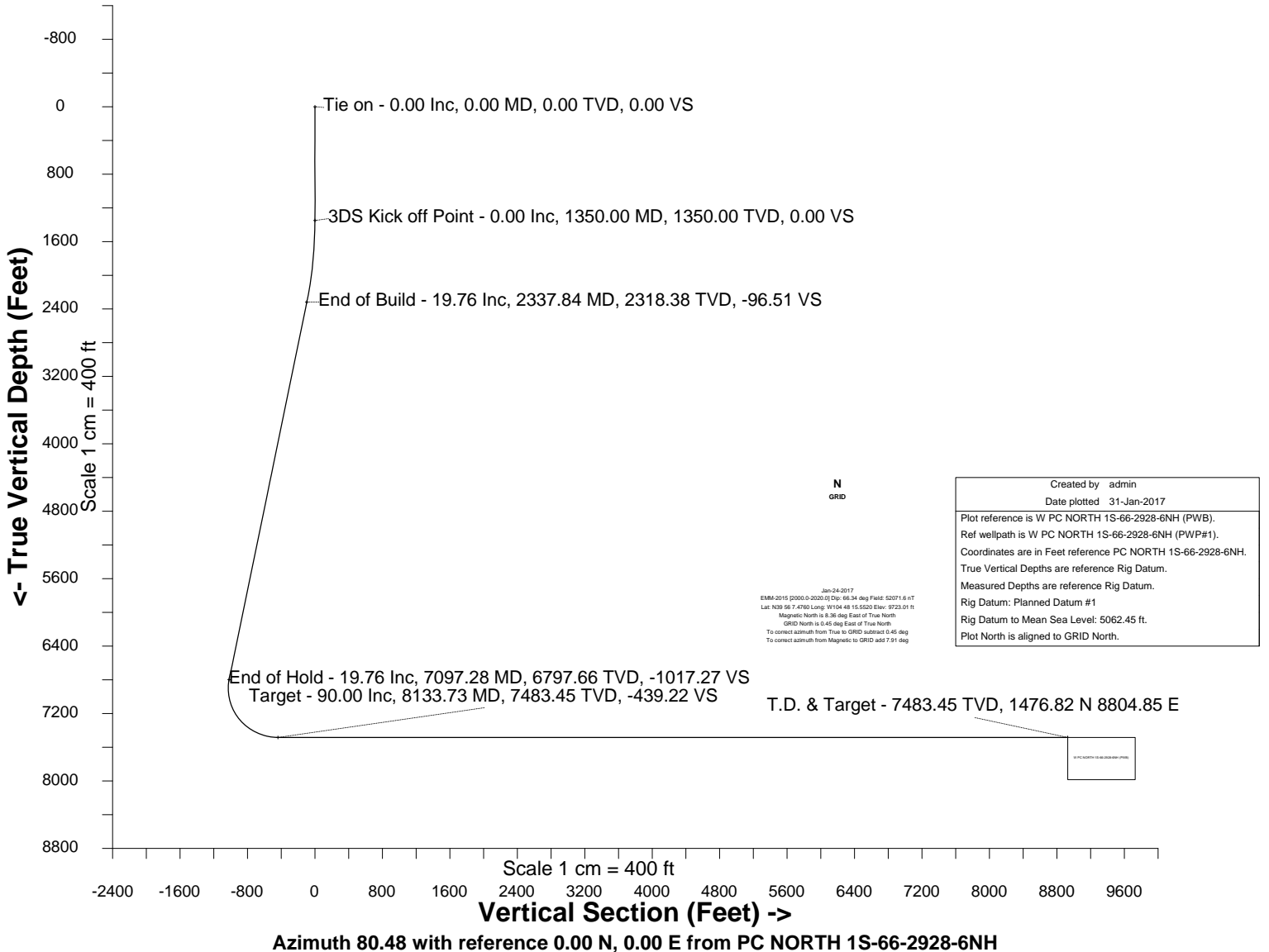
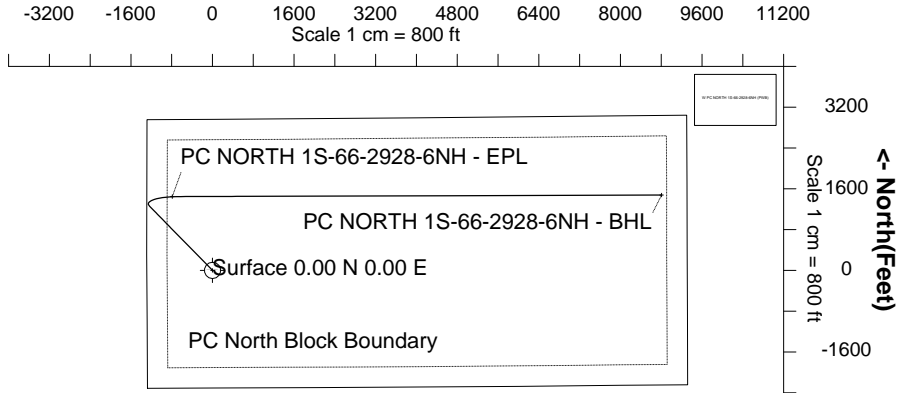



SYSDRILL  
Well Design Combined Report  
Wellbore: W PC NORTH 1S-66-2928-6NH (PWB)



### Wellhead Details

Name	Latitude	Longitude	Northing	Easting	North	East	Slot Elevation Above Ground
PC NORTH 1S-66-2928-6NH	N39 56 6.7200	W104 48 15.5520	1220007.1874	3195080.4361	76.50S	0.60E	0.00

### Declination

Date	Source	Time
Jan-24-2017	EMM-2015 [2000.0-2020.0]	09:32

### Installation Details

Name	Installation Position (Latitude)	Installation Position (Longitude)	Northing	Easting	Coord System Name	North Alignment
PC 1S-66-2928 PAD	N39 56 7.4760	W104 48 15.5520	1220083.6821	3195079.8360	CO83-NF on NORTH AMERICAN DATUM 1983 datum	Grid

### Summary Wellpath

MD[ft]	Inc[deg]	Azi[deg]	TVD[ft]	North[ft]	East[ft]	Dogleg [deg/100ft]	Vertical Section[ft]	Northing	Easting
0.00	0.00	0.000	0.00	0.00N	0.00E		0.00	1220007.19	3195080.44
1350.00	0.00	315.570	1350.00	0.00N	0.00E	==>	0.00	1220007.19	3195080.44
2337.84	19.76	315.570	2318.38	120.41N	118.06W	2.00	-96.51	1220127.60	3194962.38
7097.28	19.76	315.570	6797.66	1269.22N	1244.36W	==>	-1017.27	1221276.37	3193836.11
8133.73	90.00	89.820	7483.45	1447.36N	688.12W	10.00	-439.22	1221454.51	3194392.34
17626.74	90.00	89.820	7483.45	1476.82N	8804.85E	==>	8927.84	1221483.96	3203885.02

### Interpolated Wellpath

MD[ft]	Inc[deg]	Azi[deg]	TVD[ft]	North[ft]	East[ft]	Dogleg [deg/100ft]	Vertical Section[ft]	All Station Comments
0.00	0.00	0.000	0.00	0.00N	0.00E		0.00	Slot Datum
100.00	0.00	0.000	100.00	0.00N	0.00E	==>	0.00	
200.00	0.00	0.000	200.00	0.00N	0.00E	==>	0.00	
300.00	0.00	0.000	300.00	0.00N	0.00E	==>	0.00	
400.00	0.00	0.000	400.00	0.00N	0.00E	==>	0.00	
500.00	0.00	0.000	500.00	0.00N	0.00E	==>	0.00	
600.00	0.00	0.000	600.00	0.00N	0.00E	==>	0.00	
700.00	0.00	0.000	700.00	0.00N	0.00E	==>	0.00	
800.00	0.00	0.000	800.00	0.00N	0.00E	==>	0.00	
900.00	0.00	0.000	900.00	0.00N	0.00E	==>	0.00	
1000.00	0.00	0.000	1000.00	0.00N	0.00E	==>	0.00	
1100.00	0.00	0.000	1100.00	0.00N	0.00E	==>	0.00	
1200.00	0.00	0.000	1200.00	0.00N	0.00E	==>	0.00	
1300.00	0.00	0.000	1300.00	0.00N	0.00E	==>	0.00	
1400.00	1.00	315.570	1400.00	0.31N	0.31W	2.00	-0.25	
1500.00	3.00	315.570	1499.93	2.80N	2.75W	2.00	-2.25	
1600.00	5.00	315.570	1599.68	7.78N	7.63W	2.00	-6.24	
1700.00	7.00	315.570	1699.13	15.25N	14.95W	2.00	-12.22	
1800.00	9.00	315.570	1798.15	25.19N	24.69W	2.00	-20.19	
1900.00	11.00	315.570	1896.63	37.58N	36.85W	2.00	-30.12	
2000.00	13.00	315.570	1994.44	52.43N	51.40W	2.00	-42.02	
2100.00	15.00	315.570	2091.46	69.70N	68.34W	2.00	-55.87	
2200.00	17.00	315.570	2187.58	89.38N	87.63W	2.00	-71.64	
2300.00	19.00	315.570	2282.68	111.45N	109.27W	2.00	-89.33	
2400.00	19.76	315.570	2376.88	135.42N	132.77W	==>	-108.54	
2500.00	19.76	315.570	2470.99	159.56N	156.43W	==>	-127.88	
2600.00	19.76	315.570	2565.11	183.69N	180.10W	==>	-147.23	
2700.00	19.76	315.570	2659.22	207.83N	203.76W	==>	-166.57	
2800.00	19.76	315.570	2753.34	231.97N	227.42W	==>	-185.92	
2900.00	19.76	315.570	2847.45	256.11N	251.09W	==>	-205.27	
3000.00	19.76	315.570	2941.56	280.24N	274.75W	==>	-224.61	
3100.00	19.76	315.570	3035.68	304.38N	298.42W	==>	-243.96	

All data is in Feet unless otherwise stated  
Coordinates are from Slot MD's are from Rig and TVD's are from Rig ( Planned Datum #1 5062.5ft above Mean Sea Level )  
Vertical Section is from 0.00N 0.00E on azimuth 80.480 degrees  
Bottom hole distance is 8927.84 Feet on azimuth 80.48 degrees from Wellhead  
Calculation method uses Minimum Curvature method  
Prepared by IPT  
Date Printed: 31-Jan-2017



SYSDRILL  
Well Design Combined Report  
Wellbore: W PC NORTH 1S-66-2928-6NH (PWB)



Interpolated Wellpath								
MD[ft]	Inc[deg]	Azi[deg]	TVD[ft]	North[ft]	East[ft]	Dogleg [deg/100ft]	Vertical Section[ft]	All Station Comments
3200.00	19.76	315.570	3129.79	328.52N	322.08W	==>	-263.30	
3300.00	19.76	315.570	3223.90	352.65N	345.75W	==>	-282.65	
3400.00	19.76	315.570	3318.02	376.79N	369.41W	==>	-302.00	
3500.00	19.76	315.570	3412.13	400.93N	393.08W	==>	-321.34	
3600.00	19.76	315.570	3506.24	425.07N	416.74W	==>	-340.69	
3700.00	19.76	315.570	3600.36	449.20N	440.41W	==>	-360.03	
3800.00	19.76	315.570	3694.47	473.34N	464.07W	==>	-379.38	
3900.00	19.76	315.570	3788.59	497.48N	487.74W	==>	-398.72	
4000.00	19.76	315.570	3882.70	521.62N	511.40W	==>	-418.07	
4100.00	19.76	315.570	3976.81	545.75N	535.06W	==>	-437.42	
4200.00	19.76	315.570	4070.93	569.89N	558.73W	==>	-456.76	
4300.00	19.76	315.570	4165.04	594.03N	582.39W	==>	-476.11	
4400.00	19.76	315.570	4259.15	618.17N	606.06W	==>	-495.45	
4500.00	19.76	315.570	4353.27	642.30N	629.72W	==>	-514.80	
4600.00	19.76	315.570	4447.38	666.44N	653.39W	==>	-534.15	
4700.00	19.76	315.570	4541.49	690.58N	677.05W	==>	-553.49	
4800.00	19.76	315.570	4635.61	714.71N	700.72W	==>	-572.84	
4900.00	19.76	315.570	4729.72	738.85N	724.38W	==>	-592.18	
5000.00	19.76	315.570	4823.84	762.99N	748.05W	==>	-611.53	
5100.00	19.76	315.570	4917.95	787.13N	771.71W	==>	-630.87	
5200.00	19.76	315.570	5012.06	811.26N	795.37W	==>	-650.22	
5300.00	19.76	315.570	5106.18	835.40N	819.04W	==>	-669.57	
5400.00	19.76	315.570	5200.29	859.54N	842.70W	==>	-688.91	
5500.00	19.76	315.570	5294.40	883.68N	866.37W	==>	-708.26	
5600.00	19.76	315.570	5388.52	907.81N	890.03W	==>	-727.60	
5700.00	19.76	315.570	5482.63	931.95N	913.70W	==>	-746.95	
5800.00	19.76	315.570	5576.74	956.09N	937.36W	==>	-766.30	
5900.00	19.76	315.570	5670.86	980.23N	961.03W	==>	-785.64	
6000.00	19.76	315.570	5764.97	1004.36N	984.69W	==>	-804.99	
6100.00	19.76	315.570	5859.09	1028.50N	1008.36W	==>	-824.33	
6200.00	19.76	315.570	5953.20	1052.64N	1032.02W	==>	-843.68	
6300.00	19.76	315.570	6047.31	1076.77N	1055.69W	==>	-863.03	
6400.00	19.76	315.570	6141.43	1100.91N	1079.35W	==>	-882.37	
6500.00	19.76	315.570	6235.54	1125.05N	1103.01W	==>	-901.72	
6600.00	19.76	315.570	6329.65	1149.19N	1126.68W	==>	-921.06	
6700.00	19.76	315.570	6423.77	1173.32N	1150.34W	==>	-940.41	
6800.00	19.76	315.570	6517.88	1197.46N	1174.01W	==>	-959.75	
6900.00	19.76	315.570	6611.99	1221.60N	1197.67W	==>	-979.10	
7000.00	19.76	315.570	6706.11	1245.74N	1221.34W	==>	-998.45	
7100.00	19.57	316.160	6800.22	1269.87N	1245.00W	10.00	-1017.79	
7200.00	14.81	346.510	6895.92	1294.45N	1259.61W	10.00	-1028.14	
7300.00	15.85	24.820	6992.60	1319.33N	1256.86W	10.00	-1021.30	
7400.00	21.88	49.990	7087.34	1343.76N	1236.80W	10.00	-997.48	
7500.00	30.03	63.400	7177.26	1367.00N	1200.06W	10.00	-957.41	
7600.00	38.99	71.290	7259.61	1388.35N	1147.76W	10.00	-902.29	
7700.00	48.31	76.580	7331.91	1407.16N	1081.47W	10.00	-833.80	
7800.00	57.81	80.500	7391.96	1422.85N	1003.22W	10.00	-754.04	
7900.00	67.41	83.680	7437.92	1434.94N	915.38W	10.00	-665.41	
8000.00	77.06	86.430	7468.41	1443.08N	820.62W	10.00	-570.61	
8100.00	86.73	88.980	7482.49	1447.01N	721.83W	10.00	-472.52	
8200.00	90.00	89.820	7483.45	1447.57N	621.85W	==>	-373.83	
8300.00	90.00	89.820	7483.45	1447.88N	521.85W	==>	-275.16	
8400.00	90.00	89.820	7483.45	1448.19N	421.85W	==>	-176.48	
8500.00	90.00	89.820	7483.45	1448.50N	321.85W	==>	-77.81	
8600.00	90.00	89.820	7483.45	1448.81N	221.85W	==>	20.86	
8700.00	90.00	89.820	7483.45	1449.12N	121.85W	==>	119.54	
8800.00	90.00	89.820	7483.45	1449.43N	21.85W	==>	218.21	
8900.00	90.00	89.820	7483.45	1449.74N	78.15E	==>	316.88	
9000.00	90.00	89.820	7483.45	1450.05N	178.15E	==>	415.56	

All data is in Feet unless otherwise stated  
Coordinates are from Slot MD's are from Rig and TVD's are from Rig ( Planned Datum #1 5062.5ft above Mean Sea Level )  
Vertical Section is from 0.00N 0.00E on azimuth 80.480 degrees  
Bottom hole distance is 8927.84 Feet on azimuth 80.48 degrees from Wellhead  
Calculation method uses Minimum Curvature method  
Prepared by IPT  
Date Printed: 31-Jan-2017



SYSDRILL  
Well Design Combined Report  
Wellbore: W PC NORTH 1S-66-2928-6NH (PWB)



Interpolated Wellpath								
MD[ft]	Inc[deg]	Azi[deg]	TVD[ft]	North[ft]	East[ft]	Dogleg [deg/100ft]	Vertical Section[ft]	All Station Comments
9100.00	90.00	89.820	7483.45	1450.36N	278.15E	==>	514.23	
9200.00	90.00	89.820	7483.45	1450.67N	378.15E	==>	612.90	
9300.00	90.00	89.820	7483.45	1450.98N	478.15E	==>	711.58	
9400.00	90.00	89.820	7483.45	1451.29N	578.15E	==>	810.25	
9500.00	90.00	89.820	7483.45	1451.60N	678.15E	==>	908.92	
9600.00	90.00	89.820	7483.45	1451.91N	778.15E	==>	1007.60	
9700.00	90.00	89.820	7483.45	1452.22N	878.15E	==>	1106.27	
9800.00	90.00	89.820	7483.45	1452.53N	978.14E	==>	1204.94	
9900.00	90.00	89.820	7483.45	1452.84N	1078.14E	==>	1303.62	
10000.00	90.00	89.820	7483.45	1453.15N	1178.14E	==>	1402.29	
10100.00	90.00	89.820	7483.45	1453.46N	1278.14E	==>	1500.96	
10200.00	90.00	89.820	7483.45	1453.77N	1378.14E	==>	1599.64	
10300.00	90.00	89.820	7483.45	1454.08N	1478.14E	==>	1698.31	
10400.00	90.00	89.820	7483.45	1454.39N	1578.14E	==>	1796.98	
10500.00	90.00	89.820	7483.45	1454.70N	1678.14E	==>	1895.66	
10600.00	90.00	89.820	7483.45	1455.01N	1778.14E	==>	1994.33	
10700.00	90.00	89.820	7483.45	1455.32N	1878.14E	==>	2093.00	
10800.00	90.00	89.820	7483.45	1455.63N	1978.14E	==>	2191.68	
10900.00	90.00	89.820	7483.45	1455.95N	2078.14E	==>	2290.35	
11000.00	90.00	89.820	7483.45	1456.26N	2178.14E	==>	2389.02	
11100.00	90.00	89.820	7483.45	1456.57N	2278.14E	==>	2487.69	
11200.00	90.00	89.820	7483.45	1456.88N	2378.14E	==>	2586.37	
11300.00	90.00	89.820	7483.45	1457.19N	2478.14E	==>	2685.04	
11400.00	90.00	89.820	7483.45	1457.50N	2578.14E	==>	2783.71	
11500.00	90.00	89.820	7483.45	1457.81N	2678.14E	==>	2882.39	
11600.00	90.00	89.820	7483.45	1458.12N	2778.14E	==>	2981.06	
11700.00	90.00	89.820	7483.45	1458.43N	2878.14E	==>	3079.73	
11800.00	90.00	89.820	7483.45	1458.74N	2978.14E	==>	3178.41	
11900.00	90.00	89.820	7483.45	1459.05N	3078.13E	==>	3277.08	
12000.00	90.00	89.820	7483.45	1459.36N	3178.13E	==>	3375.75	
12100.00	90.00	89.820	7483.45	1459.67N	3278.13E	==>	3474.43	
12200.00	90.00	89.820	7483.45	1459.98N	3378.13E	==>	3573.10	
12300.00	90.00	89.820	7483.45	1460.29N	3478.13E	==>	3671.77	
12400.00	90.00	89.820	7483.45	1460.60N	3578.13E	==>	3770.45	
12500.00	90.00	89.820	7483.45	1460.91N	3678.13E	==>	3869.12	
12600.00	90.00	89.820	7483.45	1461.22N	3778.13E	==>	3967.79	
12700.00	90.00	89.820	7483.45	1461.53N	3878.13E	==>	4066.47	
12800.00	90.00	89.820	7483.45	1461.84N	3978.13E	==>	4165.14	
12900.00	90.00	89.820	7483.45	1462.15N	4078.13E	==>	4263.81	
13000.00	90.00	89.820	7483.45	1462.46N	4178.13E	==>	4362.49	
13100.00	90.00	89.820	7483.45	1462.77N	4278.13E	==>	4461.16	
13200.00	90.00	89.820	7483.45	1463.08N	4378.13E	==>	4559.83	
13300.00	90.00	89.820	7483.45	1463.39N	4478.13E	==>	4658.51	
13400.00	90.00	89.820	7483.45	1463.70N	4578.13E	==>	4757.18	
13500.00	90.00	89.820	7483.45	1464.01N	4678.13E	==>	4855.85	
13600.00	90.00	89.820	7483.45	1464.32N	4778.13E	==>	4954.53	
13700.00	90.00	89.820	7483.45	1464.63N	4878.13E	==>	5053.20	
13800.00	90.00	89.820	7483.45	1464.94N	4978.13E	==>	5151.87	
13900.00	90.00	89.820	7483.45	1465.25N	5078.13E	==>	5250.55	
14000.00	90.00	89.820	7483.45	1465.56N	5178.12E	==>	5349.22	
14100.00	90.00	89.820	7483.45	1465.87N	5278.12E	==>	5447.89	
14200.00	90.00	89.820	7483.45	1466.18N	5378.12E	==>	5546.56	
14300.00	90.00	89.820	7483.45	1466.49N	5478.12E	==>	5645.24	
14400.00	90.00	89.820	7483.45	1466.80N	5578.12E	==>	5743.91	
14500.00	90.00	89.820	7483.45	1467.11N	5678.12E	==>	5842.58	
14600.00	90.00	89.820	7483.45	1467.42N	5778.12E	==>	5941.26	
14700.00	90.00	89.820	7483.45	1467.74N	5878.12E	==>	6039.93	
14800.00	90.00	89.820	7483.45	1468.05N	5978.12E	==>	6138.60	
14900.00	90.00	89.820	7483.45	1468.36N	6078.12E	==>	6237.28	

All data is in Feet unless otherwise stated  
Coordinates are from Slot MD's are from Rig and TVD's are from Rig ( Planned Datum #1 5062.5ft above Mean Sea Level )  
Vertical Section is from 0.00N 0.00E on azimuth 80.480 degrees  
Bottom hole distance is 8927.84 Feet on azimuth 80.48 degrees from Wellhead  
Calculation method uses Minimum Curvature method  
Prepared by IPT  
Date Printed: 31-Jan-2017



SYS DRILL  
Well Design Combined Report  
Wellbore: W PC NORTH 1S-66-2928-6NH (PWB)



Interpolated Wellpath								
MD[ft]	Inc[deg]	Azi[deg]	TVD[ft]	North[ft]	East[ft]	Dogleg [deg/100ft]	Vertical Section[ft]	All Station Comments
15000.00	90.00	89.820	7483.45	1468.67N	6178.12E	==>	6335.95	
15100.00	90.00	89.820	7483.45	1468.98N	6278.12E	==>	6434.62	
15200.00	90.00	89.820	7483.45	1469.29N	6378.12E	==>	6533.30	
15300.00	90.00	89.820	7483.45	1469.60N	6478.12E	==>	6631.97	
15400.00	90.00	89.820	7483.45	1469.91N	6578.12E	==>	6730.64	
15500.00	90.00	89.820	7483.45	1470.22N	6678.12E	==>	6829.32	
15600.00	90.00	89.820	7483.45	1470.53N	6778.12E	==>	6927.99	
15700.00	90.00	89.820	7483.45	1470.84N	6878.12E	==>	7026.66	
15800.00	90.00	89.820	7483.45	1471.15N	6978.12E	==>	7125.34	
15900.00	90.00	89.820	7483.45	1471.46N	7078.12E	==>	7224.01	
16000.00	90.00	89.820	7483.45	1471.77N	7178.12E	==>	7322.68	
16100.00	90.00	89.820	7483.45	1472.08N	7278.11E	==>	7421.36	
16200.00	90.00	89.820	7483.45	1472.39N	7378.11E	==>	7520.03	
16300.00	90.00	89.820	7483.45	1472.70N	7478.11E	==>	7618.70	
16400.00	90.00	89.820	7483.45	1473.01N	7578.11E	==>	7717.38	
16500.00	90.00	89.820	7483.45	1473.32N	7678.11E	==>	7816.05	
16600.00	90.00	89.820	7483.45	1473.63N	7778.11E	==>	7914.72	
16700.00	90.00	89.820	7483.45	1473.94N	7878.11E	==>	8013.40	
16800.00	90.00	89.820	7483.45	1474.25N	7978.11E	==>	8112.07	
16900.00	90.00	89.820	7483.45	1474.56N	8078.11E	==>	8210.74	
17000.00	90.00	89.820	7483.45	1474.87N	8178.11E	==>	8309.42	
17100.00	90.00	89.820	7483.45	1475.18N	8278.11E	==>	8408.09	
17200.00	90.00	89.820	7483.45	1475.49N	8378.11E	==>	8506.76	
17300.00	90.00	89.820	7483.45	1475.80N	8478.11E	==>	8605.43	
17400.00	90.00	89.820	7483.45	1476.11N	8578.11E	==>	8704.11	
17500.00	90.00	89.820	7483.45	1476.42N	8678.11E	==>	8802.78	
17600.00	90.00	89.820	7483.45	1476.73N	8778.11E	==>	8901.45	
17626.74	90.00	89.820	7483.45	1476.82N	8804.85E	==>	8927.84	

All data is in Feet unless otherwise stated  
Coordinates are from Slot MD's are from Rig and TVD's are from Rig ( Planned Datum #1 5062.5ft above Mean Sea Level )  
Vertical Section is from 0.00N 0.00E on azimuth 80.480 degrees  
Bottom hole distance is 8927.84 Feet on azimuth 80.48 degrees from Wellhead  
Calculation method uses Minimum Curvature method  
Prepared by IPT  
Date Printed: 31-Jan-2017



SYSDRILL  
Well Design Combined Report  
Wellbore: W PC NORTH 1S-66-2928-6NH (PWB)



Targets							
Name	North[ft]	East[ft]	TVD[ft]	Latitude	Longitude	Northing	Easting
PC NORTH 1S-66-2928-6NH - BHL	1476.82N	8804.85E	7483.45	N39 56 20.6160	W104 46 22.3680	1221483.96	3203885.02
PC NORTH 1S-66-2928-6NH - EPL	1447.36N	788.12W	7483.45	N39 56 21.0840	W104 48 25.5240	1221454.51	3194292.34

Survey Tool Program						
Reference	Survey Name	MD[ft]	TVD[ft]	Survey Tool	Error Model	
523085	Planned	1500.00	1499.93	WdW Rate Gyro	Standard	
523084	Planned	17626.74	7483.45	ISCWSA MWD	Rev 4 + SAG + FLT	

Notes



SYSDRILL  
Closest Approach + Clearance Factor Summary Report  
Wellbore: W PC NORTH 1S-66-2928-6NH (PWB)



Ellipse separations are reported ONLY if BOTH wells have uncertainty data
Only Depth and Magnetic Reference Field error terms are correlated across tie points
Scan limit is calculated on CENTRE to CENTRE distance
Summary data uses Closest Approach clearance calculation for all minima
Hole size/Casings ARE included
Hole size/Casings are NOT subtracted from Centre-Centre distance
Confidence limit of 95.00% / 2.80 SD.

Wellbore		
Name	Created	Last Revised
W PC NORTH 1S-66-2928-6NH (PWB)	Jan-24-2017	Jan-24-2017

Well		
Name	Government ID	Last Revised
W PC NORTH 1S-66-2928-6NH		Jan-24-2017

Slot						
Name	Latitude	Longitude	Grid Northing	Grid Easting	North	East
PC NORTH 1S-66-2928-6NH	N39 56 6.7200	W104 48 15.5520	1220007.1874	3195080.4361	76.50S	0.60E

Installation						
Name	Installation Position (Latitude)	Installation Position (Longitude)	Easting	Northing	Coord System Name	North Alignment
PC 1S-66-2928 PAD	N39 56 7.4760	W104 48 15.5520	3195079.8360	1220083.6821	CO83-NF on NORTH AMERICAN DATUM 1983 datum	Grid

Clearance Summary							
Offset WellName	Separation [ft]	MD[ft]	Diverging From[ft]	Ellipse Separation [ft]	Ellipse MD[ft]	Clearance Factor	Clearance MD[ft]
W PC NORTH 1S-66-2928-7CD H	14.57	1350.00	1350.00	-183.25	17626.74	0.63	17626.74
W PC NORTH 1S-66-2928-5NH	14.57	1300.00	1300.00	-358.00	17626.74	0.52	17626.74
W PC NORTH 1S-66-2928-8NH	29.14	1350.00	17625.67	-401.63	17625.67	0.46	17625.67
W PC SOUTH 1S-66-2928-16C DH	30.85	1350.00	17626.74	28.67	1361.55	3.30	17626.74
W PC NORTH 1S-66-2928-4CD H	32.79	1250.35	17626.74	-73.04	17626.74	0.89	17626.74
W PC SOUTH 1S-66-2928-15N H	34.12	1350.00	17626.74	31.93	1361.55	2.92	17626.74
W PC SOUTH 1S-66-2928-17N H	34.12	1350.00	17626.74	31.94	1361.55	3.43	17626.74
W PC SOUTH 1S-66-2928-18N H	42.44	1350.00	17626.74	40.26	1350.00	3.92	17626.74
W PC NORTH 1S-66-2928-9NH	43.71	1350.00	17626.74	-52.13	17626.74	0.93	17626.74
W PC SOUTH 1S-66-2928-14N H	44.96	1461.38	17626.74	42.58	1500.00	2.41	17626.74
W PC NORTH 1S-66-2928-3NH	47.36	1200.38	1200.38	-8.18	17626.74	0.99	17626.74

All data is in Feet unless otherwise stated  
Coordinates are from Slot MD's are from Rig and TVD's are from Rig ( Planned Datum #1 5062.5ft above Mean Sea Level )  
Vertical Section is from 0.00N 0.00E on azimuth 80.480 degrees  
Prepared by IPT  
Date Printed: 31-Jan-2017



SYS DRILL  
Closest Approach + Clearance Factor Summary Report  
Wellbore: W PC NORTH 1S-66-2928-6NH (PWB)



Clearance Summary							
Offset WellName	Separation [ft]	MD[ft]	Diverging From[ft]	Ellipse Separation [ft]	Ellipse MD[ft]	Clearance Factor	Clearance MD[ft]
W PC SOUTH 1S-66-2928-19C DH	53.50	1350.00	17626.74	51.33	1350.00	4.36	17626.74
W PC SOUTH 1S-66-2928-13C DH	55.08	1624.02	17626.74	52.47	1640.42	2.22	17626.74
W PC NORTH 1S-66-2928-10C DH	58.29	1350.00	17626.74	56.11	1361.55	1.23	17626.74
W PC NORTH 1S-66-2928-2NH	61.93	1150.51	17626.74	60.08	1150.51	1.39	17626.74
W PC SOUTH 1S-66-2928-12N H	65.20	1714.25	17626.74	62.10	1738.85	1.90	17626.74
W PC SOUTH 1S-66-2928-20N H	65.94	1350.00	17626.74	63.77	1350.00	4.47	17626.74
W PC NORTH 1S-66-2928-11N H	75.32	1789.32	17618.11	71.67	1820.87	1.41	17626.74
W POLLARD #1	3077.02	13509.15	13509.15	2818.29	13615.49	11.46	14173.23



