

# STROMBERGER 22-E PAD LOCATION DRAWING

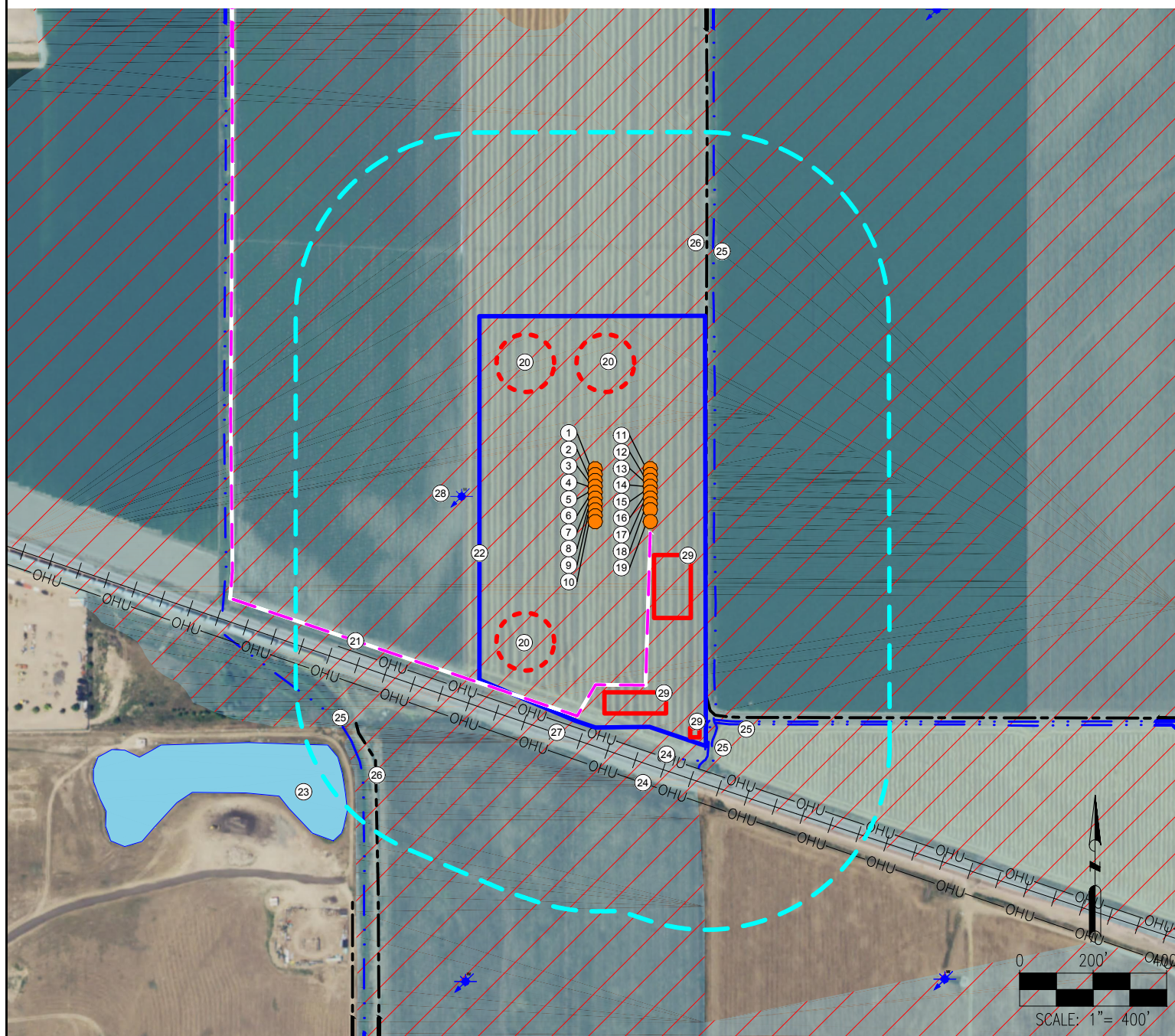

- |          |                   |  |  |
|----------|-------------------|--|--|
| 1. RBF 1 | 10. RBF 10        | 19. RBF 11   | 26. PRIVATE ROAD IS ±152' E, ±1028' SW |
| 2. RBF 2 | 11. STROMBERGER 1 | 20. PROPOSED MLVT                                      | 27. RAILROAD IS ±718' SW               |
| 3. RBF 3 | 12. STROMBERGER 2 | 21. PROPOSED ACCESS ROAD                               | 28. ABANDONED WATER WELL IS ±514' W    |
| 4. RBF 4 | 13. STROMBERGER 3 | 22. DISTURBANCE AREA                                   | 29. PROPOSED FACILITY BERM             |
| 5. RBF 5 | 14. STROMBERGER 4 | 23. POND IS ±1125' SW                                  |  |
| 6. RBF 6 | 15. STROMBERGER 5 | 24. OVERHEAD UTILITIES ARE ±686' SW, ±770' SW          |  |
| 7. RBF 7 | 16. STROMBERGER 6 | 25. DITCHES ARE ±174' E, ±658' SE, ±667' SE, ±1061' SW |  |
| 8. RBF 8 | 17. STROMBERGER 7 |  |  |
| 9. RBF 9 | 18. STROMBERGER 8 |  |  |

## LEGEND:

- |                 |                        |                          |
|-----------------|------------------------|--------------------------|
| = PROPOSED WELL | = PROPOSED ACCESS ROAD | = DISTURBANCE AREA       |
| = WATER WELL    | = EXISTING ROAD        | = 500' RADIUS            |
| = RAILROAD      | = DITCH                | = POND                   |
|                 | = OVERHEAD UTILITY     | = BUILDING UNIT          |
|                 | = FLOODPLAIN           | = BUILDING               |
|                 | = PROPOSED MLVT        | = PROPOSED FACILITY BERM |

DISCLAIMER:  
THIS PLOT DOES NOT REPRESENT A MONUMENTED LAND SURVEY, AND SHOULD NOT BE RELIED UPON TO DETERMINE BOUNDARY LINES, PROPERTY OWNERSHIP, OR OTHER PROPERTY INTERESTS. PARCEL LINES, IF DEPICTED, HAVE NOT BEEN FIELD VERIFIED, AND MAY BE BASED UPON PUBLICLY AVAILABLE DATA THAT ALSO HAS NOT BEEN INDEPENDENTLY VERIFIED.

DATA SOURCE:  
AERIAL IMAGERY: NAIP 2015  
WATER WELLS: COLORADO DWR  
NHD: USGS

PUBLICLY AVAILABLE DATA SOURCES HAVE NOT BEEN INDEPENDENTLY VERIFIED BY PFS.

## MEASURED FROM NEAREST WELL OR FACILITY:

BUILDING ±1619' N  
BUILDING UNIT ±1729' SE  
PUBLIC ROAD (E GARDEN DR) ±1896' SW  
PROP. LINE (STROMBERGER, HARRY TRUST) ±22' E  
UTILITY (POWERLINE) ±83' S  
RAILROAD ±116' S

## MEASURED FROM NEAREST EDGE OF DISTURBANCE:

SURFACE WATER (DITCH) ±0' SE

## MEASURED FROM NEAREST WELL:

WATER WELL ±1473' NE SWL = 12'  
PERMIT: 318-RD RECEIPT: 9058431

## REFERENCE LOCATION

\*\* STROMBERGER 4 \*\*

LAT: 40.474235°  
LONG: -104.870861°  
ELEVATION: 4778'  
1994' FNL & 150' FEL  
PDOP: 2.7

GPS OPERATOR: BRYAN JOHNSON

## DISTURBANCE ACREAGE:

15.44 ACRES DRILLING OPERATIONS  
7.90 ACRES INTERIM RECLAIM

CURRENT SURFACE USE: IRRIGATED CROP  
FUTURE SURFACE USE: IRRIGATED CROP

PREPARED BY:



FIELD DATE:

06-24-15

DRAWING DATE:

01-13-17

BY:

KWH

CHECKED BY:

IJM

SITE NAME:

STROMBERGER 22-E PAD

SURFACE LOCATION:

SE 1/4 NE 1/4 SEC. 22, T6N, R67W, 6TH P.M.

WELD COUNTY, COLORADO

PREPARED FOR:

