

CASK PAD LOCATION DRAWING

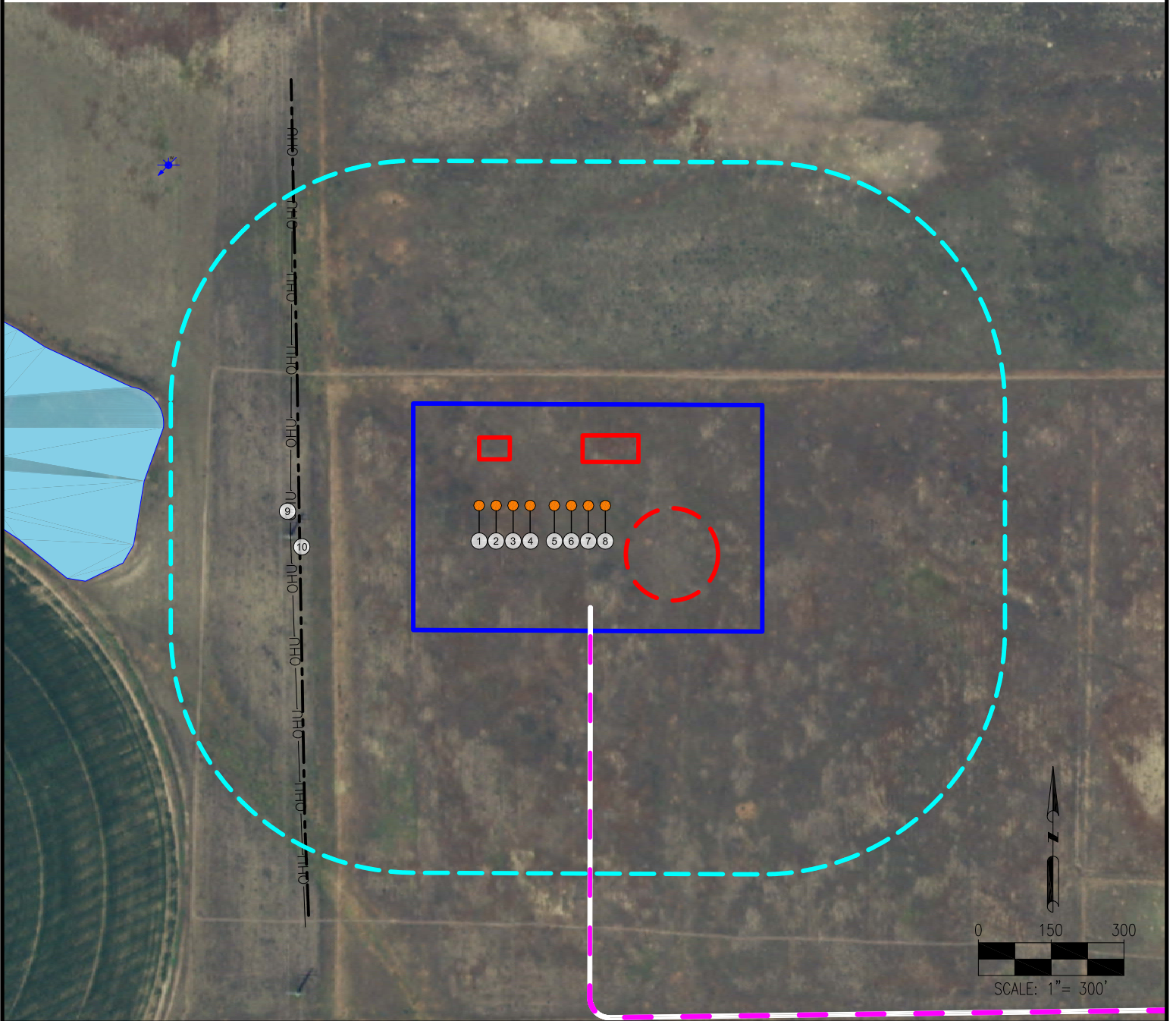

- | | |
|---|--|
| <ol style="list-style-type: none"> 1. BARLEY WINE 8-67-28-27C 2. BITTLER 8-67-28-27C 3. BROWN ALE 8-67-28-27C 4. ESB 8-67-28-27C 5. IPA 8-67-28-27C 6. MILD ALE 8-67-28-27C 7. OLD ALE 8-67-28-27N 8. STOUT 8-67-28-27N | <ol style="list-style-type: none"> 9. OVERHEAD UTILITY LINE 493' W 10. PRIVATE ROAD 476' W |
|---|--|

LEGEND:

- | | | |
|---|--|---|
| <ul style="list-style-type: none"> = PROPOSED WELL = WATER WELL | <ul style="list-style-type: none"> = PROPOSED ACCESS ROAD = EXISTING ROAD = OVERHEAD UTILITY | <ul style="list-style-type: none"> = DISTURBANCE AREA = 500' RADIUS = PROPOSED FACILITY BERM = PROPOSED MLVT = POND |
|---|--|---|

MEASURED FROM NEAREST WELL OR FACILITY:

BUILDING	±2566' E
BUILDING UNIT	±2578' E
PUBLIC ROAD (COUNTY ROAD 19)	±4083' N
PROPERTY LINE (ANHEUSER-BUSCH INC)	±125' N
UTILITY (POWERLINE)	±388' W
RAILROAD	+5280' SW

REFERENCE LOCATION

ESB 8-67-28-27C

LAT: 40.628235°N
 LONG: 104.904830°W
 ELEVATION: 5177'
 1057' FSL & 668' FWL
 PDOP: 1.3
 GPS OPERATOR: AL HNIZDO

MEASURED FROM NEAREST EDGE OF DISTURBANCE:

SURFACE WATER (DETENSION POND)	±514' W
--------------------------------	---------

MEASURED FROM NEAREST WELL:

WATER WELL	±949' NW	SWL = 0'
PERMIT: 251683	RECEIPT: 0510476B	
WATER WELL	±3337' SE	SWL = 73'
PERMIT: 191853	RECEIPT: 0393337	

DISTURBANCE ACREAGE:

7.7 ACRES DRILLING OPERATIONS
 3.85 ACRES INTERIM RECLAIM

CURRENT SURFACE USE: IMPROVED PASTURE
 FUTURE SURFACE USE: IMPROVED PASTURE

DISCLAIMER:
 THIS PLOT DOES NOT REPRESENT A MONUMENTED LAND SURVEY AND SHOULD NOT BE RELIED UPON TO DETERMINE BOUNDARY LINES, PROPERTY OWNERSHIP OR OTHER PROPERTY INTERESTS, PARCEL LINES, IF DEPICTED HAVE NOT BEEN FIELD VERIFIED AND MAY BE BASED UPON PUBLICLY AVAILABLE DATA THAT ALSO HAS NOT BEEN INDEPENDENTLY VERIFIED.

DATA SOURCE:
 AERIAL IMAGERY: NAD 2015
 WATER WELLS: COLORADO DWR
 NHD: USGS

PUBLICLY AVAILABLE DATA SOURCES HAVE NOT BEEN INDEPENDENTLY VERIFIED BY PFS.

PREPARED BY:



FIELD DATE:
01-06-17

DRAWING DATE:
01-24-17

BY:
MDC

CHECKED BY:
IJM

SITE NAME:
CASK PAD

SURFACE LOCATION:
SW 1/4 SW 1/4 SEC. 28 T8N, R67W, 6TH P.M.
WELD COUNTY, COLORADO

PREPARED FOR:

