

CASK PAD HYDROLOGY MAP

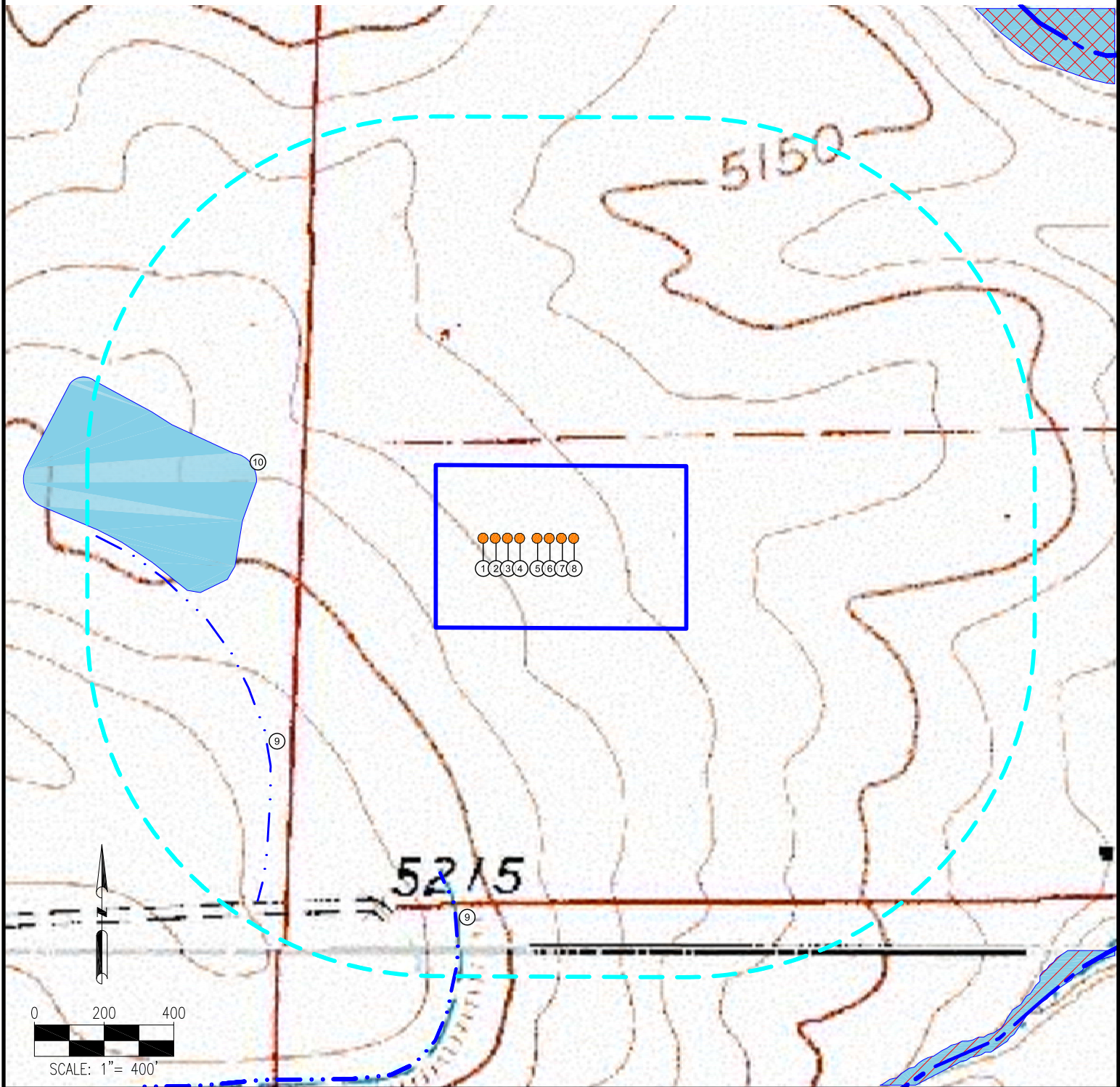

MEASUREMENTS ARE MADE FROM THE NEAREST EDGE OF THE DISTURBANCE AREA.

- | | |
|----------------------------|--|
| 1. BARLEY WINE 8-67-28-27C | 7. OLD ALE 8-67-28-27N |
| 2. BITTLER 8-67-28-27C | 8. STOUT 8-67-28-27N |
| 3. BROWN ALE 8-67-28-27C | 9. DITCHES ARE $\pm 565'$ SW, $\pm 704'$ S |
| 4. ESB 8-67-28-27C | 10. POND IS $\pm 515'$ W |
| 5. IPA 8-67-28-27C | |
| 6. MILD ALE 8-67-28-27C | |

LEGEND:

- | | | |
|-----------------|--------------|--------------------|
| = PROPOSED WELL | = POND | = DISTURBANCE AREA |
| = DITCH | = WETLANDS | = 1000' RADIUS |
| = STREAM | = FLOODPLAIN | |

DISCLAIMER:
THIS PLOT DOES NOT REPRESENT A MONUMENTED LAND SURVEY AND SHOULD NOT BE
RELIED UPON TO DETERMINE BOUNDARY LINES, PROPERTY OWNERSHIP OR OTHER
PROPERTY INTERESTS, PARCEL LINES, IF DEPICTED HAVE NOT BEEN FIELD VERIFIED AND
MAY BE BASED UPON PUBLICLY AVAILABLE DATA THAT ALSO HAS NOT BEEN
INDEPENDENTLY VERIFIED.

DATA SOURCE:
TOPO MAP: USGS
NHD: USGS

PUBLICLY AVAILABLE DATA SOURCES HAVE NOT BEEN
INDEPENDENTLY VERIFIED BY PFS.

FIELD DATE:
01-06-17

DRAWING DATE:
01-26-17

BY:
KAD

CHECKED BY:
IJM

SITE NAME:
CASK PAD

SURFACE LOCATION:
SW 1/4 SW 1/4 SEC. 28, T8N, R67W, 6TH P.M.
WELD COUNTY, COLORADO

PREPARED FOR: