

Project: Greeley Crescent  
 Site: J Section 29-T5N-R66W Weld County, CO  
 Well: Sanford J29-660  
 Wellbore: Original Drilling  
 Design: APD - Rev 1

# Northern Region - DJ Basin

Geodetic System: US State Plane 1983  
 Datum: North American Datum 1983  
 Ellipsoid: GRS 1980  
 Zone: Colorado Northern Zone  
 System Datum: Mean Sea Level

## SECTION DETAILS

Sec	MD	Inc	Azi	TVD	+N/-S	+E/-W	Dleg	TFace	VSec	Target
1	0.0	0.00	0.00	0.0	0.0	0.0	0.00	0.00	0.0	
2	2300.0	0.00	0.00	2300.0	0.0	0.0	0.00	0.00	0.0	
3	2935.5	12.71	302.98	2930.3	38.2	-58.9	2.00	302.98	-57.1	
4	5846.2	12.71	302.98	5769.7	386.8	-596.1	0.00	0.00	-578.2	
5	6481.7	0.00	0.00	6400.0	425.0	-655.0	2.00	180.00	-635.3	
6	6722.1	0.00	0.00	6640.4	425.0	-655.0	0.00	0.00	-635.3	
7	7722.1	90.00	89.34	7277.0	432.4	-18.4	9.00	89.34	1.0	
8	20707.2	90.00	89.34	7277.0	582.4	12965.8	0.00	0.00	12978.9	Sanford J29-660 BHL 1980'FNL, 460'FEL

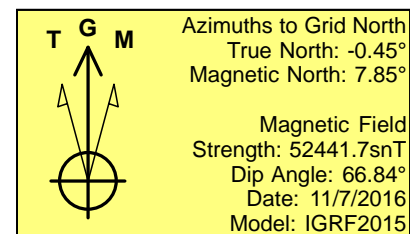
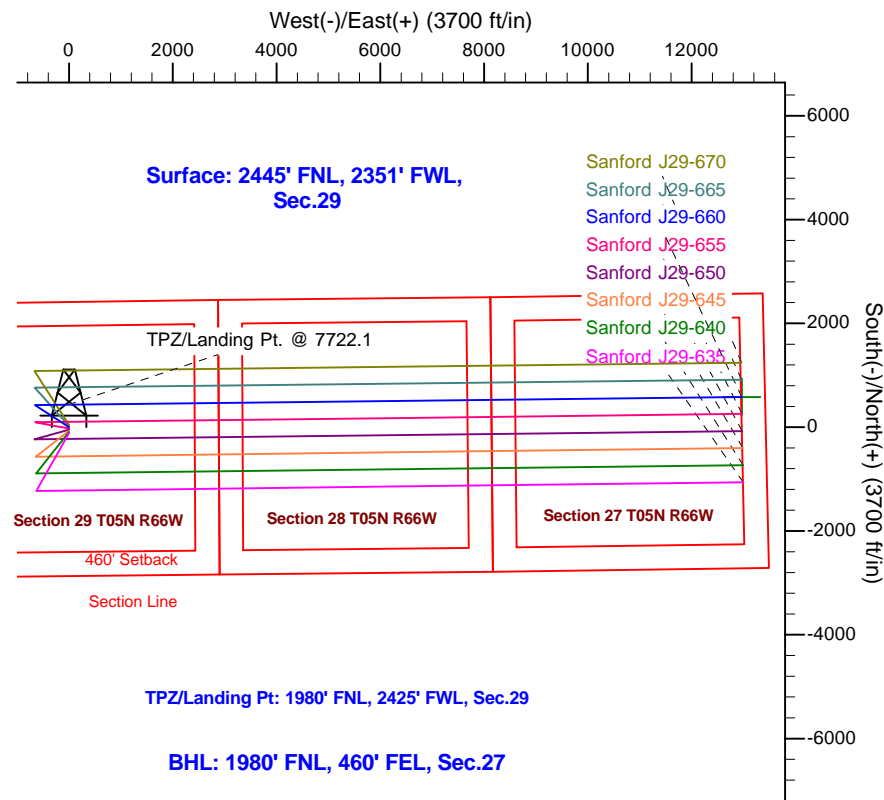
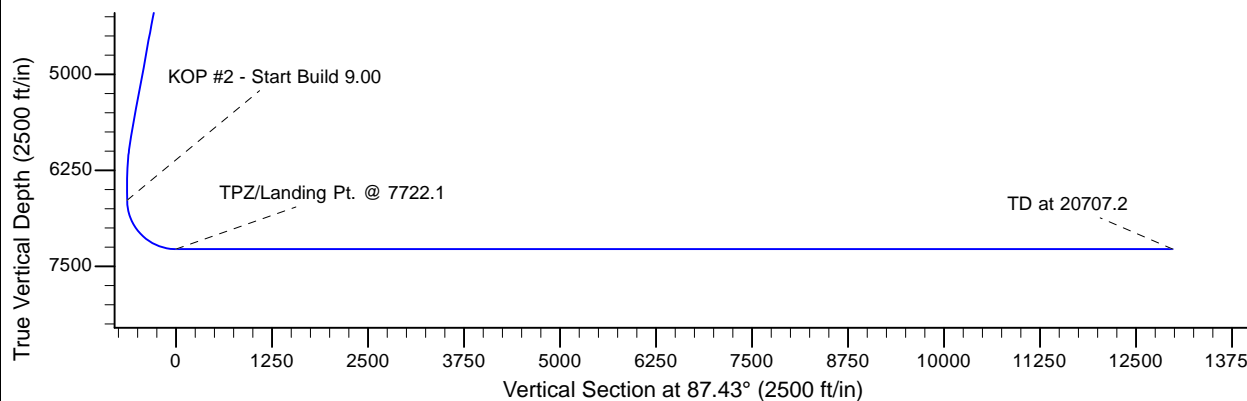
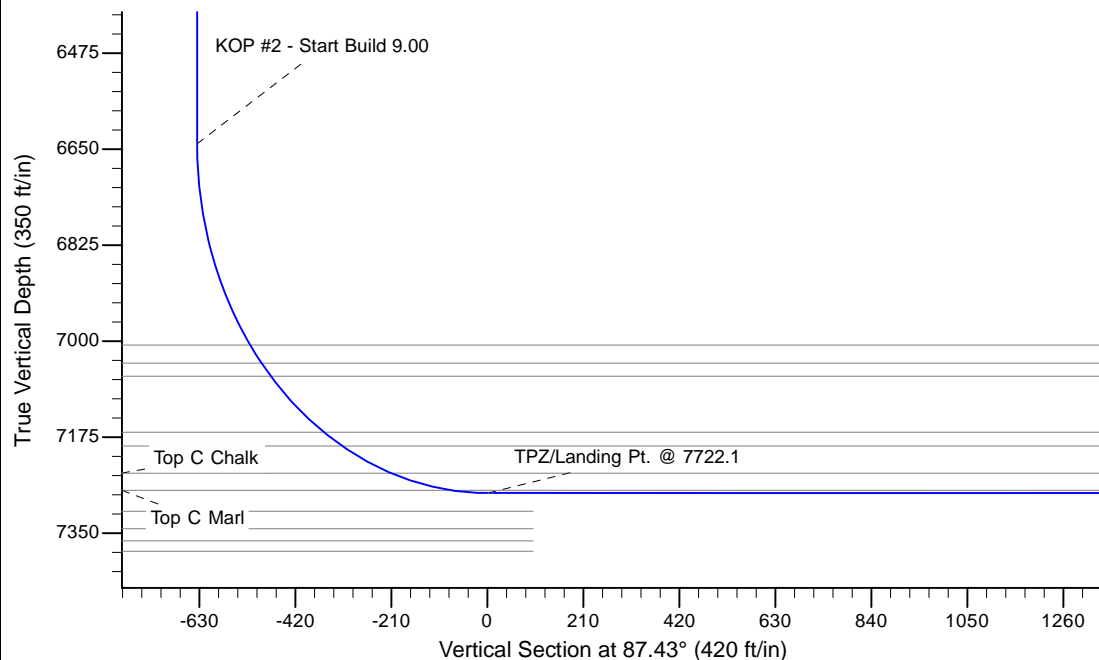

WELL DETAILS: Sanford J29-660					
		Ground Elevation: 4900.0			
	Northing	Easting	Latitude	Longitude	
0.0	0.0	1378774.18	3193809.76	40.3710500	-104.8044100
Plan: APD - Rev 1 (Sanford J29-660/Original Drilling)					
Created By: Shailey Jewell			Date: 15:15, January 18 2017		
OK to submit with 2A as per Noble Drilling 1/18/2017 3:18					