



PHOTO: VIEW OF LOCATION STAKES

CAMERA ANGLE: NORTHERLY



PHOTO: VIEW OF LOCATION STAKES

CAMERA ANGLE: EASTERLY

WHITING OIL & GAS CORP.

RAZOR #27KW-3436, 3437, 3438, 2236, 2204, 2237,
RAZOR FED #27KW-2238, 2205 & 2206
NW 1/4 SW 1/4, SECTION 27, T10N, R58W, 6th P.M.
WELD COUNTY, COLORADO



UELS, LLC
Corporate Office * 85 South 200 East
Vernal, UT 84078 * (435) 789-1017

DRAWN BY: J.D.J.	DATE DRAWN: 11-30-15
TAKEN BY: G.W.	REVISED: 00-00-00
LOCATION PHOTOS	PHOTO 1

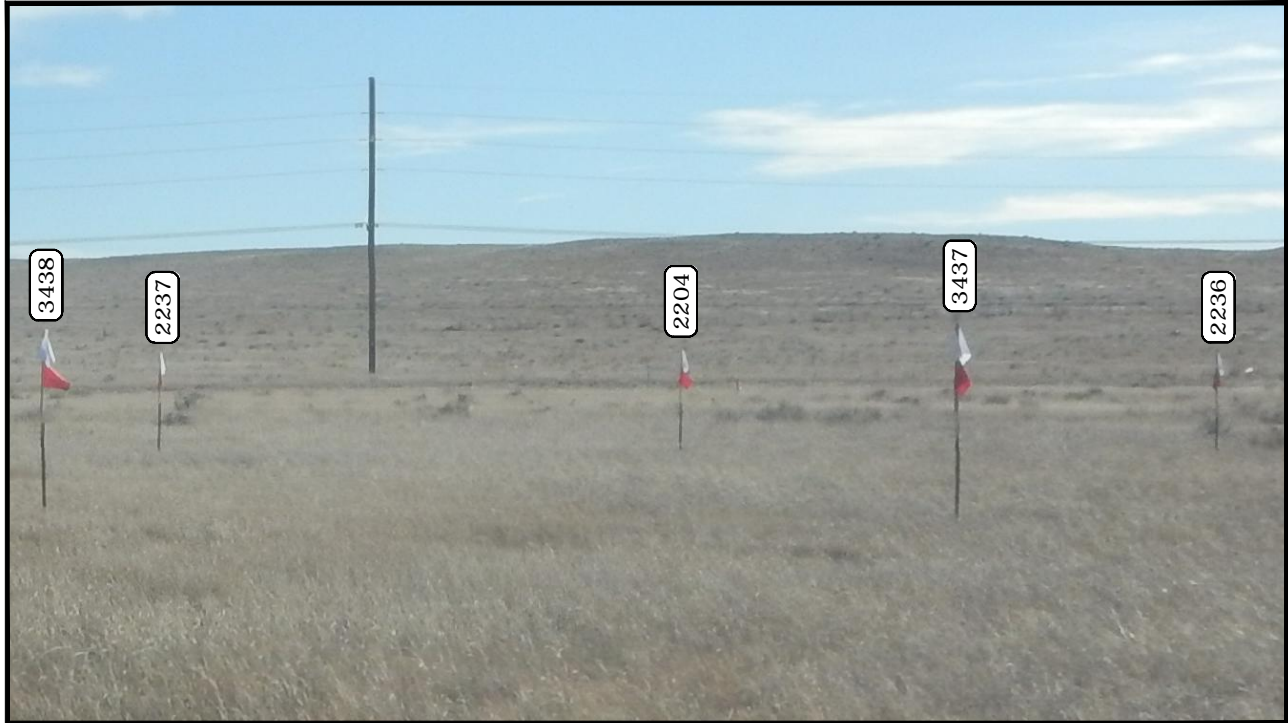

PHOTO: VIEW OF LOCATION STAKES

CAMERA ANGLE: SOUTHERLY



PHOTO: VIEW OF LOCATION STAKES

CAMERA ANGLE: WESTERLY

WHITING OIL & GAS CORP.

RAZOR #27KW-3436, 3437, 3438, 2236, 2204, 2237,
RAZOR FED #27KW-2238, 2205 & 2206
NW 1/4 SW 1/4, SECTION 27, T10N, R58W, 6th P.M.
WELD COUNTY, COLORADO



UELS, LLC
Corporate Office * 85 South 200 East
Vernal, UT 84078 * (435) 789-1017

DRAWN BY: J.D.J.	DATE DRAWN: 11-30-15
TAKEN BY: G.W.	REVISED: 00-00-00
LOCATION PHOTOS	PHOTO 2