



Lat40°, Inc. 6250 W. 10th Street, Unit 2, Greeley, CO 970-515-5294

# HYDROLOGY MAP

ELBERT 3-16 PAD

SECTION: 21  
TOWNSHIP: 5N  
RANGE: 65W  
6TH. P.M.  
WELD COUNTY, CO

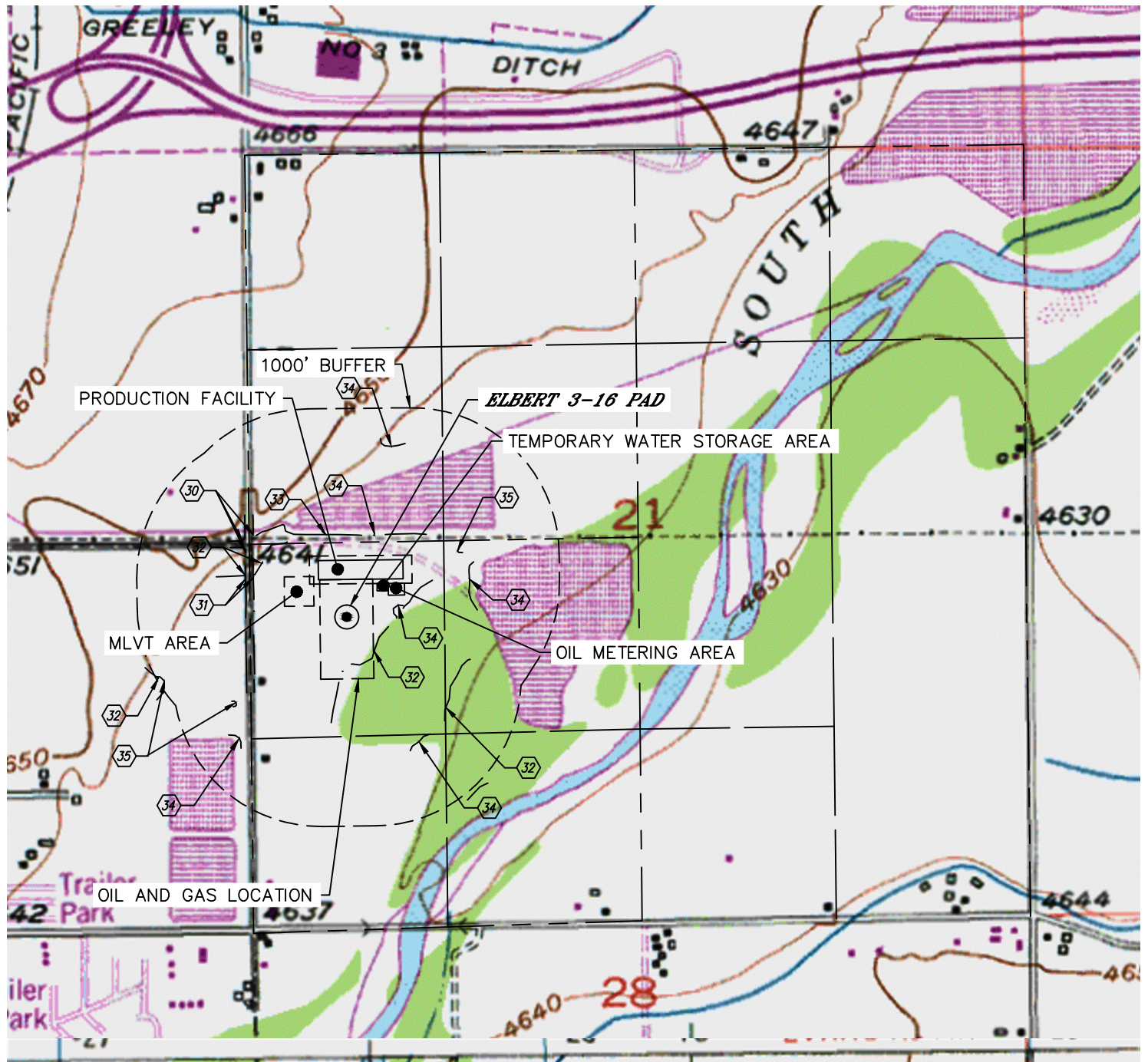

DISTANCES MEASURED FROM THE EDGE OF THE OIL AND GAS LOCATION.

- ③① FLOWLINE/CURB & GUTTER/ATTACHED SIDEWALK 313', 354' & 377' NW
- ③⑦ BARROW DITCH 211' & 265' W
- ③② DITCH (1) INSIDE LOCATION, 178' NW, 263' W, 526' SE, 987' NE
- ③③ CANAL 146' N
- ③④ POND 68' S, 137' & 740' N, 390' E, 526' SE, 682' SW
- ③⑤ LOW AREA 311' & 960' NE, 597' SW

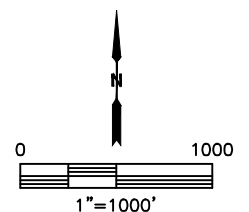

NEAREST DOWN GRADIENT SURFACE WATER: DITCH 178' NW

DATE: 12/12/2016  
PROJECT#: 2016085