

Selected Items Report

Oil and Gas Wells Selected

Filter Results by Formation Include ▼ Filter

WELL DESCRIPTION

LOCATION ID

LOCATION

WELL INFORMATION

Water Wells Selected From Map

Filter Results by Depth Greater than ▼ Filter

WELL DESCRIPTION

LOCATION

WELL INFORMATION

Depth

Top Perf

Bottom Perf

Aquifer

[Receipt=1503542, Permit=0070763-F-](#)
BP AMERICA PRODUCTION CO

NWSW 2
34 N-6W

0

0

0

GW

[Receipt=1503589, Permit=0070816-F-](#)
BP AMERICA PRODUCTION CO

NWNE 3
34 N-6W

0

0

0

GW

[Receipt=1503551, Permit=0070778-F-](#)
BP AMERICA PRODUCTION CO

NENW 3
34 N-6W

0

0

0

GW

[Receipt=1503554, Permit=0070781-F-](#)
BP AMERICA PRODUCTION CO

NWSE 3
34 N-6W

0

0

0

GW

[Receipt=9122499, Permit=0044458--](#)
LEE L WAYNE & CAROLYN H

NWSW 3
34 N-6W

87

0

0

GW

[Receipt=1503588, Permit=0070815-F-](#)
BP AMERICA PRODUCTION CO

NWSW 24
35 N-6W

0

0

0

GW

[Receipt=1503652, Permit=0070986-F-](#)
BP AMERICA PRODUCTION CO

SWSE 27
35 N-6W

0

0

0

GW

[Receipt=1503654, Permit=0070988-F-](#)
BP AMERICA PRODUCTION CO

SENE 34
35 N-6W

0

0

0

GW

[Receipt=1503549, Permit=0070770-F-](#)
BP AMERICA PRODUCTION CO

NENW 34
35 N-6W

0

0

0

GW

[Receipt=1503559, Permit=0070786-F-](#)
BP AMERICA PRODUCTION CO

NESE 34
35 N-6W

0

0

0

GW

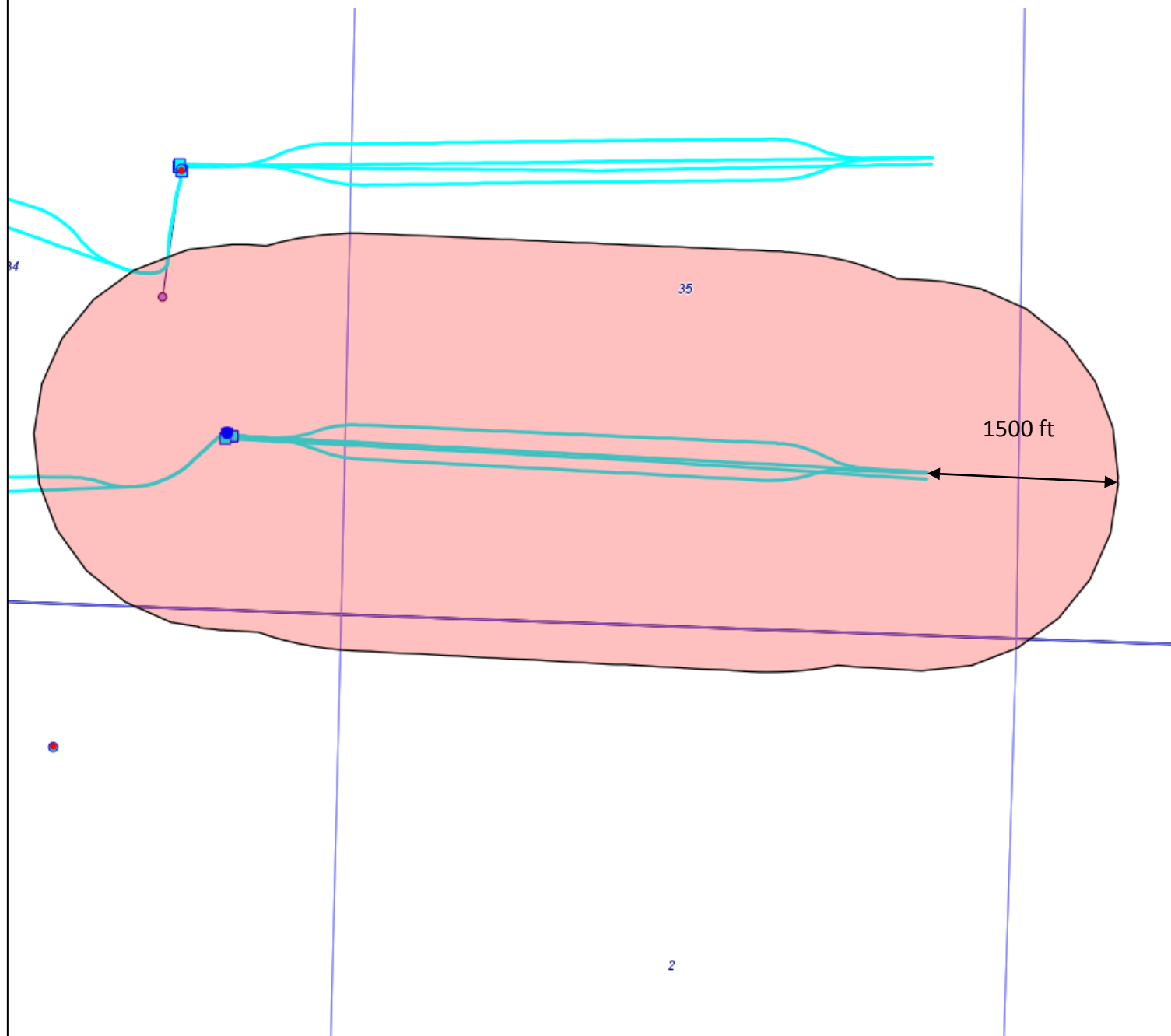
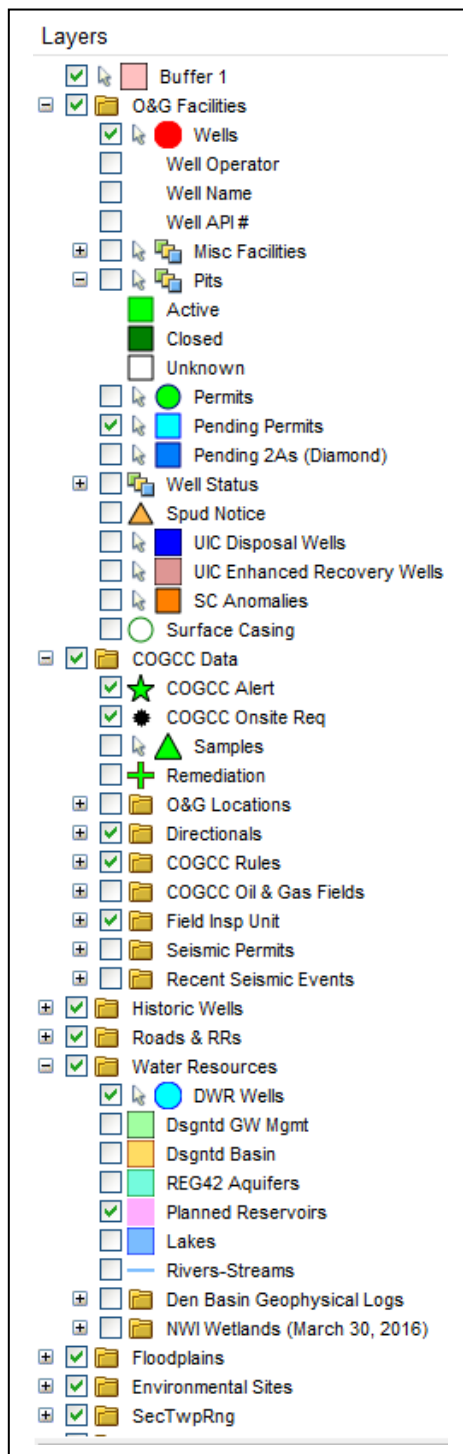

Selected Items Report

Oil and Gas Wells Selected

<div> Filter Results by Formation <div>Include</div> <div>FRLDC</div> <div>Filter</div> </div>			
WELL DESCRIPTION	LOCATION ID	LOCATION	WELL INFORMATION
05-067-07127, YANKEE FEDERAL B 1 BP AMERICA PRODUCTION COMPANY	325891	NESE 34 35N -6W (N) 37.254341, -107.509448	<div>Sidetrack TD Formation Status</div> <div>00 2865 FRLDC PR</div>

Water Wells Selected From Map

<div> Filter Results by Depth <div>Greater than</div> <div></div> <div>Filter</div> </div>					
WELL DESCRIPTION	LOCATION	WELL INFORMATION			
		Depth	Top Perf	Bottom Perf	Aquifer
Receipt=1503559, Permit=0070786-F- BP AMERICA PRODUCTION CO	NESE 34 35 N-6W	0	0	0	GW

COGIS - WELL Information

Scout Card

[Related](#)

[Insp.](#)

[1 Mile](#)

[MIT](#)

[NOAV](#)

[GIS](#)

[Doc](#)

[Review](#)

[COA](#)

[Wellbore](#)

[Orders](#)

Surface Location Data for API # 05-067-07127

Status: PR

3/1/1989

[Well Name/No:](#)

YANKEE FEDERAL B #1

(click well name for production)

[Operator:](#)

BP AMERICA PRODUCTION COMPANY - 10000

Status Date:

3/1/1989

Federal or State Lease #:

18133

County:

LA PLATA #067

Location:

NESE 34 35N6W N PM

Field:

IGNACIO BLANCO - #38300

Elevation:

7,392 ft.

Planned Location 1400 FSL 1010 FEL

[Lat/Long:](#) 37.254397/-107.509749

Lat/Long Calculated From Footages

As Drilled Location Footages Not Available

[Lat/Long:](#) 37.254341/-107.509448

Lat/Long Source: Field Measured

Wellbore Data for Sidetrack #00

Status: PR

3/1/1989

Wellbore Permit

Permit #:

880688

Expiration Date:

11/4/1988

Prop Depth/Form:

Surface Mineral Owner Same:

N

Mineral Owner:

FEDERAL

Surface Owner:

Unit:

Unit Number:

C-17340

Formation and Spacing:

Code: FRLDC , Formation: FRUITLAND COAL , Order: 0 , Unit Acreage: 320, Drill Unit: E2

Wellbore Completed

Completion Date:

3/2/1989

Measured TD:

2865

Measured PB depth:

2788

True Vertical TD:

2865

True Vertical PB depth:

Casing:

String Type: SURF , Hole Size: 12.25, Size: 8.625, Top: 0, Depth: 262, Weight: 24

Cement:

Sacks: 200, Top: 0, Bottom: 262, Method Grade:

Casing:

String Type: 1ST , Hole Size: 7.875, Size: 5.5, Top: 0, Depth: 2834, Weight: 17

Cement:

Sacks: 820, Top: 0, Bottom: 2834, Method Grade:

Formation	Log Top	Log Bottom	Cored	DSTs
FRUITLAND COAL	2494			
PICTURED CLIFFS	2665			

Completed information for formation FRLDC

Status: PR

3/1/1989

1st Production Date:

N/A

Choke Size:

0.000

Status Date:

3/1/1989

Open Hole Completion:

Commingled:

Production Method:

Formation Name:

FRUITLAND COAL

Status:

PR

Tubing Size:

Tubing Setting Depth: