

SECTION: 11
TOWNSHIP: 2N
RANGE: 64W

Y11-29 PAD

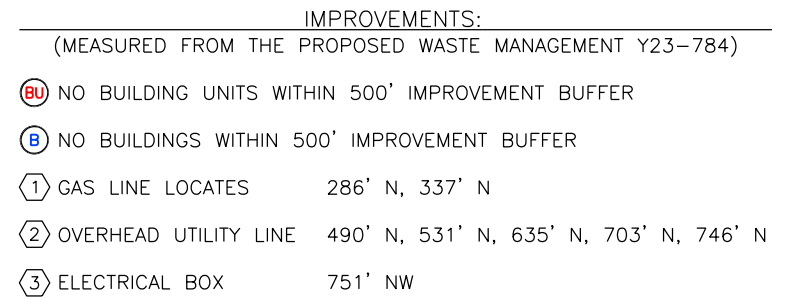

MEASURED FROM THE NEAREST	BUILDING	BUILDING UNIT	HIGH OCCUPANCY BUILDING UNIT	DESIGNATED OUTSIDE ACTIVITY AREA	PUBLIC ROAD	ABOVE GROUND UTILITY	RAILROAD	PROPERTY LINE
PROPOSED WELLHEAD	4908' S	4904' SW	5280'+	5280'+	4281' E (CR 59)	490' N	5280'+	787' N

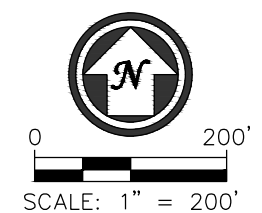

LEGEND

OG PROPOSED WELL

DATE: 12/02/2016
JOB #: NE16304