

K:\SYNERGY RESOURCES\2016 81 GOETZEL T6N R66W SEC 29\PLATS\GOETZEL 25-29\PLAT.dwg, 9/21/2016 4:22:00 PM, lisa

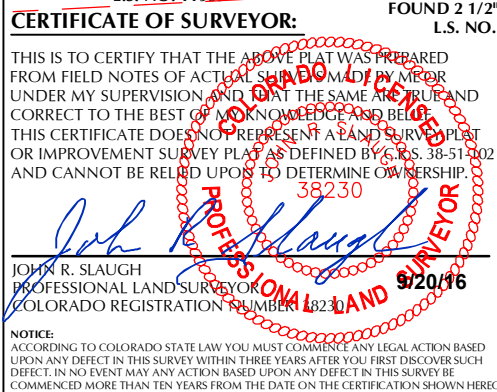

GOETZEL 34C-30-M  
WELL LOCATION CERTIFICATE  
2097' FSL & 2053' FWL NESW (SURFACE)  
108' FSL & 2570' FWL SESW (TOP OF PRODUCTION)  
LOCATED IN SECTION 29  
111' FSL & 510' FWL LOT 2 (SWSW) (BOTTOM)  
LOCATED IN SECTION 30  
T6N, R66W, 6TH P.M.  
WELD COUNTY, COLORADO

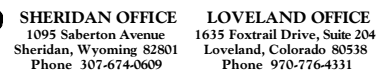

DRAFTED BY: LMO		CHECKED BY: JRS	SHEET NO: <b>1</b> 1 OF 2
DATE DRAFTED: 9/20/16		DATE SURVEYED: 9/8/16	
REVISED:		FILE NAME: 16-81	

**T6N, R66W**

W. 1/16 COR.  
SEC. 19 & SEC. 30, T6N, R66W  
FOUND 2 1/2" ALUM. CAP  
L.S. NO. 30462

NE. COR.  
SEC. 30, T6N, R66W  
FOUND 3 1/4" ALUM. CAP  
L.S. NO. 16154

N. 1/4 COR.  
SEC. 30, T6N, R66W  
FOUND 3 1/4" ALUM. CAP  
ILLEGIBLE

S 87°59'42" W  
1319.19' (M)

S 87°58'56" W  
1319.23' (M)

W. 1/4 COR.  
SEC. 30, T6N, R66W  
FOUND 3 1/4" ALUM. CAP  
ILLEGIBLE

S 86°31'14" W  
1637.09' (M)

S 86°30'40" W  
1569.52' (M)

26'59" TRUE GRID

NO. 2

NO. 1

N 00°04'38" E  
2720.16' (M)

SCALE: 1" = 1000'

W. 1/4 COR.  
SEC. 30, T6N, R66W  
FOUND 2 1/2" ALUM. CAP  
ILLEGIBLE

CW 1/16 COR.  
SEC. 30, T6N, R66W  
FOUND 3 1/4" ALUM. CAP  
L.S. NO. 7242

CENTER 1/4 COR.  
SEC. 30, T6N, R66W  
FOUND 3 1/4" ALUM. CAP  
L.S. NO. 7242

CE. 1/16 COR.  
SEC. 30, T6N, R66W  
FOUND 2 1/2" ALUM. CAP  
L.S. NO. 30462

E. 1/4 COR.  
SEC. 30, T6N, R66W  
FOUND 2 1/2" ALUM. CAP  
L.S. NO. 23501

S 86°17'18" W  
1607.63' (M)

S 86°17'23" W  
1568.73' (M)

30

S 86°17'08" W  
1336.26' (M)

S 86°17'09" W  
1336.16' (M)

N 00°04'13" E  
1321.79' (M)

N 00°05'16" E  
1321.83' (M)

CS. 1/16 COR.  
SEC. 30, T6N, R66W  
FOUND 3 1/4" ALUM. CAP  
WITNESS CORNER 229' SOUTH  
OF CORNER POSITION  
L.S. NO. 7242

460' BUFFER

S. 1/16 COR.  
SEC. 29 & SEC. 30  
T6N, R66W  
FOUND 3 1/4" ALUM. CAP  
L.S. NO. 7242

N 00°11'28" W  
1324.58' (M)

N 00°11'34" W  
1324.53' (M)

SE. COR.  
SEC. 30, T6N, R66W  
FOUND 2 1/2" ALUM. CAP  
L.S. NO. 11989

SW. COR.  
SEC. 30, T6N, R66W  
FOUND 3 1/4" ALUM. CAP  
L.S. NO. 7242

W. 1/16 COR.  
SEC. 30 & SEC. 31, T6N, R66W  
FOUND 3 1/4" ALUM. CAP  
L.S. NO. 22098

S. 1/4 COR.  
SEC. 30, T6N, R66W  
FOUND 3 1/4" ALUM. CAP  
L.S. NO. 22098

S 86°24'44" W  
1577.77' (M)

S 86°25'11" W  
1566.89' (M)

S 86°25'12" W  
2684.57' (M)

7889' GRID  
S 87°25'24" W TRUE

510'

111'

BOTTOM OF HOLE

NOTES:

- INDICATES SECTION CORNER
- INDICATES CALCULATED CORNER
- DRAWING LATITUDE AND LONGITUDE COORDINATES

**CERTIFICATE OF SURVEYOR:**

THIS IS TO CERTIFY THAT THE ABOVE PLAT WAS PREPARED FROM FIELD NOTES OF ACTUAL SURVEY MADE BY ME OR UNDER MY SUPERVISION AND THAT THE SAME ARE TRUE AND CORRECT TO THE BEST OF MY KNOWLEDGE AND BELIEF. THIS CERTIFICATE DOES NOT REPRESENT A LAND SURVEY PLAT OR IMPROVEMENT SURVEY PLAT AS DEFINED BY C.R.S. 38-51-102 AND CANNOT BE RELIED UPON TO DETERMINE OWNERSHIP.

JOHN R. SLAUGH  
PROFESSIONAL LAND SURVEYOR  
COLORADO REGISTRATION NUMBER 18230

**NOTICE:** ACCORDING TO COLORADO STATE LAW YOU MUST COMMENCE ANY LEGAL ACTION BASED UPON ANY DEFECT IN THIS SURVEY WITHIN THREE YEARS AFTER YOU FIRST DISCOVER SUCH DEFECT. IN NO EVENT MAY ANY ACTION BASED UPON ANY DEFECT IN THIS SURVEY BE COMMENCED MORE THAN TEN YEARS FROM THE DATE ON THE CERTIFICATION SHOWN HEREON.

**WELL DISTANCES:**

BUILDING: ±1361' NW  
BUILDING UNIT: ±1361' NW  
HIGH OCCUPANCY BUILDING UNIT: 5280'+  
DESIGNATED OUTSIDE ACTIVITY AREA: 5280'+  
PUBLIC ROAD: ±2087' W  
PROPERTY LINE: ±207' S  
ABOVE GROUND UTILITY: ±226' S  
RAILROAD: ±256' S

**NOTES:**

1. ▲ INDICATES SECTION CORNER
2. ● INDICATES CALCULATED CORNER
3. DRAWING LATITUDE AND LONGITUDE COORDINATES ARE NAD 83 (2011)(EPOCH:2010)
4. ELEVATION BASED ON NAVD88 (GEOID12B)
5. BASIS OF BEARING DERIVED FROM COLORADO COORDINATE SYSTEM OF 1983 NORTH ZONE.
6. ALL MEASURED DISTANCES ARE GRID.  
COMBINED SCALE FACTOR: .99974048 CALCULATED FROM THE W. 1/4 CORNER OF SECTION 29, T6N, R66W
7. OPERATOR: ROB WILSON / PDOP = 1.5
8. SEE ADDENDUM TO WELL LOCATION CERTIFICATE FOR EXISTING IMPROVEMENTS WITHIN 500' OF THE WELL PAD.
9. WELL FOOTAGES ARE MEASURED AT RIGHT ANGLES TO THE SECTION LINES.
10. THE BOTTOM OF HOLE BEARS S86°58'25"W, 7889' FROM THE TOP OF PRODUCTION ZONE.
11. NO. 1 & NO. 2 AS SHOWN HEREON ARE GOVERNMENT  
" LOTS 1 & 2 PER THE ORIGINAL GLO SURVEY

## WELL PAD - GOETZEL 25-29

GOETZEL 34C-30-M  
WELL LOCATION CERTIFICATE  
2097' FSL & 2053' FWL NESW (SURFACE)  
108' FSL & 2570' FWL SESW (TOP OF PRODUCTION)  
LOCATED IN SECTION 29  
111' FSL & 510' FWL LOT 2 (SWSW) (BOTTOM)  
LOCATED IN SECTION 30  
T6N, R66W, 6TH P.M.  
WELD COUNTY, COLORADO



**1625 Broadway, Suite 300  
Denver, Colorado 80202**



CONSULTING, LLC

**SHERIDAN OFFICE**  
1095 Saberton Avenue  
Sheridan, Wyoming 82801  
Phone 307-674-0609

**LOVELAND OFFICE**  
1635 Foxtrail Drive, Suite 204  
Loveland, Colorado 80538  
Phone 970-776-4331

DRAFTED BY: LMO	CHECKED BY: JRS	SHEET NO: <b>2</b> 2 OF 2
DATE DRAFTED: 9/20/16	DATE SURVEYED: 9/8/16	
REVISED:	FILE NAME: 16-81	