

# Great Western Operating Company, LLC

**Location** Colorado  
**Field** Wattenburg  
**Installation** Kodak South

**Slot** Slot W06 - Kodak South FD 25-280HNX  
**Well** Kodak South FD 25-280HNX  
**Wellbore** Kodak South FD 25-280HNX (PWB)

Created by admin  
Date plotted 2-Dec-2016

Plot reference is Kodak South FD 25-280HNX (PWB).  
Ref wellpath is Kodak South FD 25-280HNX (PWP#1).  
Coordinates are in Feet reference Slot W06 - Kodak South FD 25-280HNX.  
True Vertical Depths are reference Rig Datum.  
Measured Depths are reference Rig Datum.  
Rig Datum: Planned Datum #1  
Rig Datum to Mean Sea Level: 4762.60 ft.  
Plot North is aligned to TRUE North.

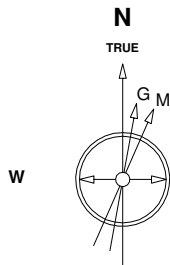

Scale 1 cm = 400 ft

East (Feet) ->

-5600 -4800 -4000 -3200 -2400 -1600 -800 0 800 1600 2400 3200 4000 4800 5600 6400 7200 8000 8800 9600

15-Jul-2016  
IGRF Model [1900.0-2020.0] Dip: 66.91 deg Field: 52519.4 nT  
Lat: N40 27 32.4396 Long: W104 51 49.7592 Elev: 4742.60 ft  
Magnetic North is 8.37 deg East of TRUE North  
To correct azimuth from Magnetic to TRUE add 8.37 deg

Scale 1 cm = 500 ft

-4000  
-3000  
-2000  
-1000  
0  
1000  
2000  
3000  
4000  
5000  
6000  
7000  
8000

<- True Vertical Depth (Feet)

9 5/8in Surface Casing

TPZ - 7471 / 6833 MD/TVD, 1850 FSL, 1815 FWL Sec 26

BHL - 15,734 / 6833 MD/TVD, 1847 FSL, 460 FEL Sec 25

5 1/2in Production Casing

TPZ - 7471 / 6833 MD/TVD, 1850 FSL, 1815 FWL Sec 26

BHL - 15,734 / 6833 MD/TVD, 1847 FSL, 460 FEL Sec 25

-2000 -1000 0 1000 2000 3000 4000 5000 6000 7000 8000 9000 10000

Scale 1 cm = 500 ft

Vertical Section (Feet) ->

Azimuth 82.17 with reference 0.00 N, 0.00 E from Slot W06 - Kodak South FD 25-280HNX

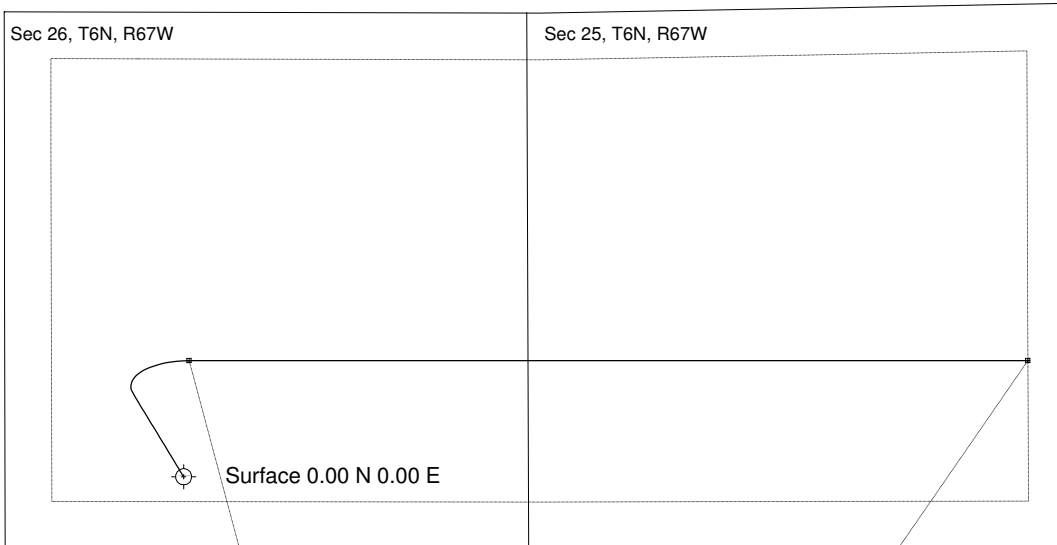

<- North(Feet)

5600  
4800  
4000  
3200  
2400  
1600  
800  
0  
-800  
-1600  
-2400  
-3200

Scale 1 cm = 400 ft

## WELL PROFILE DATA

Point	MD	Inc	Azi	TVD	North	East	deg/100ft	V. Sect
Tie on	0.00	0.00	0.00	0.00	S 0.00	W 0.00		0.00
KOP	4006.00	0.00	328.72	4006.00	S 0.00	W 0.00	0.00	0.00
End of Build	5006.01	30.00	328.72	4960.94	N 218.67	W 132.87	9.84	-101.84
End of Hold	6420.39	30.00	328.72	6185.82	N 823.04	W 500.11	0.00	-383.29
Target TPZ - ...Sec 26	7470.84	90.00	89.99	6833.00	N 1142.49	E 53.15	32.81	208.34
T.D. & Target BHL... 25	15733.89	90.00	89.99	6833.00	N 1143.89	E 8316.20	0.00	8394.50