

20

CR 66

4736

A: WATER WELL (PERMIT #12954-R, ±22'  
WELL CONSTRUCTED)

SECTION  
LINE

4730

29

Well

A

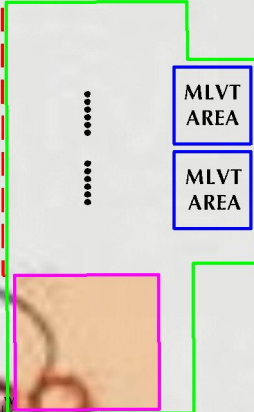

T6N  
R66W



0 250' 500'  
1" = 500'

NOTE: WATER WELLS COURTESY OF COLORADO  
DIVISION OF WATER RESOURCES

**LEGEND**

- PROPOSED WELL
- ACCESS ROAD
- DITCH/CANAL/DRAINAGE
- ▭ DISTURBANCE AREA
- ▭ PROPOSED FACILITY
- ▭ 1000' DISTURBANCE BUFFER
- \*ALL DISTANCES MEASURED FROM EDGE OF DISTURBANCE.
- == ROAD - IMPROVED - EXISTING
- ROAD - PRIMITIVE - EXISTING
- == ROAD - HIGHWAY - EXISTING

**PAD - GOETZEL 7-29**

HYDROLOGY MAP  
 GOETZEL 30N-30B-M, GOETZEL 30C-30-M, GOETZEL 4N-30C-M,  
 GOETZEL 4N-30A-M, GOETZEL 4C-30-M, GOETZEL 31N-30B-M,  
 GOETZEL 31C-30-M, GOETZEL 31N-30C-M, GOETZEL 5C-30-M,  
 GOETZEL 5N-30B-M, GOETZEL 32C-30-M & GOETZEL 32N-30C-M  
 LOCATED IN SECTION 29, T6N, R66W, 6TH P.M.  
 WELD COUNTY, COLORADO

**SYNERGY**  
RESOURCES CORPORATION

1625 Broadway, Suite 300  
Denver, Colorado 80202



**CONSULTING, LLC**

SHERIDAN OFFICE 1095 Saberton Avenue  
Sheridan, Wyoming 82801  
Phone 307-674-0609

LOVELAND OFFICE 1635 Foxtrail Drive, Suite 204  
Loveland, Colorado 80538  
Phone 970-776-4331

SCALE:	1" = 500ft	NAD83 CO-Nft
DRAWN:	CDJ	DATE: 8/31/16
REVISED:	SRS	DATE: 9/22/16