



October 31, 2016

Mr. Matt Lepore, Director
Colorado Oil and Gas Conservation Commission
1120 Lincoln Street, Suite 801
Denver, Colorado 80203

**RE: COGCC Rule 318A.e.: Proposed Spacing Unit
Wilkinson K-12HC Well: SWSW Section 1, Township 6 North, Range 65 West
Weld County, Colorado**

Dear Mr. Lepore:

Bayswater Exploration & Production, LLC (Bayswater) is planning to drill the above referenced well in accordance with the provisions set out in Colorado Oil and Gas Conservation Commission (COGCC) Rule 318A.e. Bayswater's Proposed Spacing Unit consists of:

SE¼SW¼ of Section 1, Township 6 North, Range 65 West
E½W½ and W½E½ of Section 12 and 13, Township 6 North, Range 65 West
Containing 680.00 acres, more or less

Bayswater is not the only owner within the Proposed Spacing Unit and has provided notice to the remaining owners, as required by COGCC Rule 318A.e.(6). Copies of the required notification letters are on file at Bayswater's office. The required thirty (30) day notice period has elapsed absent the receipt by Bayswater of any objection to their proposal by the owners within the Proposed Spacing Unit for the subject well.

Enclosed is the Proposed Spacing Unit Exhibit to assist in your review and approval of Bayswater's proposed Application for Permit to Drill for the Wilkinson K-12HC Well. Many thanks for your attention to this matter.

Respectfully,

A handwritten signature in blue ink, appearing to read 'Jeff Annable', written over a light blue circular stamp.

Jeff Annable
Regulatory Analyst
Agent for Bayswater Exploration & Production, LLC

:ja

Enclosure: Proposed Spacing Unit Exhibit

WILKINSON 1-P PAD
PROPOSED 318A.e. SPACING UNIT
SEC. 1: SE4SW4
SEC. 12 & 13: E2W2 & W2E2

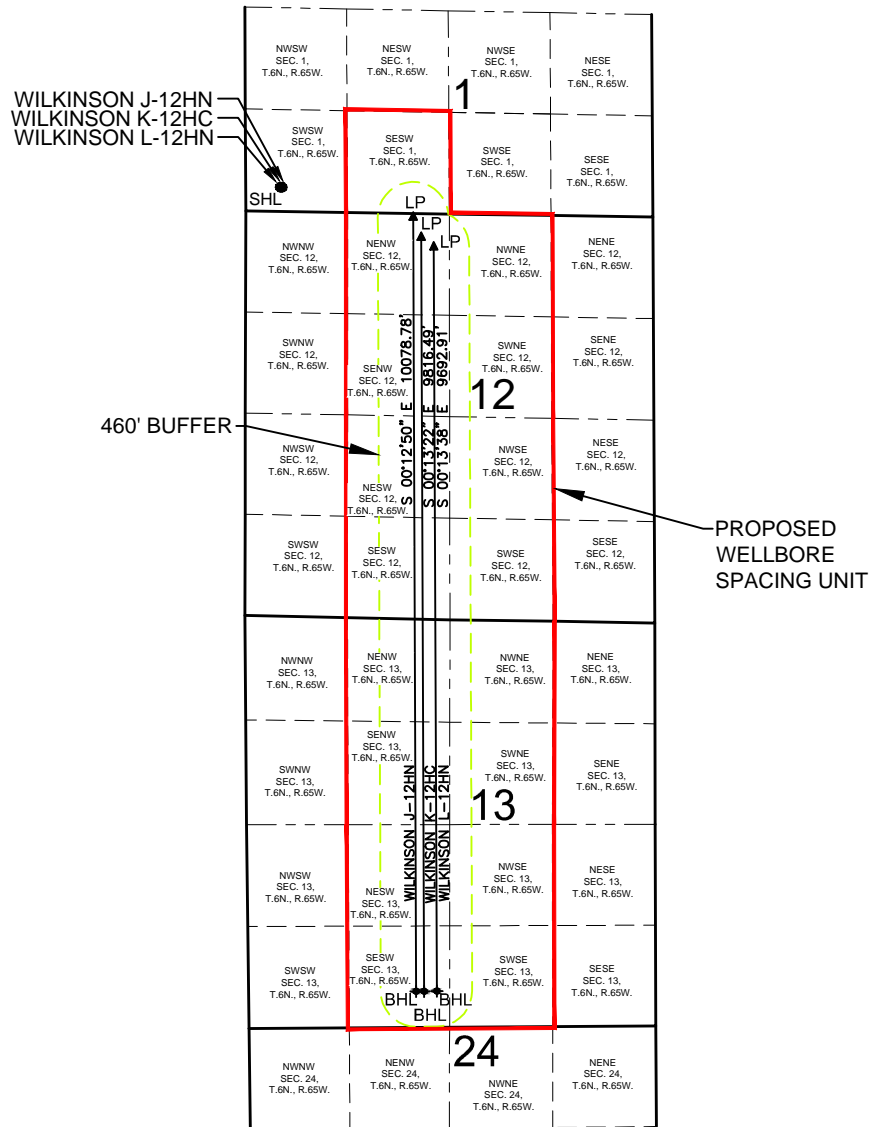

WELL **WILKINSON J-12HN** TO BE LOCATED 316' FSL AND 435' FWL, SEC. 1, T.6N, R.65W
WELL **WILKINSON K-12HC** TO BE LOCATED 316' FSL AND 450' FWL, SEC. 1, T.6N, R.65W
WELL **WILKINSON L-12HN** TO BE LOCATED 316' FSL AND 465' FWL, SEC. 1, T.6N, R.65W

LEGEND

- = PROPOSED WELL
- ▲ = LANDING POINT
- ◆ = BOTTOM HOLE
- SHL = SURFACE HOLE
- LP = LANDING POINT
- BHL = BOTTOM HOLE

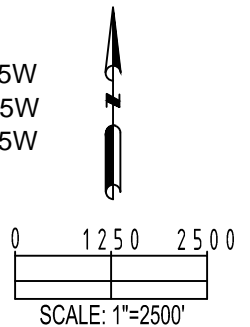

PREPARED BY:



FIELD DATE:

06-23-15

DRAWING DATE:

02-25-16

BY:

KAD

CHECKED BY:

TJN

SITE NAME:

WILKINSON 1-P PAD

SURFACE LOCATION:

SW 1/4 SW 1/4 SEC. 1, T.6N, R.65W, 6TH P.M.
WELD COUNTY, COLORADO

PREPARED FOR:

